

---

First published in the *Government Gazette*, Electronic Edition, on 17 January 2025 at 5 pm.

---

## No. S 27

### INFRASTRUCTURE PROTECTION ACT 2017

#### INFRASTRUCTURE PROTECTION (PROTECTED AREAS) ORDER 2025

##### ARRANGEMENT OF PARAGRAPHS

##### Paragraph

1. Citation and commencement
  2. Premises declared to be protected area
  3. Revocation
- The Schedule
- 

In exercise of the powers conferred by sections 8(1) and 13(1) of the Infrastructure Protection Act 2017, the Minister for Home Affairs makes the following Order:

##### **Citation and commencement**

1. This Order is the Infrastructure Protection (Protected Areas) Order 2025 and comes into operation on 18 January 2025.

##### **Premises declared to be protected area**

2. The premises described in the second column of the Schedule are declared to be a protected area for the purposes of the Act, and the person specified in the first column of that Schedule is designated as the authority of the protected area.

##### **Revocation**

3. Revoke the Protected Areas Order 2012 (G.N. No. S 350/2012).

---



---

 THE SCHEDULE

Paragraph 2

*First column**Second column*

The Authority

Protected Area

Chief Executive Officer,  
Changi Airport Group  
(Singapore) Pte. Ltd.

SELETAR AIRPORT — LANDSIDE

All that area comprised in part of Lot 5170X in Mukim No. 20 occupied by “SELETAR AIRPORT — LANDSIDE” containing an area of about 5,063 square metres and bounded approximately as follows:

Commencing at a point 44,585.619 metres North and 31,494.028 metres East of the Singapore Land Authority SVY 21 Datum, the boundaries run along successive lines of coordinates approximately as follows:

<i>Northings</i>	<i>Eastings</i>
44,585.619	31,494.028
44,574.881	31,479.413
44,558.355	31,473.859
44,557.253	31,476.614
44,554.342	31,475.573
44,556.404	31,469.956
44,559.919	31,471.134
44,562.269	31,466.177
44,571.251	31,454.085
44,573.680	31,450.762
44,574.557	31,450.877
44,575.508	31,448.843
44,587.675	31,429.825
44,590.087	31,425.446
44,571.361	31,416.086
44,606.320	31,352.572
44,604.770	31,343.416

THE SCHEDULE — *continued*

<i>First column</i>	<i>Second column</i>
The Authority	Protected Area
44,607.069	31,338.475
44,635.653	31,355.515
44,625.681	31,373.990
44,602.510	31,416.918
44,599.027	31,423.327
44,607.480	31,428.716
44,610.861	31,430.872
44,629.630	31,442.840
44,593.159	31,499.122
44,586.645	31,494.677

to the point of commencement.

The boundaries of “SELETAR AIRPORT — LANDSIDE” are more particularly delineated in the Survey Plan No. SB-50LS-LCSE-S18022-021 set out below.

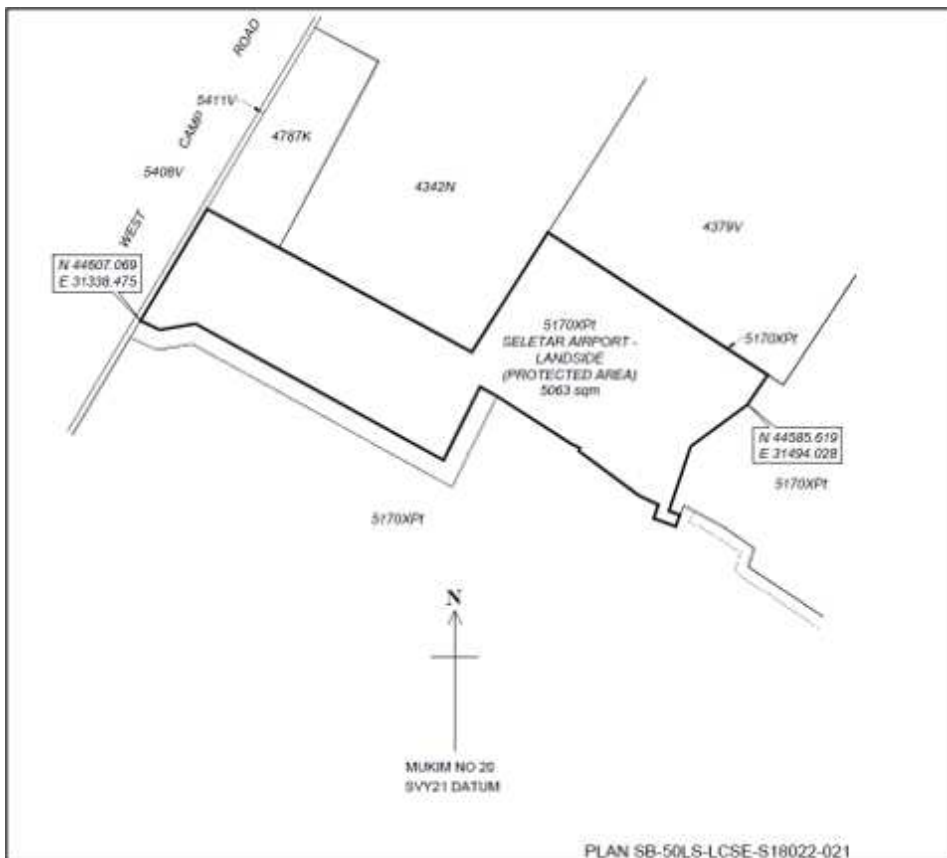
THE SCHEDULE — *continued*

Made on 20 December 2024.

PANG KIN KEONG  
*Permanent Secretary,  
Ministry of Home Affairs,  
Singapore.*

[SPF/CPS/C/09/10/16; AG/LEGIS/SL/137B/2020/3]