

---

---

First published in the *Government Gazette*, Electronic Edition, on 4 May 2018 at 5 pm.

## No. S 276

### ROAD TRAFFIC ACT (CHAPTER 276)

#### ROAD TRAFFIC (TRAFFIC SIGNS) (AMENDMENT NO. 2) RULES 2018

In exercise of the powers conferred by section 119 of the Road Traffic Act, the Land Transport Authority of Singapore, with the approval of the Minister for Transport, makes the following Rules:

#### **Citation and commencement**

1. These Rules are the Road Traffic (Traffic Signs) (Amendment No. 2) Rules 2018 and come into operation on 5 May 2018.

#### **New rule 1A**

2. The Road Traffic (Traffic Signs) Rules (R 33) (called in these Rules the principal Rules) are amended by inserting, immediately after rule 1, the following rule:

#### **“Definitions**

**1A.** In these Rules, unless the context otherwise requires —

“bicycle” has the meaning given by the Act, and includes a vehicle that has 3 wheels, has pedals, and is built to be propelled solely by human power and to transport people only (with or without carry-on baggage);

“cyclist” means an individual who is riding a bicycle or power-assisted bicycle, but excludes an individual who is walking beside and pushing a bicycle or power-assisted bicycle;

“mobility scooter” and “wheeled toy” have the meanings given by section 2(1) of the Active Mobility Act 2017 (Act 3 of 2017);

“pedestrian” means —

- (a) an individual walking, with or without animals;
- (b) an individual in a non-motorised wheelchair;
- (c) an individual driving a motorised wheelchair or riding a mobility scooter;
- (d) an individual travelling on inline skates, roller-skates or a wheeled toy;
- (e) an individual pushing a pram, stroller or trolley, or a motorised or non-motorised wheelchair; or
- (f) an individual walking beside and pushing a bicycle, power-assisted bicycle, personal mobility device or any other vehicle;

“PMD” means a personal mobility device;

“PMD rider” means an individual who is riding a personal mobility device on a road as permitted by section 5A(2) of the Act, but excludes an individual who is walking beside and pushing a PMD.”.

### **Amendment of rule 8**

3. Rule 8(2) of the principal Rules is amended by deleting sub-paragraph (b) and substituting the following sub-paragraph:

“(b) a cyclist who is not cycling alongside of another bicycle or power-assisted bicycle on his left;”.

### **Amendment of rule 15**

4. Rule 15 of the principal Rules is amended —

- (a) by inserting, immediately after the word “pedestrians” in paragraphs (1) and (2), the words “, PMD riders and cyclists”;
- (b) by inserting, immediately after the word “pedestrian” in paragraphs (7) and (8), the words “, PMD rider or cyclist”; and

- (c) by deleting the rule heading and substituting the following rule heading:

**“Light signals for cyclists, pedestrians and PMD riders”.**

### **Amendment of rule 16**

5. Rule 16 of the principal Rules is amended —

- (a) by inserting, immediately after the word “cyclists” in paragraphs (1) and (2), the words “, PMD riders and pedestrians”;
- (b) by inserting, immediately after the word “cyclist” in paragraphs (7) and (8), the words “, PMD rider or pedestrian”; and
- (c) by deleting the rule heading and substituting the following rule heading:

**“Light signals for bicycles, etc.”.**

### **Amendment of Schedule**

6. The Schedule to the principal Rules is amended —

- (a) by inserting, immediately after the words “prohibits pedestrians” in the paragraph below diagram 21 in Part I, the words “, PMD riders and cyclists”;
- (b) by deleting the heading “CYCLIST CROSSING PROHIBITION” for diagram 24(a) in Part I and substituting the heading “CYCLIST AND PMD RIDER CROSSING PROHIBITION”;
- (c) by inserting, immediately after the words “that cyclists” in the paragraph below diagram 24(a) in Part I, the words “and PMD riders”;

- (d) by deleting the heading “CYCLIST CROSSING PROHIBITION (MESSAGE ON REVERSED SIDE)” for diagram 24(d) in Part I and substituting the heading “CYCLIST AND PMD RIDER CROSSING PROHIBITION (MESSAGE ON REVERSED SIDE)”;
- (e) by inserting, immediately after diagram 24(d) in Part I, the following diagrams:

“DIAGRAM 24(e)

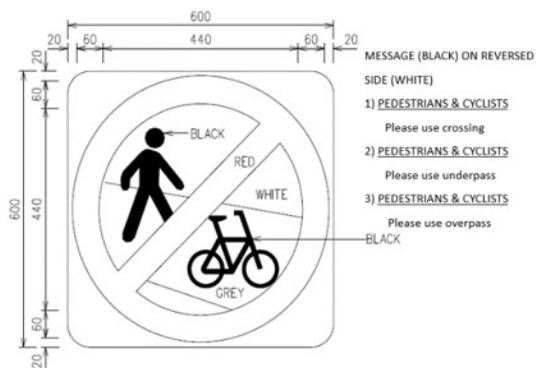

### PEDESTRIANS, CYCLISTS AND PMD RIDERS CROSSING PROHIBITION SIGN

This sign prohibits pedestrians, cyclists and PMD riders from crossing the road without using the designated crossing. It may be used in conjunction with supplementary plates to indicate the section of the road to which the prohibition applies.

DIAGRAM 24(f)

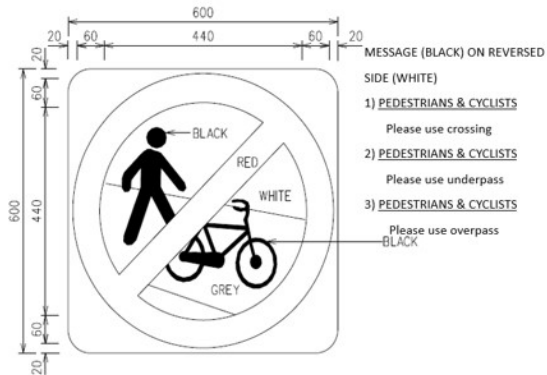

### PEDESTRIANS, CYCLISTS AND PMD RIDERS CROSSING PROHIBITION SIGN

This sign prohibits pedestrians, cyclists and PMD riders from crossing the road without using the designated crossing. This sign may be used in conjunction with supplementary plates to indicate the section of the road to which the prohibition applies.

DIAGRAM 24(g)

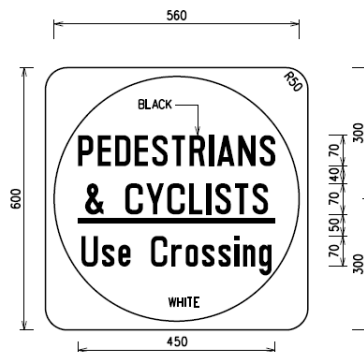

### PEDESTRIANS, CYCLISTS AND PMD RIDERS USE CROSSING SIGN

This sign indicates that pedestrians, cyclists and PMD riders are to cross the road using the designated crossing.

DIAGRAM 24(h)



PEDESTRIANS, CYCLISTS AND PMD RIDERS  
USE OVERPASS SIGN

This sign indicates that pedestrians, cyclists and PMD riders are to cross the road using the designated overpass.

DIAGRAM 24(i)

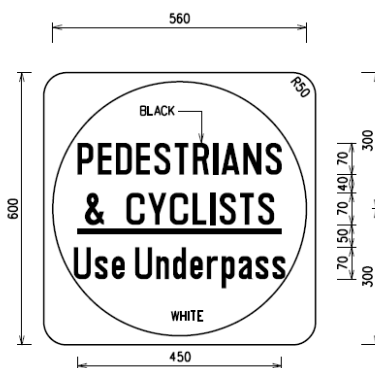

PEDESTRIANS, CYCLISTS AND PMD RIDERS  
USE UNDERPASS SIGN

This sign indicates that pedestrians, cyclists and PMD riders are to cross the road using the designated underpass.”;

- (f) by inserting, immediately after the words “MOTOR CYCLES” in the heading for diagram 26 in Part I, the words “, POWER-ASSISTED BICYCLES”;

- (g) by inserting, immediately after the words “motor cycles” in the paragraph below diagram 26 in Part I, the words “, power-assisted bicycles”;
- (h) by inserting, immediately after the word “PEDESTRIAN” in the heading for diagram 27 in Part I, the words “, POWER-ASSISTED BICYCLES”;
- (i) by inserting, immediately after the word “pedestrians” in the paragraph below diagram 27 in Part I, the words “, power-assisted bicycles”;
- (j) by inserting, immediately after the word “bicycles” in the paragraph below diagram 30 in Part I, the words “and power-assisted bicycles”;
- (k) by inserting, immediately after the words “riding of” in the paragraph below diagram 30A in Part I, the words “power-assisted bicycles and”;
- (l) by inserting, immediately after diagram 129(c) in Part III, the following diagram:

“DIAGRAM 129(ca)

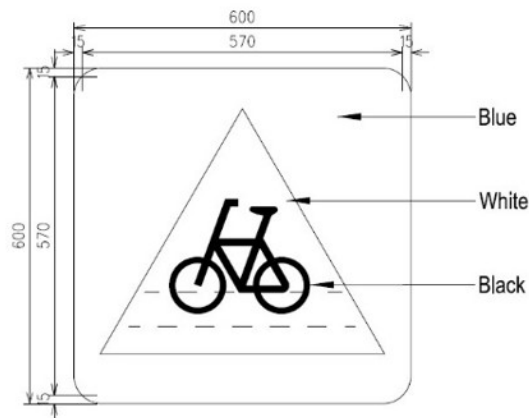

BICYCLE CROSSING SIGN

This sign indicates the location of a bicycle crossing.”; and

(m) by deleting diagram 145(a) in Part III and substituting the following diagram:

“DIAGRAM 145(a)

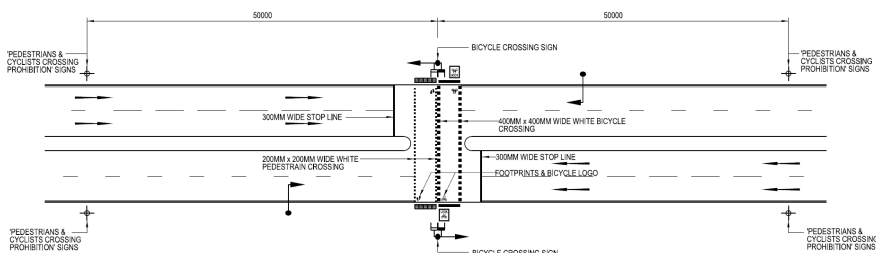

”

[G.N. Nos. S 13/2000; S 83/2000; S 375/2001; S 549/2001;  
S 334/2003; S 3/2005; S 572/2005; S 577/2005;  
S 639/2005; S 134/2007; S 651/2008; S 257/2009;  
S 165/2011; S 538/2011; S 782/2013; S 814/2013;  
S 670/2014; S 114/2016; S 676/2016; S 172/2017;  
S 189/2017; S 158/2018]

Made on 30 April 2018.

CHAN HENG LOON ALAN  
*Chairman,*  
*Land Transport Authority of*  
*Singapore.*

[LTA/LEGL/L18.029.002/JAS/DT/TS.18.03;  
AG/LEGIS/SL/276/2015/19 Vol. 1]

(To be presented to Parliament under section 141(1) of the Road Traffic Act).