First published in the Government *Gazette*, Electronic Edition, on 20th May 2013 at 5:00 pm.

No. S 311

PROTECTED AREAS AND PROTECTED PLACES ACT (CHAPTER 256)

PROTECTED PLACES (NO. 10) ORDER 2013

ARRANGEMENT OF PARAGRAPHS

Paragraph

1. Citation and commencement
2. Premises declared to be protected places
The Schedule

In exercise of the powers conferred by section 5(1) of the Protected Areas and Protected Places Act, the Minister for Home Affairs hereby makes the following Order:

Citation and commencement

1. This Order may be cited as the Protected Places (No. 10) Order 2013 and shall come into operation on 20th May 2013.

Premises declared to be protected places

2. The premises described in the second column of the Schedule are hereby declared to be protected places for the purposes of the Act, and no person shall be in those premises unless he is in possession of a pass-card or permit issued by the authority specified in the first column of the Schedule or has received the permission of an authorised officer on duty at the premises to enter the premises.

THE SCHEDULE

First column

Second column

The Authority

Protected Place

THE SCHEDULE — *continued*

Managing Director,
SP Powergrid Ltd

(1) Part of 1st. Storey Biopolis Buona Vista 66kV
Sub Station.

All that area comprised in part of Lot 4931M - MK03, along Biopolis Drive occupied by “Part of 1st. Storey Biopolis Buona Vista 66kV Sub Station” containing an area of about 1112.1 square metres and bounded approximately as follows:

Commencing at the corner of the aforesaid “Part of 1st. Storey Biopolis Buona Vista 66kV Sub Station” which point is 31762.778 metres North and 23515.939 metres East of the Singapore Land Authority SVY 21 Datum, the boundaries run along successive lines of co-ordinates approximately as follows:

<i>Northing</i>	<i>Easting</i>
31762.778	23515.939
31759.930	23526.565
31753.419	23526.565
31751.776	23527.374
31756.282	23535.777
31725.473	23552.174
31723.525	23548.585
31719.012	23551.007
31714.023	23541.520
31713.425	23541.845
31709.420	23534.251
31724.942	23525.922
31724.942	23523.043
31730.418	23523.045
31730.439	23515.952

to the point of commencement.

The boundaries of “Part of 1st. Storey Biopolis Buona Vista 66kV Sub Station” are more particularly delineated on the Survey Plan set out below.

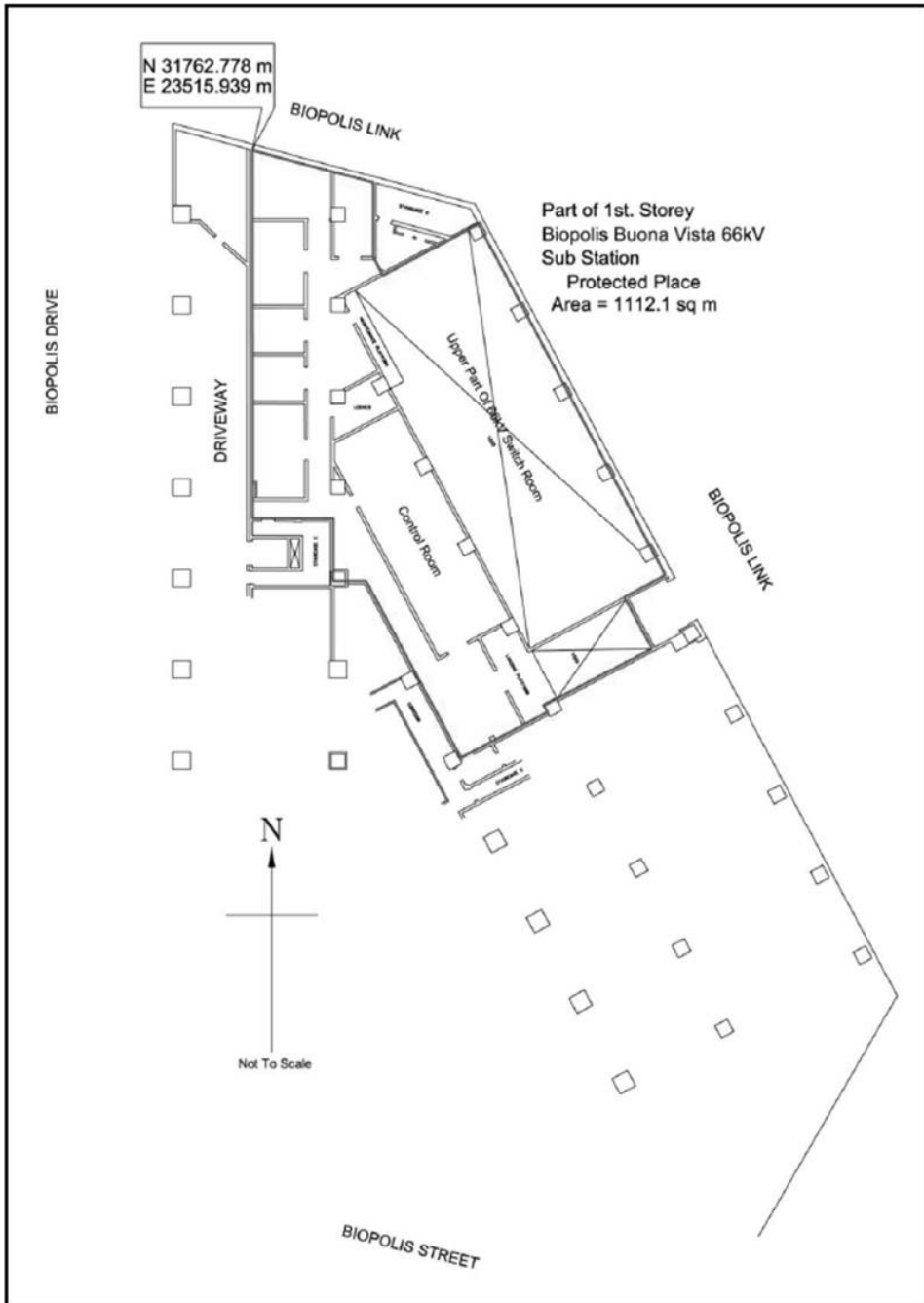
THE SCHEDULE — *continued*

First column
The Authority

Second column
Protected Place

THE SCHEDULE — *continued*

Managing Director,
SP Powergrid Ltd

(2) Part of 1st. Basement Biopolis Buona Vista 66kV
Sub Station.

All that area comprised in part of Lot 4931M – MK03, along Biopolis Drive occupied by “Part of 1st. Basement Biopolis Buona Vista 66kV Sub Station” containing an area of about 916.6 square metres and bounded approximately as follows:

Commencing at the corner of the aforesaid “Part of 1st. Basement Biopolis Buona Vista 66kV Sub Station” which point is 31761.090 metres North and 23522.975 metres East of the Singapore Land Authority SVY 21 Datum, the boundaries run along successive lines of co-ordinates approximately as follows:

<i>Northing</i>	<i>Easting</i>
31761.090	23522.975
31760.130	23526.565
31751.349	23526.563
31756.305	23535.926
31729.925	23550.005
31727.969	23546.412
31719.085	23551.142
31713.957	23541.396
31713.488	23541.651
31709.295	23533.949
31724.686	23525.727
31724.658	23520.325
31730.446	23520.315
31730.437	23514.804
31732.690	23514.808
31732.677	23522.973

to the point of commencement.

THE SCHEDULE — *continued*

The boundaries of “Part of 1st. Basement Biopolis Buona Vista 66kV Sub Station” are more particularly delineated on the Survey Plan set out below.

THE SCHEDULE — *continued*

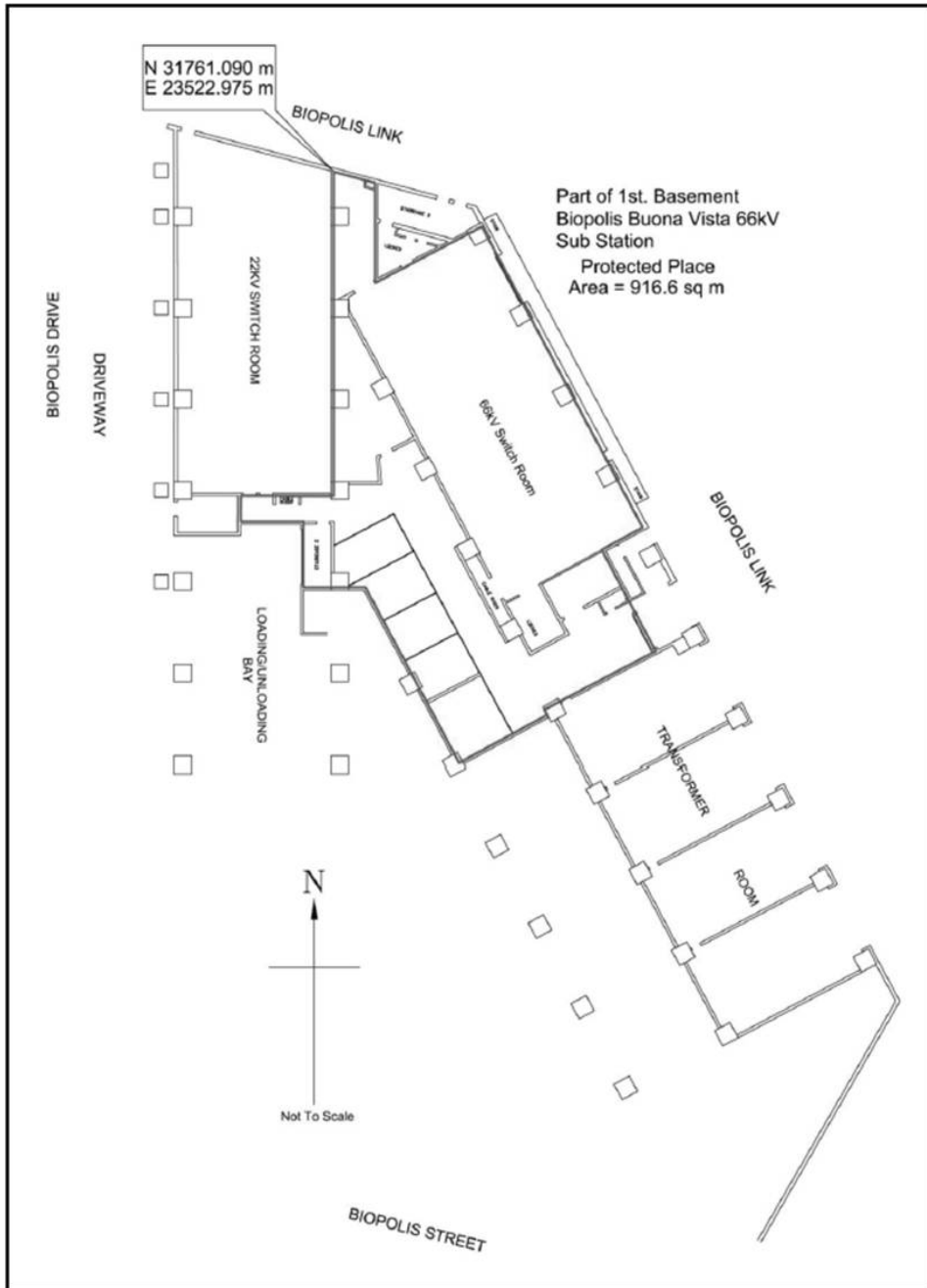

First column
The Authority

Second column
Protected Place

 THE SCHEDULE — *continued*

Managing Director,
SP Powergrid Ltd

(3) Part of 2nd. Basement Biopolis Buona Vista
66kV Sub Station.

All that area comprised in part of Lot
4931M - MK03, along Biopolis Drive occupied by
“Part of 2nd. Basement Biopolis Buona Vista 66kV
Sub Station” containing an area of about 1330.3
square metres and bounded approximately as
follows:

Commencing at the corner of the aforesaid “Part of
2nd. Basement Biopolis Buona Vista 66kV Sub
Station” which point is 31764.563 metres North and
23509.280 metres East of the Singapore Land
Authority SVY 21 Datum, the boundaries run along
successive lines of co-ordinates approximately as
follows:

<i>Northing</i>	<i>Easting</i>
31764.563	23509.280
31759.930	23526.565
31753.210	23526.565
31751.762	23527.347
31756.223	23535.808
31730.068	23549.732
31728.854	23547.503
31720.034	23552.304
31714.202	23541.263
31713.148	23541.836
31711.655	23539.026
31711.567	23539.073
31709.092	23534.413

THE SCHEDULE — *continued*

31724.711	23526.078
31724.658	23520.325
31730.446	23520.325
31730.437	23514.804
31732.737	23514.808
31732.733	23509.314

to the point of commencement.

The boundaries of “Part of 2nd. Basement Biopolis Buona Vista 66kV Sub Station” are more particularly delineated on the Survey Plan set out below.

THE SCHEDULE — *continued*

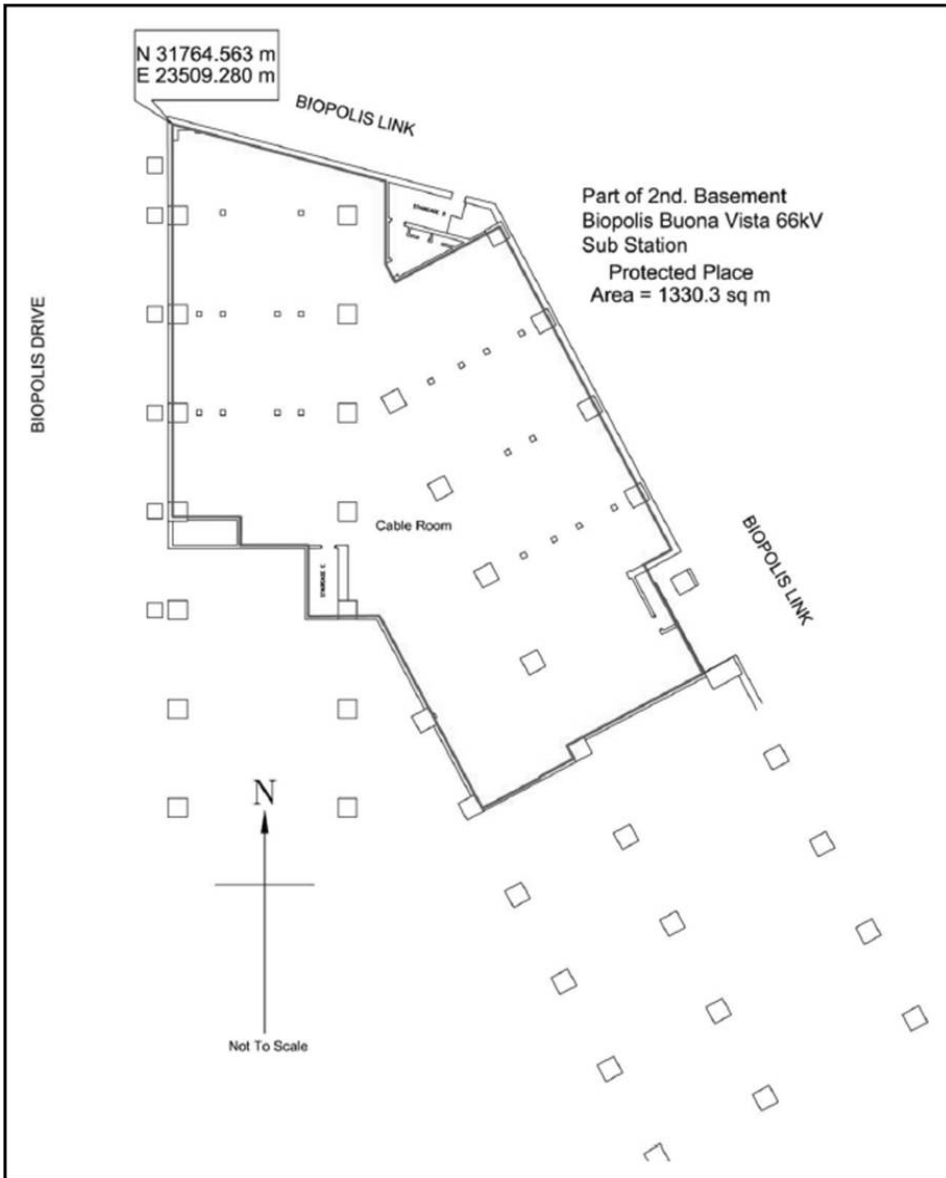

First column

Second column

The Authority

Protected Place

Managing Director,
SP Powergrid Ltd

(4) Bright Hill 66kV Sub Station.

All that area comprised in part of Lot 13935P -
MK18, along Bright Hill Road occupied by "Bright

 THE SCHEDULE — *continued*

Hill 66kV Sub Station” containing an area of about 3129.2 square metres and bounded approximately as follows:

Commencing at the corner of the aforesaid “Bright Hill 66kV Sub Station” which point is 38301.653 metres North and 28223.766 metres East of the Singapore Land Authority SVY 21 Datum, the boundaries run along successive lines of co-ordinates approximately as follows:

<i>Northing</i>	<i>Easting</i>
38301.653	28223.766
38239.562	28195.608
38228.603	28190.703
38213.712	28227.114
38220.603	28230.282
38266.820	28251.192
38285.365	28259.670
38292.382	28244.135
38292.565	28244.218
38295.032	28238.774
38294.824	28238.680

to the point of commencement.

The boundaries of “Bright Hill 66kV Sub Station” are more particularly delineated on the Survey Plan set out below.

THE SCHEDULE — *continued*

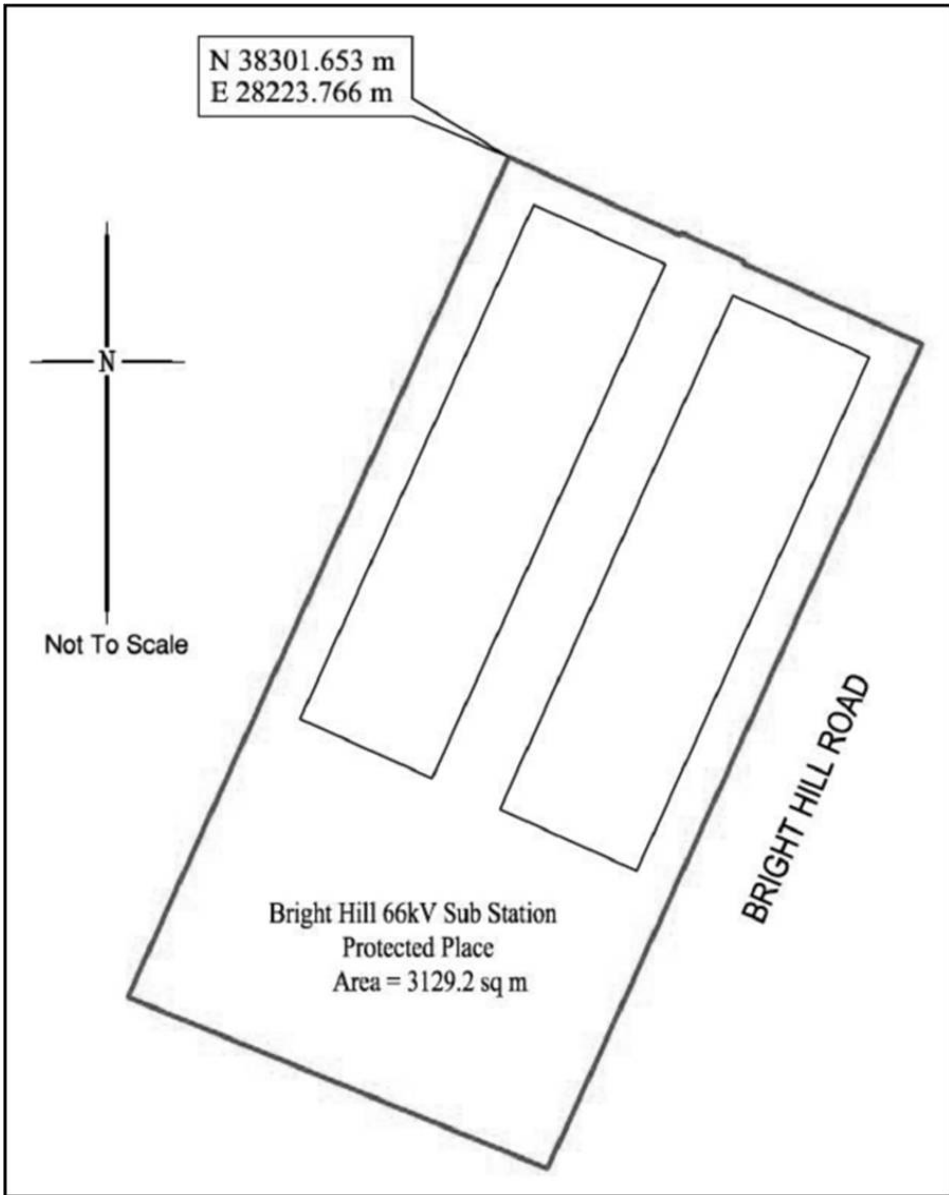

First column

Second column

The Authority

Protected Place

Managing Director,
SP Powergrid Ltd

(5) Clementi New Town 66kV Sub Station.

All that area comprised in part of Lot 8588T -
MK05, along Commonwealth Avenue West

THE SCHEDULE — *continued*

occupied by “Clementi New Town 66kV Sub Station” containing an area of about 5503.7 square metres and bounded approximately as follows:

Commencing at the corner of the aforesaid “Clementi New Town 66kV Sub Station” which point is 33395.390 metres North and 20197.222 metres East of the Singapore Land Authority SVY 21 Datum, the boundaries run along successive lines of co-ordinates approximately as follows:

<i>Northing</i>	<i>Easting</i>
33395.390	20197.222
33379.019	20214.809
33378.757	20215.074
33375.319	20217.913
33371.650	20221.012
33349.823	20235.895
33329.953	20249.421
33325.832	20252.216
33325.816	20252.227
33320.188	20255.340
33318.083	20256.604
33310.029	20261.157
33300.100	20241.811
33291.792	20225.733
33281.206	20205.180
33325.763	20182.156
33355.060	20167.170
33374.250	20181.386

to the point of commencement.

The boundaries of “Clementi New Town 66kV Sub Station” are more particularly delineated on the Survey Plan set out below.

THE SCHEDULE — *continued*

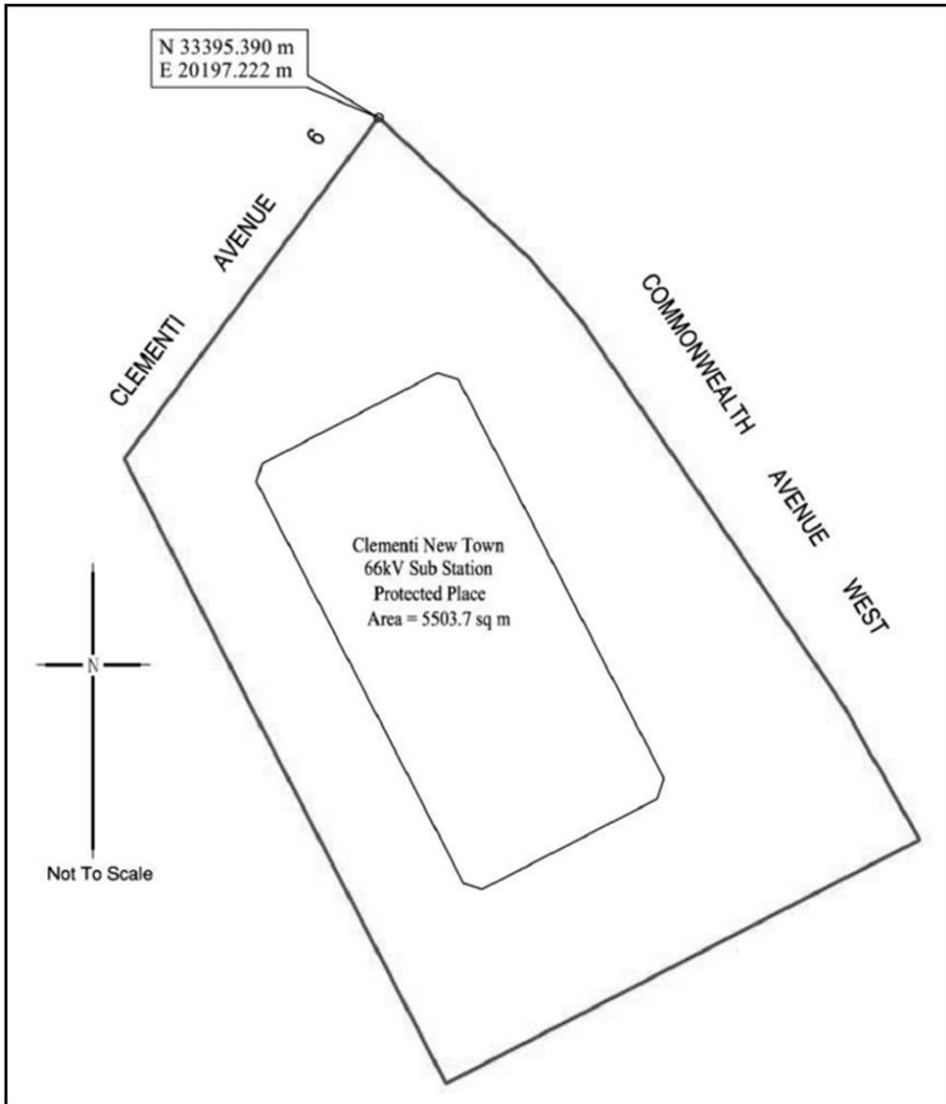

First column

Second column

The Authority

Protected Place

Managing Director,
SP Powergrid Ltd

(6) Pandan 66kV Sub Station.

All that area comprised in part of Lot 2343M - MK05, along Penjuru Road occupied by "Pandan 66kV Sub Station" containing an area of about

 THE SCHEDULE — *continued*

2188.1 square metres and bounded approximately as follows:

Commencing at the corner of the aforesaid “Pandan 66kV Sub Station” which point is 34035.357 metres North and 17223.717 metres East of the Singapore Land Authority SVY 21 Datum, the boundaries run along successive lines of co-ordinates approximately as follows:

<i>Northing</i>	<i>Easting</i>
34035.357	17223.717
33998.159	17215.228
33986.286	17272.019
33986.404	17272.047
33994.120	17273.900
33994.279	17273.966
33999.385	17275.137
33999.634	17275.146
34017.337	17279.073
34017.427	17279.102
34022.594	17280.259
34022.657	17280.021

to the point of commencement.

The boundaries of “Pandan 66kV Sub Station” are more particularly delineated on the Survey Plan set out below.

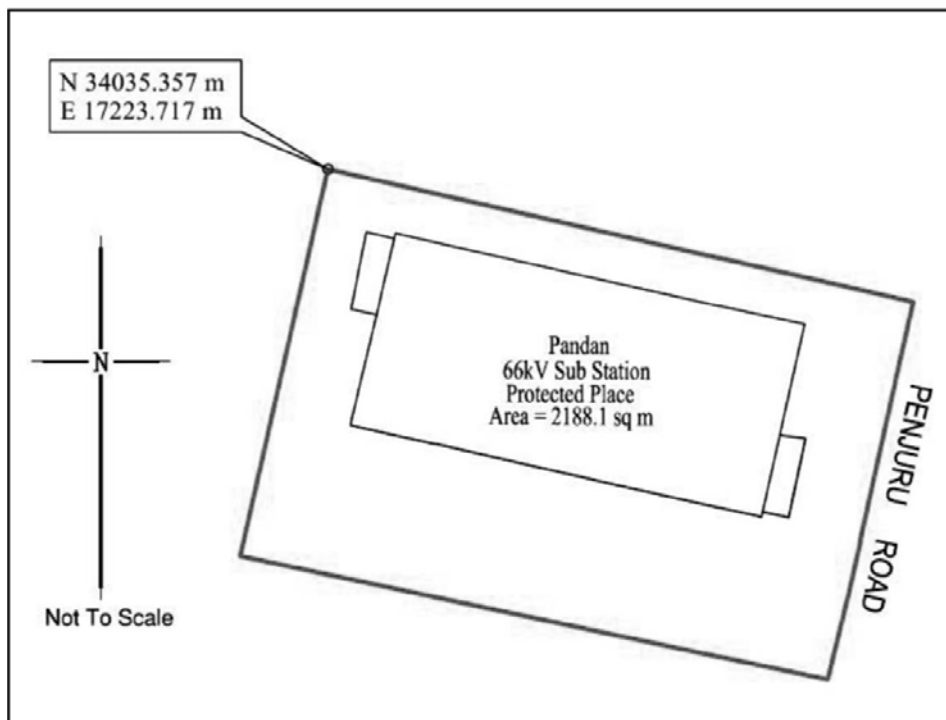
THE SCHEDULE — *continued**First column*

The Authority
 Managing Director,
 SP Powergrid Ltd

Second column

Protected Place
 (7) Part of 1st. Storey Pandan Loop 66kV Sub Station.

All that area comprised in part of Lot 6855X - MK05, along Pandan Loop occupied by "Part of 1st. Storey Pandan Loop 66kV Sub Station" containing an area of about 512.9 square metres and bounded approximately as follows:

Commencing at the corner of the aforesaid "Part of 1st. Storey Pandan Loop 66kV Sub Station" which point is 32483.672 metres North and 18902.838 metres East of the Singapore Land Authority SVY 21 Datum, the boundaries run along successive lines of co-ordinates approximately as follows:

<i>Northing</i>	<i>Easting</i>
32483.672	18902.838
32488.684	18907.714

THE SCHEDULE — *continued*

32491.506	18904.814
32493.117	18906.382
32494.837	18904.613
32495.332	18905.095
32495.703	18904.713
32496.415	18905.406
32496.450	18907.156
32489.470	18914.331
32494.243	18918.975
32479.276	18934.359
32470.802	18926.115
32468.006	18928.989
32464.725	18925.797
32464.522	18926.006
32462.780	18924.312

to the point of commencement.

The boundaries of “Part of 1st. Storey Pandan Loop 66kV Sub Station” are more particularly delineated on the Survey Plan set out below.

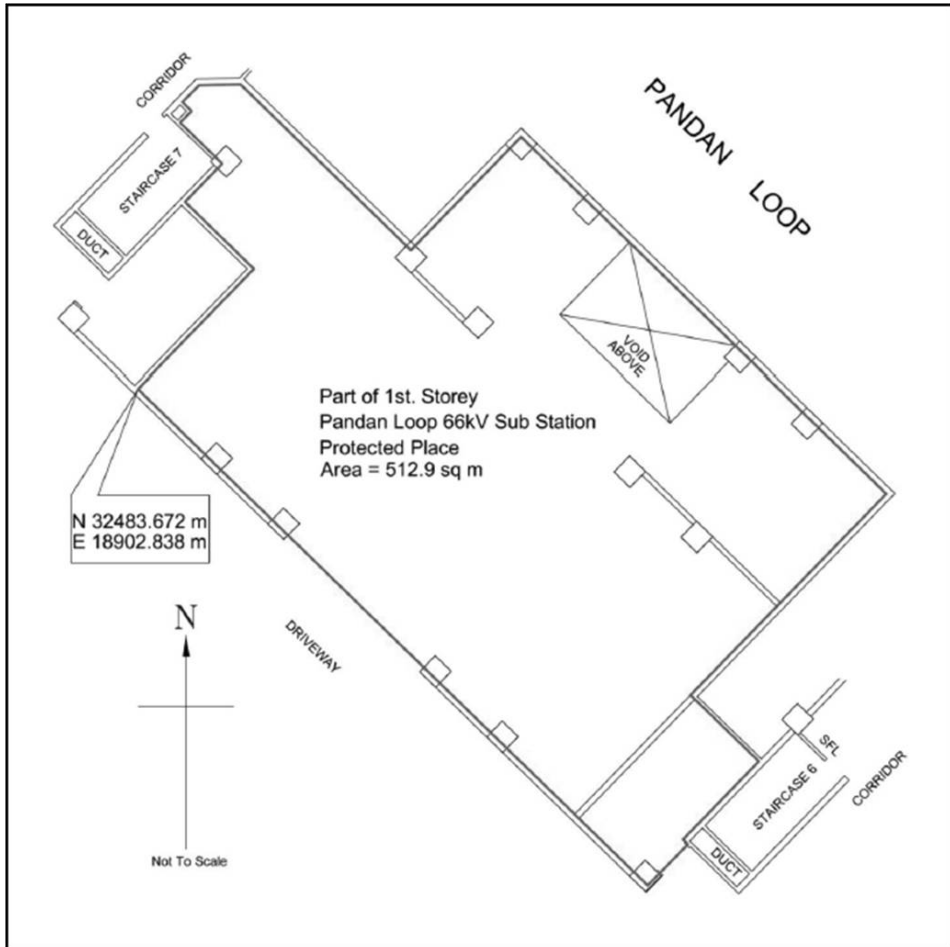
THE SCHEDULE — *continued**First column*

The Authority

Managing Director,
SP Powergrid Ltd*Second column*

Protected Place

(8) Part of 1st. Mezzanine Pandan Loop 66kV Sub Station.

All that area comprised in part of Lot 6855X - MK05, along Pandan Loop occupied by "Part of 1st. Mezzanine Pandan Loop 66kV Sub Station" containing an area of about 47.2 square metres and bounded approximately as follows:

Commencing at the corner of the aforesaid "Part of 1st. Mezzanine Pandan Loop 66kV Sub Station" which point is 32486.611 metres North and

THE SCHEDULE — *continued*

18899.816 metres East of the Singapore Land Authority SVY 21 Datum, the boundaries run along successive lines of co-ordinates approximately as follows:

<i>Northing</i>	<i>Easting</i>
32486.611	18899.816
32488.374	18901.532
32488.270	18901.639
32493.603	18906.827
32495.778	18904.591
32497.484	18906.251
32495.594	18908.193
32494.698	18907.321
32493.095	18908.970
32492.098	18908.001
32490.721	18909.417
32483.811	18902.695

to the point of commencement.

The boundaries of “Part of 1st. Mezzanine Pandan Loop 66kV Sub Station” are more particularly delineated on the Survey Plan set out below.

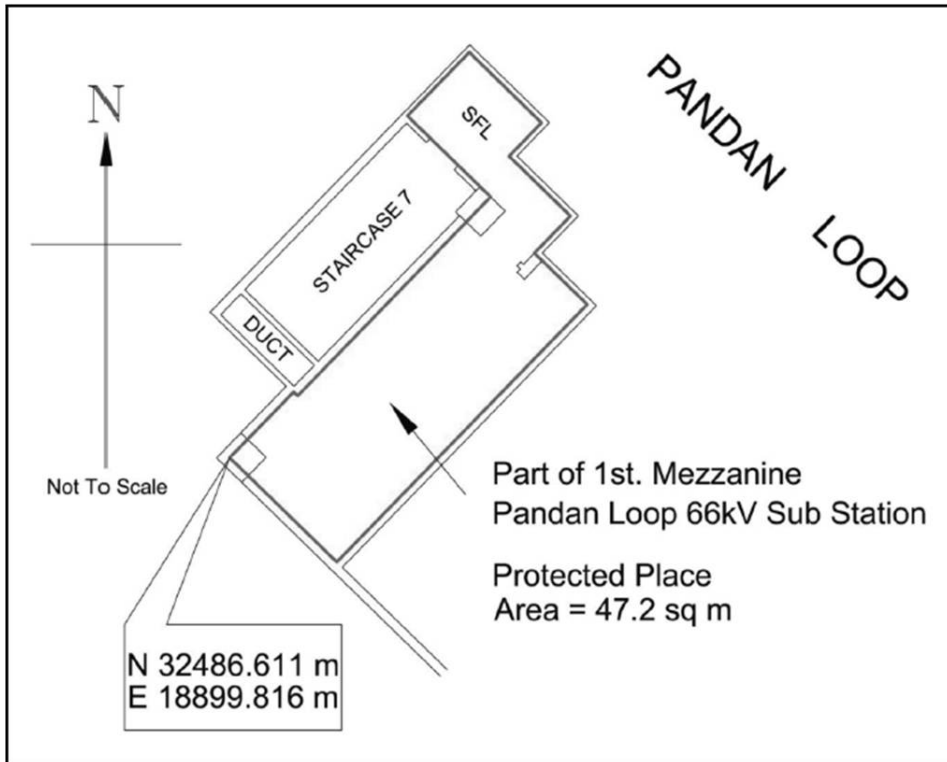
THE SCHEDULE — *continued**First column*

The Authority

Managing Director,
SP Powergrid Ltd*Second column*

Protected Place

(9) Part of 2nd. Storey Pandan Loop 66kV Sub Station.

All that area comprised in part of Lot 6855X - MK05, along Pandan Loop occupied by "Part of 2nd. Storey Pandan Loop 66kV Sub Station" containing an area of about 585.4 square metres and bounded approximately as follows:

Commencing at the corner of the aforesaid "Part of 2nd. Storey Pandan Loop 66kV Sub Station" which point is 32486.604 metres North and 18899.823 metres East of the Singapore Land Authority SVY 21 Datum, the boundaries run along successive lines of co-ordinates approximately as follows:

<i>Northing</i>	<i>Easting</i>
32486.604	18899.823

THE SCHEDULE — *continued*

32488.346	18901.518
32488.234	18901.633
32493.467	18906.723
32495.175	18904.967
32495.691	18905.469
32496.082	18905.068
32497.322	18906.274
32495.035	18908.625
32494.225	18907.837
32493.095	18908.998
32492.077	18908.008
32487.649	18912.559
32494.244	18918.975
32475.354	18938.392
32470.587	18933.755
32469.614	18934.755
32468.410	18933.583
32470.317	18931.623
32469.206	18930.542
32469.771	18929.962
32468.768	18928.985
32468.370	18929.394
32464.700	18925.824
32464.617	18925.910
32462.875	18924.215

to the point of commencement.

The boundaries of “Part of 2nd. Storey Pandan Loop 66kV Sub Station” are more particularly delineated on the Survey Plan set out below.

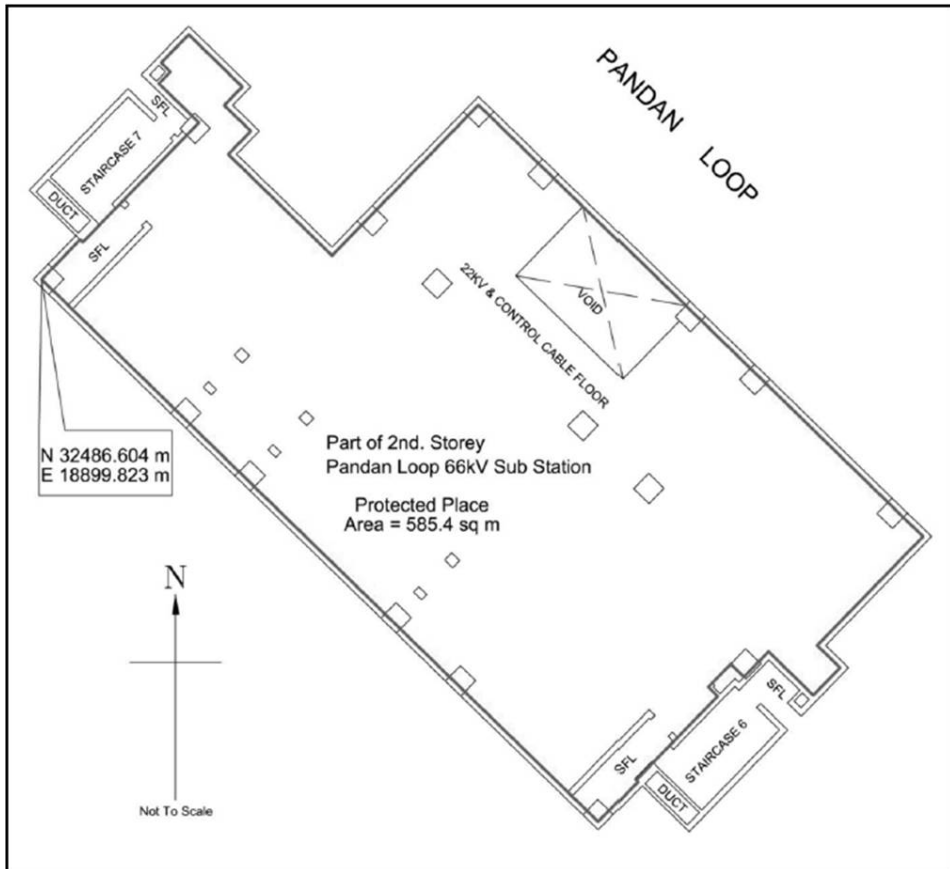
THE SCHEDULE — *continued*

First column

The Authority

Managing Director,
SP Powergrid Ltd

Second column

Protected Place

(10) Part of 3rd. Storey Pandan Loop 66kV Sub Station.

All that area comprised in part of Lot 6855X - MK05, along Pandan Loop occupied by "Part of 3rd. Storey Pandan Loop 66kV Sub Station" containing an area of about 619.2 square metres and bounded approximately as follows:

Commencing at the corner of the aforesaid "Part of 3rd. Storey Pandan Loop 66kV Sub Station" which point is 32486.562 metres North and 18898.792 metres East of the Singapore Land Authority SVY 21 Datum, the boundaries run

 THE SCHEDULE — *continued*

along successive lines of co-ordinates approximately as follows:

<i>Northing</i>	<i>Easting</i>
32486.562	18898.792
32488.841	18901.009
32488.269	18901.597
32493.624	18906.806
32495.186	18905.200
32495.580	18905.584
32496.173	18904.974
32497.484	18906.250
32495.588	18908.200
32495.509	18908.123
32489.470	18914.331
32494.244	18918.975
32476.379	18937.338
32469.297	18930.449
32469.771	18929.962
32468.839	18929.055
32468.410	18929.496
32464.669	18925.856
32464.128	18926.411
32461.849	18924.194

to the point of commencement.

The boundaries of “Part of 3rd. Storey Pandan Loop 66kV Sub Station” are more particularly delineated on the Survey Plan set out below.

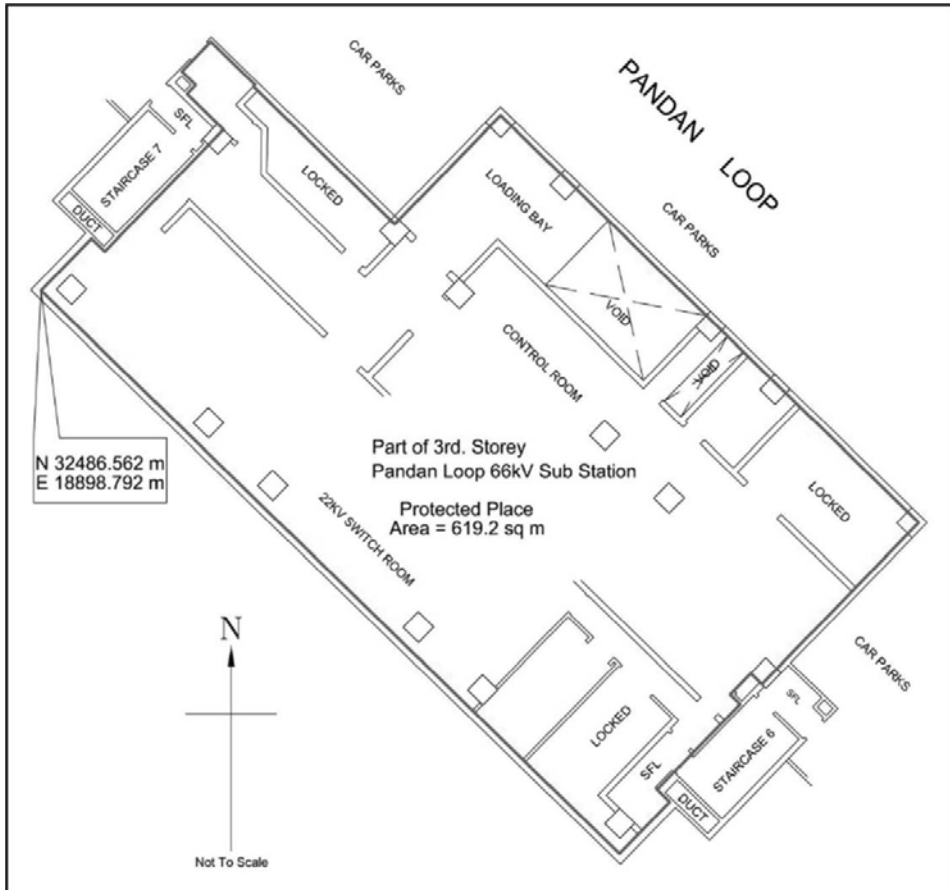
THE SCHEDULE — *continued**First column*

The Authority

Managing Director,
SP Powergrid Ltd

Second column

Protected Place

(11) Part of 4th. Storey Pandan Loop 66kV Sub Station.

All that area comprised in part of Lot 6855X - MK05, along Pandan Loop occupied by “Part of 4th. Storey Pandan Loop 66kV Sub Station” containing an area of about 618.1 square metres and bounded approximately as follows:

Commencing at the corner of the aforesaid “Part of 4th. Storey Pandan Loop 66kV Sub Station” which point is 32486.597 metres North and 18898.756 metres East of the Singapore Land Authority SVY 21 Datum,

THE SCHEDULE — *continued*

the boundaries run along successive lines of coordinates approximately as follows:

<i>Northing</i>	<i>Easting</i>
32486.597	18898.756
32488.847	18900.945
32488.192	18901.619
32493.539	18906.821
32495.150	18905.165
32495.573	18905.577
32496.082	18905.053
32497.401	18906.336
32495.574	18908.214
32495.495	18908.138
32489.470	18914.331
32494.186	18918.919
32479.299	18934.222
32477.277	18932.256
32472.717	18936.943
32469.986	18934.286
32469.561	18934.724
32468.378	18933.573
32470.317	18931.580
32469.227	18930.521
32469.771	18929.962
32468.839	18929.055
32468.435	18929.471
32464.693	18925.831
32464.094	18926.447
32461.814	18924.230

THE SCHEDULE — *continued*

to the point of commencement.

The boundaries of “Part of 4th. Storey Pandan Loop 66kV Sub Station” are more particularly delineated on the Survey Plan set out below.

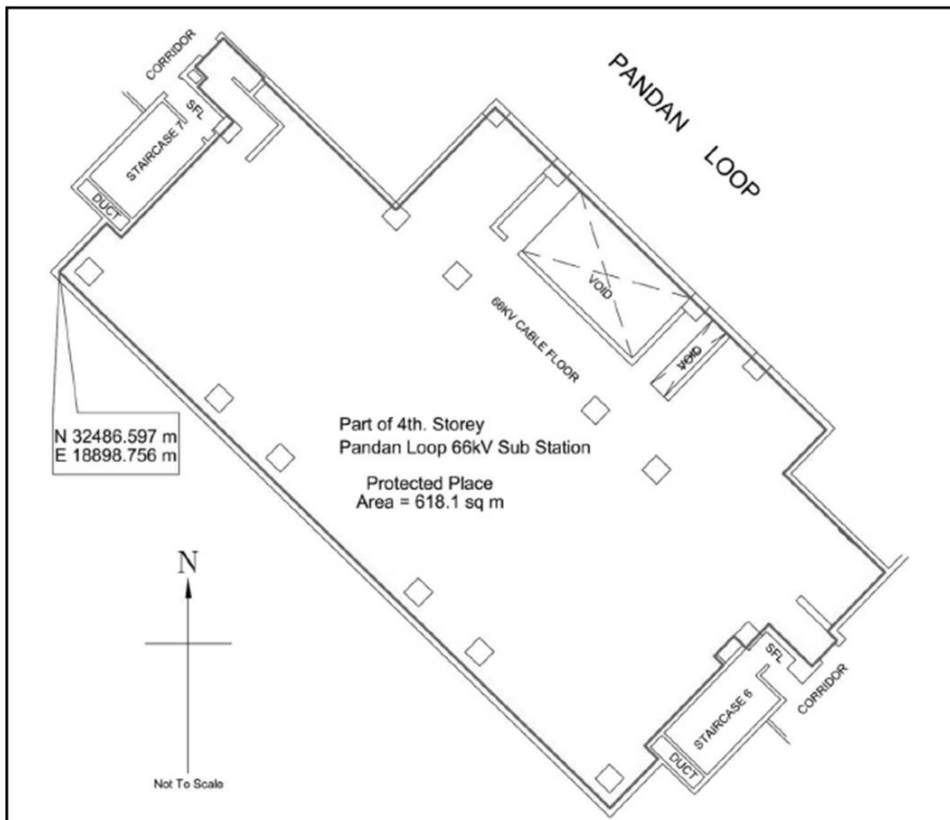

First column

The Authority

Managing Director,
SP Powergrid Ltd

Second column

Protected Place

(12) Part of 4th. Mezzanine Pandan Loop 66kV Sub Station.

All that area comprised in part of Lot 6855X - MK05, along Pandan Loop occupied by “Part of 4th. Mezzanine Pandan Loop 66kV Sub Station” containing an area of about 627.5 square metres and bounded approximately as follows:

THE SCHEDULE — *continued*

Commencing at the corner of the aforesaid “Part of 4th. Mezzanine Pandan Loop 66kV Sub Station” which point is 32486.597 metres North and 18898.756 metres East of the Singapore Land Authority SVY 21 Datum, the boundaries run along successive lines of co-ordinates approximately as follows:

<i>Northing</i>	<i>Easting</i>
32486.597	18898.756
32488.847	18900.945
32488.192	18901.619
32492.492	18905.803
32494.609	18903.627
32495.505	18904.499
32494.999	18905.019
32495.573	18905.577
32496.082	18905.053
32497.329	18906.267
32489.477	18914.338
32494.215	18918.947
32479.279	18934.300
32477.186	18932.264
32472.716	18936.858
32470.071	18934.285
32469.590	18934.780
32468.343	18933.567
32468.880	18933.015
32468.270	18932.422
32467.733	18932.974
32466.981	18932.242
32468.912	18930.256

THE SCHEDULE — *continued*

32469.206	18930.542
32469.771	18929.962
32468.839	18929.055
32468.435	18929.471
32464.693	18925.831
32464.094	18926.447
32461.814	18924.230

to the point of commencement.

The boundaries of “Part of 4th. Mezzanine Pandan Loop 66kV Sub Station” are more particularly delineated on the Survey Plan set out below.

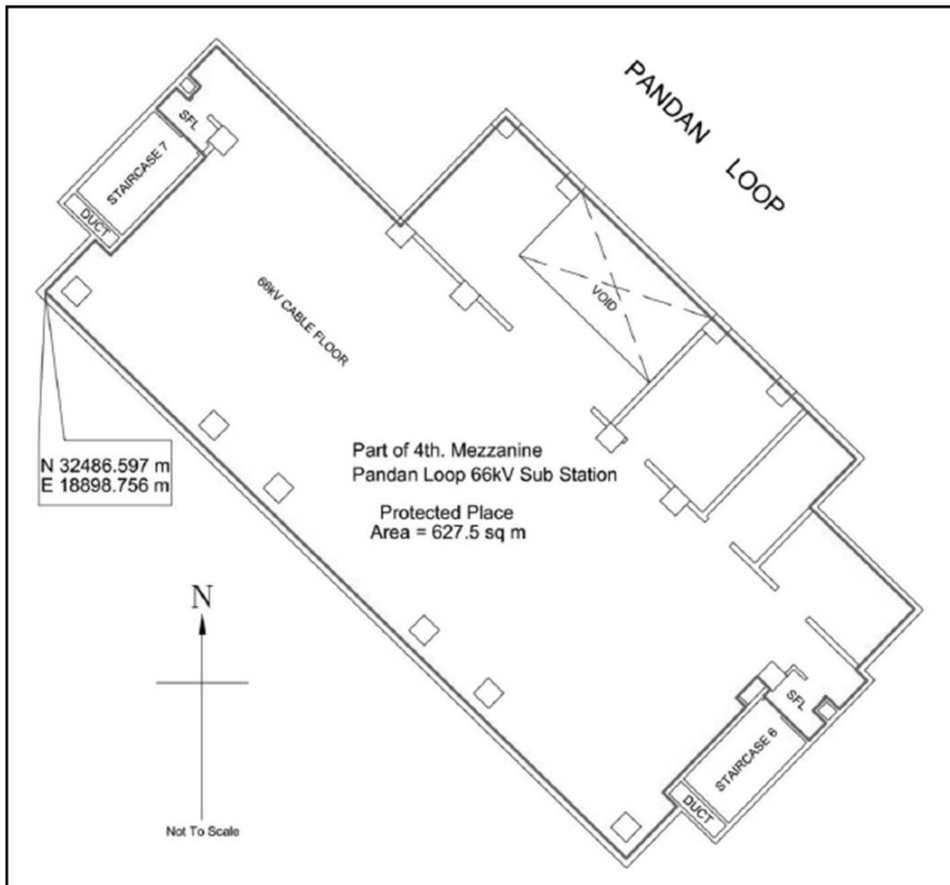

THE SCHEDULE — *continued*

<i>First column</i>	<i>Second column</i>
The Authority	Protected Place
Managing Director, SP Powergrid Ltd	(13) Part of 4th. Mezzanine Maintenance Platform Pandan Loop 66kV Sub Station.

All that area comprised in part of Lot 6855X - MK05, along Pandan Loop occupied by “Part of 4th. Mezzanine Maintenance Platform Pandan Loop 66kV Sub Station” containing an area of about 16.5 square metres and bounded approximately as follows:

Commencing at the corner of the aforesaid “Part of 4th. Mezzanine Maintenance Platform Pandan Loop 66kV Sub Station” which point is 32464.192 metres North and 18921.785 metres East of the Singapore Land Authority SVY 21 Datum, the boundaries run along successive lines of co-ordinates approximately as follows:

<i>Northing</i>	<i>Easting</i>
32464.192	18921.785
32468.105	18925.593
32467.213	18926.510
32467.105	18926.405
32466.164	18927.373
32465.397	18926.627
32465.502	18926.519
32464.742	18925.780
32464.093	18926.447
32461.814	18924.229

to the point of commencement.

The boundaries of “Part of 4th. Mezzanine Maintenance Platform Pandan Loop 66kV Sub Station” are more particularly delineated on the Survey Plan set out below.

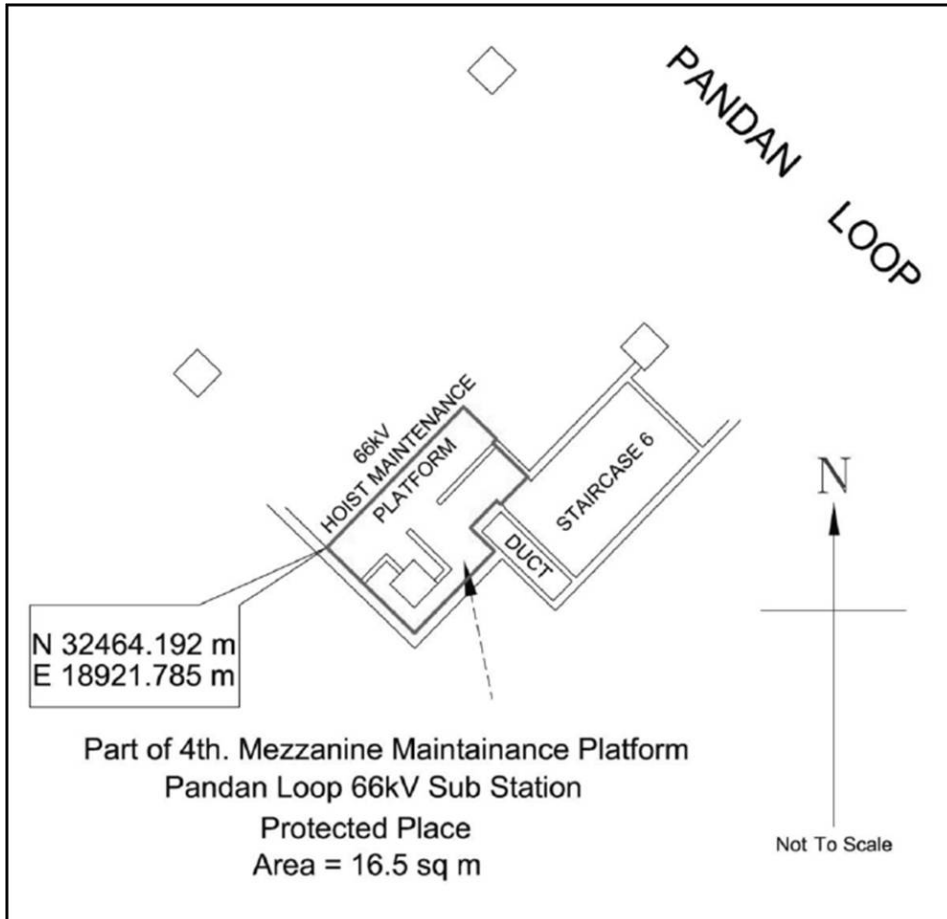
THE SCHEDULE — *continued**First column**Second column*

The Authority

Protected Place

Managing Director,
SP Powergrid Ltd

(14) Queenstown 66kV Sub Station.

All that area comprised in part of Lot 372M - MK03, along Margaret Drive occupied by “Queenstown 66kV Sub Station” containing an area of about 1998.5 square metres and bounded approximately as follows:

Commencing at the corner of the aforesaid “Queenstown 66kV Sub Station” which point is 31337.592 metres North and 24758.282 metres East of the Singapore Land Authority SVY 21 Datum, the

THE SCHEDULE — *continued*

boundaries run along successive lines of co-ordinates approximately as follows:

<i>Northing</i>	<i>Easting</i>
31337.592	24758.282
31319.740	24778.386
31311.396	24787.839
31305.731	24794.258
31295.439	24785.144
31287.797	24778.397
31280.513	24771.990
31275.126	24767.237
31284.067	24755.725
31292.074	24746.648
31300.505	24737.050
31303.931	24733.150
31305.013	24731.912
31307.524	24731.763
31317.772	24740.792
31332.171	24753.506
31336.546	24757.378

to the point of commencement.

The boundaries of “Queenstown 66kV Sub Station” are more particularly delineated on the Survey Plan set out below.

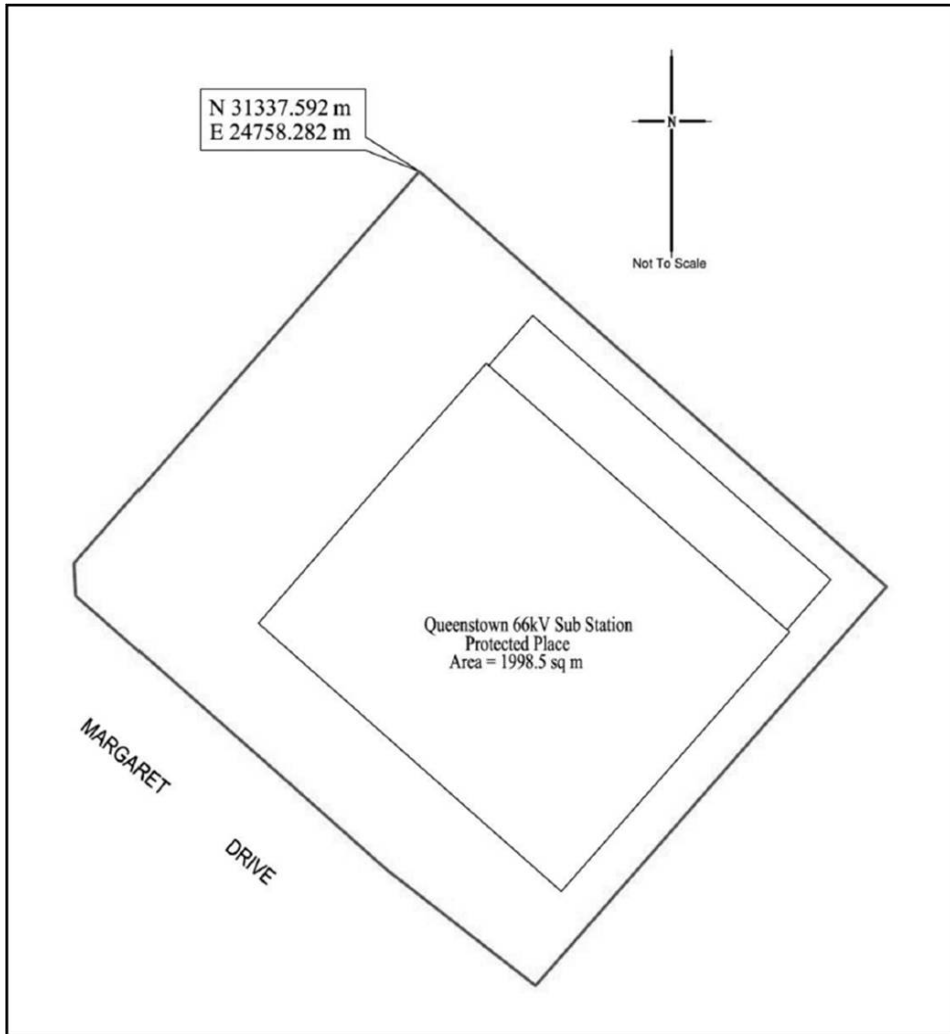
THE SCHEDULE — *continued**First column**Second column*

The Authority

Protected Place

Managing Director,
SP Powergrid Ltd

(15) Science Park III 66kV Sub Station.

All that area comprised in part of Lot 3217T - MK03, along Science Park Road occupied by "Science Park III 66kV Sub Station" containing an area of about 4168.1 square metres and bounded approximately as follows:

THE SCHEDULE — *continued*

Commencing at the corner of the aforesaid “Science Park III 66kV Sub Station” which point is 29833.406 metres North and 22274.732 metres East of the Singapore Land Authority SVY 21 Datum, the boundaries run along successive lines of co-ordinates approximately as follows:

<i>Northing</i>	<i>Easting</i>
29833.406	22274.732
29826.431	22282.570
29824.225	22284.606
29819.080	22287.815
29819.796	22289.563
29820.069	22289.991
29819.898	22290.158
29819.808	22290.004
29816.799	22293.416
29816.935	22293.543
29816.786	22293.726
29816.679	22293.632
29816.226	22294.145
29761.439	22356.233
29752.984	22344.268
29752.567	22312.857
29757.651	22296.326
29803.310	22244.501
29827.192	22262.869

to the point of commencement.

The boundaries of “Science Park III 66kV Sub Station” are more particularly delineated on the Survey Plan set out below.

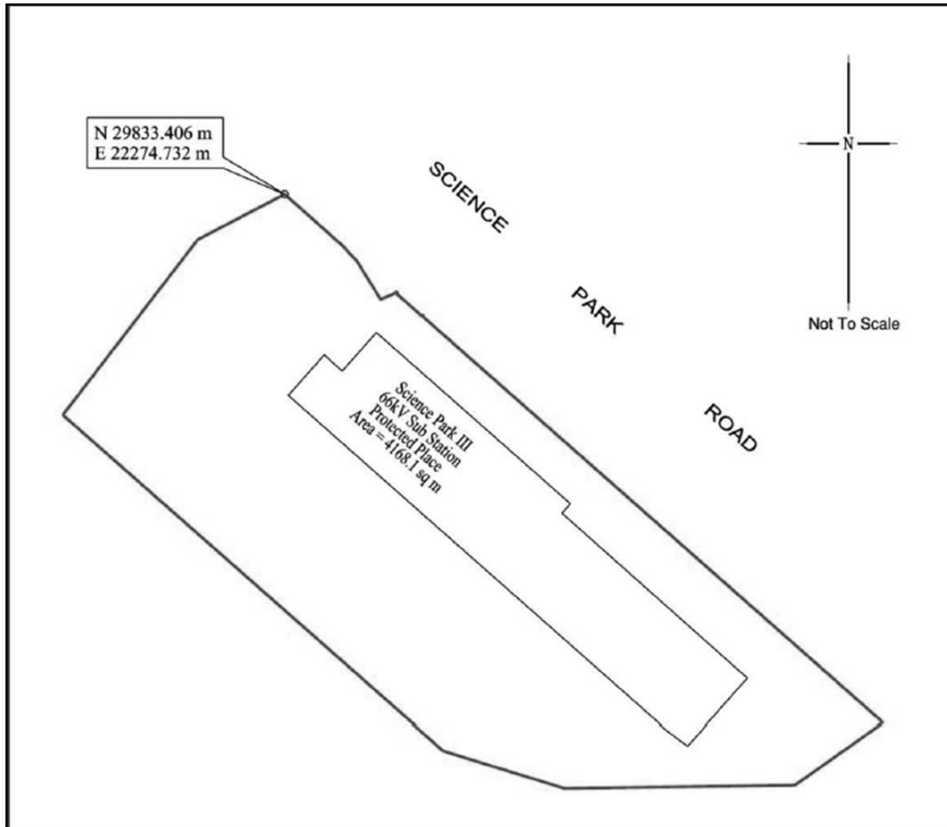
THE SCHEDULE — *continued**First column*

The Authority

Managing Director,
SP Powergrid Ltd

Second column

Protected Place

(16) Serangoon North 66kV Sub Station.

All that area comprised in part of Lot 16100K - MK18, along Serangoon North Avenue 6 occupied by “Serangoon North 66kV Sub Station” containing an area of about 4395.9 square metres and bounded approximately as follows:

Commencing at the corner of the aforesaid “Serangoon North 66kV Sub Station” which point is 39816.899 metres North and 32274.646 metres East of the Singapore Land Authority SVY 21 Datum, the boundaries run along successive lines of co-ordinates approximately as follows:

THE SCHEDULE — *continued*

<i>Northing</i>	<i>Easting</i>
39816.899	32274.646
39769.478	32271.554
39769.481	32271.504
39768.923	32271.466
39762.799	32271.047
39762.240	32271.011
39762.235	32271.090
39759.112	31170.887
39757.577	32295.238
39755.686	32325.029
39754.315	32346.764
39754.311	32346.836
39754.381	32346.840
39777.479	32348.382
39799.323	32349.832
39809.249	32350.450
39811.731	32350.605

to the point of commencement.

The boundaries of “Serangoon North 66kV Sub Station” are more particularly delineated on the Survey Plan set out below.

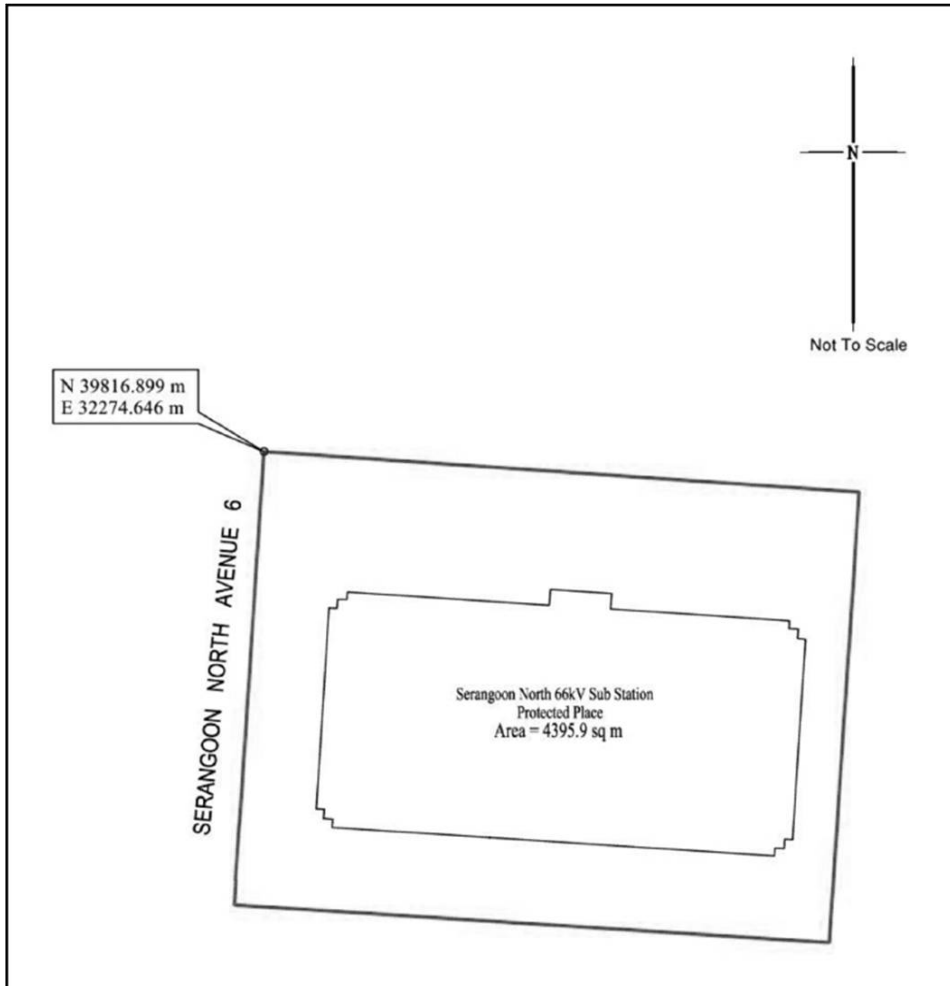
THE SCHEDULE — *continued**First column*

The Authority

Managing Director,
SP Powergrid Ltd*Second column*

Protected Place

(17) West Coast 66kV Sub Station.

All that area comprised in part of Lot 4569X - MK03, along Harbour Drive occupied by "West Coast 66kV Sub Station" containing an area of about 3408.3 square metres and bounded approximately as follows:

Commencing at the corner of the aforesaid "West Coast 66kV Sub Station" which point is 29721.786 metres North and 21515.961 metres East of the

THE SCHEDULE — *continued*

Singapore Land Authority SVY 21 Datum, the boundaries run along successive lines of co-ordinates approximately as follows:

<i>Northing</i>	<i>Easting</i>
29721.786	21515.961
29721.548	21515.819
29701.196	21503.690
29685.810	21494.542
29669.596	21484.839
29669.325	21485.485
29663.089	21486.540
29663.240	21489.040
29660.561	21493.589
29654.530	21503.785
29645.246	21519.259
29647.597	21534.671
29647.657	21534.707
29668.211	21547.028
29688.762	21559.333
29691.578	21560.969
29694.104	21562.395
29694.984	21561.140
29696.402	21559.124
29713.652	21529.721
29713.662	21529.705
29713.855	21529.818
29713.949	21529.667
29713.761	21529.557
29715.383	21526.844

THE SCHEDULE — *continued*

29715.587	21526.953
29715.875	21526.469
29715.709	21526.372
29719.773	21519.454
29719.939	21519.558
29720.230	21519.077
29720.044	21518.963
29721.668	21516.234
29721.837	21516.325
29721.933	21516.171
29721.733	21516.048

to the point of commencement.

The boundaries of “West Coast 66kV Sub Station” are more particularly delineated on the Survey Plan set out below.

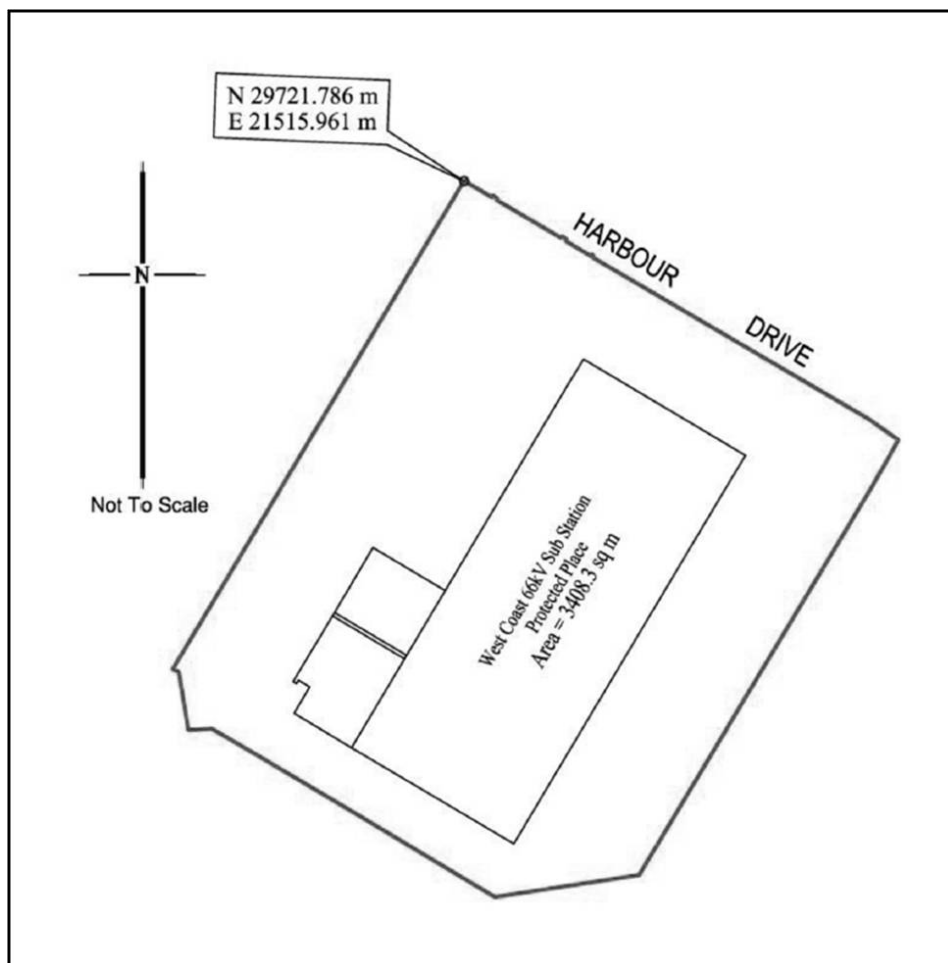
THE SCHEDULE — *continued*

Made this 26th day of April 2013.

TAN TEE HOW
*Permanent Secretary,
Ministry of Home Affairs,
Singapore.*

[MHA (PS) 12/2/02 TF 1; AG/LLRD/SL/256/2010/1 Vol. 5]