

---

---

First published in the *Government Gazette*, Electronic Edition, on 29 January 2024 at 5 pm.

## No. S 35

### INFRASTRUCTURE PROTECTION ACT 2017

#### INFRASTRUCTURE PROTECTION (PROTECTED PLACES) (NO. 3) ORDER 2024

##### ARRANGEMENT OF PARAGRAPHS

###### Paragraph

1. Citation and commencement
  2. Premises declared to be protected place
  3. Revocation
- The Schedule
- 

In exercise of the powers conferred by sections 14(1) and 19(1) of the Infrastructure Protection Act 2017, the Minister for Home Affairs makes the following Order:

#### **Citation and commencement**

1. This Order is the Infrastructure Protection (Protected Places) (No. 3) Order 2024 and comes into operation on 29 January 2024.

#### **Premises declared to be protected place**

2. The premises described in the second column of the Schedule are declared to be a protected place for the purposes of the Act, and the person specified in the first column of that Schedule is designated as the authority of the protected place.

#### **Revocation**

3. In the Protected Places (Consolidation) Order (O 2), in the Schedule, in item (33), delete paragraph 2.

---



---

THE SCHEDULE

Paragraph 2

*First column**Second column*

The Authority

Protected Place

Commanding Officer,  
Supply Base (East)

GUILLEMARD CAMP

All that area comprised in part of Lots 99167A and 6368K in Mukim No. 25 occupied by “GUILLEMARD CAMP” containing an area of about 24,596.9 square metres and bounded approximately as follows:

Commencing at the northernmost corner of “GUILLEMARD CAMP” at a point 32,616.309 metres North and 34,416.086 metres East of the Singapore Land Authority SVY21 Datum, the boundaries run along successive lines of coordinates approximately as follows:

<i>Northing</i>	<i>Easting</i>
32,616.309	34,416.086
32,587.058	34,457.956
32,579.299	34,471.860
32,556.679	34,508.167
32,556.397	34,509.731
32,556.547	34,511.860
32,558.739	34,514.939
32,570.692	34,530.222
32,571.189	34,532.619
32,558.577	34,589.641
32,557.405	34,591.547
32,556.614	34,592.116
32,554.270	34,592.606
32,522.616	34,589.215
32,520.394	34,585.082
32,477.773	34,578.617

---



---

 THE SCHEDULE — *continued*

<i>First column</i>	<i>Second column</i>
The Authority	Protected Place
32,439.356	34,572.700
32,424.012	34,575.189
32,407.237	34,577.909
32,403.211	34,558.112
32,403.015	34,556.849
32,401.917	34,551.012
32,400.023	34,541.422
32,398.565	34,533.989
32,398.371	34,533.221
32,397.892	34,531.961
32,388.800	34,487.251
32,384.563	34,466.417
32,385.205	34,465.526
32,407.530	34,460.750
32,490.178	34,443.069
32,491.251	34,442.840
32,520.726	34,436.534
32,567.491	34,426.530
32,573.867	34,425.165
32,592.280	34,421.226
32,604.676	34,418.575
32,606.043	34,418.282
32,608.450	34,417.767
32,616.309	34,416.086

to the point of commencement.

The boundaries of “GUILLEMARD CAMP” are more particularly delineated in the Survey Plan

THE SCHEDULE — *continued**First column**Second column*

The Authority

Protected Place

No. 00000-2022-L-2015-00231-GZ00-003-R filed in the office of the Director, Building and Infrastructure Programme Centre, Defence Science and Technology Agency, Singapore, a copy of which is set out below.

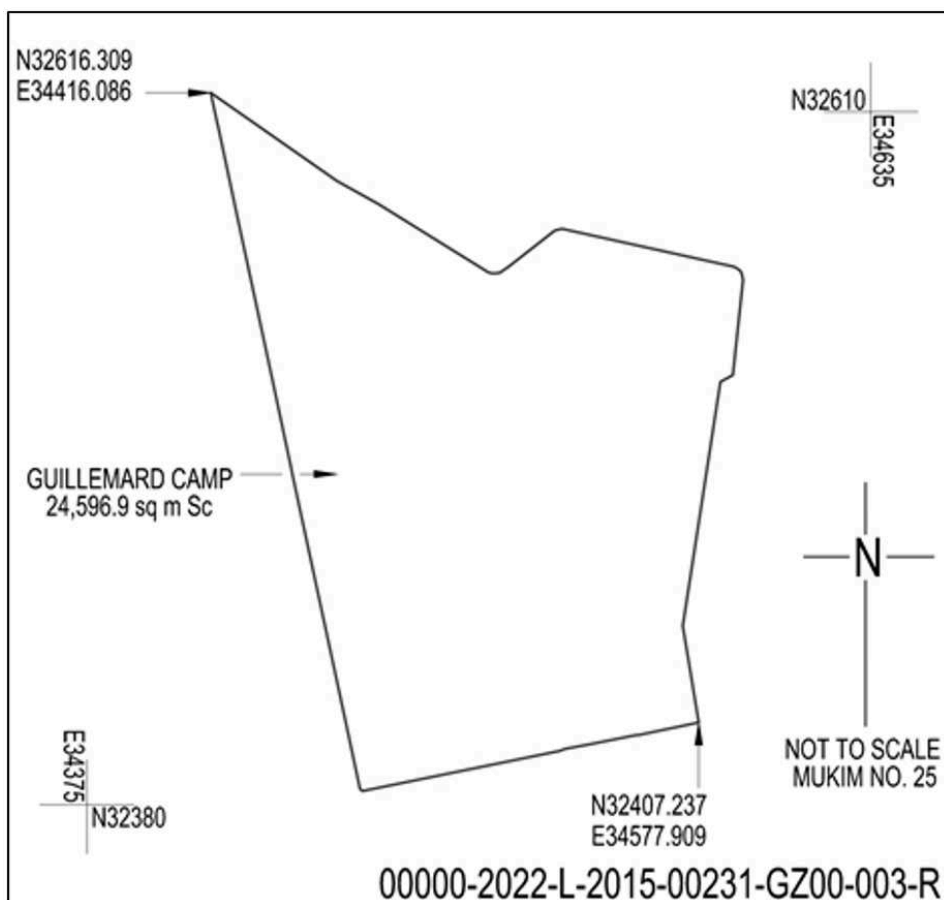

Made on 22 January 2024.

PANG KIN KEONG  
*Permanent Secretary,  
Ministry of Home Affairs,  
Singapore.*

[SPF/CPS/C/09/12/19; AG/LEGIS/SL/137B/2020/2 Vol. 15]