First published in the Government Gazette, Electronic Edition, on 6th July 2015 at 5:00 pm.

No. S 421

**PROTECTED AREAS AND PROTECTED PLACES ACT
(CHAPTER 256)**

PROTECTED PLACES (NO. 4) ORDER 2015

ARRANGEMENT OF PARAGRAPHS

Paragraph

1. Citation and commencement
2. Premises declared to be protected places

The Schedule

In exercise of the powers conferred by section 5(1) of the Protected Areas and Protected Places Act, the Minister for Home Affairs makes the following Order:

Citation and commencement

1. This Order may be cited as the Protected Places (No. 4) Order 2015 and comes into operation on 6 July 2015.

Premises declared to be protected places

2.—(1) The premises described in the second column of the Schedule are declared to be protected places for the purposes of the Act.

(2) No person may enter or remain in those premises unless the person —

- (a) is in possession of a pass-card or permit issued by the authority specified in the first column of the Schedule; or
- (b) has received the permission of an authorised officer on duty at those premises to enter those premises.

 THE SCHEDULE

<i>First column</i>	<i>Second column</i>																														
The Authority	Protected Place																														
Chief Executive Officer, Changi Airport Group (Singapore) Pte. Ltd.	(1) Changi Airport Passenger Terminal Building 3 (Basement 2) <p>All that area comprised in part of Land Lot 4594L in Mukim No. 31 (Changi) occupied by “Changi Airport Passenger Terminal Building 3 (Basement 2)” containing an area of about 23988.432 square metres and bounded approximately as follows:</p> <p>Commencing at Point A of the aforesaid “Changi Airport Passenger Terminal Building 3 (Basement 2)”, which point is 37844.073 metres North and 44980.907 metres East of the Singapore Land Authority SVY 21 Datum, the boundaries run along successive lines of coordinates approximately as follows:</p> <table border="0" style="margin-left: auto; margin-right: auto;"> <thead> <tr> <th style="text-align: center;"><i>Northing</i></th> <th style="text-align: center;"><i>Easting</i></th> </tr> </thead> <tbody> <tr><td style="text-align: center;">37844.073</td><td style="text-align: center;">44980.907</td></tr> <tr><td style="text-align: center;">37791.601</td><td style="text-align: center;">44958.644</td></tr> <tr><td style="text-align: center;">37764.454</td><td style="text-align: center;">45022.623</td></tr> <tr><td style="text-align: center;">37469.874</td><td style="text-align: center;">44897.633</td></tr> <tr><td style="text-align: center;">37496.434</td><td style="text-align: center;">44835.035</td></tr> <tr><td style="text-align: center;">37455.009</td><td style="text-align: center;">44817.458</td></tr> <tr><td style="text-align: center;">37407.747</td><td style="text-align: center;">44928.846</td></tr> <tr><td style="text-align: center;">37408.668</td><td style="text-align: center;">44929.237</td></tr> <tr><td style="text-align: center;">37408.785</td><td style="text-align: center;">44928.960</td></tr> <tr><td style="text-align: center;">37418.911</td><td style="text-align: center;">44933.257</td></tr> <tr><td style="text-align: center;">37418.794</td><td style="text-align: center;">44933.533</td></tr> <tr><td style="text-align: center;">37419.715</td><td style="text-align: center;">44933.924</td></tr> <tr><td style="text-align: center;">37419.832</td><td style="text-align: center;">44933.648</td></tr> <tr><td style="text-align: center;">37426.460</td><td style="text-align: center;">44936.460</td></tr> </tbody> </table>	<i>Northing</i>	<i>Easting</i>	37844.073	44980.907	37791.601	44958.644	37764.454	45022.623	37469.874	44897.633	37496.434	44835.035	37455.009	44817.458	37407.747	44928.846	37408.668	44929.237	37408.785	44928.960	37418.911	44933.257	37418.794	44933.533	37419.715	44933.924	37419.832	44933.648	37426.460	44936.460
<i>Northing</i>	<i>Easting</i>																														
37844.073	44980.907																														
37791.601	44958.644																														
37764.454	45022.623																														
37469.874	44897.633																														
37496.434	44835.035																														
37455.009	44817.458																														
37407.747	44928.846																														
37408.668	44929.237																														
37408.785	44928.960																														
37418.911	44933.257																														
37418.794	44933.533																														
37419.715	44933.924																														
37419.832	44933.648																														
37426.460	44936.460																														

<i>First column</i>		<i>Second column</i>
The Authority		Protected Place
	37424.445	44941.207
	37431.534	44944.215
	37433.548	44939.467
	37437.322	44941.069
	37437.205	44941.345
	37438.126	44941.736
	37438.243	44941.459
	37448.369	44945.756
	37448.252	44946.032
	37449.173	44946.423
	37449.290	44946.147
	37459.416	44950.443
	37459.299	44950.719
	37460.219	44951.110
	37460.610	44950.189
	37459.874	44949.877
	37465.302	44937.082
	37471.310	44939.630
	37471.778	44938.525
	37473.553	44939.271
	37476.031	44933.431
	37480.035	44935.130
	37477.474	44941.167
	37490.272	44946.589
	37489.882	44947.510
	37490.986	44947.978
	37491.377	44947.058
	37504.081	44952.448

<i>First column</i>		<i>Second column</i>
The Authority		Protected Place
	37503.690	44953.369
	37504.795	44953.837
	37505.186	44952.917
	37517.889	44958.307
	37517.499	44959.228
	37518.603	44959.696
	37518.994	44958.776
	37531.698	44964.166
	37531.307	44965.086
	37532.412	44965.555
	37532.802	44964.635
	37545.506	44970.025
	37545.116	44970.945
	37546.220	44971.414
	37546.611	44970.494
	37559.315	44975.884
	37558.924	44976.804
	37560.029	44977.273
	37560.419	44976.352
	37573.123	44981.743
	37572.732	44982.663
	37573.837	44983.132
	37574.228	44982.211
	37585.367	44986.938
	37585.551	44987.016
	37580.825	44998.154
	37580.963	44998.213
	37580.884	44998.397

<i>First column</i>		<i>Second column</i>
The Authority		Protected Place
	37581.989	44998.866
	37582.067	44998.682
	37582.389	44998.818
	37586.725	44988.600
	37587.646	44988.991
	37588.036	44988.070
	37600.740	44993.460
	37600.349	44994.381
	37601.454	44994.850
	37601.845	44993.929
	37614.548	44999.319
	37614.158	45000.240
	37615.263	45000.709
	37615.653	44999.788
	37628.357	45005.178
	37627.966	45006.099
	37629.071	45006.568
	37629.462	45005.647
	37642.165	45011.037
	37641.775	45011.958
	37642.879	45012.426
	37643.270	45011.506
	37655.974	45016.896
	37655.583	45017.817
	37656.688	45018.285
	37657.078	45017.365
	37669.782	45022.755
	37669.392	45023.676

<i>First column</i>		<i>Second column</i>
The Authority		Protected Place
	37670.496	45024.144
	37670.887	45023.224
	37675.674	45025.255
	37675.858	45025.333
	37675.838	45025.379
	37683.571	45028.660
	37683.200	45029.534
	37684.305	45030.003
	37684.676	45029.129
	37697.380	45034.519
	37697.009	45035.393
	37698.113	45035.862
	37698.504	45034.941
	37711.208	45040.332
	37710.817	45041.252
	37711.922	45041.721
	37712.312	45040.800
	37725.016	45046.191
	37724.625	45047.111
	37725.730	45047.580
	37726.121	45046.659
	37738.924	45052.092
	37738.524	45053.008
	37742.539	45054.710
	37744.275	45050.612
	37744.364	45050.650
	37746.111	45051.391
	37746.032	45051.577

<i>First column</i>	<i>Second column</i>
The Authority	Protected Place
37744.372	45055.489
37750.493	45058.087
37756.352	45044.278
37760.603	45046.082
37761.336	45047.895
37753.126	45067.243
37754.691	45067.906
37754.418	45068.551
37798.145	45087.104
37804.199	45072.835
37806.960	45074.007
37810.280	45066.182
37810.359	45065.998
37807.597	45064.826
37812.675	45052.859
37813.411	45053.172
37813.802	45052.251
37814.506	45050.590
37813.802	45052.251

to the point of commencement (Point A).

The boundaries of “Changi Airport Passenger Terminal Building 3 (Basement 2)” are more particularly delineated in the Survey Plan Ref. No. T3PP_B2_A set out below.

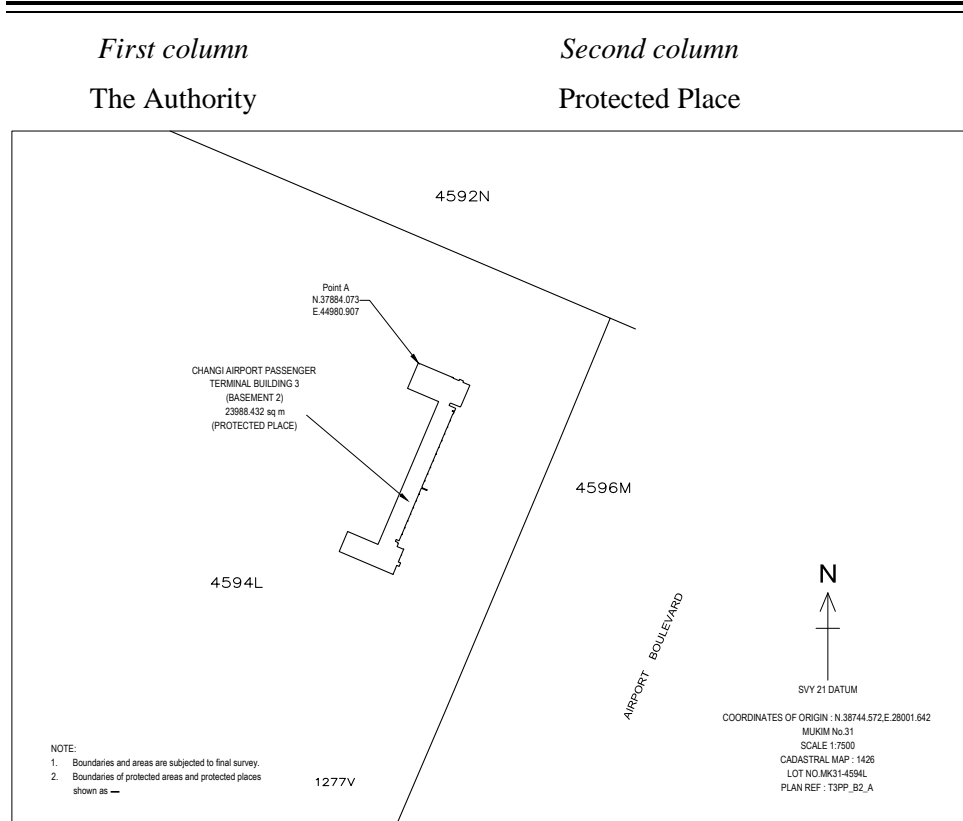

Chief Executive Officer,
Changi Airport Group
(Singapore) Pte. Ltd.

(2) Changi Airport Passenger Terminal Building 3 (Basement 1)

All that area comprised in part of Land Lot 4594L in Mukim No. 31 (Changi) occupied by “Changi Airport Passenger Terminal Building 3 (Basement 1)” containing an area of about 23976.050 square metres and bounded approximately as follows:

Commencing at Point B of the aforesaid “Changi Airport Passenger Terminal Building 3 (Basement 1)”, which point is 37844.073 metres North and 44980.907 metres East of the Singapore Land Authority SVY 21 Datum, the boundaries run along successive lines of coordinates approximately as follows:

<i>Northing</i>	<i>Easting</i>
37844.073	44980.907
37791.601	44958.644

<i>First column</i>		<i>Second column</i>
The Authority		Protected Place
	37764.454	45022.623
	37469.874	44897.633
	37496.434	44835.035
	37455.009	44817.458
	37408.138	44927.925
	37407.747	44928.846
	37408.668	44929.237
	37408.980	44928.500
	37419.107	44932.797
	37418.794	44933.533
	37419.715	44933.924
	37420.027	44933.187
	37437.517	44940.608
	37437.205	44941.345
	37438.126	44941.736
	37438.438	44940.999
	37448.565	44945.296
	37448.252	44946.032
	37449.173	44946.423
	37449.485	44945.686
	37459.611	44949.983
	37459.299	44950.719
	37460.220	44951.110
	37460.610	44950.189
	37459.874	44949.877
	37465.303	44937.082
	37477.089	44942.079
	37477.485	44941.163

<i>First column</i>		<i>Second column</i>
The Authority		Protected Place
	37490.272	44946.589
	37489.882	44947.510
	37490.987	44947.979
	37491.377	44947.058
	37504.081	44952.448
	37503.690	44953.369
	37504.795	44953.837
	37505.186	44952.917
	37517.889	44958.307
	37517.499	44959.228
	37518.603	44959.696
	37518.994	44958.776
	37531.698	44964.166
	37531.307	44965.087
	37532.412	44965.555
	37532.802	44964.635
	37545.506	44970.025
	37545.116	44970.945
	37546.220	44971.414
	37546.611	44970.494
	37559.315	44975.884
	37558.924	44976.804
	37560.029	44977.273
	37560.419	44976.352
	37573.123	44981.743
	37572.733	44982.663
	37573.837	44983.132
	37574.228	44982.211

<i>First column</i>		<i>Second column</i>
The Authority		Protected Place
	37586.932	44987.602
	37586.541	44988.522
	37587.646	44988.991
	37588.036	44988.070
	37600.740	44993.460
	37600.349	44994.381
	37601.454	44994.850
	37601.845	44993.929
	37614.548	44999.319
	37614.158	45000.240
	37615.263	45000.709
	37615.653	44999.788
	37628.357	45005.178
	37627.966	45006.099
	37629.071	45006.568
	37629.462	45005.647
	37642.165	45011.037
	37641.775	45011.958
	37642.879	45012.426
	37643.270	45011.506
	37655.974	45016.896
	37655.583	45017.817
	37656.688	45018.285
	37657.079	45017.365
	37669.782	45022.755
	37669.392	45023.676
	37670.496	45024.144
	37670.887	45023.224

<i>First column</i>		<i>Second column</i>
The Authority		Protected Place
	37683.591	45028.614
	37683.200	45029.534
	37684.305	45030.003
	37684.695	45029.083
	37697.399	45034.473
	37697.009	45035.393
	37698.113	45035.862
	37698.504	45034.942
	37711.208	45040.332
	37710.817	45041.252
	37711.922	45041.721
	37712.312	45040.800
	37725.016	45046.191
	37724.625	45047.111
	37725.730	45047.580
	37726.121	45046.659
	37738.922	45052.091
	37738.524	45053.008
	37750.778	45058.209
	37751.165	45057.285
	37760.918	45061.424
	37760.527	45062.344
	37761.448	45062.735
	37758.284	45070.191
	37798.145	45087.104
	37804.199	45072.835
	37806.963	45074.008
	37810.360	45066.001

<i>First column</i>	<i>Second column</i>
The Authority	Protected Place
37807.596	45064.828
37812.675	45052.859
37813.411	45053.172
37813.802	45052.251

to the point of commencement (Point B).

The boundaries of “Changi Airport Passenger Terminal Building 3 (Basement 1)” are more particularly delineated in the Survey Plan Ref. No. T3PP_B1_B set out below.

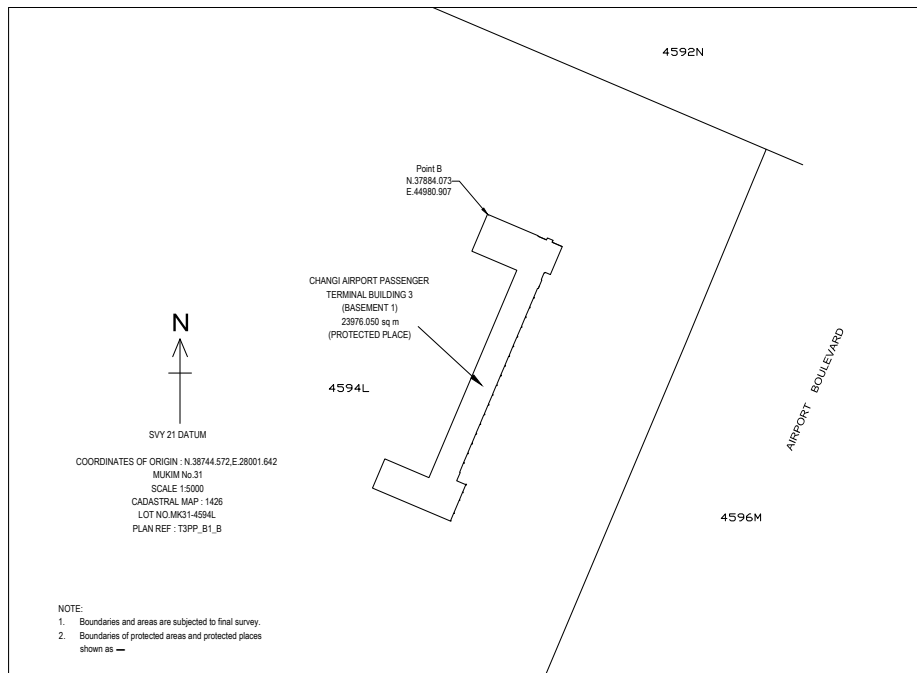

Chief Executive Officer,
Changi Airport Group
(Singapore) Pte. Ltd.

(3) Changi Airport Passenger Terminal
Building 3 (1st Storey)

All that area comprised in part of Land Lots 4594L and 1277V in Mukim No. 31 (Changi) occupied by “Changi Airport Passenger Terminal Building 3 (1st Storey)” containing an area of about 102080.003 square metres and bounded approximately as follows:

*First column**Second column*

The Authority

Protected Place

Commencing at Point C of the aforesaid “Changi Airport Passenger Terminal Building 3 (1st Storey)”, which point is 38024.068 metres North and 45178.838 metres East of the Singapore Land Authority SVY 21 Datum, the boundaries run along successive lines of coordinates approximately as follows:

<i>Northing</i>	<i>Easting</i>
38024.068	45178.838
38010.722	45173.170
38005.751	45171.059
37998.572	45168.010
37996.497	45172.894
37972.660	45162.769
37974.654	45158.070
37972.168	45157.016
37970.176	45161.707
37963.129	45158.857
37965.252	45153.859
37954.207	45149.168
37945.607	45169.417
37924.253	45160.348
37926.599	45154.826
37903.772	45145.131
37901.426	45150.654
37879.244	45141.233
37877.795	45144.645
37867.013	45140.065
37870.573	45131.683

<i>First column</i>		<i>Second column</i>
The Authority		Protected Place
	37859.357	45126.920
	37855.732	45135.455
	37849.657	45132.875
	37849.725	45132.716
	37830.046	45124.358
	37824.573	45137.244
	37817.329	45134.167
	37818.316	45131.843
	37809.434	45128.071
	37808.076	45131.269
	37805.678	45130.251
	37803.137	45136.234
	37808.020	45138.308
	37804.678	45146.177
	37800.556	45144.427
	37797.202	45152.781
	37789.102	45149.340
	37791.565	45143.542
	37787.699	45141.900
	37782.774	45153.497
	37760.814	45144.063
	37760.766	45144.178
	37743.300	45136.760
	37738.854	45147.230
	37727.809	45142.539
	37725.121	45148.867
	37617.891	45103.326
	37619.211	45100.217

<i>First column</i>		<i>Second column</i>
The Authority		Protected Place
	37611.285	45092.910
	37602.781	45086.285
	37592.594	45097.205
	37590.617	45096.365
	37592.347	45092.292
	37564.918	45080.643
	37563.188	45084.716
	37558.126	45082.566
	37561.185	45075.363
	37556.590	45073.520
	37556.234	45072.566
	37556.297	45072.418
	37547.150	45068.533
	37547.454	45062.783
	37536.756	45061.264
	37526.020	45060.633
	37524.784	45063.543
	37418.590	45018.441
	37420.212	45014.621
	37409.167	45009.930
	37415.812	44994.283
	37397.193	44986.375
	37396.020	44989.136
	37362.405	44974.860
	37365.337	44967.957
	37366.028	44968.250
	37374.914	44947.327
	37349.019	44936.329

<i>First column</i>		<i>Second column</i>
The Authority		Protected Place
	37350.578	44932.660
	37349.000	44931.997
	37350.109	44929.402
	37341.852	44925.917
	37345.052	44918.382
	37335.924	44914.552
	37335.924	44914.554
	37292.220	44895.944
	37294.409	44890.789
	37255.221	44874.341
	37254.548	44875.924
	37248.842	44873.500
	37248.612	44874.042
	37238.395	44869.703
	37238.625	44869.161
	37237.981	44868.888
	37240.057	44864.113
	37241.741	44864.825
	37243.731	44860.140
	37242.375	44859.564
	37242.727	44858.735
	37240.794	44857.914
	37234.941	44871.725
	37214.957	44863.238
	37218.863	44854.043
	37196.034	44844.347
	37196.887	44842.337
	37190.741	44839.739

<i>First column</i>		<i>Second column</i>
The Authority		Protected Place
	37189.152	44843.354
	37185.046	44841.623
	37183.073	44846.220
	37172.028	44841.528
	37180.862	44820.727
	37147.727	44806.654
	37141.472	44821.381
	37118.644	44811.689
	37116.081	44817.726
	37094.712	44808.691
	37093.460	44811.637
	37071.370	44802.255
	37075.204	44793.230
	37063.422	44788.227
	37061.075	44793.754
	37050.030	44789.063
	37049.781	44789.630
	37017.396	44775.855
	37019.976	44769.780
	36981.318	44753.361
	36979.617	44757.368
	36975.252	44755.514
	36974.608	44757.030
	36972.714	44756.226
	36971.227	44759.726
	36949.689	44750.578
	36947.032	44756.835
	36941.694	44754.567

<i>First column</i>		<i>Second column</i>
The Authority		Protected Place
	36940.345	44757.743
	36945.131	44759.776
	36941.359	44768.658
	36936.573	44766.625
	36932.937	44775.185
	36921.546	44770.320
	36920.364	44773.104
	36915.657	44771.105
	36913.859	44775.338
	36892.321	44766.191
	36895.213	44759.382
	36874.566	44750.613
	36877.278	44744.227
	36870.211	44738.350
	36863.515	44732.053
	36856.677	44724.579
	36850.749	44716.364
	36840.751	44699.813
	36831.548	44682.808
	36821.645	44658.941
	36815.111	44633.942
	36813.445	44603.669
	36816.245	44573.479
	36856.924	44572.148
	36913.825	44683.716
	36914.563	44683.340
	36914.964	44684.127
	36915.066	44684.598

<i>First column</i>		<i>Second column</i>
The Authority		Protected Place
	36914.936	44685.063
	36920.517	44696.021
	36921.258	44695.991
	36921.816	44696.480
	36926.706	44706.081
	36927.750	44707.468
	36929.207	44708.414
	36939.824	44712.923
	36940.360	44713.469
	36940.353	44714.234
	36940.187	44714.625
	36941.444	44715.159
	36942.646	44712.329
	37058.836	44761.675
	37057.624	44764.529
	37071.292	44770.334
	37071.468	44769.920
	37071.100	44769.763
	37071.237	44769.441
	37081.713	44773.884
	37082.927	44774.404
	37082.614	44775.142
	37085.195	44776.238
	37086.407	44773.385
	37202.423	44822.657
	37201.211	44825.511
	37214.833	44831.296
	37215.009	44830.882

<i>First column</i>		<i>Second column</i>
The Authority		Protected Place
	37214.733	44830.765
	37214.870	44830.443
	37226.835	44835.526
	37226.835	44835.524
	37226.698	44835.846
	37226.423	44835.729
	37226.247	44836.143
	37228.824	44837.238
	37230.036	44834.385
	37351.532	44885.985
	37350.320	44888.838
	37369.189	44896.852
	37371.672	44891.007
	37373.133	44891.628
	37465.734	44821.876
	37496.703	44835.029
	37477.861	44879.393
	37478.588	44879.729
	37474.083	44890.337
	37777.824	45019.337
	37783.121	45006.866
	37783.857	45007.178
	37801.918	44964.655
	37832.887	44977.807
	37846.992	45092.877
	37848.454	45093.498
	37846.284	45098.607
	37859.170	45104.080

<i>First column</i>		<i>Second column</i>
The Authority		Protected Place
	37858.858	45104.816
	37859.327	45105.015
	37860.497	45102.260
	37965.956	45147.049
	37964.783	45149.810
	37966.868	45150.696
	37967.024	45150.327
	37966.702	45150.190
	37966.858	45149.823
	37978.824	45154.905
	37978.668	45155.272
	37978.345	45155.136
	37978.189	45155.504
	38025.452	45175.578

to the point of commencement (Point C).

The boundaries of “Changi Airport Passenger Terminal Building 3 (1st Storey)” are more particularly delineated in the Survey Plan Ref. No. T3PP_S1_C set out below.

First column
The Authority

Second column
Protected Place

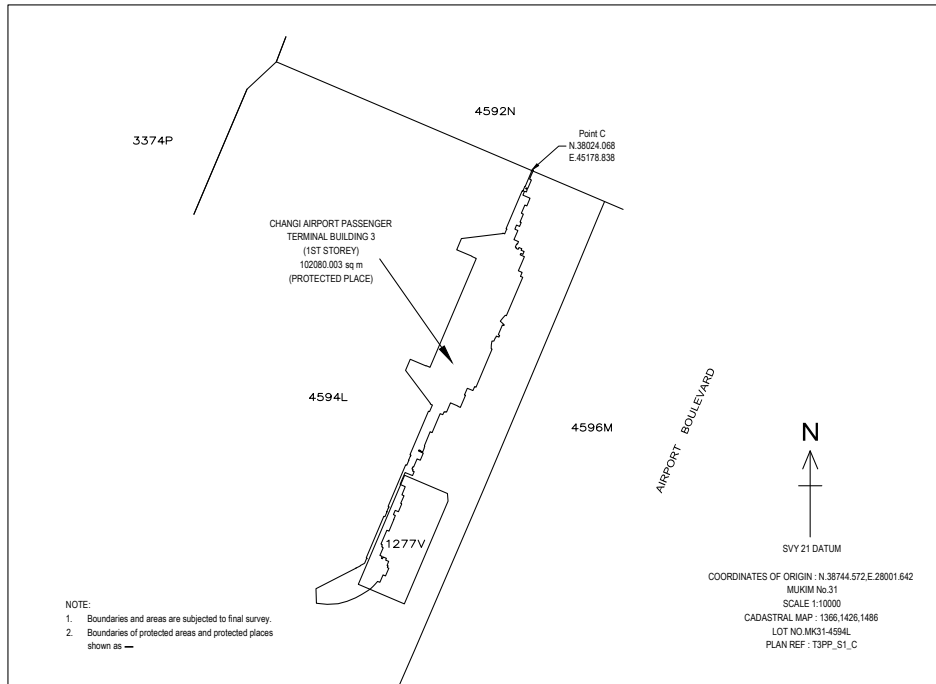

Chief Executive Officer,
Changi Airport Group
(Singapore) Pte. Ltd.

(4) Changi Airport Passenger Terminal Building 3 (1st Storey Open Area)

All that area comprised in part of Land Lots 3788V and 1277V in Mukim No.31 (Changi) occupied by “Changi Airport Passenger Terminal Building 3 (1st Storey Open Area)” containing an area of about 128202.881 square metres and bounded approximately as follows:

Commencing at Point D of the aforesaid “Changi Airport Passenger Terminal Building 3 (1st Storey Open Area)”, which point is 36914.861 metres North and 44772.980 metres East of the Singapore Land Authority SVY 21 Datum, the boundaries run along successive lines of coordinates approximately as follows:

<i>First column</i>	<i>Second column</i>	
The Authority	Protected Place	
	<i>Northing</i>	<i>Easting</i>
	36914.861	44772.980
	36918.658	44774.593
	36885.182	44814.032
	36882.343	44815.203
	36879.207	44816.000
	36858.960	44819.618
	36841.500	44822.530
	36815.448	44826.898
	36813.043	44827.444
	36808.201	44828.487
	36803.576	44829.114
	36798.701	44829.478
	36791.472	44829.068
	36786.707	44828.473
	36782.057	44827.535
	36777.427	44826.091
	36772.958	44824.464
	36768.383	44822.543
	36754.184	44816.588
	36740.743	44810.895
	36727.280	44805.221
	36713.940	44799.568
	36702.733	44794.709
	36698.478	44792.586
	36692.248	44788.897
	36688.386	44785.999
	36684.652	44782.831

<i>First column</i>		<i>Second column</i>
The Authority		Protected Place
	36682.822	44781.103
	36679.514	44777.510
	36675.123	44771.863
	36672.476	44767.740
	36671.196	44765.562
	36662.449	44748.360
	36656.975	44737.534
	36648.101	44720.212
	36645.693	44716.046
	36642.726	44712.159
	36639.147	44708.845
	36635.079	44706.255
	36630.619	44704.257
	36626.031	44702.963
	36618.741	44702.508
	36609.372	44704.769
	36601.098	44709.877
	36595.935	44714.924
	36590.459	44727.952
	36587.803	44726.778
	36581.221	44742.130
	36566.031	44736.377
	36564.060	44738.705
	36542.429	44729.514
	36509.769	44715.587
	36490.736	44707.522
	36466.282	44694.074
	36454.400	44681.503

<i>First column</i>		<i>Second column</i>
The Authority		Protected Place
	36449.074	44679.180
	36432.694	44672.247
	36403.007	44659.687
	36370.319	44645.737
	36343.530	44635.070
	36329.257	44628.368
	36335.831	44612.088
	36342.303	44596.828
	36348.996	44581.048
	36355.871	44564.714
	36432.480	44381.485
	36816.245	44573.479
	36813.445	44603.669
	36815.111	44633.942
	36821.645	44658.941
	36831.548	44682.808
	36840.751	44699.813
	36850.749	44716.364
	36856.677	44724.579
	36863.515	44732.053
	36870.211	44738.350
	36877.278	44744.227
	36874.566	44750.613
	36895.213	44759.382
	36892.321	44766.191
	36913.859	44775.338

to the point of commencement (Point D).

First column

The Authority

Second column

Protected Place

The boundaries of “Changi Airport Passenger Terminal Building 3 (1st Storey Open Area)” are more particularly delineated in the Survey Plan Ref. No. T3PP_S1_D set out below.

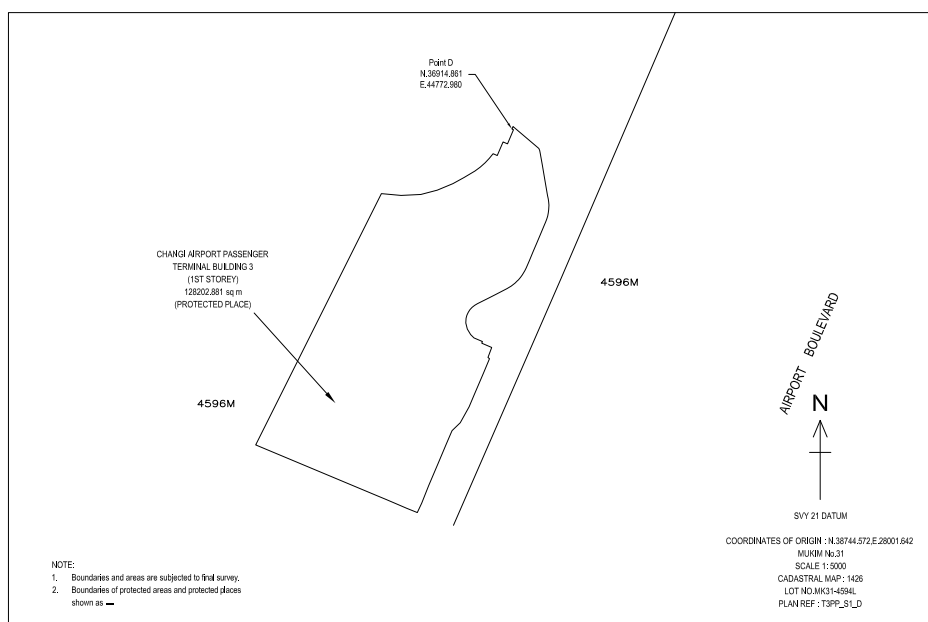

Chief Executive Officer, (5) Changi Airport Passenger Terminal Building 3 (2nd Storey)
Changi Airport Group
(Singapore) Pte. Ltd.

All that area comprised in part of Land Lots 4594L and 1277V in Mukim No. 31 (Changi) occupied by “Changi Airport Passenger Terminal Building 3 (2nd Storey)” containing an area of about 101740.525 square metres and bounded approximately as follows:

Commencing at Point E of the aforesaid “Changi Airport Passenger Terminal Building 3 (2nd Storey)”, which point is 38268.492 metres North and 48994.034 metres East of the Singapore Land Authority SVY 21 Datum, the boundaries run along successive lines of coordinates approximately as follows:

<i>First column</i>	<i>Second column</i>	
The Authority	Protected Place	
	<i>Northing</i>	<i>Easting</i>
	38268.492	48994.034
	38234.357	48979.533
	38200.291	48965.065
	38200.564	48964.420
	38191.084	48960.394
	38190.811	48961.039
	38131.811	48935.981
	38132.085	48935.337
	38122.605	48931.311
	38122.331	48931.955
	38062.779	48906.663
	38062.466	48907.399
	38059.895	48906.307
	38060.481	48904.926
	38051.916	48901.289
	38051.642	48901.933
	37978.527	48870.881
	37978.840	48870.145
	37966.874	48865.064
	37966.562	48865.799
	37964.785	48865.045
	37965.958	48862.283
	37860.491	48817.491
	37859.318	48820.252
	37857.063	48819.294
	37857.376	48818.558
	37846.285	48813.848

<i>First column</i>		<i>Second column</i>
The Authority		Protected Place
	37848.454	48808.739
	37848.086	48808.583
	37848.027	48808.721
	37847.107	48808.330
	37847.205	48808.100
	37846.978	48808.004
	37832.887	48693.048
	37801.917	48679.895
	37783.076	48724.260
	37782.339	48723.947
	37778.098	48733.934
	37757.848	48725.334
	37757.838	48725.358
	37757.809	48725.426
	37756.889	48725.035
	37756.654	48725.587
	37743.768	48720.114
	37744.003	48719.562
	37743.082	48719.171
	37742.848	48719.724
	37729.962	48714.251
	37730.197	48713.699
	37729.276	48713.308
	37729.041	48713.860
	37716.155	48708.387
	37716.390	48707.835
	37715.470	48707.444
	37715.235	48707.996

<i>First column</i>		<i>Second column</i>
The Authority		Protected Place
	37702.349	48702.524
	37702.583	48701.971
	37701.663	48701.580
	37701.428	48702.133
	37688.542	48696.660
	37688.777	48696.108
	37687.857	48695.717
	37687.622	48696.269
	37674.736	48690.796
	37674.971	48690.244
	37674.050	48689.853
	37673.816	48690.405
	37660.930	48684.933
	37661.164	48684.380
	37660.244	48683.990
	37660.009	48684.542
	37647.123	48679.069
	37647.358	48678.517
	37646.437	48678.126
	37646.203	48678.678
	37633.317	48673.205
	37633.551	48672.653
	37632.631	48672.262
	37632.397	48672.814
	37619.511	48667.342
	37619.745	48666.789
	37618.825	48666.399
	37618.590	48666.951

<i>First column</i>		<i>Second column</i>
The Authority		Protected Place
	37605.704	48661.478
	37605.939	48660.926
	37605.018	48660.535
	37604.783	48661.087
	37591.897	48655.614
	37592.132	48655.062
	37591.211	48654.671
	37590.977	48655.224
	37578.091	48649.751
	37578.325	48649.198
	37577.405	48648.807
	37577.171	48649.360
	37564.285	48643.887
	37564.519	48643.335
	37563.599	48642.944
	37563.364	48643.496
	37550.478	48638.023
	37550.713	48637.471
	37549.792	48637.080
	37549.558	48637.632
	37536.672	48632.160
	37536.906	48631.607
	37535.986	48631.217
	37535.752	48631.769
	37522.866	48626.296
	37523.100	48625.744
	37522.179	48625.353
	37521.945	48625.905

<i>First column</i>		<i>Second column</i>
The Authority		Protected Place
	37509.059	48620.433
	37509.294	48619.880
	37508.373	48619.489
	37508.139	48620.042
	37495.345	48614.608
	37495.618	48613.964
	37474.356	48604.934
	37478.597	48594.947
	37477.861	48594.634
	37496.703	48550.270
	37465.734	48537.117
	37373.226	48606.799
	37372.999	48606.703
	37372.902	48606.933
	37371.981	48606.542
	37372.037	48606.412
	37371.668	48606.255
	37369.189	48612.093
	37350.320	48604.079
	37351.493	48601.318
	37229.986	48549.713
	37228.814	48552.475
	37226.523	48551.502
	37226.835	48550.765
	37214.870	48545.684
	37214.557	48546.420
	37201.211	48540.752
	37202.384	48537.990

<i>First column</i>		<i>Second column</i>
The Authority		Protected Place
	37086.368	48488.718
	37085.195	48491.479
	37082.982	48490.539
	37083.295	48489.803
	37071.304	48484.722
	37070.996	48485.449
	37057.624	48479.770
	37058.797	48477.008
	36942.606	48427.662
	36941.434	48430.423
	36939.395	48429.557
	36939.718	48428.797
	36929.167	48424.344
	36928.854	48425.081
	36928.735	48425.030
	36925.059	48426.902
	36918.910	48414.828
	36921.271	48413.625
	36857.285	48287.985
	36816.143	48289.331
	36815.255	48295.250
	36814.539	48301.226
	36814.001	48307.123
	36813.645	48312.917
	36813.450	48318.626
	36813.415	48324.275
	36813.528	48329.827
	36813.642	48332.575

<i>First column</i>		<i>Second column</i>
The Authority		Protected Place
	36813.790	48335.305
	36813.974	48338.017
	36814.173	48340.546
	36814.581	48344.699
	36815.139	48349.330
	36815.519	48351.277
	36816.047	48353.813
	36816.610	48356.341
	36817.204	48358.866
	36817.830	48361.353
	36818.487	48363.823
	36819.177	48366.278
	36819.897	48368.716
	36820.649	48371.139
	36821.432	48373.546
	36822.245	48375.937
	36823.090	48378.330
	36824.869	48383.035
	36825.806	48385.363
	36826.769	48387.678
	36827.764	48389.977
	36828.788	48392.261
	36831.458	48397.868
	36834.069	48402.904
	36834.365	48403.468
	36835.544	48405.673
	36836.735	48407.872
	36837.941	48410.064

<i>First column</i>		<i>Second column</i>
The Authority		Protected Place
	36839.160	48412.248
	36840.392	48414.426
	36841.638	48416.597
	36842.899	48418.762
	36844.172	48420.918
	36845.454	48423.060
	36846.762	48425.216
	36848.077	48427.352
	36849.406	48429.482
	36850.750	48431.605
	36852.129	48433.699
	36853.571	48435.759
	36855.091	48437.807
	36856.680	48439.826
	36860.060	48443.736
	36863.713	48447.487
	36865.600	48449.340
	36867.603	48451.228
	36869.655	48453.096
	36871.616	48454.819
	36873.629	48456.523
	36875.999	48458.457
	36877.284	48459.454
	36874.566	48465.854
	36895.489	48474.740
	36894.317	48477.500
	36894.501	48477.578
	36893.797	48479.235

<i>First column</i>		<i>Second column</i>
The Authority		Protected Place
	36905.979	48484.409
	36906.683	48482.752
	36937.209	48495.717
	36943.463	48480.990
	36910.570	48467.020
	36911.809	48464.102
	36955.747	48482.763
	36959.103	48474.863
	36915.164	48456.202
	36916.235	48453.680
	36949.346	48467.742
	36949.534	48467.301
	37323.885	48626.289
	37323.699	48626.726
	37356.868	48640.813
	37355.800	48643.329
	37322.677	48629.261
	37319.317	48637.172
	37352.440	48651.240
	37351.182	48654.204
	37348.477	48660.573
	37315.353	48646.506
	37312.633	48652.879
	37367.778	48676.300
	37367.962	48676.378
	37362.567	48689.080
	37363.488	48689.471
	37363.097	48690.391

<i>First column</i>		<i>Second column</i>
The Authority		Protected Place
	37373.222	48694.691
	37373.612	48693.771
	37374.533	48694.162
	37374.142	48695.082
	37384.267	48699.382
	37384.658	48698.462
	37385.578	48698.852
	37385.187	48699.773
	37395.312	48704.073
	37395.703	48703.153
	37396.623	48703.543
	37396.232	48704.464
	37413.640	48711.859
	37414.072	48710.843
	37436.241	48720.259
	37451.897	48683.397
	37453.001	48683.866
	37453.705	48682.210
	37461.068	48685.337
	37460.365	48686.994
	37466.163	48689.456
	37462.076	48699.081
	37462.306	48699.179
	37462.434	48698.877
	37466.298	48696.011
	37469.058	48699.731
	37463.397	48703.941
	37463.425	48703.979

<i>First column</i>		<i>Second column</i>
The Authority		Protected Place
	37458.419	48707.692
	37456.371	48712.513
	37554.857	48754.341
	37564.649	48731.284
	37567.687	48732.574
	37569.491	48728.071
	37547.861	48718.884
	37545.283	48717.790
	37543.678	48721.570
	37543.763	48721.606
	37543.648	48721.876
	37532.721	48717.235
	37534.031	48714.097
	37534.400	48714.254
	37534.790	48713.333
	37533.226	48712.669
	37536.197	48705.674
	37555.433	48713.844
	37553.401	48718.630
	37572.247	48726.634
	37570.821	48729.992
	37575.515	48731.985
	37574.097	48735.324
	37615.010	48752.699
	37616.428	48749.361
	37621.122	48751.355
	37622.548	48747.997
	37642.038	48756.275

<i>First column</i>		<i>Second column</i>
The Authority		Protected Place
	37645.048	48749.187
	37651.176	48751.790
	37650.199	48754.091
	37662.992	48759.524
	37660.021	48766.519
	37658.128	48765.715
	37657.737	48766.636
	37658.105	48766.792
	37656.758	48769.914
	37645.823	48765.270
	37645.883	48765.132
	37622.467	48755.160
	37622.535	48754.999
	37621.845	48754.706
	37621.766	48754.890
	37621.674	48754.851
	37621.440	48755.403
	37624.477	48756.693
	37614.685	48779.750
	37713.171	48821.577
	37715.219	48816.756
	37714.149	48808.076
	37713.595	48803.563
	37718.153	48802.970
	37718.774	48807.745
	37718.645	48808.048
	37718.876	48808.145
	37723.100	48798.198

<i>First column</i>		<i>Second column</i>
The Authority		Protected Place
	37726.414	48799.606
	37727.743	48796.476
	37736.763	48800.307
	37739.708	48801.558
	37740.080	48800.684
	37741.966	48801.485
	37743.159	48798.678
	37750.292	48801.707
	37747.477	48808.334
	37736.432	48803.643
	37736.217	48804.150
	37737.230	48804.579
	37722.512	48839.234
	37784.273	48865.464
	37792.568	48845.932
	37797.731	48846.376
	37801.135	48845.880
	37808.047	48845.138
	37808.565	48845.359
	37807.978	48846.741
	37816.749	48850.466
	37817.727	48848.163
	37853.746	48863.460
	37856.579	48856.791
	37831.699	48846.223
	37833.263	48842.538
	37858.144	48853.105
	37858.514	48852.233

<i>First column</i>		<i>Second column</i>
The Authority		Protected Place
	37900.199	48869.936
	37900.277	48869.752
	37944.366	48888.477
	37944.288	48888.660
	37988.960	48907.416
	37988.851	48907.673
	38028.087	48924.391
	38028.116	48924.321
	38036.868	48928.008
	38036.295	48929.366
	38036.663	48929.522
	38036.506	48929.890
	38044.895	48933.453
	38045.051	48933.085
	38045.419	48933.241
	38047.120	48929.237
	38126.356	48962.889
	38124.656	48966.893
	38125.024	48967.050
	38124.868	48967.418
	38133.256	48970.980
	38133.412	48970.612
	38133.780	48970.769
	38135.481	48966.765
	38202.249	48995.116
	38200.547	48999.125
	38213.385	49004.577
	38213.229	49004.945

<i>First column</i>		<i>Second column</i>
The Authority		Protected Place
	38221.617	49008.508
	38221.773	49008.140
	38222.142	49008.296
	38224.165	49003.532
	38226.390	49004.477
	38226.360	49004.546
	38226.680	49005.249
	38228.854	49006.172
	38229.581	49005.918
	38229.612	49005.846
	38230.578	49006.257
	38230.146	49007.275
	38228.213	49006.454
	38224.092	49016.155
	38253.744	49028.751

to the point of commencement (Point E).

The boundaries of “Changi Airport Passenger Terminal Building 3 (2nd Storey)” are more particularly delineated in the Survey Plan Ref. No. T3PP_S2_E set out below.

First column
The Authority

Second column
Protected Place

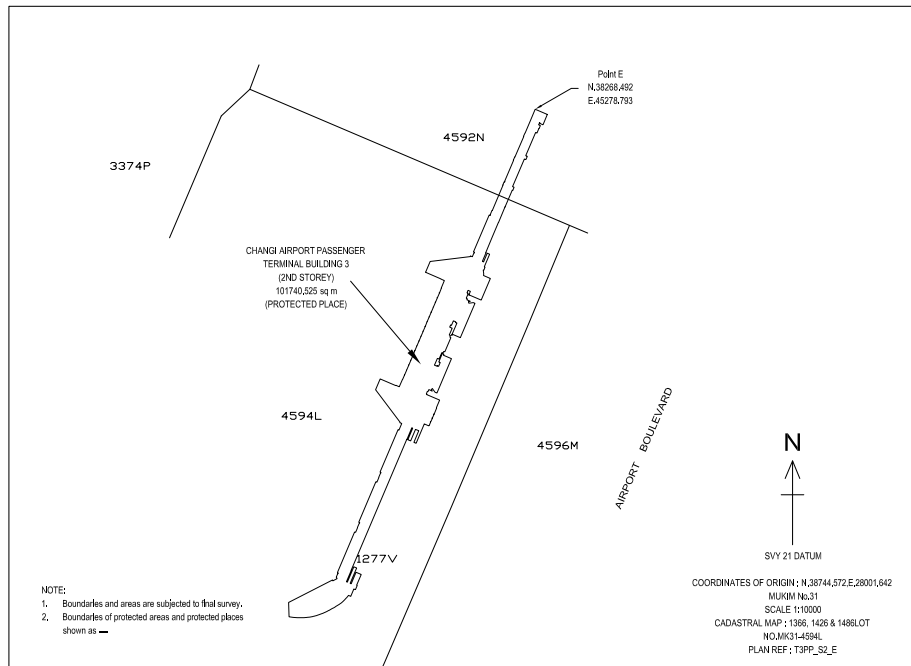

Chief Executive Officer, (6) Changi Airport Passenger Terminal
Changi Airport Group Building 3 (3rd Storey)
(Singapore) Pte. Ltd.

All that area comprised in part of Land Lots 4594L, 3788V and 1277V in Mukim No. 31 (Changi) occupied by “Changi Airport Passenger Terminal Building 3 (3rd Storey)” containing:

(a) An area of about 18488.978 square metres and bounded approximately as follows:

Commencing at Point F of the aforesaid “Changi Airport Passenger Terminal Building 3 (3rd Storey)”, which point is 37835.697 metres North and 45031.359 metres East of the Singapore Land Authority SVY 21 Datum, the boundaries run along successive lines of coordinates approximately as follows:

<i>First column</i>	<i>Second column</i>	
The Authority	Protected Place	
	<i>Northing</i>	<i>Easting</i>
	37835.697	45031.359
	37842.829	45091.109
	37848.461	45093.484
	37843.529	45105.096
	37831.471	45099.975
	37832.333	45097.945
	37830.345	45096.488
	37827.836	45094.721
	37825.302	45093.013
	37822.743	45091.363
	37820.160	45089.771
	37817.553	45088.236
	37814.921	45086.757
	37812.266	45085.334
	37809.587	45083.967
	37806.885	45082.656
	37804.159	45081.400
	37801.409	45080.200
	37798.648	45079.027
	37795.887	45077.854
	37793.126	45076.682
	37790.364	45075.509
	37787.603	45074.336
	37784.842	45073.163
	37782.080	45071.991
	37779.319	45070.818
	37776.558	45069.645

<i>First column</i>	<i>Second column</i>
The Authority	Protected Place
	37773.797 45068.473
	37771.035 45067.300
	37769.685 45066.732
	37769.927 45064.738
	37769.811 45061.113
	37769.299 45058.477
	37768.591 45056.322
	37767.755 45054.480
	37766.822 45052.869
	37765.812 45051.441
	37765.083 45050.555
	37764.254 45050.285
	37760.755 45061.046
	37757.617 45060.026
	37761.162 45049.122
	37760.471 45048.898
	37759.652 45051.418
	37756.846 45050.506
	37757.682 45047.934
	37757.313 45047.814
	37752.399 45059.386
	37749.843 45058.360
	37749.963 45058.079
	37738.456 45053.191
	37730.825 45046.936
	37722.515 45038.430
	37718.325 45032.565
	37708.248 45028.132

<i>First column</i>	<i>Second column</i>	
The Authority	Protected Place	
	37694.616	45021.375
	37684.649	45015.809
	37673.255	45015.210
	37673.282	45014.711
	37661.022	45014.066
	37661.222	45010.271
	37673.481	45010.916
	37673.513	45010.317
	37666.247	45009.935
	37666.268	45009.535
	37663.521	45009.390
	37663.677	45006.444
	37666.424	45006.590
	37666.439	45006.311
	37661.060	45006.009
	37655.676	45006.160
	37650.649	45006.713
	37644.960	45007.807
	37639.431	45004.656
	37633.612	45000.232
	37629.250	44995.962
	37635.353	44981.590
	37600.175	44966.650
	37594.071	44981.021
	37586.407	44980.742
	37579.733	44979.477
	37574.639	44977.941
	37571.475	44973.087

<i>First column</i>	<i>Second column</i>	
The Authority	Protected Place	
	37566.373	44966.871
	37560.801	44961.446
	37560.610	44961.650
	37562.622	44963.526
	37560.611	44965.684
	37558.599	44963.807
	37558.326	44964.100
	37553.006	44959.137
	37552.596	44959.576
	37561.573	44967.950
	37558.981	44970.729
	37550.004	44962.354
	37549.663	44962.720
	37541.321	44954.937
	37532.104	44952.192
	37522.690	44949.019
	37514.035	44945.737
	37505.879	44942.338
	37498.749	44943.396
	37491.875	44943.596
	37483.553	44943.075
	37477.058	44942.175
	37465.550	44937.288
	37465.452	44937.518
	37462.918	44936.442
	37467.828	44924.868
	37467.491	44924.688
	37466.221	44927.076

<i>First column</i>	<i>Second column</i>	
The Authority	Protected Place	
	37463.616	44925.690
	37464.884	44923.307
	37464.243	44922.966
	37458.835	44933.132
	37455.921	44931.582
	37461.236	44921.592
	37460.502	44921.202
	37458.157	44921.454
	37453.349	44922.913
	37450.110	44924.804
	37447.423	44927.041
	37445.632	44929.100
	37413.909	44915.627
	37403.337	44911.358
	37392.481	44908.195
	37379.662	44905.461
	37379.401	44906.023
	37367.450	44900.947
	37366.785	44902.512
	37367.752	44902.923
	37366.462	44905.961
	37362.662	44904.346
	37360.771	44906.133
	37344.059	44888.998
	37336.813	44885.921
	37337.358	44884.637
	37342.442	44886.796
	37349.446	44889.716

<i>First column</i>	<i>Second column</i>	
The Authority	Protected Place	
	37350.321	44888.838
	37369.189	44896.852
	37371.678	44890.992
	37372.046	44891.148
	37371.980	44891.304
	37372.902	44891.692
	37372.999	44891.462
	37377.659	44893.441
	37425.475	44856.865
	37477.962	44879.156
	37469.066	44900.103
	37545.277	44932.470
	37549.558	44922.392
	37591.898	44940.373
	37587.618	44950.452
	37655.729	44979.379
	37660.010	44969.301
	37702.349	44987.283
	37698.069	44997.361
	37774.359	45029.545
	37783.046	45008.989

to the point of commencement (Point F).

- (b) An area of about 281.767 square metres and bounded approximately as follows:

First column
The Authority

Second column
Protected Place

Commencing at Point G of the aforesaid “Changi Airport Passenger Terminal Building 3 (3rd Storey)”, which point is 37965.646 metres North and 45150.333 metres East of the Singapore Land Authority SVY 21 Datum, the boundaries run along successive lines of coordinates approximately as follows:

<i>Northing</i>	<i>Easting</i>
37965.646	45150.333
37965.937	45150.456
37965.996	45150.318
37990.768	45160.839
37990.355	45161.810
37989.930	45161.629
37989.407	45162.863
37993.330	45164.529
37993.303	45166.750
37973.408	45166.596
37973.412	45164.842
37965.456	45164.771
37965.502	45159.538
37958.129	45157.698
37958.445	45156.432
37965.664	45158.233

to the point of commencement (Point G).

- (c) An area of about 29.863 square metres and bounded approximately as follows:

First column
The Authority

Second column
Protected Place

Commencing at Point H of the aforesaid “Changi Airport Passenger Terminal Building 3 (3rd Storey)”, which point is 37981.690 metres North and 45189.087 metres East of the Singapore Land Authority SVY 21 Datum, the boundaries run along successive lines of coordinates approximately as follows:

<i>Northing</i>	<i>Easting</i>
37981.690	45189.087
37971.487	45184.754
37973.051	45181.072
37975.747	45182.217
37975.043	45183.874
37982.569	45187.016

to the point of commencement (Point H).

- (d) An area of about 29.861 square metres and bounded approximately as follows:

Commencing at Point I of the aforesaid “Changi Airport Passenger Terminal Building 3 (3rd Storey)”, which point is 37915.418 metres North and 45160.941 metres East of the Singapore Land Authority SVY 21 Datum, the boundaries run along successive lines of coordinates approximately as follows:

<i>Northing</i>	<i>Easting</i>
37915.418	45160.941
37905.216	45156.608
37906.780	45152.927
37909.476	45154.072
37908.772	45155.728

First column
The Authority

Second column
Protected Place

37916.298 45158.870

to the point of commencement (Point I).

- (e) An area of about 283.627 square metres and bounded approximately as follows:

Commencing at Point J of the aforesaid “Changi Airport Passenger Terminal Building 3 (3rd Storey)”, which point is 37229.230 metres North and 44837.573 metres East of the Singapore Land Authority SVY 21 Datum, the boundaries run along successive lines of coordinates approximately as follows:

<i>Northing</i>	<i>Easting</i>
37229.230	44837.573
37222.863	44843.827
37229.172	44847.771
37228.447	44848.936
37221.994	44844.891
37219.396	44847.443
37213.385	44841.323
37211.635	44843.068
37197.750	44828.926
37199.373	44827.332
37203.266	44828.985
37204.225	44826.791
37228.998	44837.312
37228.939	44837.450

to the point of commencement (Point J).

First column
The Authority

Second column
Protected Place

- (f) An area of about 282.594 square metres and bounded approximately as follows:

Commencing at Point K of the aforesaid “Changi Airport Passenger Terminal Building 3 (3rd Storey)”, which point is 37085.643 metres North and 44776.591 metres East of the Singapore Land Authority SVY 21 Datum, the boundaries run along successive lines of coordinates approximately as follows:

<i>Northing</i>	<i>Easting</i>
37085.643	44776.591
37079.658	44782.425
37085.740	44786.845
37084.908	44787.989
37078.772	44783.505
37075.777	44786.448
37069.765	44780.328
37068.048	44782.086
37054.163	44767.944
37055.786	44766.350
37059.366	44767.822
37059.889	44766.588
37060.226	44766.780
37060.638	44765.809
37085.411	44776.330
37085.352	44776.468

to the point of commencement (Point K).

First column
The Authority

Second column
Protected Place

- (g) An area of about 29.841 square metres and bounded approximately as follows:

Commencing at Point L of the aforesaid “Changi Airport Passenger Terminal Building 3 (3rd Storey)”, which point is 37288.401 metres North and 44890.314 metres East of the Singapore Land Authority SVY 21 Datum, the boundaries run along successive lines of coordinates approximately as follows:

<i>Northing</i>	<i>Easting</i>
37288.401	44890.314
37286.843	44893.983
37276.641	44889.650
37277.520	44887.579
37285.007	44890.813
37285.710	44889.156

to the point of commencement (Point L).

- (h) An area of about 29.842 square metres bounded approximately as follows:

Commencing at Point M of the aforesaid “Changi Airport Passenger Terminal Building 3 (3rd Storey)”, which point is 37209.527 metres North and 44861.146 metres East of the Singapore Land Authority SVY 21 Datum, the boundaries run along successive lines of coordinates approximately as follows:

<i>Northing</i>	<i>Easting</i>
37209.527	44861.146
37199.324	44856.813
37200.204	44854.742
37207.691	44857.976
37208.394	44856.320

First column
The Authority

Second column
Protected Place

37211.085 44857.478

to the point of commencement (Point M).

- (i) An area of about 29.844 square metres and bounded approximately as follows:

Commencing at Point N of the aforesaid “Changi Airport Passenger Terminal Building 3 (3rd Storey)”, which point is 37132.211 metres North and 44828.310 metres East of the Singapore Land Authority SVY 21 Datum, the boundaries run along successive lines of coordinates approximately as follows:

<i>Northing</i>	<i>Easting</i>
37132.211	44828.310
37122.008	44823.977
37122.888	44821.906
37130.375	44825.140
37131.078	44823.483
37133.769	44824.641

to the point of commencement (Point N).

- (j) An area of about 29.838 square metres and bounded approximately as follows:

Commencing at Point O of the aforesaid “Changi Airport Passenger Terminal Building 3 (3rd Storey)”, which point is 37065.940 metres North and 44800.164 metres East of the Singapore Land Authority SVY 21 Datum, the boundaries run along successive lines of coordinates approximately as follows:

<i>Northing</i>	<i>Easting</i>
37065.940	44800.164
37055.738	44795.831

<i>First column</i>	<i>Second column</i>	
The Authority	Protected Place	
	37056.617	44793.760
	37064.104	44796.994
	37064.807	44795.338
	37067.498	44796.496

to the point of commencement (Point O).

- (k) An area of about 29.841 square metres and bounded approximately as follows:

Commencing at Point P of the aforesaid “Changi Airport Passenger Terminal Building 3 (3rd Storey)”, which point is 36990.182 metres North and 44763.659 metres East of the Singapore Land Authority SVY 21 Datum, the boundaries run along successive lines of coordinates approximately as follows:

<i>Northing</i>	<i>Easting</i>
36990.182	44763.659
36988.624	44767.328
36978.422	44762.995
36979.301	44760.924
36986.788	44764.158
36987.491	44762.501

to the point of commencement (Point P).

The boundaries of “Changi Airport Passenger Terminal Building 3 (3rd Storey)” referred to in sub-paragraphs (a) to (k) are more particularly delineated in the Survey Plan Ref. No. T3PP_S3_FP set out below.

First column
The Authority

Second column
Protected Place

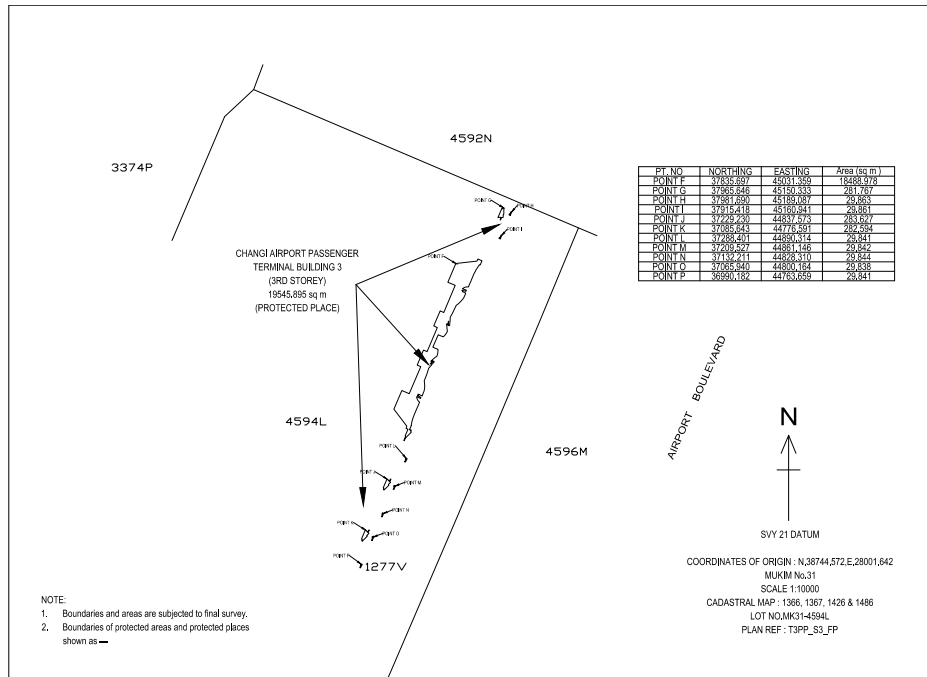

Chief Executive Officer, (7) Changi Airport Passenger Terminal Building 3 (4th Storey)
Changi Airport Group
(Singapore) Pte. Ltd.

All that area comprised in part of Land Lot 4594L in Mukim No. 31 (Changi) occupied by “Changi Airport Passenger Terminal Building 3 (4th Storey)” containing:

- (a) An area of about 3457.356 square metres and bounded approximately as follows:

Commencing at Point Q of the aforesaid “Changi Airport Passenger Terminal Building 3 (4th storey)”, which point is 37488.404 metres North and 44913.235 metres East of the Singapore Land Authority SVY 21 Datum, the boundaries run along successive lines of coordinates approximately as follows:

<i>First column</i>	<i>Second column</i>	
The Authority	Protected Place	
	<i>Northing</i>	<i>Easting</i>
	37488.404	44913.235
	37486.138	44918.565
	37481.365	44916.551
	37479.883	44920.040
	37481.641	44920.790
	37480.467	44923.552
	37483.451	44924.820
	37482.520	44927.005
	37483.348	44927.357
	37480.010	44935.216
	37476.002	44933.526
	37473.052	44940.473
	37475.858	44941.668
	37464.497	44968.929
	37454.557	44964.707
	37454.374	44965.137
	37454.052	44965.000
	37452.686	44968.220
	37429.850	44958.415
	37431.180	44955.286
	37412.771	44947.468
	37436.655	44891.229

to the point of commencement (Point Q).

First column
The Authority

Second column
Protected Place

- (b) An area of about 3334.145 square metres and bounded approximately as follows:

Commencing at Point R of the aforesaid “Changi Airport Passenger Terminal Building 3 (4th Storey)”, which point is 37803.147 metres North and 45046.880 metres East of the Singapore Land Authority SVY 21 Datum, the boundaries run along successive lines of coordinates approximately as follows:

<i>Northing</i>	<i>Easting</i>
37803.147	45046.880
37779.212	45103.097
37748.273	45093.651
37735.262	45070.775
37740.197	45049.119
37751.835	45025.085
37746.016	45037.102
37748.925	45031.094
37751.835	45025.085

to the point of commencement (Point R).

The boundaries of “Changi Airport Passenger Terminal Building 3 (4th Storey)” referred to in sub-paragraphs (a) and (b) are more particularly delineated in the Survey Plan Ref. No. T3PP_S4_QR set out below.

First column
The Authority

Second column
Protected Place

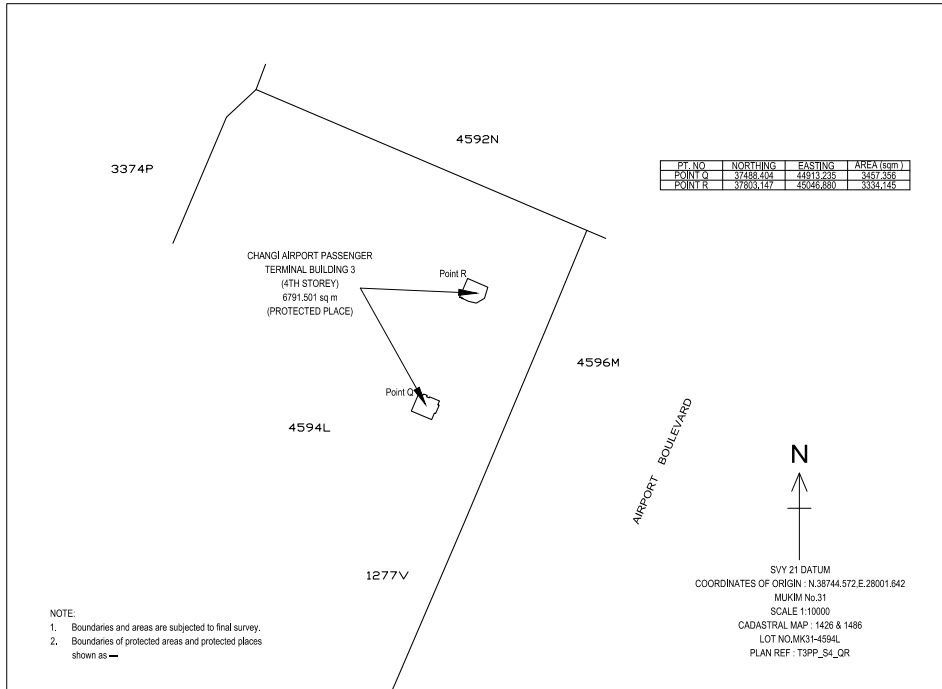

Made on 23 June 2015.

LEO YIP
*Permanent Secretary,
Ministry of Home Affairs,
Singapore.*

[MHA(PS) 12/2/06 TF 4; AG/LLRD/SL/256/2010/1 Vol. 11]