First published in the Government *Gazette*, Electronic Edition, on 6 July 2023 at 5 pm.

No. S 481

INFRASTRUCTURE PROTECTION ACT 2017

INFRASTRUCTURE PROTECTION
(PROTECTED PLACES) (NO. 11)
ORDER 2023

ARRANGEMENT OF PARAGRAPHS

Paragraph

1. Citation and commencement
 2. Premises declared to be protected place
- The Schedule
-

In exercise of the powers conferred by section 14(1) of the Infrastructure Protection Act 2017, the Minister for Home Affairs makes the following Order:

Citation and commencement

1. This Order is the Infrastructure Protection (Protected Places) (No. 11) Order 2023 and comes into operation on 7 July 2023.

Premises declared to be protected place

2. The premises described in the second column of the Schedule are declared to be a protected place for the purposes of the Act, and the person specified in the first column of that Schedule is designated as the authority of the protected place.

THE SCHEDULE

Paragraph 2

<i>First column</i>	<i>Second column</i>														
The Authority	Protected Place														
Senior Operations Director, Fonda Global Engineering Pte. Ltd.	<p>FONDA GLOBAL AT 101 NEYTHAL ROAD</p> <p>All that area comprised in part of Lot 00422L in Mukim No. 6 occupied by “FONDA GLOBAL AT 101 NEYTHAL ROAD” containing an area of about 50.157 square metres and bounded approximately as follows:</p> <p>Commencing at the northernmost corner at a point 34,341.171 metres North and 13,442.460 metres East of the Singapore Land Authority SVY 21 Datum, the boundaries run along successive lines of coordinates approximately as follows:</p> <table border="0" style="margin-left: auto; margin-right: auto;"> <thead> <tr> <th style="text-align: center;"><i>Northing</i></th> <th style="text-align: center;"><i>Easting</i></th> </tr> </thead> <tbody> <tr> <td style="text-align: center;">34,341.171</td> <td style="text-align: center;">13,442.460</td> </tr> <tr> <td style="text-align: center;">34,341.156</td> <td style="text-align: center;">13,454.899</td> </tr> <tr> <td style="text-align: center;">34,328.486</td> <td style="text-align: center;">13,454.824</td> </tr> <tr> <td style="text-align: center;">34,328.495</td> <td style="text-align: center;">13,447.745</td> </tr> <tr> <td style="text-align: center;">34,330.495</td> <td style="text-align: center;">13,447.747</td> </tr> <tr> <td style="text-align: center;">34,330.501</td> <td style="text-align: center;">13,442.447</td> </tr> </tbody> </table> <p>to the point of commencement.</p>	<i>Northing</i>	<i>Easting</i>	34,341.171	13,442.460	34,341.156	13,454.899	34,328.486	13,454.824	34,328.495	13,447.745	34,330.495	13,447.747	34,330.501	13,442.447
<i>Northing</i>	<i>Easting</i>														
34,341.171	13,442.460														
34,341.156	13,454.899														
34,328.486	13,454.824														
34,328.495	13,447.745														
34,330.495	13,447.747														
34,330.501	13,442.447														

The boundaries of “FONDA GLOBAL AT 101 NEYTHAL ROAD” are more particularly delineated in the Survey Plan set out below.

THE SCHEDULE — *continued*

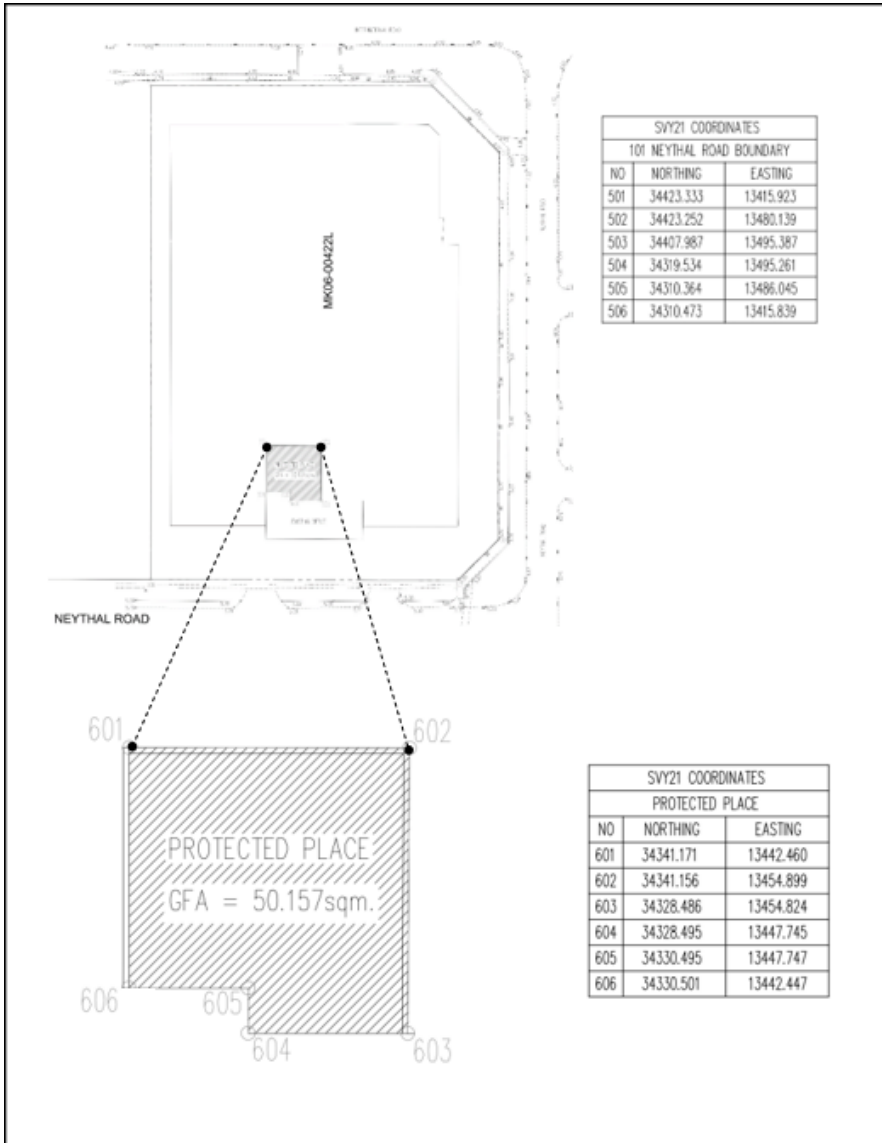

Made on 28 June 2023.

PANG KIN KEONG
*Permanent Secretary,
Ministry of Home Affairs,
Singapore.*

[SPF/CPS/C/09/12/16; AG/LEGIS/SL/137B/2020/2 Vol. 1]