First published in the Government *Gazette*, Electronic Edition, on 15 July 2021 at 5 pm.

No. S 519

INFRASTRUCTURE PROTECTION ACT 2017
(ACT 41 OF 2017)

INFRASTRUCTURE PROTECTION
(PROTECTED PLACES) (NO. 9)
ORDER 2021

ARRANGEMENT OF PARAGRAPHS

Paragraph

1. Citation and commencement
 2. Premises declared to be protected places
- The Schedule
-

In exercise of the powers conferred by section 14(1) of the Infrastructure Protection Act 2017, the Minister for Home Affairs makes the following Order:

Citation and commencement

1. This Order is the Infrastructure Protection (Protected Places) (No. 9) Order 2021 and comes into operation on 16 July 2021.

Premises declared to be protected places

2. The premises described in the second column of the Schedule are declared to be protected places for the purposes of the Act, and the person specified in the first column of that Schedule is designated as the authority of the corresponding protected place.

 THE SCHEDULE

Paragraph 2

<i>First column</i>	<i>Second column</i>																																
The Authority	Protected Place																																
1. Director-General, Civil Aviation Authority of Singapore	<p>ANCILLARY FACILITIES BUILDING AT 20 CHANGI EAST CLOSE</p> <p>All that area comprised in part of Lot 05188A PT in Mukim No. 31 occupied by “ANCILLARY FACILITIES BUILDING AT 20 CHANGI EAST CLOSE” containing an area of about 17832.40 square metres and bounded approximately as follows:</p> <p>Commencing at a point 34016.395 metres North and 47131.307 metres East of the Singapore Land Authority SVY 21 Datum, the boundaries run along successive lines of coordinates approximately as follows:</p> <table border="0" style="margin-left: auto; margin-right: auto;"> <thead> <tr> <th style="text-align: left;"><i>Northing</i></th> <th style="text-align: left;"><i>Easting</i></th> </tr> </thead> <tbody> <tr><td>34016.395</td><td>47131.307</td></tr> <tr><td>33988.723</td><td>47119.719</td></tr> <tr><td>34017.692</td><td>47050.540</td></tr> <tr><td>34027.840</td><td>47054.786</td></tr> <tr><td>34045.359</td><td>47062.125</td></tr> <tr><td>34032.476</td><td>47043.721</td></tr> <tr><td>34036.618</td><td>47045.480</td></tr> <tr><td>34039.276</td><td>47037.860</td></tr> <tr><td>34040.111</td><td>47032.979</td></tr> <tr><td>34041.145</td><td>47023.153</td></tr> <tr><td>34041.161</td><td>47021.199</td></tr> <tr><td>34041.027</td><td>47017.780</td></tr> <tr><td>34040.436</td><td>47012.358</td></tr> <tr><td>34039.820</td><td>47007.873</td></tr> <tr><td>34038.754</td><td>47002.523</td></tr> </tbody> </table>	<i>Northing</i>	<i>Easting</i>	34016.395	47131.307	33988.723	47119.719	34017.692	47050.540	34027.840	47054.786	34045.359	47062.125	34032.476	47043.721	34036.618	47045.480	34039.276	47037.860	34040.111	47032.979	34041.145	47023.153	34041.161	47021.199	34041.027	47017.780	34040.436	47012.358	34039.820	47007.873	34038.754	47002.523
<i>Northing</i>	<i>Easting</i>																																
34016.395	47131.307																																
33988.723	47119.719																																
34017.692	47050.540																																
34027.840	47054.786																																
34045.359	47062.125																																
34032.476	47043.721																																
34036.618	47045.480																																
34039.276	47037.860																																
34040.111	47032.979																																
34041.145	47023.153																																
34041.161	47021.199																																
34041.027	47017.780																																
34040.436	47012.358																																
34039.820	47007.873																																
34038.754	47002.523																																

THE SCHEDULE — *continued*

<i>First column</i>		<i>Second column</i>
The Authority		Protected Place
	34037.598	46998.428
	34036.135	46994.509
	34034.318	46990.587
	34031.600	46985.711
	34028.527	46980.858
	34026.681	46978.369
	34024.552	46975.872
	34018.029	46969.192
	34015.633	46967.185
	34013.473	46965.653
	34005.434	46960.945
	34011.150	46947.501
	34013.590	46948.681
	34020.395	46952.837
	34026.761	46957.637
	34032.627	46963.037
	34037.938	46968.984
	34042.642	46975.422
	34046.694	46982.288
	34050.057	46989.518
	34052.696	46997.041
	34054.589	47004.786
	34055.715	47012.679
	34056.064	47020.645
	34055.634	47028.607
	34054.427	47036.488
	34052.456	47044.214

THE SCHEDULE — *continued*

<i>First column</i>	<i>Second column</i>
The Authority	Protected Place
	34049.740 47051.710

to the point of commencement.

The boundaries of “ANCILLARY FACILITIES BUILDING AT 20 CHANGI EAST CLOSE” are more particularly delineated in the Plan set out below.

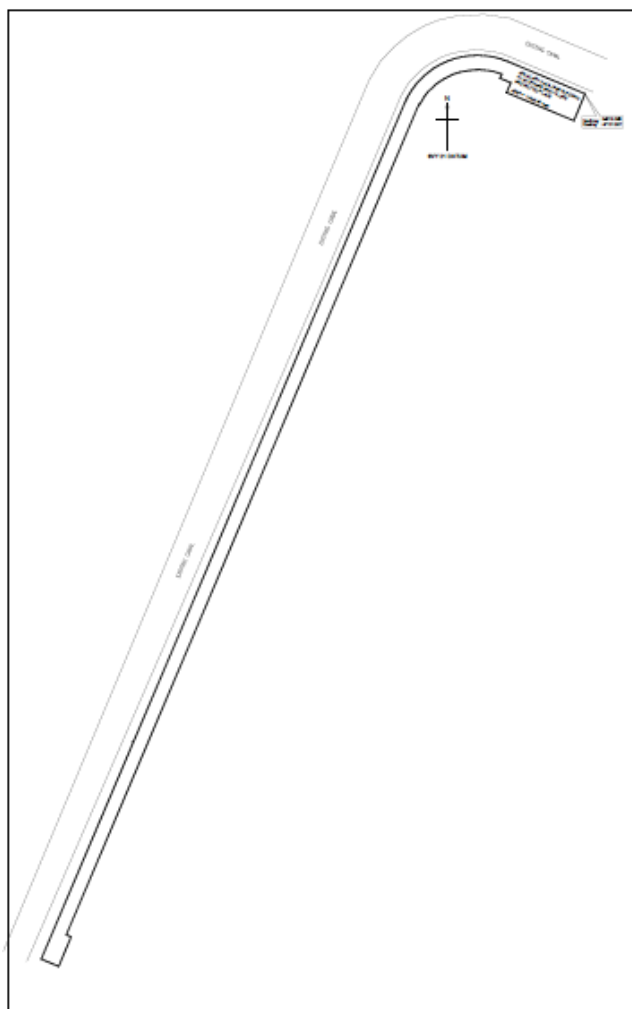

THE SCHEDULE — *continued*

<i>First column</i>	<i>Second column</i>																																
The Authority	Protected Place																																
2. Director-General, Civil Aviation Authority of Singapore	<p>ANCILLARY FACILITIES BUILDING AT 21 AVIATION PARK ROAD</p> <p>All that area comprised in part of Lots 05134C and 05137V in Mukim No. 31 occupied by “ANCILLARY FACILITIES BUILDING AT 21 AVIATION PARK ROAD” containing an area of about 6800.30 square metres and bounded approximately as follows:</p> <p>Commencing at a point 38441.263 metres North and 49547.621 metres East of the Singapore Land Authority SVY 21 Datum, the boundaries run along successive lines of coordinates approximately as follows:</p> <table border="0" style="margin-left: auto; margin-right: auto;"> <thead> <tr> <th style="text-align: left;"><i>Northing</i></th> <th style="text-align: left;"><i>Easting</i></th> </tr> </thead> <tbody> <tr><td>38441.263</td><td>49547.621</td></tr> <tr><td>38414.994</td><td>49609.526</td></tr> <tr><td>38382.483</td><td>49595.816</td></tr> <tr><td>38406.514</td><td>49539.349</td></tr> <tr><td>38411.996</td><td>49526.468</td></tr> <tr><td>38437.023</td><td>49537.120</td></tr> <tr><td>38397.946</td><td>49535.703</td></tr> <tr><td>38182.342</td><td>49443.940</td></tr> <tr><td>38158.542</td><td>49433.811</td></tr> <tr><td>38130.931</td><td>49422.081</td></tr> <tr><td>38134.068</td><td>49414.695</td></tr> <tr><td>38141.935</td><td>49411.523</td></tr> <tr><td>38164.013</td><td>49420.932</td></tr> <tr><td>38173.217</td><td>49424.841</td></tr> <tr><td>38187.815</td><td>49431.054</td></tr> </tbody> </table>	<i>Northing</i>	<i>Easting</i>	38441.263	49547.621	38414.994	49609.526	38382.483	49595.816	38406.514	49539.349	38411.996	49526.468	38437.023	49537.120	38397.946	49535.703	38182.342	49443.940	38158.542	49433.811	38130.931	49422.081	38134.068	49414.695	38141.935	49411.523	38164.013	49420.932	38173.217	49424.841	38187.815	49431.054
<i>Northing</i>	<i>Easting</i>																																
38441.263	49547.621																																
38414.994	49609.526																																
38382.483	49595.816																																
38406.514	49539.349																																
38411.996	49526.468																																
38437.023	49537.120																																
38397.946	49535.703																																
38182.342	49443.940																																
38158.542	49433.811																																
38130.931	49422.081																																
38134.068	49414.695																																
38141.935	49411.523																																
38164.013	49420.932																																
38173.217	49424.841																																
38187.815	49431.054																																

to the point of commencement.

THE SCHEDULE — *continued*

First column

Second column

The Authority

Protected Place

The boundaries of “ANCILLARY FACILITIES BUILDING AT 21 AVIATION PARK ROAD” are more particularly delineated in the Plan set out below.

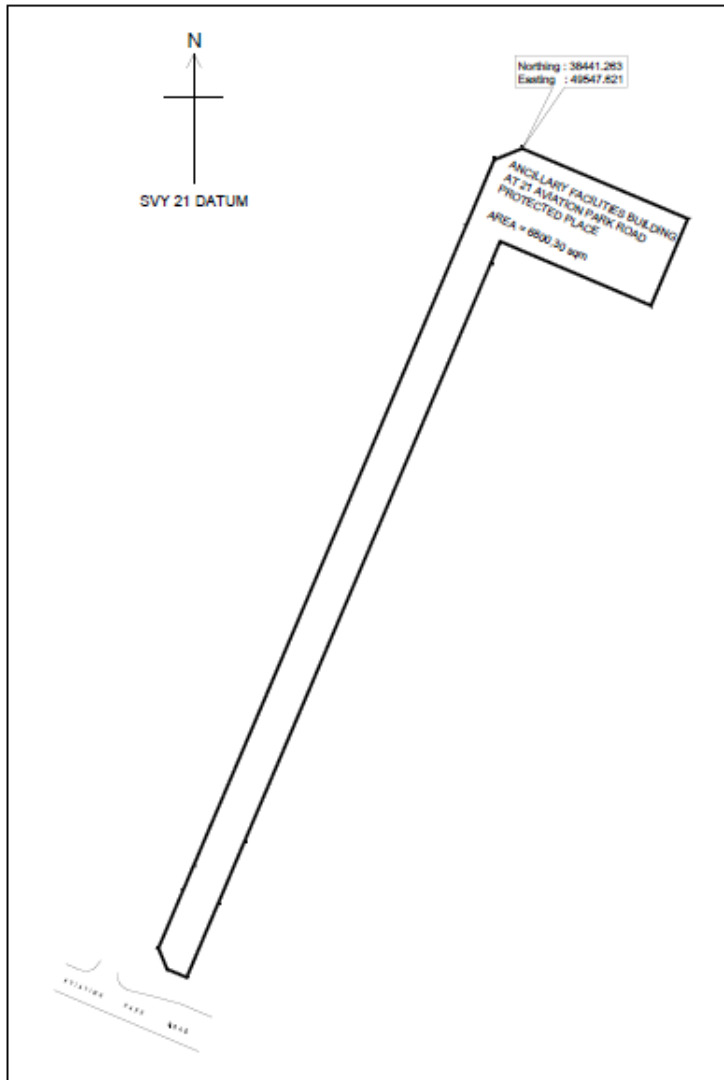

Made on 1 July 2021.

PANG KIN KEONG
*Permanent Secretary,
Ministry of Home Affairs,
Singapore.*

[SPF/CPS/C/09/10/08; AG/LEGIS/SL/137B/2020/2 Vol. 1]