First published in the *Government Gazette*, Electronic Edition, on 30 January 2024 at 5 pm.

No. S 52

INFRASTRUCTURE PROTECTION ACT 2017

INFRASTRUCTURE PROTECTION (PROTECTED PLACES) (NO. 9) ORDER 2024

ARRANGEMENT OF PARAGRAPHS

Paragraph

1. Citation and commencement
 2. Premises declared to be protected places
 3. Revocations
- The Schedule
-

In exercise of the powers conferred by sections 14(1) and 19(1) of the Infrastructure Protection Act 2017, the Minister for Home Affairs makes the following Order:

Citation and commencement

1. This Order is the Infrastructure Protection (Protected Places) (No. 9) Order 2024 and comes into operation on 31 January 2024.

Premises declared to be protected places

2. The premises described in the second column of the Schedule are declared to be protected places for the purposes of the Act, and the person specified in the first column of that Schedule is designated as the authority of the corresponding protected place.

Revocations

3.—(1) In the Protected Places (No. 8) Order 2012 (G.N. No. S 453/2012), in the Schedule, delete items (3), (16) and (17).

(2) In the Protected Places (No. 6) Order 2013 (G.N. No. S 307/2013), in the Schedule, delete items (5) to (8).

(3) In the Protected Places (No. 8) Order 2013 (G.N. No. S 309/2013), in the Schedule, delete item (2).

(4) In the Protected Places (No. 9) Order 2013 (G.N. No. S 310/2013), in the Schedule, delete item (1).

(5) In the Protected Places (No. 6) Order 2014 (G.N. No. S 532/2014), in the Schedule, delete item (1).

THE SCHEDULE

Paragraph 2

<i>First column</i>	<i>Second column</i>																												
The Authority	Protected Place																												
1. Chief Executive Officer, SP PowerGrid Ltd	<p style="text-align: center;">BUKIT PANJANG SUBSTATION</p> <p>All that area comprised in part of Lot 03233P in Mukim No. 10 occupied by “BUKIT PANJANG SUBSTATION” containing an area of about 3308.5 square metres and bounded approximately as follows:</p> <p>Commencing at a point 39829.981 metres North and 20026.697 metres East of the Singapore Land Authority SVY 21 Datum, the boundaries run along successive lines of coordinates approximately as follows:</p> <table style="margin-left: auto; margin-right: auto; border-collapse: collapse;"> <thead> <tr> <th style="text-align: left;"><i>Northing</i></th> <th style="text-align: left;"><i>Easting</i></th> </tr> </thead> <tbody> <tr><td>39829.981</td><td>20026.697</td></tr> <tr><td>39830.075</td><td>20026.713</td></tr> <tr><td>39834.781</td><td>20046.440</td></tr> <tr><td>39836.244</td><td>20052.573</td></tr> <tr><td>39840.940</td><td>20072.718</td></tr> <tr><td>39835.552</td><td>20081.350</td></tr> <tr><td>39835.482</td><td>20081.393</td></tr> <tr><td>39812.748</td><td>20085.500</td></tr> <tr><td>39789.201</td><td>20089.675</td></tr> <tr><td>39766.301</td><td>20093.690</td></tr> <tr><td>39762.493</td><td>20073.679</td></tr> <tr><td>39760.411</td><td>20062.220</td></tr> <tr><td>39779.810</td><td>20052.235</td></tr> </tbody> </table>	<i>Northing</i>	<i>Easting</i>	39829.981	20026.697	39830.075	20026.713	39834.781	20046.440	39836.244	20052.573	39840.940	20072.718	39835.552	20081.350	39835.482	20081.393	39812.748	20085.500	39789.201	20089.675	39766.301	20093.690	39762.493	20073.679	39760.411	20062.220	39779.810	20052.235
<i>Northing</i>	<i>Easting</i>																												
39829.981	20026.697																												
39830.075	20026.713																												
39834.781	20046.440																												
39836.244	20052.573																												
39840.940	20072.718																												
39835.552	20081.350																												
39835.482	20081.393																												
39812.748	20085.500																												
39789.201	20089.675																												
39766.301	20093.690																												
39762.493	20073.679																												
39760.411	20062.220																												
39779.810	20052.235																												

to the point of commencement.

The boundaries of “BUKIT PANJANG SUBSTATION” are more particularly delineated in the Survey Plan set out below.

THE SCHEDULE — *continued*

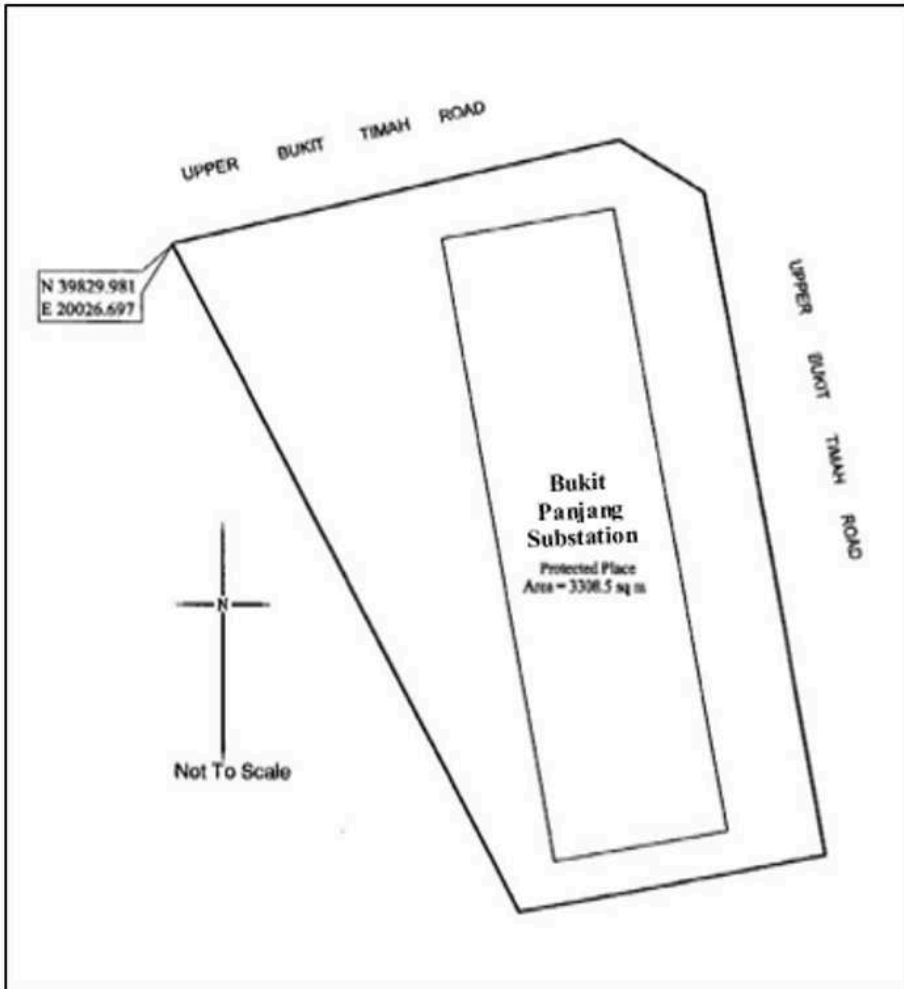

 THE SCHEDULE — *continued*

<i>First column</i>	<i>Second column</i>																																				
The Authority	Protected Place																																				
2. Chief Executive Officer, SP PowerGrid Ltd	<p>CHANDER SUBSTATION</p> <p>All that area comprised in part of Lot 01572K in Town Subdivision No. 18 occupied by “CHANDER SUBSTATION” containing an area of about 1571.2 square metres and bounded approximately as follows:</p> <p>Commencing at a point 32246.192 metres North and 29996.719 metres East of the Singapore Land Authority SVY 21 Datum, the boundaries run along successive lines of coordinates approximately as follows:</p> <table border="0" style="margin-left: 40px;"> <thead> <tr> <th style="text-align: left;"><i>Northing</i></th> <th style="text-align: left;"><i>Easting</i></th> </tr> </thead> <tbody> <tr><td>32246.192</td><td>29996.719</td></tr> <tr><td>32266.565</td><td>30011.894</td></tr> <tr><td>32267.983</td><td>30010.140</td></tr> <tr><td>32281.514</td><td>30020.361</td></tr> <tr><td>32282.534</td><td>30027.848</td></tr> <tr><td>32278.367</td><td>30033.333</td></tr> <tr><td>32277.356</td><td>30032.748</td></tr> <tr><td>32276.492</td><td>30032.164</td></tr> <tr><td>32271.937</td><td>30038.280</td></tr> <tr><td>32272.773</td><td>30038.905</td></tr> <tr><td>32273.460</td><td>30039.463</td></tr> <tr><td>32269.149</td><td>30045.182</td></tr> <tr><td>32264.491</td><td>30046.815</td></tr> <tr><td>32242.643</td><td>30030.507</td></tr> <tr><td>32227.877</td><td>30019.449</td></tr> <tr><td>32227.139</td><td>30013.061</td></tr> <tr><td>32227.910</td><td>30011.603</td></tr> </tbody> </table>	<i>Northing</i>	<i>Easting</i>	32246.192	29996.719	32266.565	30011.894	32267.983	30010.140	32281.514	30020.361	32282.534	30027.848	32278.367	30033.333	32277.356	30032.748	32276.492	30032.164	32271.937	30038.280	32272.773	30038.905	32273.460	30039.463	32269.149	30045.182	32264.491	30046.815	32242.643	30030.507	32227.877	30019.449	32227.139	30013.061	32227.910	30011.603
<i>Northing</i>	<i>Easting</i>																																				
32246.192	29996.719																																				
32266.565	30011.894																																				
32267.983	30010.140																																				
32281.514	30020.361																																				
32282.534	30027.848																																				
32278.367	30033.333																																				
32277.356	30032.748																																				
32276.492	30032.164																																				
32271.937	30038.280																																				
32272.773	30038.905																																				
32273.460	30039.463																																				
32269.149	30045.182																																				
32264.491	30046.815																																				
32242.643	30030.507																																				
32227.877	30019.449																																				
32227.139	30013.061																																				
32227.910	30011.603																																				

THE SCHEDULE — *continued*

<i>First column</i>	<i>Second column</i>	
The Authority	Protected Place	
	32242.234	29992.293
	32243.160	29991.983
	32247.494	29994.776
	32246.867	29995.811

to the point of commencement.

The boundaries of “CHANDER SUBSTATION” are more particularly delineated in the Survey Plan set out below.

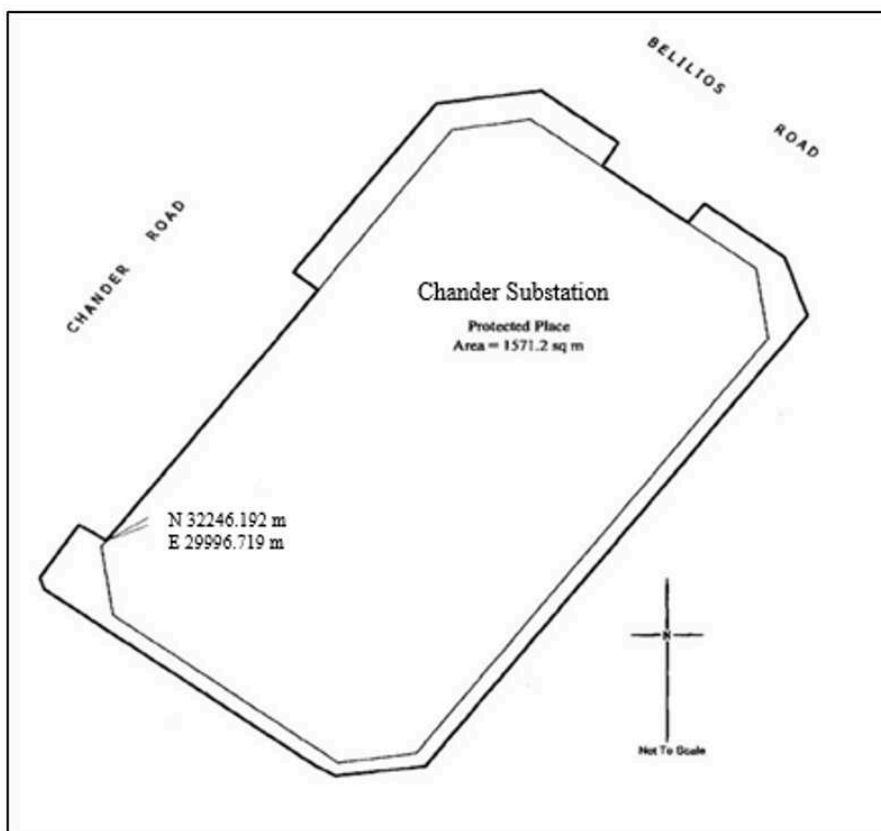

THE SCHEDULE — *continued*

<i>First column</i>	<i>Second column</i>																																		
The Authority	Protected Place																																		
3. Chief Executive Officer, SP PowerGrid Ltd	<p>CHANGI COAST SUBSTATION</p> <p>All that area comprised in part of Lot 04174N in Mukim No. 31 occupied by “CHANGI COAST SUBSTATION” containing an area of about 3103.7 square metres and bounded approximately as follows:</p> <p>Commencing at a point 39812.623 metres North and 46895.748 metres East of the Singapore Land Authority SVY 21 Datum, the boundaries run along successive lines of coordinates approximately as follows:</p> <table border="0" style="margin-left: auto; margin-right: auto;"> <thead> <tr> <th style="text-align: left;"><i>Northing</i></th> <th style="text-align: left;"><i>Easting</i></th> </tr> </thead> <tbody> <tr><td>39812.623</td><td>46895.748</td></tr> <tr><td>39819.165</td><td>46912.246</td></tr> <tr><td>39825.692</td><td>46928.622</td></tr> <tr><td>39831.066</td><td>46942.141</td></tr> <tr><td>39828.668</td><td>46943.053</td></tr> <tr><td>39828.588</td><td>46943.088</td></tr> <tr><td>39828.369</td><td>46942.452</td></tr> <tr><td>39828.047</td><td>46942.564</td></tr> <tr><td>39822.480</td><td>46944.755</td></tr> <tr><td>39822.780</td><td>46945.481</td></tr> <tr><td>39818.061</td><td>46947.370</td></tr> <tr><td>39817.654</td><td>46947.437</td></tr> <tr><td>39803.924</td><td>46952.819</td></tr> <tr><td>39787.770</td><td>46958.742</td></tr> <tr><td>39767.497</td><td>46965.207</td></tr> <tr><td>39763.086</td><td>46954.142</td></tr> </tbody> </table>	<i>Northing</i>	<i>Easting</i>	39812.623	46895.748	39819.165	46912.246	39825.692	46928.622	39831.066	46942.141	39828.668	46943.053	39828.588	46943.088	39828.369	46942.452	39828.047	46942.564	39822.480	46944.755	39822.780	46945.481	39818.061	46947.370	39817.654	46947.437	39803.924	46952.819	39787.770	46958.742	39767.497	46965.207	39763.086	46954.142
<i>Northing</i>	<i>Easting</i>																																		
39812.623	46895.748																																		
39819.165	46912.246																																		
39825.692	46928.622																																		
39831.066	46942.141																																		
39828.668	46943.053																																		
39828.588	46943.088																																		
39828.369	46942.452																																		
39828.047	46942.564																																		
39822.480	46944.755																																		
39822.780	46945.481																																		
39818.061	46947.370																																		
39817.654	46947.437																																		
39803.924	46952.819																																		
39787.770	46958.742																																		
39767.497	46965.207																																		
39763.086	46954.142																																		

THE SCHEDULE — *continued*

<i>First column</i>	<i>Second column</i>	
The Authority	Protected Place	
	39757.602	46940.174
	39770.120	46912.715
	39792.535	46903.764

to the point of commencement.

The boundaries of “CHANGI COAST SUBSTATION” are more particularly delineated in the Survey Plan set out below.

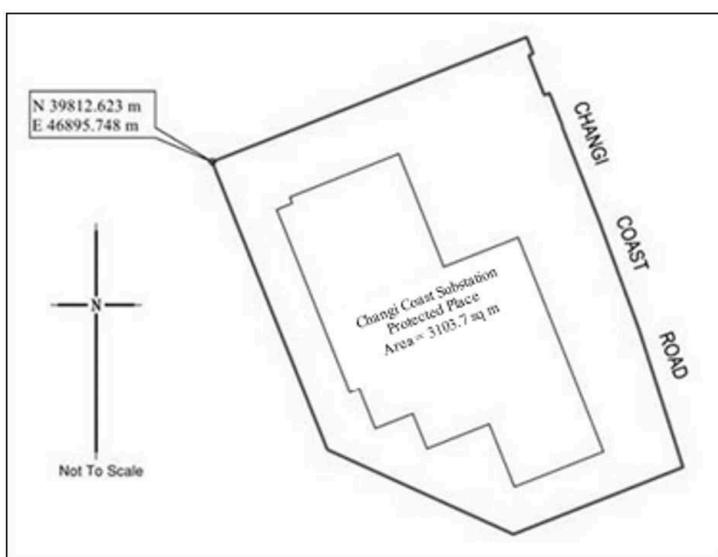

THE SCHEDULE — *continued*

<i>First column</i>	<i>Second column</i>																																				
The Authority	Protected Place																																				
4. Chief Executive Officer, SP PowerGrid Ltd	<p>CHANGI SOUTH SUBSTATION</p> <p>All that area comprised in part of Lot 10111K in Mukim No. 27 occupied by “CHANGI SOUTH SUBSTATION” containing an area of about 5454.9 square metres and bounded approximately as follows:</p> <p>Commencing at a point 36381.198 metres North and 42921.838 metres East of the Singapore Land Authority SVY 21 Datum, the boundaries run along successive lines of coordinates approximately as follows:</p> <table border="0" style="margin-left: auto; margin-right: auto;"> <thead> <tr> <th style="text-align: left;"><i>Northing</i></th> <th style="text-align: left;"><i>Easting</i></th> </tr> </thead> <tbody> <tr><td>36381.198</td><td>42921.838</td></tr> <tr><td>36363.229</td><td>42921.255</td></tr> <tr><td>36336.022</td><td>42920.335</td></tr> <tr><td>36309.477</td><td>42919.448</td></tr> <tr><td>36293.786</td><td>42918.901</td></tr> <tr><td>36292.167</td><td>42920.715</td></tr> <tr><td>36289.321</td><td>42924.427</td></tr> <tr><td>36286.171</td><td>42927.971</td></tr> <tr><td>36286.071</td><td>42928.084</td></tr> <tr><td>36286.622</td><td>42928.878</td></tr> <tr><td>36286.445</td><td>42929.097</td></tr> <tr><td>36286.389</td><td>42929.018</td></tr> <tr><td>36282.473</td><td>42933.555</td></tr> <tr><td>36282.406</td><td>42933.631</td></tr> <tr><td>36282.476</td><td>42933.692</td></tr> <tr><td>36278.264</td><td>42938.501</td></tr> <tr><td>36278.306</td><td>42938.567</td></tr> </tbody> </table>	<i>Northing</i>	<i>Easting</i>	36381.198	42921.838	36363.229	42921.255	36336.022	42920.335	36309.477	42919.448	36293.786	42918.901	36292.167	42920.715	36289.321	42924.427	36286.171	42927.971	36286.071	42928.084	36286.622	42928.878	36286.445	42929.097	36286.389	42929.018	36282.473	42933.555	36282.406	42933.631	36282.476	42933.692	36278.264	42938.501	36278.306	42938.567
<i>Northing</i>	<i>Easting</i>																																				
36381.198	42921.838																																				
36363.229	42921.255																																				
36336.022	42920.335																																				
36309.477	42919.448																																				
36293.786	42918.901																																				
36292.167	42920.715																																				
36289.321	42924.427																																				
36286.171	42927.971																																				
36286.071	42928.084																																				
36286.622	42928.878																																				
36286.445	42929.097																																				
36286.389	42929.018																																				
36282.473	42933.555																																				
36282.406	42933.631																																				
36282.476	42933.692																																				
36278.264	42938.501																																				
36278.306	42938.567																																				

 THE SCHEDULE — *continued*

<i>First column</i>		<i>Second column</i>
The Authority		Protected Place
	36280.894	42942.660
	36289.889	42956.263
	36302.367	42974.493
	36317.311	42996.649
	36336.873	42983.490
	36357.986	42969.313
	36395.973	42943.712
	36389.065	42933.458

to the point of commencement.

The boundaries of “CHANGI SOUTH SUBSTATION” are more particularly delineated in the Survey Plan set out below.

THE SCHEDULE — *continued*

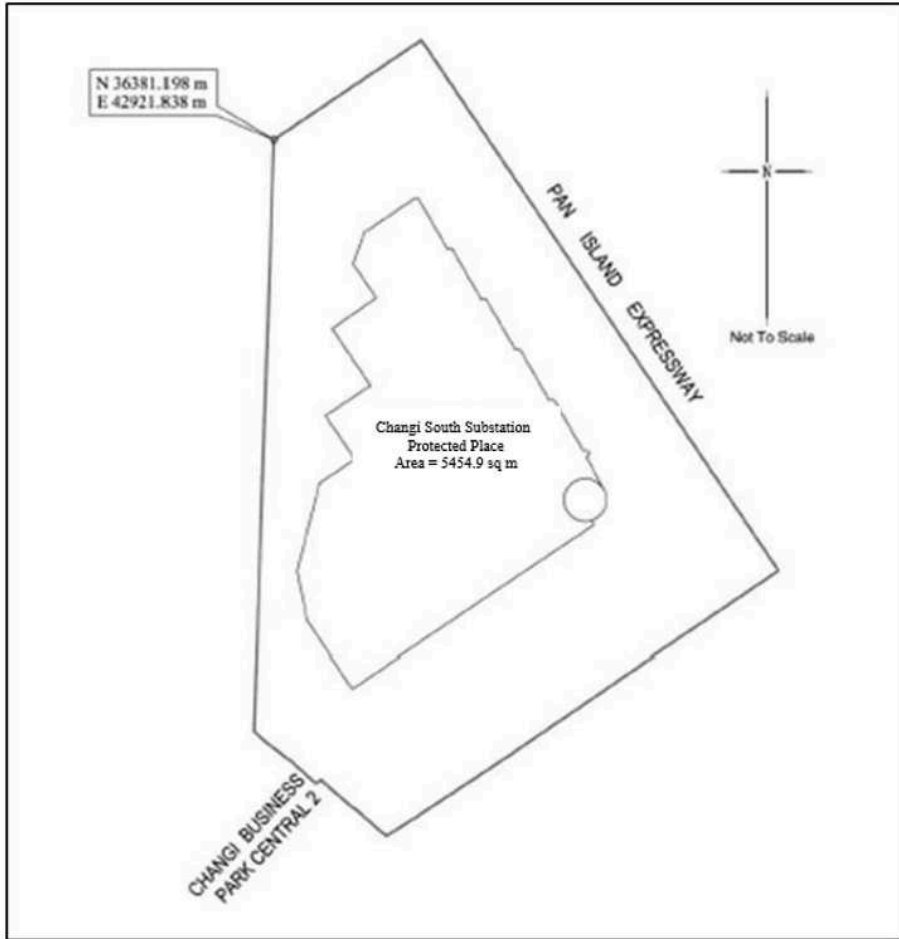

THE SCHEDULE — *continued*

<i>First column</i>	<i>Second column</i>																																				
The Authority	Protected Place																																				
5. Chief Executive Officer, SP PowerGrid Ltd	<p>CHOA CHU KANG NEW TOWN SUBSTATION</p> <p>All that area comprised in part of Lot 01936W in Mukim No. 11 occupied by “CHOA CHU KANG NEW TOWN SUBSTATION” containing an area of about 4309.5 square metres and bounded approximately as follows:</p> <p>Commencing at a point 41321.034 metres North and 18051.665 metres East of the Singapore Land Authority SVY 21 Datum, the boundaries run along successive lines of coordinates approximately as follows:</p> <table border="0" style="margin-left: auto; margin-right: auto;"> <thead> <tr> <th style="text-align: left;"><i>Northing</i></th> <th style="text-align: left;"><i>Easting</i></th> </tr> </thead> <tbody> <tr><td>41321.034</td><td>18051.665</td></tr> <tr><td>41316.339</td><td>18056.177</td></tr> <tr><td>41310.068</td><td>18062.148</td></tr> <tr><td>41282.869</td><td>18060.617</td></tr> <tr><td>41251.954</td><td>18060.210</td></tr> <tr><td>41232.421</td><td>18060.269</td></tr> <tr><td>41225.404</td><td>18047.911</td></tr> <tr><td>41216.195</td><td>18032.357</td></tr> <tr><td>41223.008</td><td>18027.927</td></tr> <tr><td>41231.852</td><td>18022.139</td></tr> <tr><td>41258.533</td><td>18004.700</td></tr> <tr><td>41279.659</td><td>18007.362</td></tr> <tr><td>41303.567</td><td>18010.429</td></tr> <tr><td>41304.468</td><td>18016.446</td></tr> <tr><td>41305.002</td><td>18019.441</td></tr> <tr><td>41306.303</td><td>18025.254</td></tr> <tr><td>41307.716</td><td>18029.557</td></tr> </tbody> </table>	<i>Northing</i>	<i>Easting</i>	41321.034	18051.665	41316.339	18056.177	41310.068	18062.148	41282.869	18060.617	41251.954	18060.210	41232.421	18060.269	41225.404	18047.911	41216.195	18032.357	41223.008	18027.927	41231.852	18022.139	41258.533	18004.700	41279.659	18007.362	41303.567	18010.429	41304.468	18016.446	41305.002	18019.441	41306.303	18025.254	41307.716	18029.557
<i>Northing</i>	<i>Easting</i>																																				
41321.034	18051.665																																				
41316.339	18056.177																																				
41310.068	18062.148																																				
41282.869	18060.617																																				
41251.954	18060.210																																				
41232.421	18060.269																																				
41225.404	18047.911																																				
41216.195	18032.357																																				
41223.008	18027.927																																				
41231.852	18022.139																																				
41258.533	18004.700																																				
41279.659	18007.362																																				
41303.567	18010.429																																				
41304.468	18016.446																																				
41305.002	18019.441																																				
41306.303	18025.254																																				
41307.716	18029.557																																				

 THE SCHEDULE — *continued*

<i>First column</i>	<i>Second column</i>
The Authority	Protected Place
41309.073	18032.684
41308.793	18032.847
41311.581	18038.751
41311.928	18038.695
41315.035	18044.172
41317.098	18047.006
41319.716	18050.163

to the point of commencement.

The boundaries of “CHOA CHU KANG NEW TOWN SUBSTATION” are more particularly delineated in the Survey Plan set out below.

THE SCHEDULE — *continued*

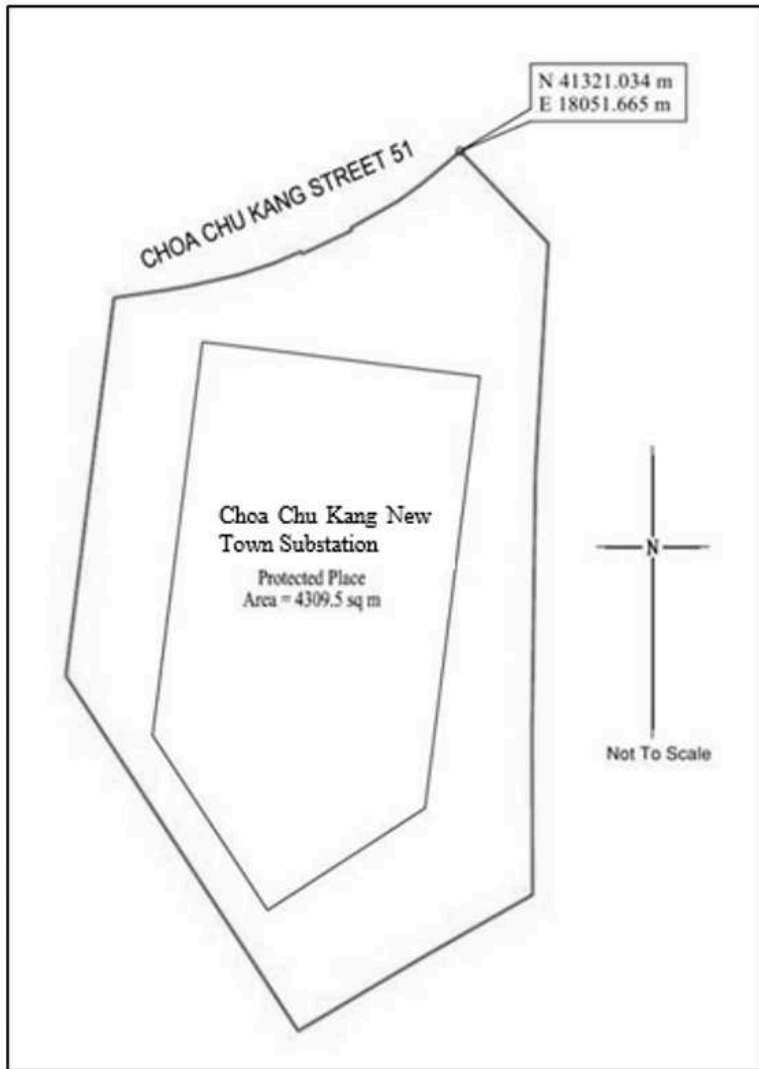

THE SCHEDULE — *continued*

<i>First column</i>	<i>Second column</i>																		
The Authority	Protected Place																		
6. Chief Executive Officer, SP PowerGrid Ltd	<p>CRAWFORD STREET SUBSTATION</p> <p>All that area comprised in part of Lot 01822A in Town Subdivision No. 17 occupied by “CRAWFORD STREET SUBSTATION” containing an area of about 1220.2 square metres and bounded approximately as follows:</p> <p>Commencing at a point 32137.076 metres North and 31485.969 metres East of the Singapore Land Authority SVY 21 Datum, the boundaries run along successive lines of coordinates approximately as follows:</p> <table border="0" style="margin-left: auto; margin-right: auto;"> <thead> <tr> <th style="text-align: left;"><i>Northing</i></th> <th style="text-align: left;"><i>Easting</i></th> </tr> </thead> <tbody> <tr> <td>32137.076</td> <td>31485.969</td> </tr> <tr> <td>32132.789</td> <td>31488.992</td> </tr> <tr> <td>32105.117</td> <td>31509.375</td> </tr> <tr> <td>32115.288</td> <td>31522.901</td> </tr> <tr> <td>32126.439</td> <td>31528.674</td> </tr> <tr> <td>32155.475</td> <td>31518.470</td> </tr> <tr> <td>32154.027</td> <td>31511.206</td> </tr> <tr> <td>32144.257</td> <td>31496.028</td> </tr> </tbody> </table>	<i>Northing</i>	<i>Easting</i>	32137.076	31485.969	32132.789	31488.992	32105.117	31509.375	32115.288	31522.901	32126.439	31528.674	32155.475	31518.470	32154.027	31511.206	32144.257	31496.028
<i>Northing</i>	<i>Easting</i>																		
32137.076	31485.969																		
32132.789	31488.992																		
32105.117	31509.375																		
32115.288	31522.901																		
32126.439	31528.674																		
32155.475	31518.470																		
32154.027	31511.206																		
32144.257	31496.028																		

to the point of commencement.

The boundaries of “CRAWFORD STREET SUBSTATION” are more particularly delineated in the Survey Plan set out below.

THE SCHEDULE — *continued*

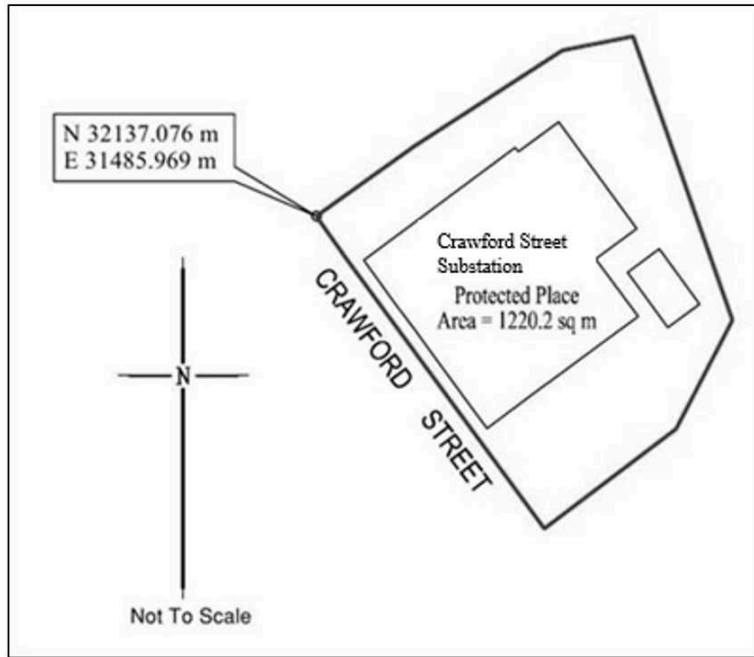

THE SCHEDULE — *continued*

<i>First column</i>	<i>Second column</i>																																				
The Authority	Protected Place																																				
7. Chief Executive Officer, SP PowerGrid Ltd	<p>EUNOS FLYOVER SUBSTATION</p> <p>All that area comprised in part of Lot 06720M in Mukim No. 23 occupied by “EUNOS FLYOVER SUBSTATION” containing an area of about 3363.2 square metres and bounded approximately as follows:</p> <p>Commencing at a point 34055.946 metres North and 35983.982 metres East of the Singapore Land Authority SVY 21 Datum, the boundaries run along successive lines of coordinates approximately as follows:</p> <table border="0" style="margin-left: auto; margin-right: auto;"> <thead> <tr> <th style="text-align: left;"><i>Northing</i></th> <th style="text-align: left;"><i>Easting</i></th> </tr> </thead> <tbody> <tr><td>34055.946</td><td>35983.982</td></tr> <tr><td>34064.776</td><td>36011.293</td></tr> <tr><td>34071.181</td><td>36016.449</td></tr> <tr><td>34098.236</td><td>36020.088</td></tr> <tr><td>34100.366</td><td>36020.296</td></tr> <tr><td>34106.673</td><td>36019.895</td></tr> <tr><td>34113.313</td><td>36018.883</td></tr> <tr><td>34119.838</td><td>36017.292</td></tr> <tr><td>34126.199</td><td>36015.135</td></tr> <tr><td>34132.346</td><td>36012.429</td></tr> <tr><td>34138.232</td><td>36009.195</td></tr> <tr><td>34143.813</td><td>36005.456</td></tr> <tr><td>34144.213</td><td>36005.134</td></tr> <tr><td>34144.191</td><td>35973.813</td></tr> <tr><td>34126.241</td><td>35972.079</td></tr> <tr><td>34108.293</td><td>35970.338</td></tr> <tr><td>34088.763</td><td>35968.457</td></tr> </tbody> </table>	<i>Northing</i>	<i>Easting</i>	34055.946	35983.982	34064.776	36011.293	34071.181	36016.449	34098.236	36020.088	34100.366	36020.296	34106.673	36019.895	34113.313	36018.883	34119.838	36017.292	34126.199	36015.135	34132.346	36012.429	34138.232	36009.195	34143.813	36005.456	34144.213	36005.134	34144.191	35973.813	34126.241	35972.079	34108.293	35970.338	34088.763	35968.457
<i>Northing</i>	<i>Easting</i>																																				
34055.946	35983.982																																				
34064.776	36011.293																																				
34071.181	36016.449																																				
34098.236	36020.088																																				
34100.366	36020.296																																				
34106.673	36019.895																																				
34113.313	36018.883																																				
34119.838	36017.292																																				
34126.199	36015.135																																				
34132.346	36012.429																																				
34138.232	36009.195																																				
34143.813	36005.456																																				
34144.213	36005.134																																				
34144.191	35973.813																																				
34126.241	35972.079																																				
34108.293	35970.338																																				
34088.763	35968.457																																				

THE SCHEDULE — *continued*

<i>First column</i>	<i>Second column</i>	
The Authority	Protected Place	
	34086.984	35986.928
	34083.800	35986.683
	34070.043	35985.386

to the point of commencement.

The boundaries of “EUNOS FLYOVER SUBSTATION” are more particularly delineated in the Survey Plan set out below.

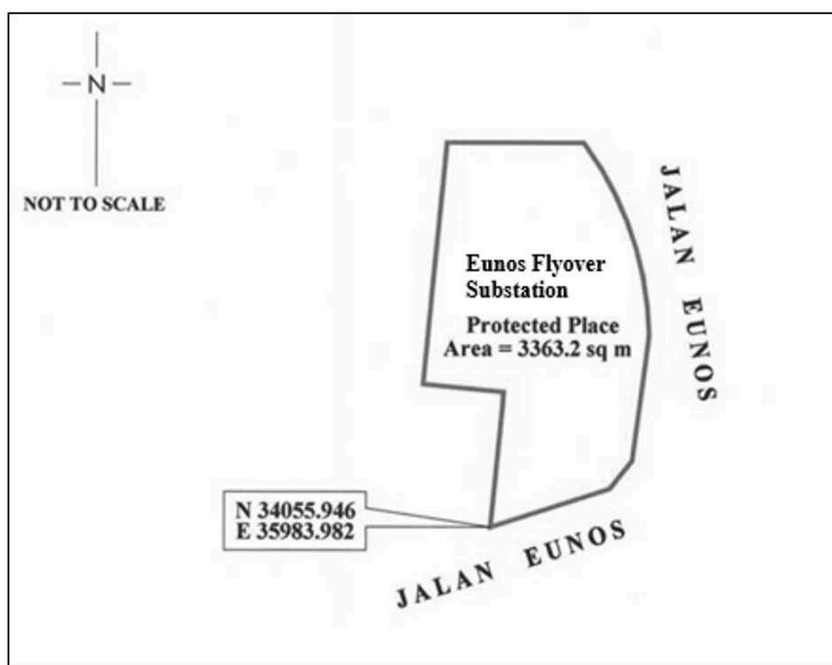

THE SCHEDULE — *continued*

<i>First column</i>	<i>Second column</i>																																				
The Authority	Protected Place																																				
8. Chief Executive Officer, SP PowerGrid Ltd	<p>EUNOS SUBSTATION</p> <p>All that area comprised in part of Lot 06423W in Mukim No. 23 occupied by “EUNOS SUBSTATION” containing an area of about 8877.3 square metres and bounded approximately as follows:</p> <p>Commencing at a point 33492.978 metres North and 35447.346 metres East of the Singapore Land Authority SVY 21 Datum, the boundaries run along successive lines of coordinates approximately as follows:</p> <table border="0" style="margin-left: auto; margin-right: auto;"> <thead> <tr> <th style="text-align: left;"><i>Northing</i></th> <th style="text-align: left;"><i>Easting</i></th> </tr> </thead> <tbody> <tr><td>33492.978</td><td>35447.346</td></tr> <tr><td>33494.013</td><td>35452.350</td></tr> <tr><td>33497.401</td><td>35470.523</td></tr> <tr><td>33512.942</td><td>35550.048</td></tr> <tr><td>33513.006</td><td>35550.866</td></tr> <tr><td>33508.557</td><td>35551.760</td></tr> <tr><td>33486.004</td><td>35556.191</td></tr> <tr><td>33482.524</td><td>35556.815</td></tr> <tr><td>33455.388</td><td>35562.222</td></tr> <tr><td>33430.079</td><td>35567.154</td></tr> <tr><td>33424.974</td><td>35540.591</td></tr> <tr><td>33423.898</td><td>35535.326</td></tr> <tr><td>33418.455</td><td>35508.313</td></tr> <tr><td>33411.934</td><td>35475.561</td></tr> <tr><td>33412.231</td><td>35472.381</td></tr> <tr><td>33413.618</td><td>35467.334</td></tr> <tr><td>33415.311</td><td>35462.548</td></tr> </tbody> </table>	<i>Northing</i>	<i>Easting</i>	33492.978	35447.346	33494.013	35452.350	33497.401	35470.523	33512.942	35550.048	33513.006	35550.866	33508.557	35551.760	33486.004	35556.191	33482.524	35556.815	33455.388	35562.222	33430.079	35567.154	33424.974	35540.591	33423.898	35535.326	33418.455	35508.313	33411.934	35475.561	33412.231	35472.381	33413.618	35467.334	33415.311	35462.548
<i>Northing</i>	<i>Easting</i>																																				
33492.978	35447.346																																				
33494.013	35452.350																																				
33497.401	35470.523																																				
33512.942	35550.048																																				
33513.006	35550.866																																				
33508.557	35551.760																																				
33486.004	35556.191																																				
33482.524	35556.815																																				
33455.388	35562.222																																				
33430.079	35567.154																																				
33424.974	35540.591																																				
33423.898	35535.326																																				
33418.455	35508.313																																				
33411.934	35475.561																																				
33412.231	35472.381																																				
33413.618	35467.334																																				
33415.311	35462.548																																				

THE SCHEDULE — *continued*

<i>First column</i>	<i>Second column</i>
The Authority	Protected Place
	33451.332 35455.584
	33477.558 35450.389
	33477.524 35453.723
	33477.819 35453.656
	33478.380 35453.413
	33484.750 35452.102
	33485.226 35452.031
	33485.394 35451.904
	33484.762 35448.862

to the point of commencement.

The boundaries of “EUNOS SUBSTATION” are more particularly delineated in the Survey Plan set out below.

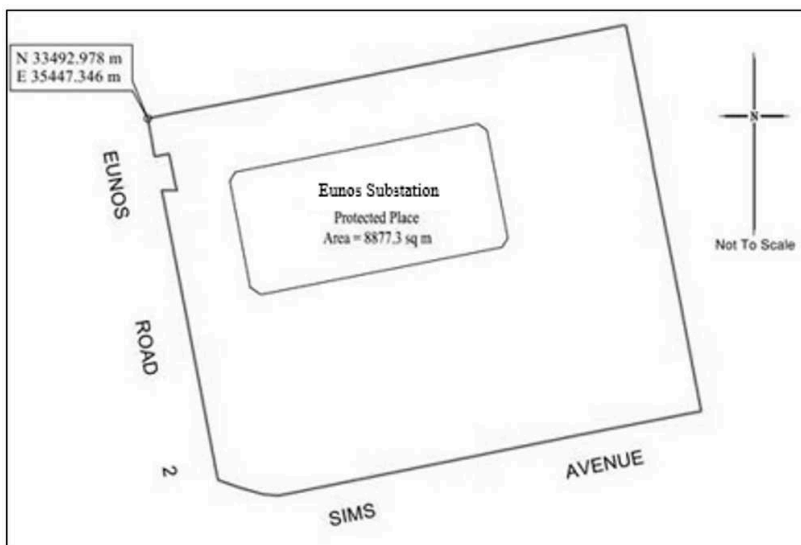

THE SCHEDULE — *continued*

<i>First column</i>	<i>Second column</i>																																				
The Authority	Protected Place																																				
9. Chief Executive Officer, SP PowerGrid Ltd	<p>FLORA DRIVE SUBSTATION</p> <p>All that area comprised in part of Lot 04641W in Mukim No. 31 occupied by “FLORA DRIVE SUBSTATION” containing an area of about 1740.4 square metres and bounded approximately as follows:</p> <p>Commencing at a point 37542.923 metres North and 42741.157 metres East of the Singapore Land Authority SVY 21 Datum, the boundaries run along successive lines of coordinates approximately as follows:</p> <table border="0" style="margin-left: auto; margin-right: auto;"> <thead> <tr> <th style="text-align: left;"><i>Northing</i></th> <th style="text-align: left;"><i>Easting</i></th> </tr> </thead> <tbody> <tr><td>37542.923</td><td>42741.157</td></tr> <tr><td>37540.098</td><td>42742.447</td></tr> <tr><td>37534.666</td><td>42744.914</td></tr> <tr><td>37528.397</td><td>42747.768</td></tr> <tr><td>37528.451</td><td>42747.894</td></tr> <tr><td>37528.340</td><td>42747.945</td></tr> <tr><td>37519.632</td><td>42751.914</td></tr> <tr><td>37508.371</td><td>42757.002</td></tr> <tr><td>37498.191</td><td>42762.225</td></tr> <tr><td>37501.522</td><td>42773.059</td></tr> <tr><td>37504.446</td><td>42782.574</td></tr> <tr><td>37507.404</td><td>42792.012</td></tr> <tr><td>37520.885</td><td>42788.202</td></tr> <tr><td>37535.249</td><td>42784.173</td></tr> <tr><td>37549.560</td><td>42780.081</td></tr> <tr><td>37550.368</td><td>42772.912</td></tr> <tr><td>37551.702</td><td>42760.543</td></tr> </tbody> </table>	<i>Northing</i>	<i>Easting</i>	37542.923	42741.157	37540.098	42742.447	37534.666	42744.914	37528.397	42747.768	37528.451	42747.894	37528.340	42747.945	37519.632	42751.914	37508.371	42757.002	37498.191	42762.225	37501.522	42773.059	37504.446	42782.574	37507.404	42792.012	37520.885	42788.202	37535.249	42784.173	37549.560	42780.081	37550.368	42772.912	37551.702	42760.543
<i>Northing</i>	<i>Easting</i>																																				
37542.923	42741.157																																				
37540.098	42742.447																																				
37534.666	42744.914																																				
37528.397	42747.768																																				
37528.451	42747.894																																				
37528.340	42747.945																																				
37519.632	42751.914																																				
37508.371	42757.002																																				
37498.191	42762.225																																				
37501.522	42773.059																																				
37504.446	42782.574																																				
37507.404	42792.012																																				
37520.885	42788.202																																				
37535.249	42784.173																																				
37549.560	42780.081																																				
37550.368	42772.912																																				
37551.702	42760.543																																				

THE SCHEDULE — *continued*

<i>First column</i>	<i>Second column</i>
The Authority	Protected Place
	37547.187 42750.496
	37543.017 42741.363

to the point of commencement.

The boundaries of “FLORA DRIVE SUBSTATION” are more particularly delineated in the Survey Plan set out below.

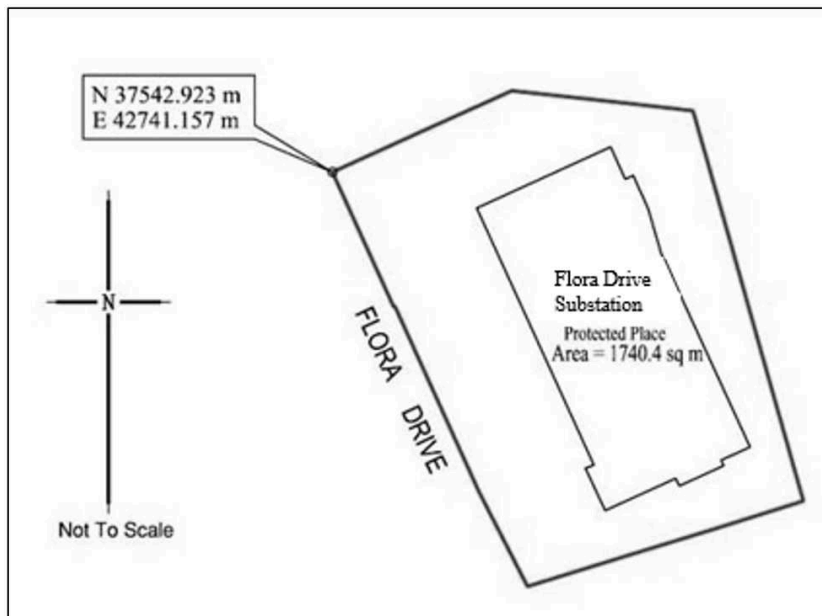

THE SCHEDULE — *continued*

<i>First column</i>	<i>Second column</i>																																				
The Authority	Protected Place																																				
10. Chief Executive Officer, SP PowerGrid Ltd	<p>GEORGE STREET SUBSTATION</p> <p>All that area comprised in part of Lots 00199W and 00611C in Town Subdivision No. 4 occupied by “GEORGE STREET SUBSTATION” containing an area of about 853.1 square metres and bounded approximately as follows:</p> <p>Commencing at a point 29801.609 metres North and 29664.100 metres East of the Singapore Land Authority SVY 21 Datum, the boundaries run along successive lines of coordinates approximately as follows:</p> <table border="0" style="margin-left: auto; margin-right: auto;"> <thead> <tr> <th style="text-align: left;"><i>Northing</i></th> <th style="text-align: left;"><i>Easting</i></th> </tr> </thead> <tbody> <tr><td>29801.609</td><td>29664.100</td></tr> <tr><td>29809.708</td><td>29668.052</td></tr> <tr><td>29808.676</td><td>29670.173</td></tr> <tr><td>29809.430</td><td>29670.536</td></tr> <tr><td>29810.292</td><td>29670.219</td></tr> <tr><td>29811.483</td><td>29670.241</td></tr> <tr><td>29812.562</td><td>29670.744</td></tr> <tr><td>29813.344</td><td>29671.643</td></tr> <tr><td>29813.693</td><td>29672.782</td></tr> <tr><td>29813.549</td><td>29673.965</td></tr> <tr><td>29813.042</td><td>29674.871</td></tr> <tr><td>29812.554</td><td>29675.546</td></tr> <tr><td>29811.890</td><td>29676.899</td></tr> <tr><td>29811.935</td><td>29677.320</td></tr> <tr><td>29799.646</td><td>29702.348</td></tr> <tr><td>29799.267</td><td>29702.677</td></tr> <tr><td>29798.625</td><td>29703.990</td></tr> </tbody> </table>	<i>Northing</i>	<i>Easting</i>	29801.609	29664.100	29809.708	29668.052	29808.676	29670.173	29809.430	29670.536	29810.292	29670.219	29811.483	29670.241	29812.562	29670.744	29813.344	29671.643	29813.693	29672.782	29813.549	29673.965	29813.042	29674.871	29812.554	29675.546	29811.890	29676.899	29811.935	29677.320	29799.646	29702.348	29799.267	29702.677	29798.625	29703.990
<i>Northing</i>	<i>Easting</i>																																				
29801.609	29664.100																																				
29809.708	29668.052																																				
29808.676	29670.173																																				
29809.430	29670.536																																				
29810.292	29670.219																																				
29811.483	29670.241																																				
29812.562	29670.744																																				
29813.344	29671.643																																				
29813.693	29672.782																																				
29813.549	29673.965																																				
29813.042	29674.871																																				
29812.554	29675.546																																				
29811.890	29676.899																																				
29811.935	29677.320																																				
29799.646	29702.348																																				
29799.267	29702.677																																				
29798.625	29703.990																																				

THE SCHEDULE — *continued*

<i>First column</i>		<i>Second column</i>
The Authority		Protected Place
	29798.456	29704.626
	29798.012	29705.697
	29797.155	29706.525
	29796.038	29706.939
	29794.849	29706.867
	29793.789	29706.322
	29793.038	29705.397
	29792.751	29704.504
	29792.041	29704.170
	29790.972	29706.318
	29782.902	29702.362
	29783.967	29700.214
	29783.254	29699.859
	29782.066	29700.217
	29780.884	29700.072
	29779.860	29699.462
	29779.170	29698.492
	29778.929	29697.325
	29779.180	29696.160
	29779.879	29695.195
	29780.976	29694.563
	29780.696	29693.055
	29792.955	29668.026
	29794.266	29667.155
	29794.154	29665.964
	29794.531	29664.834
	29795.333	29663.952

THE SCHEDULE — *continued*

<i>First column</i>	<i>Second column</i>
The Authority	Protected Place
29796.422	29663.470
29797.614	29663.469
29798.704	29663.949
29799.507	29664.829
29799.878	29665.904
29800.576	29666.222

to the point of commencement.

The boundaries of “GEORGE STREET SUBSTATION” are more particularly delineated in the Survey Plan set out below.

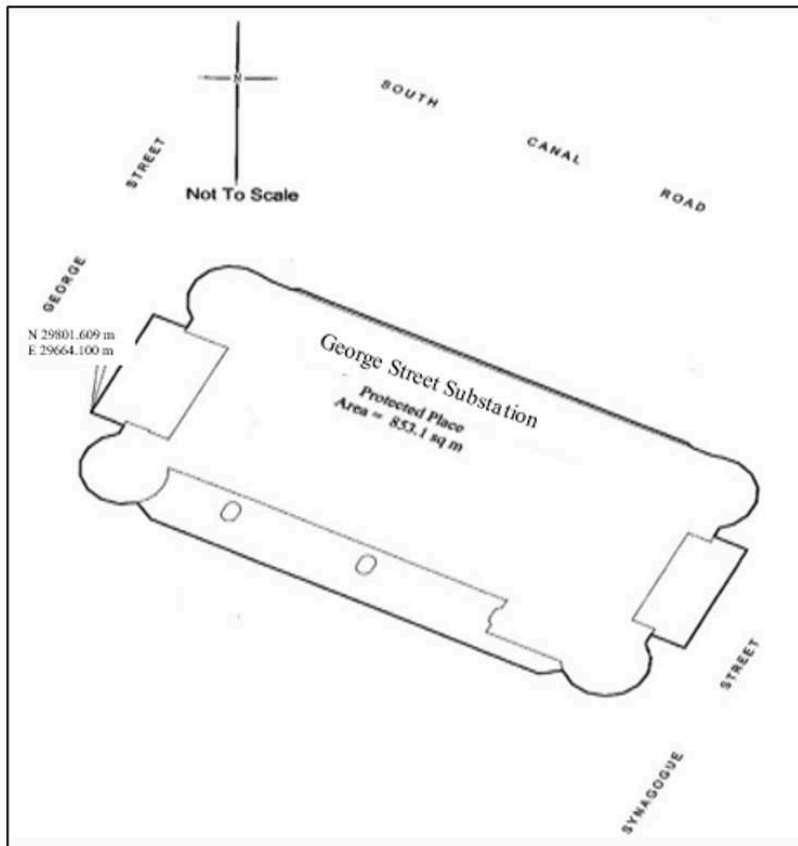

Made on 22 January 2024.

PANG KIN KEONG
*Permanent Secretary,
Ministry of Home Affairs,
Singapore.*

[SPF/CPS/C/09/02/03; AG/LEGIS/SL/137B/2020/2 Vol. 15]