First published in the *Government Gazette*, Electronic Edition, on 12th February 2016 at 5:00 pm.

No. S 65

PROTECTED AREAS AND PROTECTED PLACES ACT
(CHAPTER 256)

PROTECTED PLACES ORDER 2016

ARRANGEMENT OF PARAGRAPHS

Paragraph

1. Citation and commencement
 2. Premises declared to be protected places
The Schedule
-

In exercise of the powers conferred by section 5(1) of the Protected Areas and Protected Places Act, the Minister for Home Affairs makes the following Order:

Citation and commencement

1. This Order is the Protected Places Order 2016 and comes into operation on 12 February 2016.

Premises declared to be protected places

2.—(1) The premises described in the second column of the Schedule are declared to be protected places for the purposes of the Act.

(2) No person may enter or remain in those premises unless the person —

- (a) is in possession of a pass-card or permit issued by the authority specified in the first column of the Schedule; or
- (b) has received the permission of an authorised officer on duty at those premises to enter those premises.

 THE SCHEDULE

<i>First column</i>	<i>Second column</i>																						
The Authority	Protected Place																						
Director, Water Supply (Network) Department, Public Utilities Board	(1) Sentosa Service Reservoir All that area comprised in part of State Land Lot 02869V Pt in Mukim No. 34 occupied by “Sentosa Service Reservoir” containing an area of about 2,512 square metres and bounded approximately as follows: Commencing at a point 26048.013 metres North and 27989.986 metres East of the Singapore Land Authority SVY 21 Datum, the boundaries run along successive lines of coordinates approximately as follows: <table border="0" style="margin-left: 40px;"> <thead> <tr> <th style="text-align: center;"><i>Northing</i></th> <th style="text-align: center;"><i>Easting</i></th> </tr> </thead> <tbody> <tr><td style="text-align: center;">26048.013</td><td style="text-align: center;">27989.986</td></tr> <tr><td style="text-align: center;">26018.781</td><td style="text-align: center;">27961.902</td></tr> <tr><td style="text-align: center;">25992.828</td><td style="text-align: center;">27989.675</td></tr> <tr><td style="text-align: center;">25990.615</td><td style="text-align: center;">27995.988</td></tr> <tr><td style="text-align: center;">25976.349</td><td style="text-align: center;">28011.502</td></tr> <tr><td style="text-align: center;">25982.038</td><td style="text-align: center;">28016.967</td></tr> <tr><td style="text-align: center;">28981.985</td><td style="text-align: center;">28021.036</td></tr> <tr><td style="text-align: center;">25995.735</td><td style="text-align: center;">28034.859</td></tr> <tr><td style="text-align: center;">26009.498</td><td style="text-align: center;">28020.648</td></tr> <tr><td style="text-align: center;">26014.284</td><td style="text-align: center;">28025.254</td></tr> </tbody> </table> <p style="margin-left: 40px;">to the point of commencement.</p> <p style="margin-left: 40px;">The boundaries of “Sentosa Service Reservoir” are more particularly delineated in the Survey Plan Ref. No. 3P/SSR/BDY/A4-1 set out below.</p>	<i>Northing</i>	<i>Easting</i>	26048.013	27989.986	26018.781	27961.902	25992.828	27989.675	25990.615	27995.988	25976.349	28011.502	25982.038	28016.967	28981.985	28021.036	25995.735	28034.859	26009.498	28020.648	26014.284	28025.254
<i>Northing</i>	<i>Easting</i>																						
26048.013	27989.986																						
26018.781	27961.902																						
25992.828	27989.675																						
25990.615	27995.988																						
25976.349	28011.502																						
25982.038	28016.967																						
28981.985	28021.036																						
25995.735	28034.859																						
26009.498	28020.648																						
26014.284	28025.254																						

THE SCHEDULE — *continued**First column**Second column*

The Authority

Protected Place

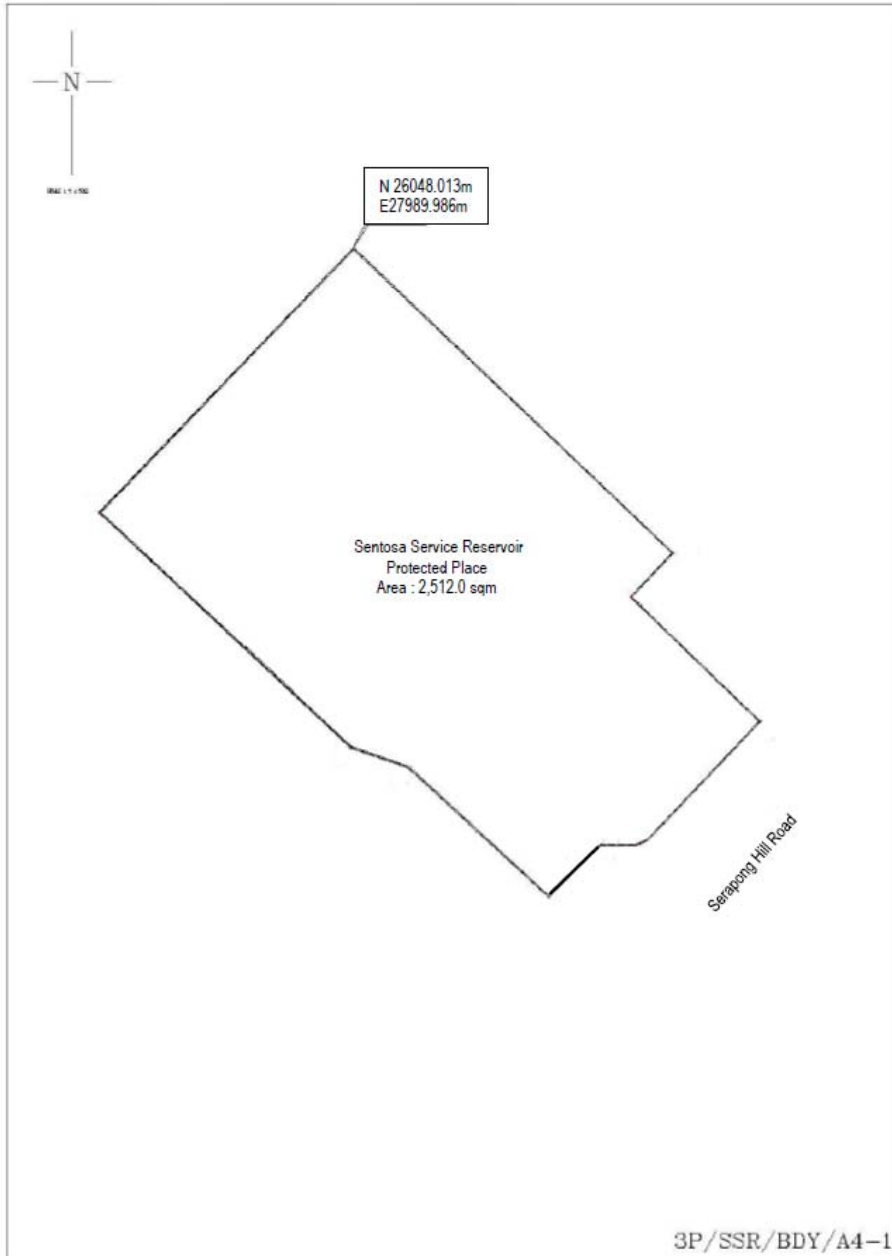

THE SCHEDULE — *continued*

<i>First column</i>	<i>Second column</i>																																				
The Authority	Protected Place																																				
Director, Water Supply (Network) Department, Public Utilities Board	<p>(2) Sentosa Booster Station</p> <p>All that area comprised in part of State Land Lot 02846N Pt in Mukim No. 34 occupied by “Sentosa Booster Station” containing an area of about 3,035.8 square metres and bounded approximately as follows:</p> <p>Commencing at a point 25502.145 metres North and 28140.580 metres East of the Singapore Land Authority SVY 21 Datum, the boundaries run along successive lines of coordinates approximately as follows:</p> <table border="0" style="margin-left: 40px;"> <thead> <tr> <th style="text-align: left;"><i>Northing</i></th> <th style="text-align: left;"><i>Easting</i></th> </tr> </thead> <tbody> <tr><td>25502.145</td><td>28140.580</td></tr> <tr><td>25468.282</td><td>28131.441</td></tr> <tr><td>25463.948</td><td>28135.298</td></tr> <tr><td>25462.830</td><td>28136.438</td></tr> <tr><td>25462.207</td><td>28137.908</td></tr> <tr><td>25453.978</td><td>28168.253</td></tr> <tr><td>25452.408</td><td>28168.087</td></tr> <tr><td>25447.401</td><td>28185.340</td></tr> <tr><td>25453.628</td><td>28187.093</td></tr> <tr><td>25449.997</td><td>28202.952</td></tr> <tr><td>25458.810</td><td>28210.598</td></tr> <tr><td>25461.613</td><td>28210.827</td></tr> <tr><td>25465.911</td><td>28211.912</td></tr> <tr><td>25470.277</td><td>28209.773</td></tr> <tr><td>25475.153</td><td>28207.857</td></tr> <tr><td>25481.787</td><td>25205.636</td></tr> <tr><td>25487.383</td><td>28203.957</td></tr> </tbody> </table>	<i>Northing</i>	<i>Easting</i>	25502.145	28140.580	25468.282	28131.441	25463.948	28135.298	25462.830	28136.438	25462.207	28137.908	25453.978	28168.253	25452.408	28168.087	25447.401	28185.340	25453.628	28187.093	25449.997	28202.952	25458.810	28210.598	25461.613	28210.827	25465.911	28211.912	25470.277	28209.773	25475.153	28207.857	25481.787	25205.636	25487.383	28203.957
<i>Northing</i>	<i>Easting</i>																																				
25502.145	28140.580																																				
25468.282	28131.441																																				
25463.948	28135.298																																				
25462.830	28136.438																																				
25462.207	28137.908																																				
25453.978	28168.253																																				
25452.408	28168.087																																				
25447.401	28185.340																																				
25453.628	28187.093																																				
25449.997	28202.952																																				
25458.810	28210.598																																				
25461.613	28210.827																																				
25465.911	28211.912																																				
25470.277	28209.773																																				
25475.153	28207.857																																				
25481.787	25205.636																																				
25487.383	28203.957																																				

 THE SCHEDULE — *continued*

<i>First column</i>	<i>Second column</i>
The Authority	Protected Place
25490.411	28203.498
25482.735	28196.824
25496.519	28191.741
25497.325	28184.182
25492.418	28178.149
25501.785	28143.570

to the point of commencement.

The boundaries of “Sentosa Booster Station” are more particularly delineated in the Survey Plan Ref. No. 3P/SBS/BDY/A4-1 set out below.

THE SCHEDULE — *continued*

First column

Second column

The Authority

Protected Place

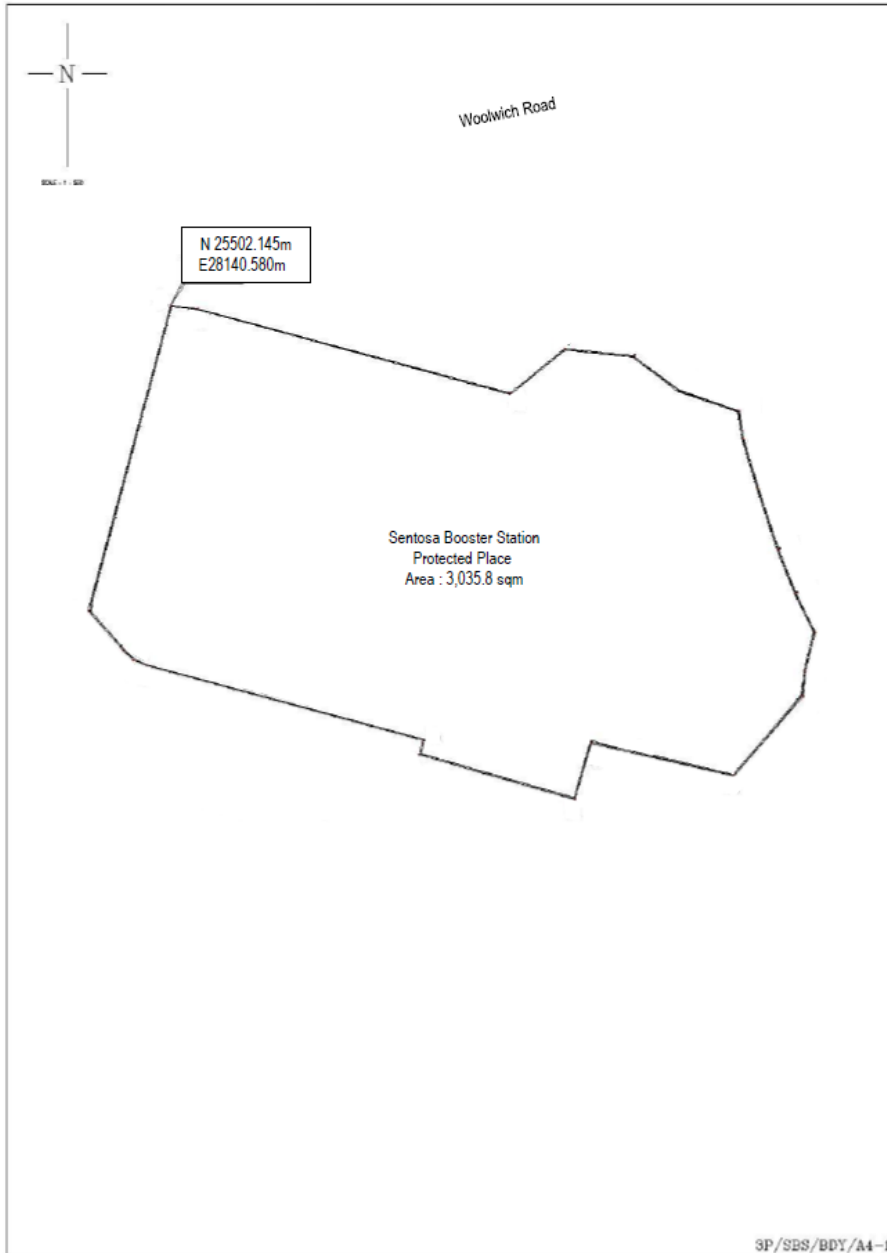

 THE SCHEDULE — *continued*

<i>First column</i>	<i>Second column</i>																																				
The Authority	Protected Place																																				
Director, Water Supply (Network) Department, Public Utilities Board	(3) Tampines NEWater Service Reservoir All that area comprised in part of State Land Lot 02371N in Mukim No. 29 occupied by “Tampines NEWater Service Reservoir” containing an area of about 17,331.3 square metres and bounded approximately as follows: Commencing at a point 39081.739 metres North and 38312.257 metres East of the Singapore Land Authority SVY 21 Datum, the boundaries run along successive lines of coordinates approximately as follows: <table border="0" style="margin-left: 40px;"> <thead> <tr> <th style="text-align: left;"><i>Northing</i></th> <th style="text-align: left;"><i>Easting</i></th> </tr> </thead> <tbody> <tr><td>39081.739</td><td>38312.257</td></tr> <tr><td>38978.900</td><td>38268.015</td></tr> <tr><td>38944.509</td><td>38263.237</td></tr> <tr><td>38928.401</td><td>38246.378</td></tr> <tr><td>38908.362</td><td>38237.380</td></tr> <tr><td>38904.477</td><td>38242.044</td></tr> <tr><td>38896.871</td><td>38252.641</td></tr> <tr><td>38893.308</td><td>38257.829</td></tr> <tr><td>38870.908</td><td>38285.741</td></tr> <tr><td>38869.000</td><td>38289.930</td></tr> <tr><td>38866.156</td><td>38296.900</td></tr> <tr><td>38863.337</td><td>38304.876</td></tr> <tr><td>38861.020</td><td>38316.689</td></tr> <tr><td>38860.119</td><td>38323.317</td></tr> <tr><td>38862.720</td><td>38322.245</td></tr> <tr><td>38866.014</td><td>38321.333</td></tr> <tr><td>38870.124</td><td>38321.283</td></tr> </tbody> </table>	<i>Northing</i>	<i>Easting</i>	39081.739	38312.257	38978.900	38268.015	38944.509	38263.237	38928.401	38246.378	38908.362	38237.380	38904.477	38242.044	38896.871	38252.641	38893.308	38257.829	38870.908	38285.741	38869.000	38289.930	38866.156	38296.900	38863.337	38304.876	38861.020	38316.689	38860.119	38323.317	38862.720	38322.245	38866.014	38321.333	38870.124	38321.283
<i>Northing</i>	<i>Easting</i>																																				
39081.739	38312.257																																				
38978.900	38268.015																																				
38944.509	38263.237																																				
38928.401	38246.378																																				
38908.362	38237.380																																				
38904.477	38242.044																																				
38896.871	38252.641																																				
38893.308	38257.829																																				
38870.908	38285.741																																				
38869.000	38289.930																																				
38866.156	38296.900																																				
38863.337	38304.876																																				
38861.020	38316.689																																				
38860.119	38323.317																																				
38862.720	38322.245																																				
38866.014	38321.333																																				
38870.124	38321.283																																				

THE SCHEDULE — *continued*

<i>First column</i>	<i>Second column</i>
The Authority	Protected Place
38872.002	38321.564
38884.901	38325.536
38911.642	38335.145
39058.769	38387.799

to the point of commencement.

The boundaries of “Tampines NEWater Service Reservoir” are more particularly delineated in the Survey Plan Ref. No. 3P/TR/BDY/A4-1 set out below.

THE SCHEDULE — *continued**First column**Second column*

The Authority

Protected Place

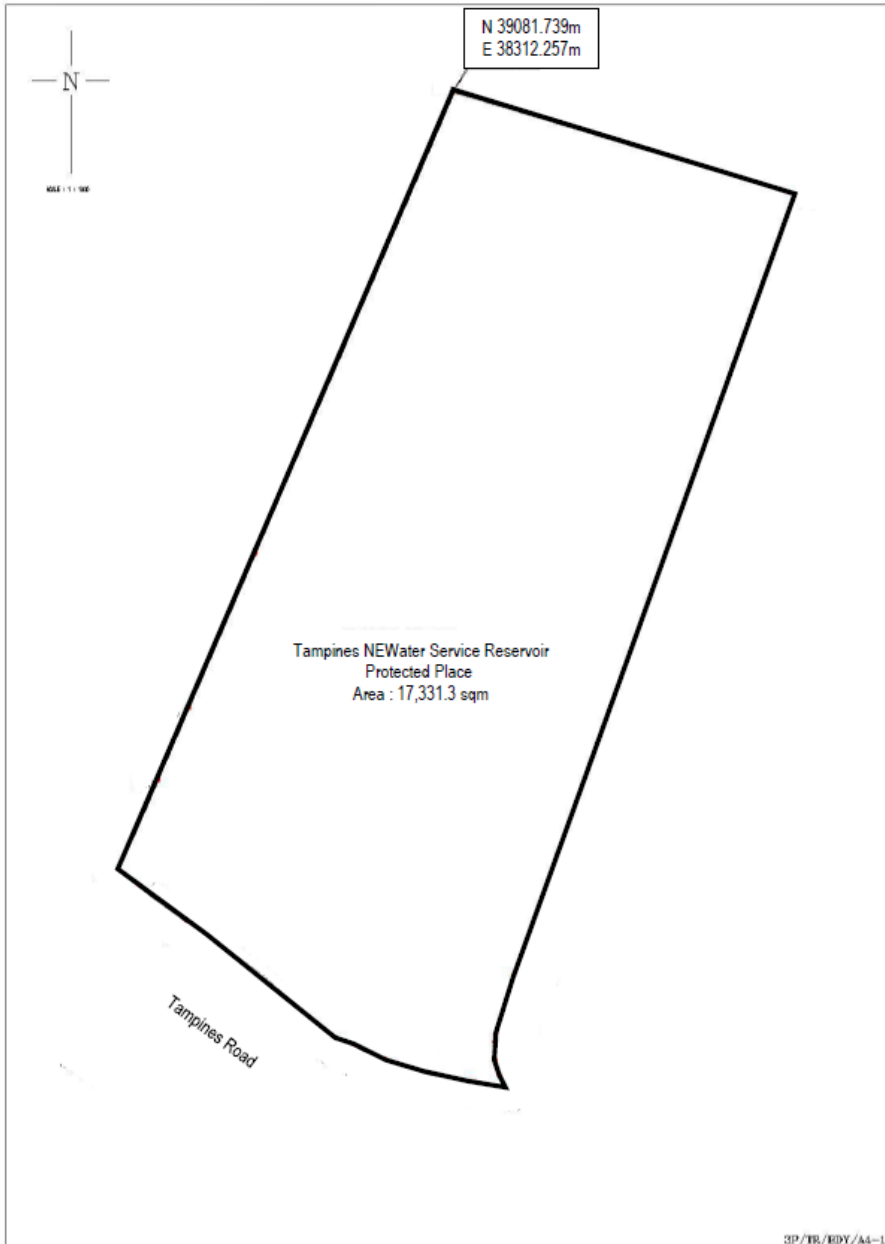

THE SCHEDULE — *continued*

<i>First column</i>	<i>Second column</i>																																				
The Authority	Protected Place																																				
Director, Water Supply (Network) Department, Public Utilities Board	<p>(4) Mandai Hill NEWater Service Reservoir</p> <p>All that area comprised in part of State Land Lots 06127M Pt and 05754V Pt in Mukim No. 13 occupied by “Mandai Hill NEWater Service Reservoir” containing an area of about 16,956.5 square metres and bounded approximately as follows:</p> <p>Commencing at a point 43968.995 metres North and 22557.980 metres East of the Singapore Land Authority SVY 21 Datum, the boundaries run along successive lines of coordinates approximately as follows:</p> <table border="0" style="margin-left: 40px;"> <thead> <tr> <th style="text-align: left;"><i>Northing</i></th> <th style="text-align: left;"><i>Easting</i></th> </tr> </thead> <tbody> <tr><td>43968.995</td><td>22557.980</td></tr> <tr><td>43976.493</td><td>22559.225</td></tr> <tr><td>43987.755</td><td>22561.040</td></tr> <tr><td>44045.592</td><td>22570.428</td></tr> <tr><td>44047.015</td><td>22570.682</td></tr> <tr><td>44049.425</td><td>22571.323</td></tr> <tr><td>44053.379</td><td>22572.657</td></tr> <tr><td>44056.740</td><td>22574.163</td></tr> <tr><td>44060.213</td><td>22576.022</td></tr> <tr><td>44063.582</td><td>22578.168</td></tr> <tr><td>44066.763</td><td>22580.581</td></tr> <tr><td>44068.480</td><td>22582.046</td></tr> <tr><td>44070.236</td><td>22583.709</td></tr> <tr><td>44072.430</td><td>22586.080</td></tr> <tr><td>44075.095</td><td>22589.239</td></tr> <tr><td>44116.177</td><td>22638.705</td></tr> <tr><td>44110.985</td><td>22643.035</td></tr> </tbody> </table>	<i>Northing</i>	<i>Easting</i>	43968.995	22557.980	43976.493	22559.225	43987.755	22561.040	44045.592	22570.428	44047.015	22570.682	44049.425	22571.323	44053.379	22572.657	44056.740	22574.163	44060.213	22576.022	44063.582	22578.168	44066.763	22580.581	44068.480	22582.046	44070.236	22583.709	44072.430	22586.080	44075.095	22589.239	44116.177	22638.705	44110.985	22643.035
<i>Northing</i>	<i>Easting</i>																																				
43968.995	22557.980																																				
43976.493	22559.225																																				
43987.755	22561.040																																				
44045.592	22570.428																																				
44047.015	22570.682																																				
44049.425	22571.323																																				
44053.379	22572.657																																				
44056.740	22574.163																																				
44060.213	22576.022																																				
44063.582	22578.168																																				
44066.763	22580.581																																				
44068.480	22582.046																																				
44070.236	22583.709																																				
44072.430	22586.080																																				
44075.095	22589.239																																				
44116.177	22638.705																																				
44110.985	22643.035																																				

 THE SCHEDULE — *continued*

<i>First column</i>	<i>Second column</i>
The Authority	Protected Place
44121.130	22655.413
44126.425	22651.002
44134.373	22660.592
44025.164	22751.316
44030.413	22741.610
43992.819	22671.916
43981.150	22669.446
43994.542	22605.083
43973.344	22601.610
43975.184	22590.441
43971.403	22589.907
43973.449	22576.303
43966.489	22575.175

to the point of commencement.

The boundaries of “Mandai Hill NEWater Service Reservoir” are more particularly delineated in the Survey Plan Ref. No. 3P/MR/BDY/A4-1 set out below.

THE SCHEDULE — *continued*

First column

Second column

The Authority

Protected Place

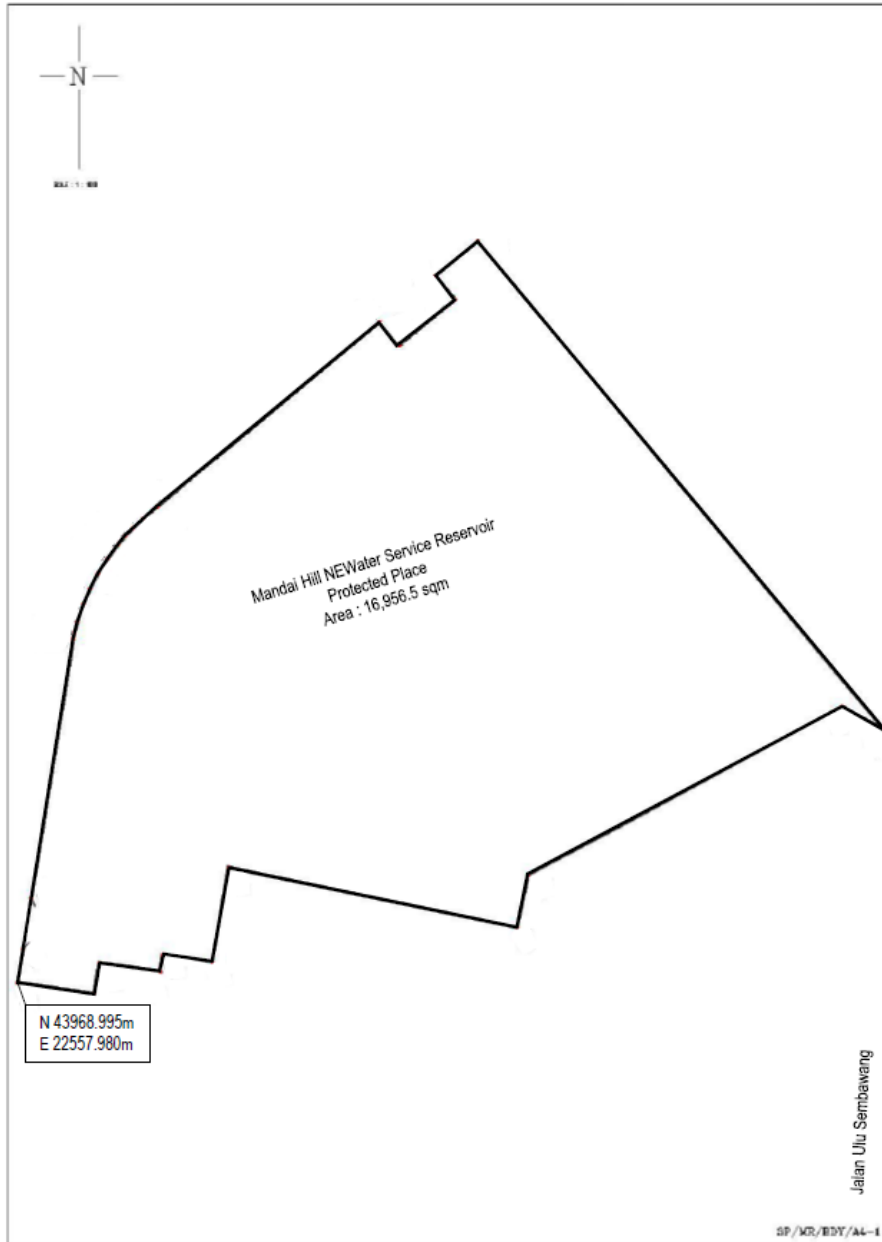

 THE SCHEDULE — *continued*

<i>First column</i>	<i>Second column</i>																																				
The Authority	Protected Place																																				
Director, Water Supply (Network) Department, Public Utilities Board	<p>(5) Woodlands NEWater Service Reservoir</p> <p>All that area comprised in part of State Land Lot 1952V Pt in Mukim No. 13 occupied by “Woodlands NEWater Service Reservoir” containing an area of about 14,455.3 square metres and bounded approximately as follows:</p> <p>Commencing at a point 45910.917 metres North and 20985.540 metres East of the Singapore Land Authority SVY 21 Datum, the boundaries run along successive lines of coordinates approximately as follows:</p> <table border="0" style="margin-left: 40px;"> <thead> <tr> <th style="text-align: left;"><i>Northing</i></th> <th style="text-align: left;"><i>Easting</i></th> </tr> </thead> <tbody> <tr><td>45910.917</td><td>20985.540</td></tr> <tr><td>45933.276</td><td>21069.743</td></tr> <tr><td>45935.064</td><td>21079.407</td></tr> <tr><td>45916.544</td><td>21083.386</td></tr> <tr><td>45917.915</td><td>21090.168</td></tr> <tr><td>45924.685</td><td>21089.232</td></tr> <tr><td>45928.312</td><td>21117.422</td></tr> <tr><td>45855.575</td><td>21119.068</td></tr> <tr><td>45857.132</td><td>21148.874</td></tr> <tr><td>45808.878</td><td>21149.941</td></tr> <tr><td>45706.994</td><td>21151.915</td></tr> <tr><td>45705.056</td><td>21060.032</td></tr> <tr><td>45785.241</td><td>20996.775</td></tr> <tr><td>45814.438</td><td>20995.571</td></tr> <tr><td>45799.980</td><td>20957.332</td></tr> <tr><td>45869.276</td><td>20955.972</td></tr> <tr><td>48570.646</td><td>20963.113</td></tr> </tbody> </table>	<i>Northing</i>	<i>Easting</i>	45910.917	20985.540	45933.276	21069.743	45935.064	21079.407	45916.544	21083.386	45917.915	21090.168	45924.685	21089.232	45928.312	21117.422	45855.575	21119.068	45857.132	21148.874	45808.878	21149.941	45706.994	21151.915	45705.056	21060.032	45785.241	20996.775	45814.438	20995.571	45799.980	20957.332	45869.276	20955.972	48570.646	20963.113
<i>Northing</i>	<i>Easting</i>																																				
45910.917	20985.540																																				
45933.276	21069.743																																				
45935.064	21079.407																																				
45916.544	21083.386																																				
45917.915	21090.168																																				
45924.685	21089.232																																				
45928.312	21117.422																																				
45855.575	21119.068																																				
45857.132	21148.874																																				
45808.878	21149.941																																				
45706.994	21151.915																																				
45705.056	21060.032																																				
45785.241	20996.775																																				
45814.438	20995.571																																				
45799.980	20957.332																																				
45869.276	20955.972																																				
48570.646	20963.113																																				

 THE SCHEDULE — *continued*

<i>First column</i>	<i>Second column</i>
The Authority	Protected Place
45881.817	20966.208
45906.209	20959.497
45855.797	21119.063
45854.777	21101.872
45840.063	21062.816

to the point of commencement.

The boundaries of “Woodlands NEWater Service Reservoir” are more particularly delineated in the Survey Plan Ref. No. 3P/WAS/BDY/A4-1 set out below.

THE SCHEDULE — *continued**First column**Second column*

The Authority

Protected Place

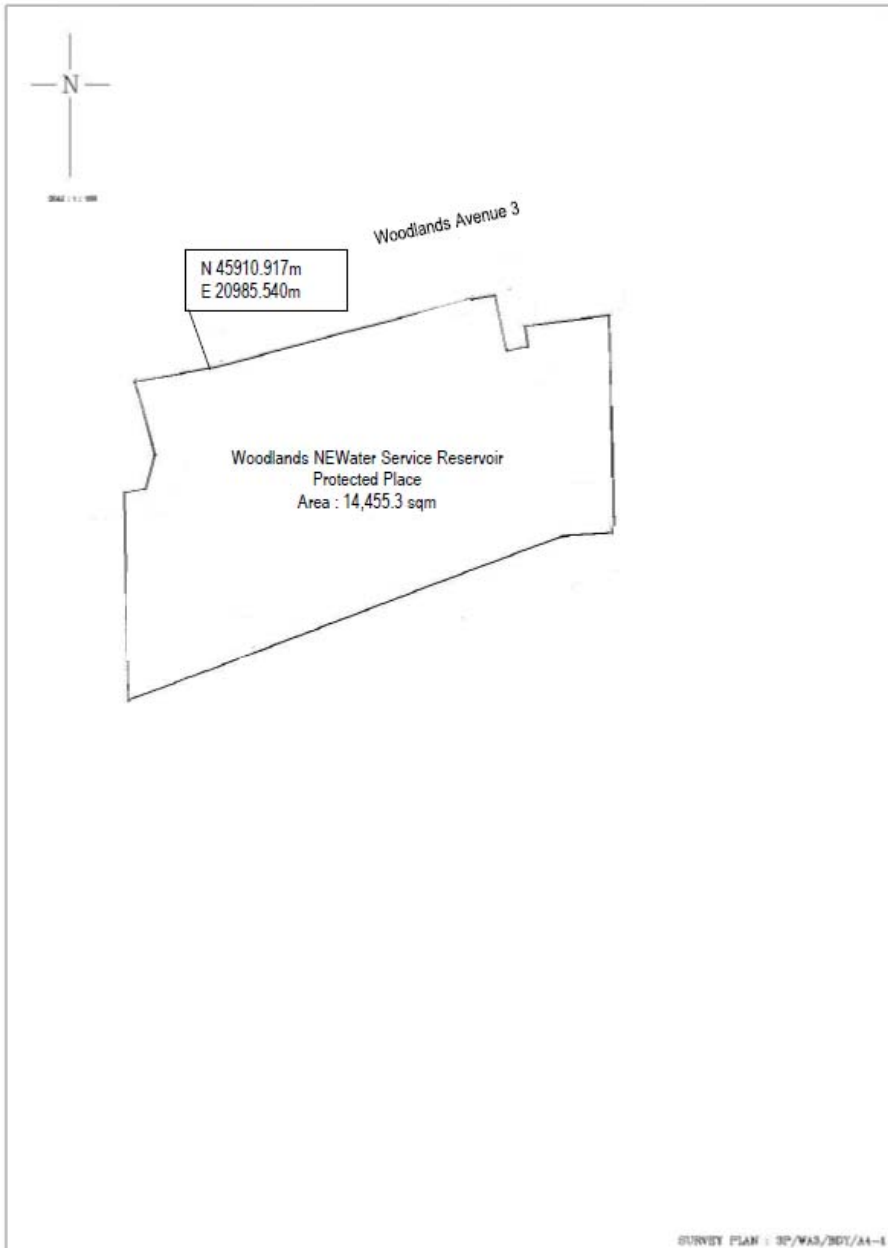

THE SCHEDULE — *continued*

<i>First column</i>	<i>Second column</i>																																				
The Authority	Protected Place																																				
Director, Water Supply (Network) Department, Public Utilities Board	<p>(6) Kent Ridge NEWater Service Reservoir</p> <p>All that area comprised in part of State Land Lot 01097T Pt in Mukim No. 3 occupied by “Kent Ridge NEWater Service Reservoir” containing an area of about 11,965.3 square metres and bounded approximately as follows:</p> <p>Commencing at a point 30259.265 metres North and 22440.275 metres East of the Singapore Land Authority SVY 21 Datum, the boundaries run along successive lines of coordinates approximately as follows:</p> <table border="0" style="margin-left: 40px;"> <thead> <tr> <th style="text-align: center;"><i>Northing</i></th> <th style="text-align: center;"><i>Easting</i></th> </tr> </thead> <tbody> <tr><td style="text-align: center;">30259.265</td><td style="text-align: center;">22440.275</td></tr> <tr><td style="text-align: center;">30252.243</td><td style="text-align: center;">22434.475</td></tr> <tr><td style="text-align: center;">30246.000</td><td style="text-align: center;">22429.198</td></tr> <tr><td style="text-align: center;">30219.829</td><td style="text-align: center;">22407.038</td></tr> <tr><td style="text-align: center;">30223.243</td><td style="text-align: center;">22403.136</td></tr> <tr><td style="text-align: center;">30220.648</td><td style="text-align: center;">22400.806</td></tr> <tr><td style="text-align: center;">30223.686</td><td style="text-align: center;">22397.396</td></tr> <tr><td style="text-align: center;">30227.213</td><td style="text-align: center;">22383.990</td></tr> <tr><td style="text-align: center;">30243.074</td><td style="text-align: center;">22366.506</td></tr> <tr><td style="text-align: center;">30248.923</td><td style="text-align: center;">22362.405</td></tr> <tr><td style="text-align: center;">30258.424</td><td style="text-align: center;">22352.440</td></tr> <tr><td style="text-align: center;">30273.139</td><td style="text-align: center;">22335.776</td></tr> <tr><td style="text-align: center;">30289.353</td><td style="text-align: center;">22315.318</td></tr> <tr><td style="text-align: center;">30300.458</td><td style="text-align: center;">22300.499</td></tr> <tr><td style="text-align: center;">30312.970</td><td style="text-align: center;">22283.447</td></tr> <tr><td style="text-align: center;">30320.479</td><td style="text-align: center;">22272.000</td></tr> <tr><td style="text-align: center;">30323.753</td><td style="text-align: center;">22271.418</td></tr> </tbody> </table>	<i>Northing</i>	<i>Easting</i>	30259.265	22440.275	30252.243	22434.475	30246.000	22429.198	30219.829	22407.038	30223.243	22403.136	30220.648	22400.806	30223.686	22397.396	30227.213	22383.990	30243.074	22366.506	30248.923	22362.405	30258.424	22352.440	30273.139	22335.776	30289.353	22315.318	30300.458	22300.499	30312.970	22283.447	30320.479	22272.000	30323.753	22271.418
<i>Northing</i>	<i>Easting</i>																																				
30259.265	22440.275																																				
30252.243	22434.475																																				
30246.000	22429.198																																				
30219.829	22407.038																																				
30223.243	22403.136																																				
30220.648	22400.806																																				
30223.686	22397.396																																				
30227.213	22383.990																																				
30243.074	22366.506																																				
30248.923	22362.405																																				
30258.424	22352.440																																				
30273.139	22335.776																																				
30289.353	22315.318																																				
30300.458	22300.499																																				
30312.970	22283.447																																				
30320.479	22272.000																																				
30323.753	22271.418																																				

 THE SCHEDULE — *continued*

<i>First column</i>	<i>Second column</i>
The Authority	Protected Place
30341.408	22271.719
30344.459	22268.140
30367.817	22258.771
30391.559	22288.104
30366.883	22338.875
30352.412	22328.626
30322.006	22364.577
30287.586	22405.970

to the point of commencement.

The boundaries of “Kent Ridge NEWater Service Reservoir” are more particularly delineated in the Survey Plan Ref. No. 3P/SBV/BDY/A4-1 set out below.

THE SCHEDULE — *continued*

First column

Second column

The Authority

Protected Place

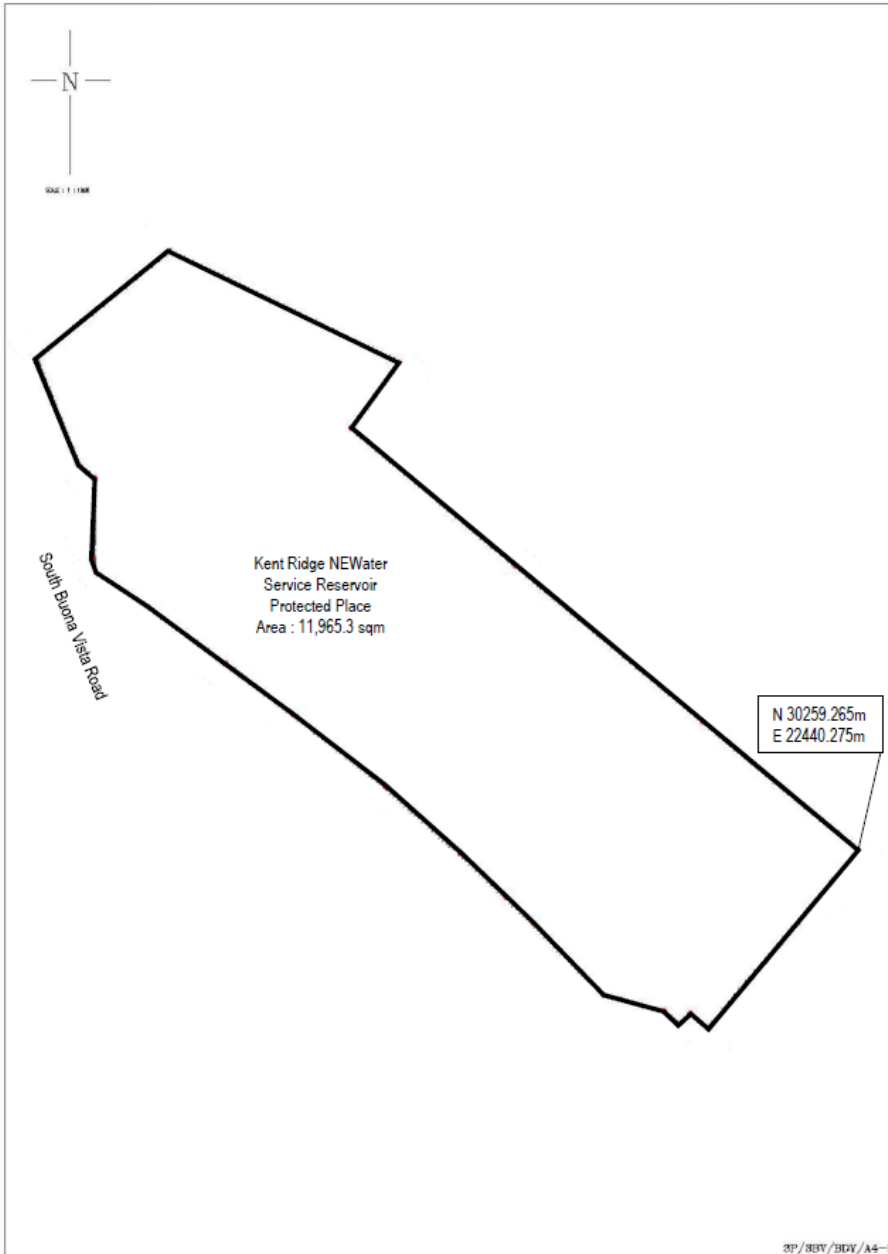

THE SCHEDULE — *continued*

<i>First column</i>	<i>Second column</i>																																		
The Authority	Protected Place																																		
Director, Water Supply (Network) Department, Public Utilities Board	<p>(7) Jurong Island Industrial Water Service Reservoir</p> <p>All that area comprised in part of State Land Lot 2389P Pt in Mukim No. 34 occupied by “Jurong Island Industrial Water Service Reservoir” containing an area of about 7,817.7 square metres and bounded approximately as follows:</p> <p>Commencing at a point 29058.249 metres North and 15283.650 metres East of the Singapore Land Authority SVY 21 Datum, the boundaries run along successive lines of coordinates approximately as follows:</p> <table border="0" style="margin-left: 40px;"> <thead> <tr> <th style="text-align: left;"><i>Northing</i></th> <th style="text-align: left;"><i>Easting</i></th> </tr> </thead> <tbody> <tr><td>29058.249</td><td>15283.650</td></tr> <tr><td>29051.000</td><td>15291.163</td></tr> <tr><td>29028.015</td><td>15314.948</td></tr> <tr><td>29024.786</td><td>15313.163</td></tr> <tr><td>29006.996</td><td>15303.333</td></tr> <tr><td>28993.664</td><td>15297.026</td></tr> <tr><td>28976.676</td><td>15288.282</td></tr> <tr><td>28965.614</td><td>15282.675</td></tr> <tr><td>28941.124</td><td>15265.291</td></tr> <tr><td>28916.101</td><td>15248.771</td></tr> <tr><td>28892.584</td><td>15232.012</td></tr> <tr><td>28889.555</td><td>15228.671</td></tr> <tr><td>28882.158</td><td>15220.511</td></tr> <tr><td>28880.025</td><td>15217.733</td></tr> <tr><td>28911.968</td><td>15184.650</td></tr> <tr><td>28918.542</td><td>15192.111</td></tr> </tbody> </table>	<i>Northing</i>	<i>Easting</i>	29058.249	15283.650	29051.000	15291.163	29028.015	15314.948	29024.786	15313.163	29006.996	15303.333	28993.664	15297.026	28976.676	15288.282	28965.614	15282.675	28941.124	15265.291	28916.101	15248.771	28892.584	15232.012	28889.555	15228.671	28882.158	15220.511	28880.025	15217.733	28911.968	15184.650	28918.542	15192.111
<i>Northing</i>	<i>Easting</i>																																		
29058.249	15283.650																																		
29051.000	15291.163																																		
29028.015	15314.948																																		
29024.786	15313.163																																		
29006.996	15303.333																																		
28993.664	15297.026																																		
28976.676	15288.282																																		
28965.614	15282.675																																		
28941.124	15265.291																																		
28916.101	15248.771																																		
28892.584	15232.012																																		
28889.555	15228.671																																		
28882.158	15220.511																																		
28880.025	15217.733																																		
28911.968	15184.650																																		
28918.542	15192.111																																		

 THE SCHEDULE — *continued*

<i>First column</i>	<i>Second column</i>
The Authority	Protected Place
28916.807	15194.466
28921.215	15199.514
28931.803	15207.194
28935.266	15209.462
28944.825	15215.777
28957.532	15224.254
28969.061	15232.006
28980.486	15240.089
28988.152	15245.534
28991.026	15247.048
28990.600	15348.206
28995.591	15250.729
28996.155	15249.742
29006.888	15255.170
29010.416	15257.164
29017.936	15260.906
29030.211	15267.116
29033.193	15263.905
29038.838	15269.337
29042.817	15265.369
29049.395	15271.752
29047.792	15273.548
29051.834	15278.578

to the point of commencement.

The boundaries of “Jurong Island Industrial Water Service Reservoir” are more particularly delineated in the Survey Plan

THE SCHEDULE — *continued**First column**Second column*

The Authority

Protected Place

Ref. No. AS14044-PC-SERAYA-AVE set out below.

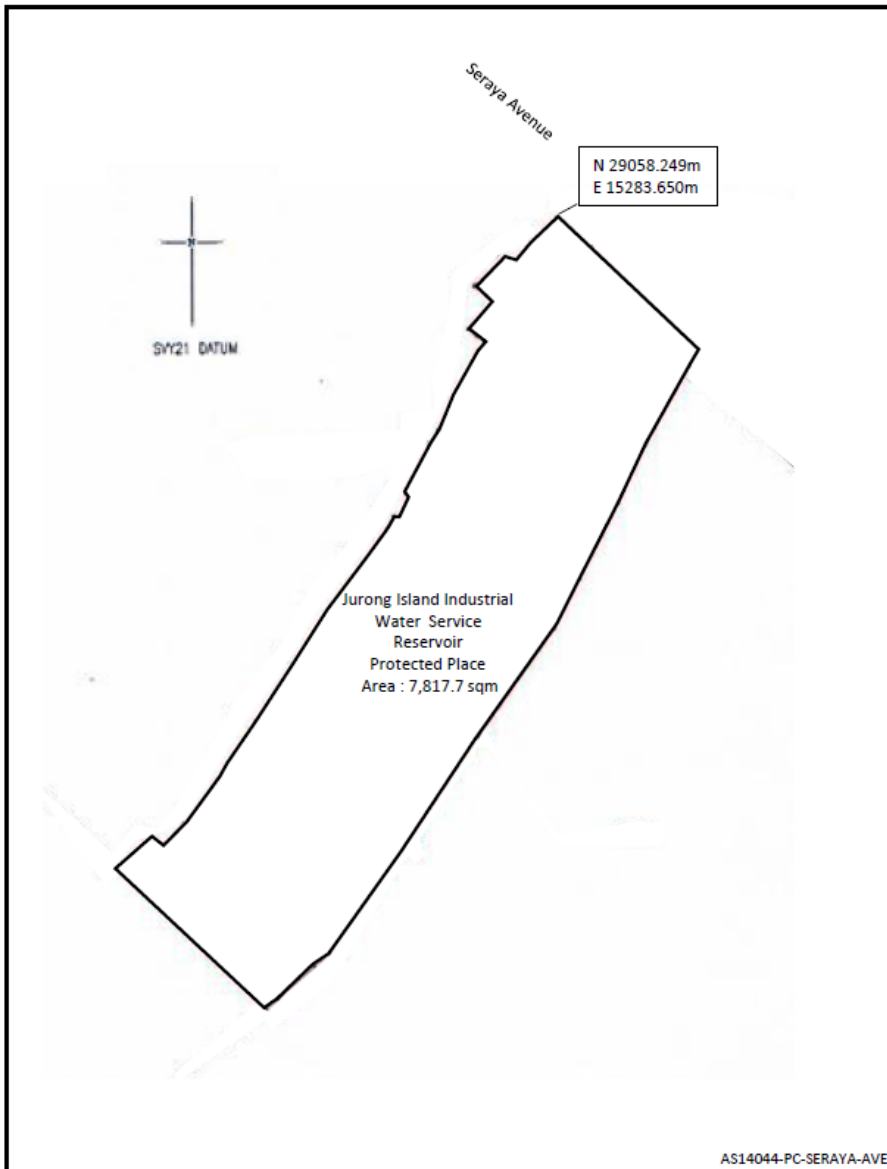

Made on 2 February 2016.

LEO YIP
*Permanent Secretary,
Ministry of Home Affairs,
Singapore.*

[MHA (PS) 12/2/02 TF 4; CP/C/198/39/1 V29; AG/LEGIS/SL/256/
2015/1 Vol. 2]