

---

---

First published in the Government *Gazette*, Electronic Edition, on 2 August 2022 at 5 pm.

**No. S 658**

INFRASTRUCTURE PROTECTION ACT 2017

INFRASTRUCTURE PROTECTION  
(PROTECTED PLACES) (NO. 5)  
ORDER 2022

ARRANGEMENT OF PARAGRAPHS

Paragraph

1. Citation and commencement
  2. Premises declared to be protected place
- The Schedule
- 

In exercise of the powers conferred by section 14(1) of the Infrastructure Protection Act 2017, the Minister for Home Affairs makes the following Order:

**Citation and commencement**

1. This Order is the Infrastructure Protection (Protected Places) (No. 5) Order 2022 and comes into operation on 15 August 2022.

**Premises declared to be protected place**

2. The premises described in the second column of the Schedule are declared to be a protected place for the purposes of the Act, and the person specified in the first column of that Schedule is designated as the authority of the protected place.

---



---

 THE SCHEDULE

Paragraph 2

*First column**Second column*

## The Authority

## Protected Place

Director of  
Biosafety Level 3,  
Lee Kong Chian  
School of Medicine

LEE KONG CHIAN SCHOOL OF MEDICINE,  
BIOSAFETY LEVEL 3 LABORATORY (BSL3)  
FACILITY AT 7<sup>TH</sup> STOREY OF THE  
EXPERIMENTAL MEDICINE BUILDING,  
NANYANG TECHNOLOGICAL UNIVERSITY

All that area comprised in part of Lot 02033K in Mukim No. 9 occupied by “LEE KONG CHIAN SCHOOL OF MEDICINE, BIOSAFETY LEVEL 3 LABORATORY (BSL3) FACILITY AT 7<sup>TH</sup> STOREY OF THE EXPERIMENTAL MEDICINE BUILDING, NANYANG TECHNOLOGICAL UNIVERSITY” containing an area of about 307.5 square metres and bounded approximately as follows:

Commencing at the north easternmost corner of the “LEE KONG CHIAN SCHOOL OF MEDICINE, BIOSAFETY LEVEL 3 LABORATORY (BSL3) FACILITY AT 7<sup>TH</sup> STOREY OF THE EXPERIMENTAL MEDICINE BUILDING, NANYANG TECHNOLOGICAL UNIVERSITY” at a point 36,328.139 metres North and 10,764.835 metres East of the Singapore Land Authority SVY 21 Datum, the boundaries run along successive lines of coordinates approximately as follows:

| <i>Northing</i> | <i>Easting</i> |
|-----------------|----------------|
| 36328.139       | 10764.835      |
| 36314.487       | 10770.073      |
| 36309.040       | 10755.875      |
| 36305.881       | 10757.098      |
| 36304.141       | 10752.603      |
| 36318.874       | 10746.948      |
| 36319.047       | 10747.393      |
| 36321.088       | 10746.603      |

to the point of commencement.

THE SCHEDULE — *continued*

*First column*

*Second column*

The Authority

Protected Place

The boundaries of “LEE KONG CHIAN SCHOOL OF MEDICINE, BIOSAFETY LEVEL 3 LABORATORY (BSL3) FACILITY AT 7<sup>TH</sup> STOREY OF THE EXPERIMENTAL MEDICINE BUILDING, NANYANG TECHNOLOGICAL UNIVERSITY” are more particularly delineated in the Survey Plan No. 19287GZ1 set out below.

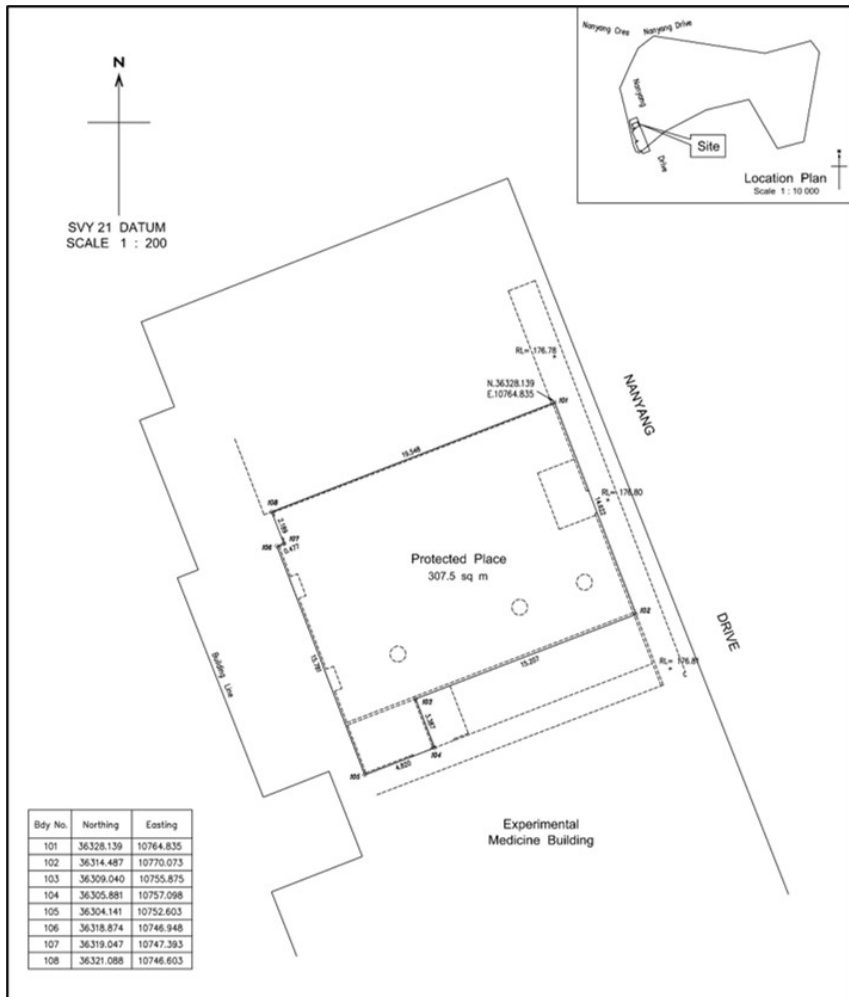

Made on 17 January 2022.

PANG KIN KEONG  
*Permanent Secretary,  
Ministry of Home Affairs,  
Singapore.*

[SPF/CPS/C/09/07/03; AG/LEGIS/SL/137B/2020/2 Vol. 1]