

**PROTECTED AREAS AND PROTECTED PLACES ACT  
(CHAPTER 256, SECTION 5(1))**

**PROTECTED PLACES (CONSOLIDATION) ORDER**

**ARRANGEMENT OF PARAGRAPHS**

Paragraph

1. Citation
  2. Premises declared to be protected place  
The Schedule
- 

**Citation**

**1.** This Order may be cited as the Protected Places (Consolidation) Order.

**Premises declared to be protected place**

**2.** The premises described in the second column of the Schedule are hereby declared to be a protected place for the purposes of the Act, and no person shall be in those premises unless he is in possession of a pass-card or permit issued by the authority specified in the first column of the Schedule or has received the permission of an authorised officer on duty at the premises to enter.

**THE SCHEDULE**

<i>First column</i>	<i>Second column</i>
The Authority	Protected Place
(1) S 18/99 [12.1.99] Board of Commissioners of Currency, Singapore	THE SINGAPORE MINT  All that area comprised in part of State Land lots 6305C and 6306M, 20 Teban Gardens Crescent, occupied by “THE SINGAPORE MINT” containing an area of about 6,015.2 square metres and bounded approximately as follows:  Commencing at the northeastern-most corner of the perimeter fence of the aforesaid “THE SINGAPORE MINT” which the point is 34,223.3 metres North and 17,636.2 metres East of the Survey Department origin

THE SCHEDULE — *continued*

of co-ordinates, the boundaries run along successive lines of fence of bearings and distances as under:

<i>Bearing</i>	<i>Distance in metres</i>
214° 16'	65.5 (along chain link fence)
213° 48'	25.7 (along wall)
303° 56'	10.0 (along chain link fence)
213° 19'	1.5 (along chain link fence)
304° 07'	49.9 (along chain link fence)
304° 07'	5.3 (along chain link fence)
34° 17'	32.1 (along chain link fence)
33° 52'	60.2 (along chain link fence)
121° 20'	11.4 (along chain link fence)
124° 26'	53.9 (along chain link fence)

to the point of commencement.

The boundaries of “THE SINGAPORE MINT” are more particularly delineated in the Plan set out below.

THE SCHEDULE — *continued*

THE SINGAPORE MINT

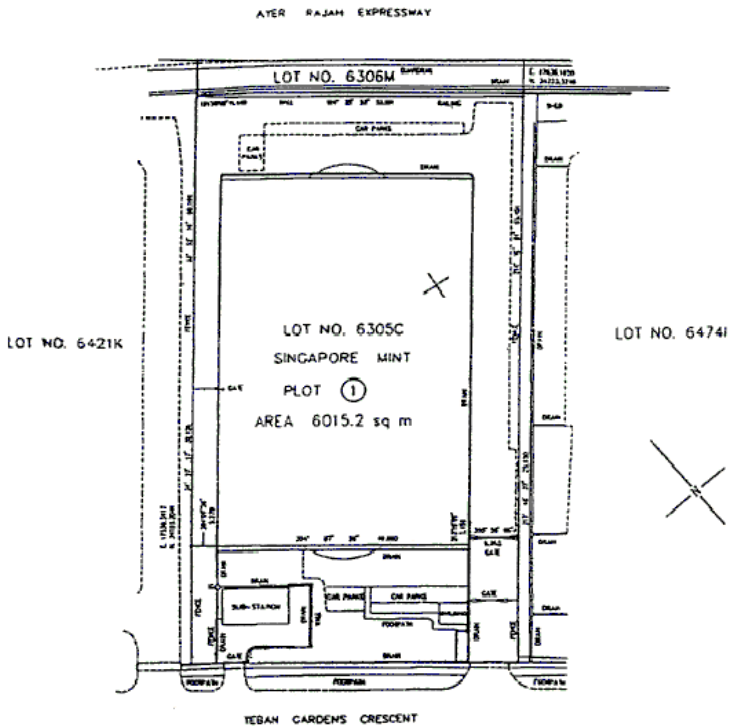

*First column*

*Second column*

The Authority

Protected Place

(2) S 109/99

KRANJI RADIO TRANSMITTING STATION

[17.3.99]

All that area comprised in part of State Land Lot 859PT Mukim No. 12, 91 Kranji Way, occupied by “KRANJI RADIO TRANSMITTING STATION” containing an area of about 687,663 square metres and bounded approximately as follows:

Managing Director  
Singapore  
Telecommunications Ltd

of Commencing at the northeastern-most corner of the perimeter fence of the aforesaid “KRANJI RADIO TRANSMITTING STATION” which the point is 46,630 metres North and 16,569 metres East of the Survey Department origin of

THE SCHEDULE — *continued*

co-ordinates, the boundaries run along successive lines of fence of bearings and distances as under:

<i>Bearing</i>	<i>Distance in metres</i>
178° 29'	41.8 (along chain link fence)
85° 04'	165.0 (along chain link fence)
175° 37'	127.8 (along chain link fence)
91° 03'	193.2 (along chain link fence)
179° 03'	157.8 (along chain link fence)
204° 15'	226.3 (along chain link fence)
127° 47'	38.9 (along chain link fence)
108° 29'	61.7 (along chain link fence)
179° 55'	118.9 (along chain link fence)
90° 32'	74.4 (along chain link fence)
182° 08'	123.9 (along chain link fence)
220° 25'	62.5 (along chain link fence)
240° 00'	34.0 (along chain link fence)
294° 17'	46.8 (along chain link fence)
324° 14'	45.0 (along chain link fence)

THE SCHEDULE — *continued*

356° 35'	56.2 (along chain link fence)
271° 03'	252.4 (along chain link fence)
191° 16'	90.9 (along chain link fence)
237° 00'	68.8 (along chain link fence)
299° 10'	34.1 (along chain link fence)
325° 31'	60.4 (along chain link fence)
269° 51'	373.3 (along chain link fence)
217° 19'	53.6 (along chain link fence)
233° 13'	38.0 (along chain link fence)
315° 10'	85.8 (along chain link fence)
357° 30'	67.9 (along chain link fence)
292° 22'	47.5 (along chain link fence)
210° 48'	68.9 (along chain link fence)
228° 34'	110.4 (along chain link fence)
285° 38'	26.2 (along chain link fence)
47° 43'	84.0 (along chain link fence)
33° 43'	77.9 (along chain link fence)

THE SCHEDULE — *continued*

20° 14'	77.9 (along chain link fence)
13° 56'	217.1 (along chain link fence)
24° 05'	207.5 (along chain link fence)
37° 47'	107.3 (along chain link fence)
51° 39'	85.9 (along chain link fence)
63° 59'	85.9 (along chain link fence)
73° 07'	287.0 (along chain link fence)
180° 01'	18.4 (along chain link fence)
90° 01'	15.1 (along chain link fence and gates)
15° 51'	2.1 (along chain link fence)
53° 36'	2.1 (along chain link fence)
86° 08'	4.4 (along chain link fence)
359° 45'	5.4 (along chain link fence and wall)
271° 38'	4.2 (along chain link fence)
309° 26'	2.6 (along chain link fence)
346° 02'	2.3 (along chain link fence)
1° 03'	10.0 (along chain link fence)

THE SCHEDULE — *continued*

73° 12'      14.9 (along chain link fence)

to the point of commencement

The boundaries of “KLANJI RADIO TRANSMITTING STATION” are more particularly delineated in the Plan set out below.

KLANJI RADIO TRANSMITTING STATION

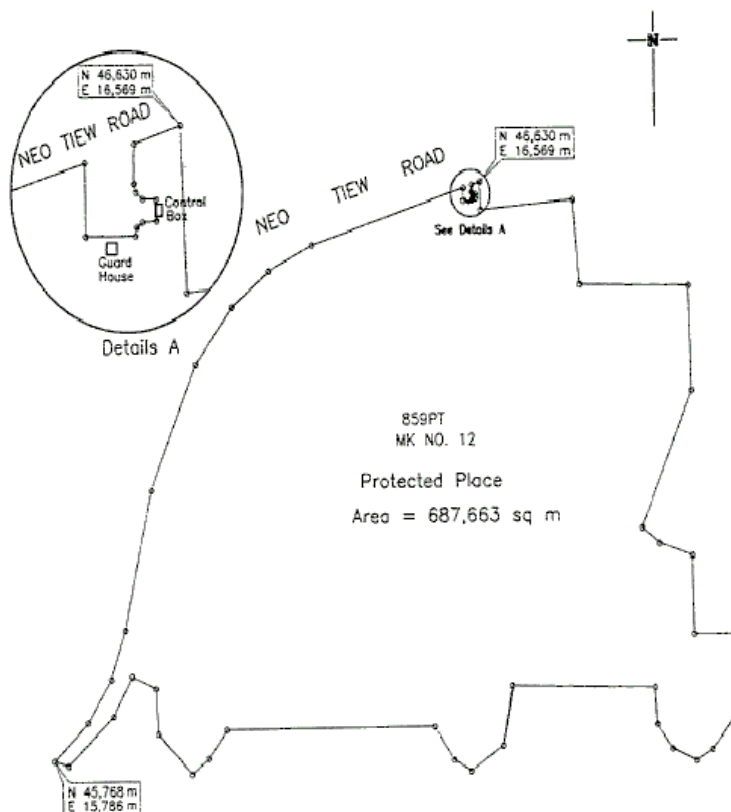

(3) [*Deleted by S 418/2015 wef 06/07/2015*]

[*S 418/2015 wef 06/07/2015*]

[ ]

*First column*

*Second column*

THE SCHEDULE — *continued*

The Authority	Protected Place
(4) Commander, Tengah Air Base, Air Power Generation Command	<p>MURAI CAMP.</p> <p>All that area comprised in Land Lots 766L, 1472X, 99939M, 99942M, 99945P, 99949N and 99962P and part of Land Lots 1789V, 99936X and 99966N in Mukim No. 12 occupied by “MURAI CAMP” containing an area of about 581,330.9 square metres and bounded approximately as follows:</p>

Commencing at a point of the aforesaid “MURAI CAMP” which point is 41,922.287 metres North and 13,102.465 metres East of the Singapore Land Authority SVY 21 Datum, the boundaries run along successive lines of compiled coordinates approximately as follows:

<i>Northing</i>	<i>Easting</i>
41,922.287	13,102.465
41,990.860	13,114.074
42,055.383	13,125.635
42,210.004	13,152.533
42,241.721	13,159.129
42,395.657	13,190.688
42,467.710	13,201.654
42,536.498	13,211.379
42,551.707	13,213.652
42,553.122	13,213.864
42,658.900	13,243.077
42,627.333	13,236.203
42,595.417	13,233.067
42,406.516	13,237.180
42,363.084	13,241.168
42,320.076	13,252.062



THE SCHEDULE — *continued*

42,257.630	13,277.108
42,209.938	13,297.205
42,029.188	13,373.358
41,951.921	13,404.989
41,930.614	13,413.712
41,904.043	13,424.589
41,805.580	13,464.899
41,753.704	13,476.936
41,700.182	13,479.426
41,460.457	13,465.277
41,452.313	13,464.796
41,312.653	13,456.533
41,196.275	13,451.314
41,121.916	13,447.966
41,090.160	13,426.403
40,904.289	13,300.091
40,830.054	13,250.029
40,752.905	13,198.668
40,626.210	13,114.322
40,569.796	13,076.552
40,585.072	13,062.580
40,597.793	13,050.945
40,675.448	12,979.919
40,687.239	12,973.863
40,693.459	12,970.668
40,707.498	12,958.304

THE SCHEDULE — *continued*

40,723.884	12,937.252
40,744.084	12,915.757
40,755.916	12,903.167
40,828.320	12,915.499
40,869.104	12,922.445
40,912.575	12,929.877
41,039.538	12,951.559
41,045.644	12,952.599
41,037.896	12,966.228
41,202.855	12,992.789
41,413.754	13,028.898
41,603.932	13,063.580
41,817.611	13,102.827
41,822.643	13,103.694
41,823.258	13,085.700
41,843.116	13,089.062
41,837.831	13,131.472
41,916.268	13,146.203
41,917.615	13,135.154

to the point of commencement.

Excluding all that area contained in Lot 704L as described below:

LOT 704L

All that area comprised in Land Lot 704L in Mukim No. 12 containing an area of about 4,197.8 square metres and bounded approximately as follows:

Commencing at a point which is 41,929.171 metres North and 13,295.530 metres East of the Singapore

THE SCHEDULE — *continued*

Land Authority SVY 21 Datum, the boundaries run along successive lines of compiled coordinates approximately as follows:

<i>Northing</i>	<i>Easting</i>
41,929.171	13,295.530
41,960.537	13,371.502
41,917.470	13,389.278
41,877.743	13,317.330

to the point of commencement.

The boundaries of “MURAI CAMP” are more particularly delineated on the Survey Plan No. D8935/GAZ filed in the office of the Director, Building and Infrastructure, Defence Science and Technology Agency, Singapore, a copy of which is set out below.

THE SCHEDULE — *continued*

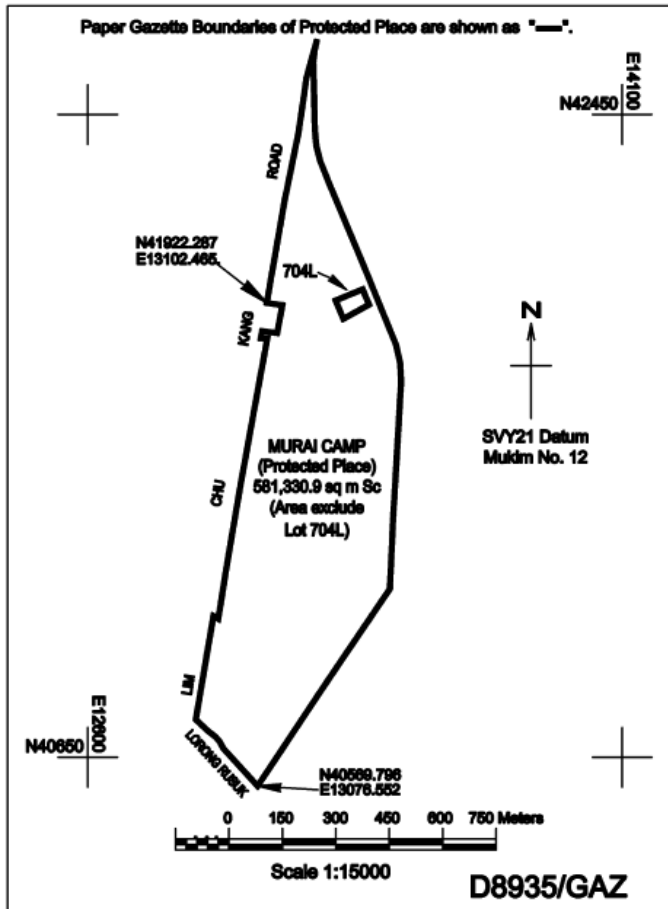

[S 93/2012 wef 09/03/2012]

[S 288/2013 wef 02/05/2013]

LEGISLATIVE HISTORY  
PROTECTED PLACES (CONSOLIDATION) ORDER  
(CHAPTER 256, O 13)

This Legislative History is provided for the convenience of users of the Protected Places (Consolidation) Order. It is not part of this Order.

**1. G. N. No. S 18/1999 — Protected Places Order 1999**

Date of commencement : 12 January 1999

**2. G. N. No. S 109/1999 — Protected Places (No. 2) Order 1999**

Date of commencement : 17 March 1999

**3. G. N. No. S 171/1999 — Protected Places (No. 3) Order 1999**

Date of commencement : 31 March 1999

**4. G. N. No. S 190/1999 — Protected Places (No. 5) Order 1999**

Date of commencement : 13 April 1999

**5. G. N. No. S 392/1999 — Protected Places (No. 6) Order 1999**

Date of commencement : 8 September 1999

**6. 2001 Revised Edition — Protected Places (Consolidation) Order**

Date of operation : 31 January 2001

**7. G. N. No. S 93/2012 — Protected Places (Consolidation) (Amendment No. 2) Order 2012**

Date of commencement : 9 March 2012

**8. G.N. No. S 288/2013 — Protected Places (Consolidation) (Amendment) Order 2013**

Date of commencement : 2 May 2013

**9. G.N. No. S 418/2015 — Protected Places (Miscellaneous Amendments) Order 2015**

Date of commencement : 6 July 2015