

PROTECTED AREAS AND PROTECTED PLACES ACT
(CHAPTER 256, SECTION 5(1))

PROTECTED PLACES (CONSOLIDATION) ORDER

ARRANGEMENT OF PARAGRAPHS

Paragraph

- 1.
- 2.

The Schedule

1. This Order may be cited as the Protected Places (Consolidation) Order.

2. The premises described in the second column of the Schedule is hereby declared to be a protected place for the purposes of the Act, and no person shall be in those premises unless he is in the possession of a pass-card or permit issued by the authority specified in the first column of the Schedule or has received the permission of an authorised officer on duty at the premises to enter the premises.

THE SCHEDULE

First column	Second column
The Authority	Protected Place
(1) S 9/2000 [7.1.2000] Commanding Officer, School of Transport	Singapore Armed Forces Driving Circuit.

All that area comprised in part of Lot 2658, part of State Reserve and part of State Land Lot 4527, Mukim No. 23 (PAYA LEBAR), Lots 2397, 2398, 2402, 2552, part of Lots 2399, 2403, part of State Reserve and part of State Land Lots 2549, 2551, Mukim No. 28 (ULU BEDOK) occupied by "SINGAPORE ARMED FORCES DRIVING CIRCUIT" containing an area of about

THE SCHEDULE — *continued*

62,413 square metres and bounded approximately as follows:

Commencing at the easternmost corner of the perimeter fence of the aforesaid "SINGAPORE ARMED FORCES DRIVING CIRCUIT" which point is 36,105.914 metres North and 37,111.541 metres East of the Survey Department origin of co-ordinates (30,000 metres North, 30,000 metres East), the boundaries run along successive lines of fence bearings and distances as under:

<i>Bearing</i>	<i>Distance in metres</i>	
215° 50' 34"	94.869	
305° 50' 09"	5.651	
35° 16' 38"	5.231	
305° 17' 06"	6.554	(partly across a concrete drain)
216° 42' 28"	5.259	
305° 42' 30"	86.177	
216° 11' 50"	12.797	(along gate partly across a concrete drain)
122° 54' 10"	1.588	
160° 39' 49"	5.034	
216° 09' 47"	96.515	
316° 58' 44"	35.321	
305° 50' 30"	133.336	(along gate partly across a concrete drain)
215° 58' 36"	52.915	
305° 41' 07"	104.384	
48° 54' 29"	266.128	
126° 59' 08"	239.095	
126° 32' 53"	66.708	

to the point of commencement.

THE SCHEDULE — *continued*

The boundaries of “SINGAPORE ARMED FORCES DRIVING CIRCUIT” are more particularly delineated and edged pink on Survey Plan No. LE/97/212/GAZ filed in the office of the Director, Lands and Estates Organisation, Ministry of Defence, Singapore.

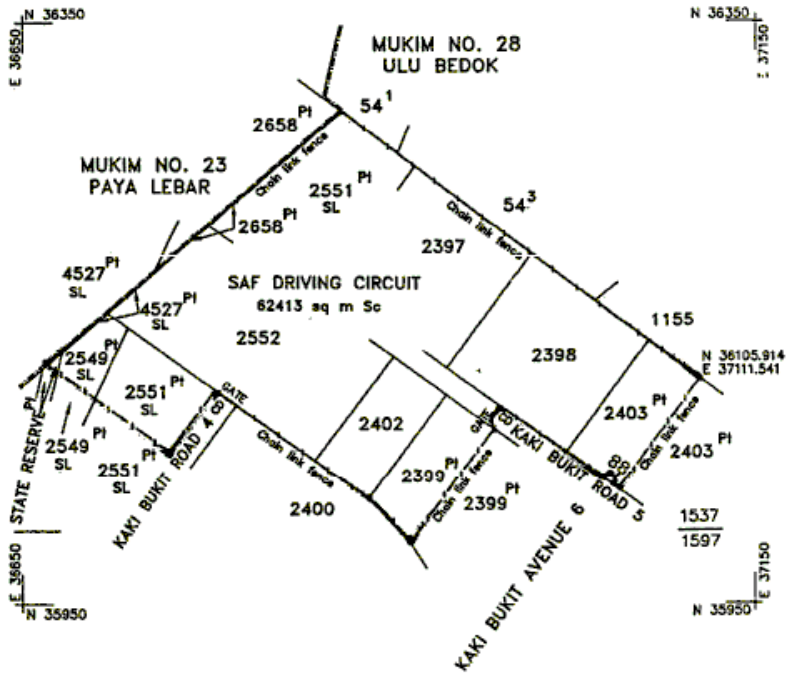

NOTE :
 1. Boundaries of Protected Place shown hereon are edged pink.



<i>First column</i>	<i>Second column</i>
The Authority	Protected Place
(2) Camp Commandant, Changi Naval Base	CHANGI NAVAL BASE.

THE SCHEDULE — *continued*

All that area comprised in part of State Land Lot 4229N in Mukim No. 31 and part of foreshore within the territorial waters of the Republic of Singapore occupied by “CHANGI NAVAL BASE” containing an area of about 969,139.7 square metres and bounded approximately as follows:

Commencing at a point of the aforesaid “CHANGI NAVAL BASE” which point is 33,110.671 metres North and 48,210.206 metres East of the Singapore Land Authority SVY21 Datum, the boundaries run along successive lines of co-ordinates approximately as follows:

<i>Northing</i>	<i>Easting</i>
33,110.671	48,210.206
33,294.591	48,281.072
33,437.079	48,335.974
33,444.542	48,620.595
33,447.481	48,732.671
33,761.973	48,724.425
33,767.421	48,932.239
33,878.783	48,929.319
33,881.782	48,929.240
33,902.829	49,731.964
34,082.064	49,727.266
34,084.790	49,859.872
34,093.014	50,155.949
34,093.474	50,172.493
34,076.144	50,172.930
33,868.213	50,179.024
33,653.886	50,184.649
33,363.498	50,193.163
33,176.976	50,198.632

THE SCHEDULE — *continued*

33,162.548	50,188.729
33,161.782	50,159.520
33,151.953	49,784.665
33,626.790	49,772.215
33,608.443	49,072.455
33,133.606	49,084.905

to the point of commencement.

The boundaries of “CHANGI NAVAL BASE” are more particularly delineated on the Survey Plan No. 948GAZ filed in the office of the Director, Building and Infrastructure Services, Defence Science and Technology Agency, Singapore, a copy of which is set out below.

[S 540/2010 wef 22/09/2010]

THE SCHEDULE — *continued*

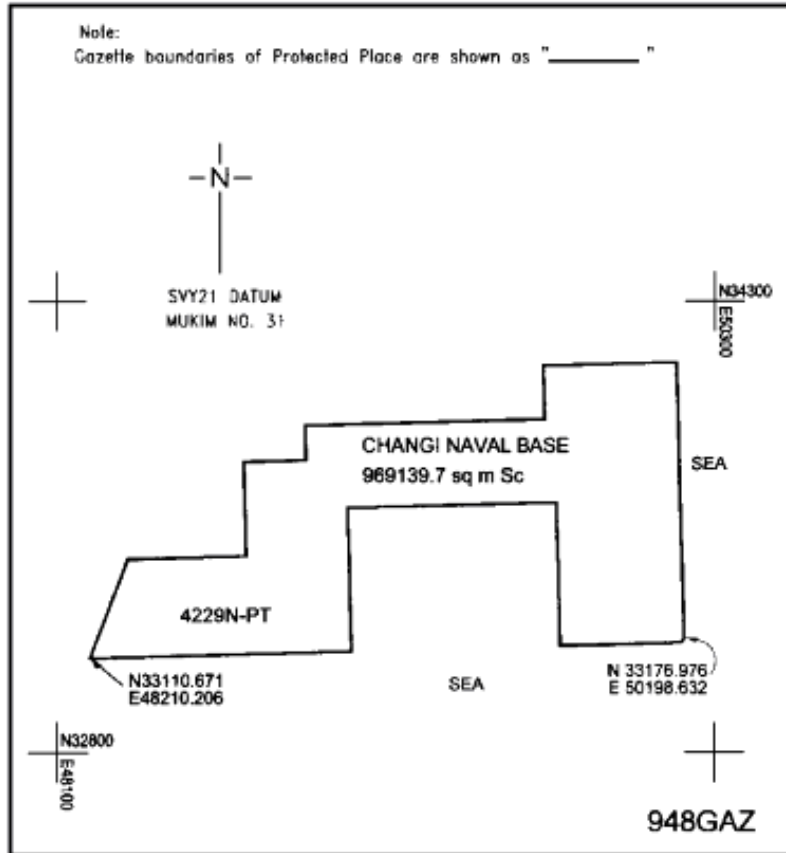

Scale 1 : 20000

<i>First column</i>	<i>Second column</i>
The Authority	Protected Place
(3) Deleted by S 702/2008, wef 31/12/2008.	

<i>First column</i>	<i>Second column</i>
The Authority	Protected Place
(4) S 62/2001 [13.2.2001] Assistant Chief of the General Staff	Haig Road Camp.

THE SCHEDULE — *continued*(Training), G6
Army

All that area comprised in part of State Land Lots 55-30, 55-31 and 55-32 in MUKIM No. 25 (GELANG) occupied by "HAIG ROAD CAMP" containing an area of about 14,204 square metres and bounded approximately as follows:

Commencing at a point northernmost corner of the aforesaid "HAIG ROAD CAMP" which point is 32,230.403 metres North and 35,245.086 metres East of the Survey Department origin of co-ordinates (30,000 metres North, 30,000 metres East), the boundaries run along successive lines of bearings and distances approximately as under:

<i>Bearing</i>	<i>Distance in metres</i>	
156° 11' 21"	11.157	(along existing fence)
153° 42' 16"	16.645	(along existing gate)
157° 59' 35"	52.282	(along existing fence)
244° 47' 31"	20.491	(along existing fence)
159° 58' 36"	0.598	(along existing fence)
248° 16' 53"	1.736	(along existing fence)
308° 37' 11"	0.580	(along existing fence)
246° 28' 41"	62.393	(along existing fence)
246° 41' 23"	41.991	(along existing fence)
247° 21' 05"	53.520	(along existing fence)
336° 38' 45"	8.933	(along existing fence)
336° 36' 16"	12.197	(along existing fence)
336° 09' 45"	11.669	(along existing fence)
336° 34' 52"	42.661	(along existing fence)
64° 40' 14"	21.698	(along existing fence)
65° 34' 39"	1.474	(along existing gate)
65° 03' 23"	56.093	(along existing fence)

THE SCHEDULE — *continued*

65° 42' 26" 27.207 (along existing fence)

65° 06' 20" 74.458 (along existing fence)

to the point of commencement.

The boundaries of “HAIG ROAD CAMP” are more particularly delineated and edged pink on Survey Plan No. 25/01/100/GAZ filed in the office of the Director, Building and Infrastructure, Defence Science and Technology Agency, Singapore.

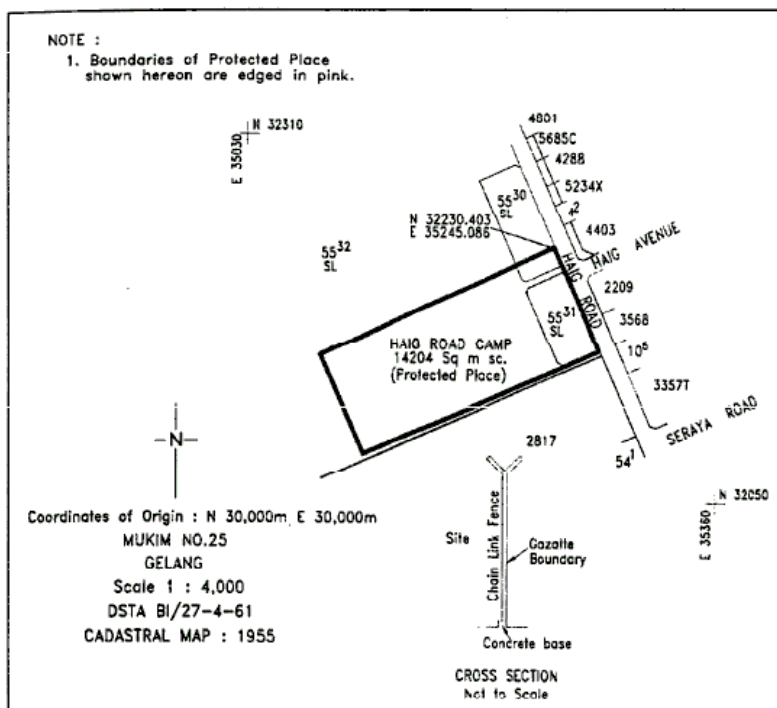

First column

Second column

The Authority

Protected Place

(5) S 82/2001
[14.2.2001]
Managing
Director,
Monetary

MAS Currency House

THE SCHEDULE — *continued*

Authority of
Singapore

All that area comprised in part of state land lots 3445K, 109 Pasir Panjang Road, occupied by “MONETARY AUTHORITY OF SINGAPORE” containing an area of about 8,521.2 square metres and bounded approximately as follows:

Commencing at the northeastern-most corner of the perimeter fence of the aforesaid “MAS Currency House” which point is 28,648.12 metres North and 23,627.35 metres East of the Survey Department origin of coordinates (30,000 metres North, 30,000 metres East), the boundaries run along successive lines of fence of bearings and distances approximately as under:

<i>Bearing</i>	<i>Distance in metres</i>	
258°58'	109.36	(along lines of boundaries walls)
301°20'	74.53	(along lines of boundaries walls)
304°20'	10.06	along lines of boundaries walls)
298°37'	8.62	(along lines of boundaries walls)
23°06'	62.71	(along lines of boundaries walls)
109°59'	45.50	(along lines of boundaries walls)
19°43'	26.61	(along lines of boundaries walls)
109°12'	43.06	(along lines of boundaries walls)
111°38'	11.26	(along lines of boundaries walls)
109°17'	5.30	(along lines of boundaries walls)

THE SCHEDULE — *continued*

to the point of commencement.

The boundaries of “MAS CURRENCY HOUSE” are more particularly delineated in the Plan set out below.

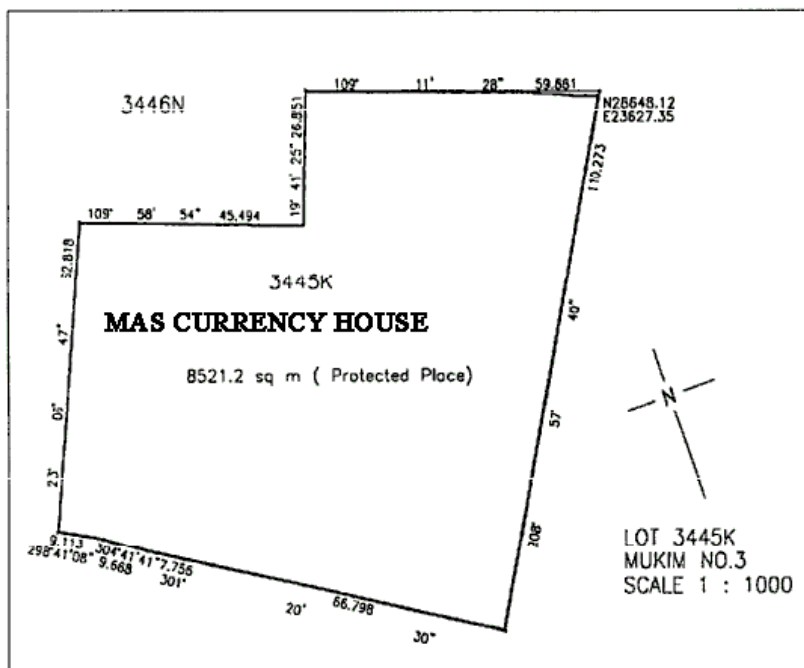

First column

Second column

The Authority

Protected Place

(6) Commander,
Commando
Training
Institute

PASIR RIS CAMP.

All that area comprised in Land Lot 2250K in Mukim No. 29 and occupied by “PASIR RIS CAMP” containing an area of about 261,807.1 square metres and bounded approximately as follows:

Commencing at a point of the aforesaid “PASIR RIS CAMP” which point is 41,390.757 metres North and 39,113.941 metres East of the Singapore Land Authority SVY 21 Datum, the boundaries run along successive lines of coordinates approximately as follows:

Northing

Easting

THE SCHEDULE — *continued*

<i>First column</i>	<i>Second column</i>
The Authority	Protected Place
41,390.757	39,113.941
41,391.442	39,113.164
41,454.264	39,041.904
41,490.809	39,000.450
41,598.505	38,871.849
41,612.764	38,851.775
41,616.783	38,846.663
41,649.676	38,806.931
41,655.332	38,800.099
41,659.312	38,795.481
41,680.706	38,770.661
41,688.645	38,761.450
41,700.562	38,747.656
41,701.750	38,746.101
41,706.909	38,746.138
41,710.810	38,748.889
41,747.138	38,779.573
41,759.581	38,790.533
41,771.162	38,802.398
41,887.073	38,925.307
41,985.468	39,029.640
42,046.014	39,093.844
42,037.303	39,102.252
42,058.140	39,124.493
42,073.275	39,140.647
42,098.801	39,167.892
42,099.502	39,168.640

THE SCHEDULE — *continued*

<i>First column</i>	<i>Second column</i>
The Authority	Protected Place
42,108.132	39,177.852
42,113.541	39,183.625
42,114.115	39,184.257
42,073.717	39,217.477
42,064.011	39,224.732
42,028.591	39,251.208
42,000.896	39,268.946
42,000.286	39,269.337
41,990.967	39,275.305
41,951.682	39,300.467
41,810.320	39,373.204
41,657.662	39,448.967
41,647.209	39,430.062
41,637.585	39,412.781
41,630.807	39,401.091
41,614.418	39,372.822
41,601.663	39,353.943
41,588.908	39,335.066
41,561.093	39,298.291
41,534.459	39,266.474
41,479.089	39,207.962
41,441.572	39,168.317
41,416.135	39,140.675

to the point of commencement.

The boundaries of “PASIR RIS CAMP” are more particularly delineated on the Survey Plan No. GAZ900 filed in the office of the Director, Building and

THE SCHEDULE — *continued*

<i>First column</i>	<i>Second column</i>
The Authority	Protected Place
	Infrastructure, Defence Science and Technology Agency, Singapore, a copy of which is set out below.

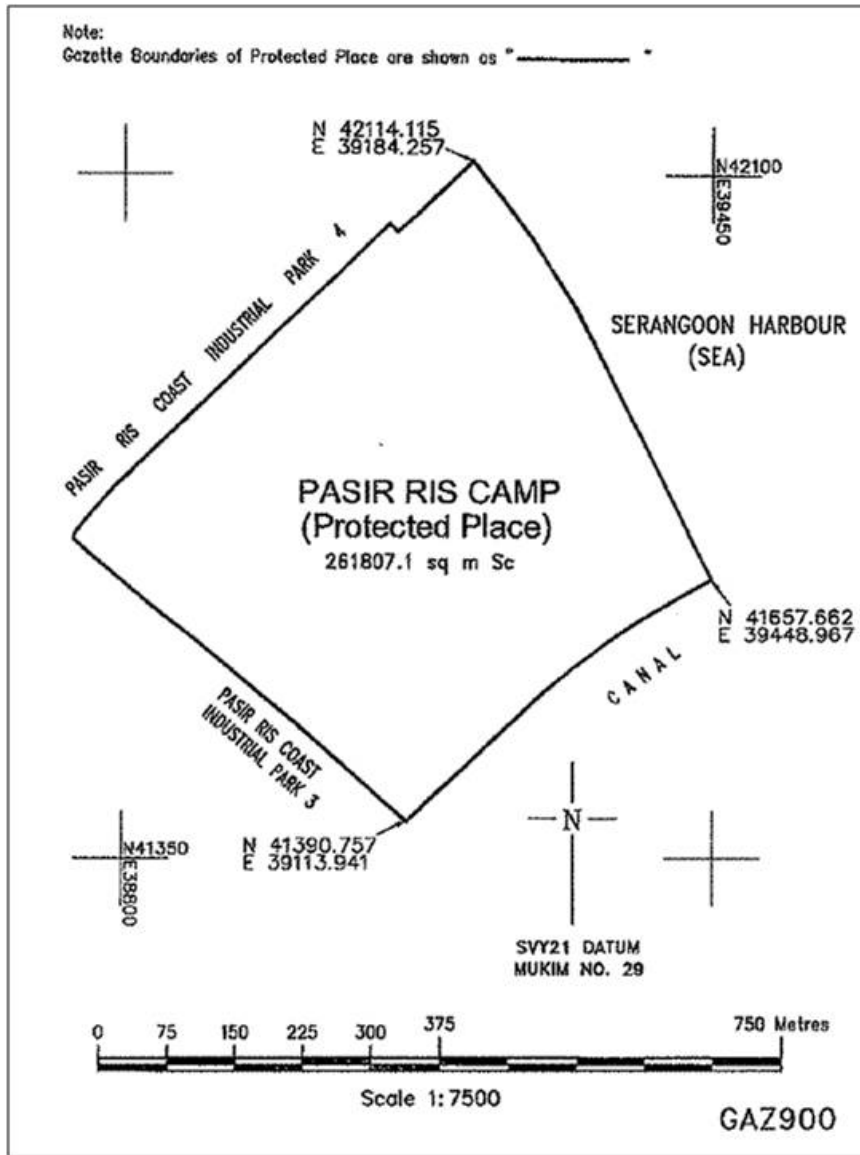

[S 214/2015 wef 15/04/2015]

<i>First column</i>	<i>Second column</i>
---------------------	----------------------

THE SCHEDULE — *continued*

The Authority	Protected Place																																	
(7) S 154/2001 [29.3.2001] President, Court Martial Centre	Singapore Armed Forces Court Martial Centre. All that area comprised in part of State Land Lot 2173, MUKIM No. 11 (KRANJI), occupied by "SINGAPORE ARMED FORCES COURT MARTIAL CENTRE" containing an area of about 7,581 square metres and bounded approximately as follows: Commencing at a point southwestern corner of the aforesaid "SINGAPORE ARMED FORCES COURT MARTIAL CENTRE" which point is 42,239.414 metres North and 17,895.830 metres East of the Survey Department origin of co-ordinates (30,000 metres North, 30,000 metres East), the boundaries run along successive lines of bearings and distances approximately as under: <table border="0" style="margin-left: 40px;"> <thead> <tr> <th style="text-align: left;"><i>Bearing</i></th> <th style="text-align: left;"><i>Distance in metres</i></th> <th></th> </tr> </thead> <tbody> <tr> <td>7° 26' 08"</td> <td>20.913</td> <td>(along existing fence)</td> </tr> <tr> <td>322° 30' 39"</td> <td>4.464</td> <td>(along existing fence)</td> </tr> <tr> <td>232° 17' 36"</td> <td>0.753</td> <td></td> </tr> <tr> <td>322° 28' 44"</td> <td>5.027</td> <td>(along existing drain)</td> </tr> <tr> <td>277° 23' 52"</td> <td>5.484</td> <td>(along existing drain)</td> </tr> <tr> <td>7° 21' 57"</td> <td>18.016</td> <td>(along existing drain)</td> </tr> <tr> <td>277° 09' 00"</td> <td>11.582</td> <td></td> </tr> <tr> <td>7° 09' 00"</td> <td>17.360</td> <td>(along existing hoarding)</td> </tr> <tr> <td>276° 57' 48"</td> <td>13.737</td> <td>(along existing hoarding)</td> </tr> <tr> <td>7° 44' 15"</td> <td>31.868</td> <td>(along existing hoarding)</td> </tr> </tbody> </table>	<i>Bearing</i>	<i>Distance in metres</i>		7° 26' 08"	20.913	(along existing fence)	322° 30' 39"	4.464	(along existing fence)	232° 17' 36"	0.753		322° 28' 44"	5.027	(along existing drain)	277° 23' 52"	5.484	(along existing drain)	7° 21' 57"	18.016	(along existing drain)	277° 09' 00"	11.582		7° 09' 00"	17.360	(along existing hoarding)	276° 57' 48"	13.737	(along existing hoarding)	7° 44' 15"	31.868	(along existing hoarding)
<i>Bearing</i>	<i>Distance in metres</i>																																	
7° 26' 08"	20.913	(along existing fence)																																
322° 30' 39"	4.464	(along existing fence)																																
232° 17' 36"	0.753																																	
322° 28' 44"	5.027	(along existing drain)																																
277° 23' 52"	5.484	(along existing drain)																																
7° 21' 57"	18.016	(along existing drain)																																
277° 09' 00"	11.582																																	
7° 09' 00"	17.360	(along existing hoarding)																																
276° 57' 48"	13.737	(along existing hoarding)																																
7° 44' 15"	31.868	(along existing hoarding)																																

THE SCHEDULE — *continued*

7° 30' 34"	29.798	(along existing hoarding)
7° 30' 34"	2.120	
97° 30' 25"	73.683	
187° 37' 09"	27.634	(along existing drain)
187° 35' 06"	39.139	(along existing drain)
187° 28' 32"	10.003	
187° 33' 33"	21.087	(along existing drain)
187° 27' 16"	28.124	(along existing drain)
187° 27' 16"	0.144	(along existing drain)
277° 39' 27"	9.217	
277° 39' 27"	12.973	(along existing fence)
277° 40' 02"	13.305	(along existing fence)

to the point of commencement.

The boundaries of "SINGAPORE ARMED FORCES COURT MARTIAL CENTRE" are more particularly delineated and edged pink on the Survey Plan No. BI/00/569/GAZ filed in the office of the Director, Building and Infrastructure, Defence Science and Technology Agency, Singapore.

THE SCHEDULE — *continued*

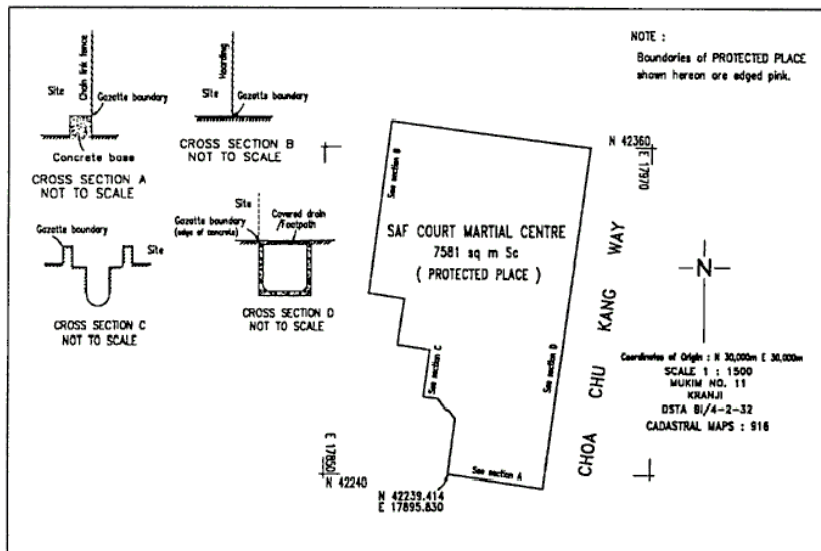

First column

Second column

The Authority

Protected Place

(8) S 240/2001
[27.4.2001]
Managing
Director of
PowerGrid Ltd

400 KV SUBSTATION AT AYER RAJAH
CRESCENT, SINGAPORE.

All that area comprised in part of State Land Lots 3106C Mk 3 Pasir Panjang, occupied by “400 KV SUBSTATION AT AYER RAJAH CRESCENT, SINGAPORE” containing an area of about 11,529.1 square metres and bounded approximately as follows:

Commencing at the northeastern-most corner of the perimeter fence of the aforesaid “400 KV SUBSTATION AT AYER RAJAH CRESCENT, SINGAPORE” which the point is 31,106.6 metres North and 23,088.2 metres East of the Survey Department origin of co-ordinates, the boundaries run along successive lines of fence of bearings and distances approximately as under:

Bearing Distance in metres

THE SCHEDULE — *continued*

213° 21'	136.5	(along chain link fence)
303° 30'	33.3	(along chain link fence)
304° 31'	1.2	(along wall)
32° 51'	0.9	(along wall)
303° 16'	7.6	(across a gate)
214° 12'	0.9	(along wall)
303° 22'	10.8	(along wall)
216° 05'	0.2	(along wall)
305° 51'	0.3	(along wall)
303° 41'	25.9	(along chain link fence)
25° 10'	2.1	(along chain link fence)
16° 57'	2.1	(along chain link fence)
22° 46'	10.7	(along chain link fence)
23° 00'	1.2	(across a gate)
22° 59'	103.6	(along chain link fence)

to the point of commencement.

The boundaries of “400 KV SUBSTATION AT AYER RAJAH CRESCENT, SINGAPORE” are more particularly delineated in the Plan set out below.

THE SCHEDULE — *continued*

AYER RAJA CRESENT 400 KV SUB-STATION

MUKIM NO. 3

SCALE 1 : 1200

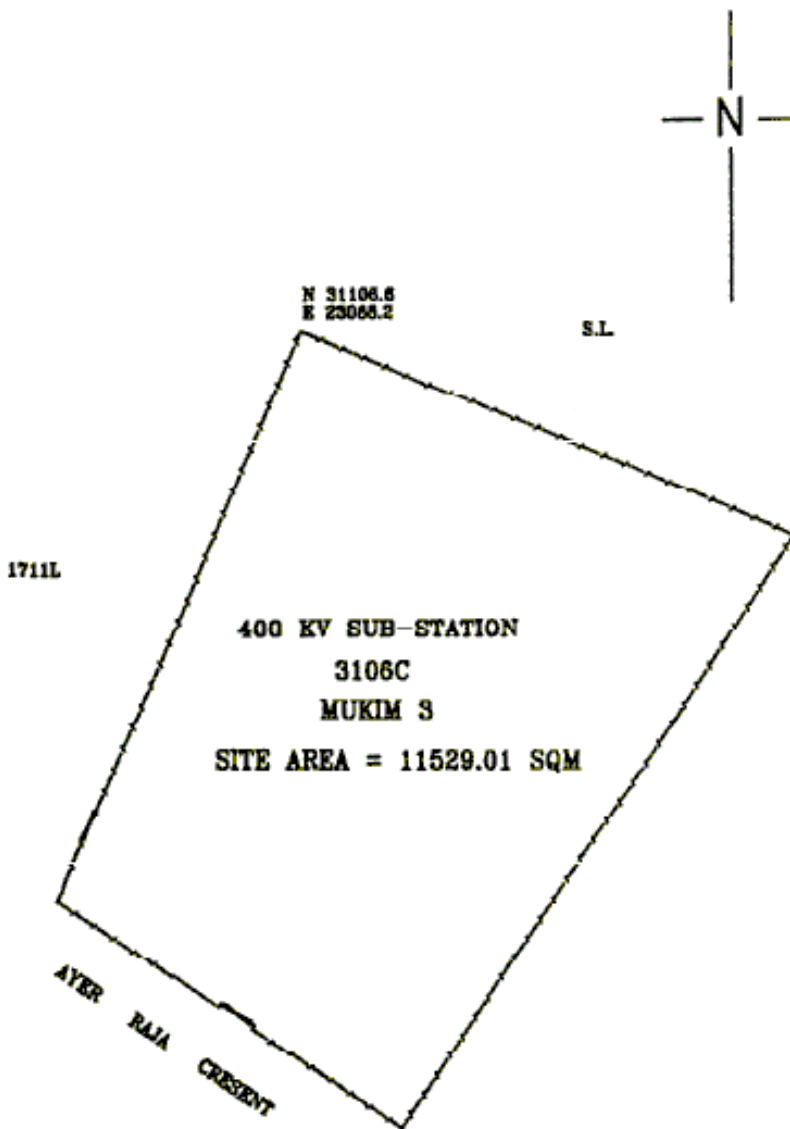

First column

The Authority

Second column

Protected Place

THE SCHEDULE — *continued*

- (9) S 241/2001
[27.4.2001]
Managing
Director of
PowerGrid Ltd
- 230 KV SUBSTATION AT PENG NGUAN STREET,
SINGAPORE.

All that area comprised in lot 2642X Mk 1, occupied by “230 KV SUBSTATION AT PENG NGUAN STREET, SINGAPORE” containing an area of about 5,053.6 square metres and bounded approximately as follows:

Commencing at the northeastern-most corner of the perimeter fence of the aforesaid “230 KV SUBSTATION AT PENG NGUAN STREET, SINGAPORE” which point is 27,821.2 metres North and 29,454.1 metres East of the Survey Department origin of co-ordinates (30,000 metres North, 30,000 metres East), the boundaries run along successive lines of fence of bearings and distances as under:

<i>Bearing</i>	<i>Distance in metres</i>			
141° 10'	3.5	(along	chain	link
		fence)		
232° 02'	0.2	(along	chain	link
		fence)		
141° 36'	6.0	(across a gate)		
52° 02'	0.2	(along	chain	link
		fence)		
141° 44'	77.6	(along	chain	link
		fence)		
243° 38'	60.4	(along	chain	link
		fence)		
315° 38'	54.2	(along	chain	link
		fence)		
226° 33'	0.4	(along wall)		
321° 24'	9.8	(along wall)		
51° 39'	0.3	(along wall)		

THE SCHEDULE — *continued*

322° 04'	0.2	(along chain link fence)
49° 15'	0.2	(along chain link fence)
321° 27'	8.0	(across a gate)
232° 58'	0.2	(along chain link fence)
322° 05'	2.8	(along chain link fence)
51° 46'	33.2	(along chain link fence)
51° 41'	31.7	(along chain link fence)

to the point of commencement.

The boundaries of “230 KV SUBSTATION AT PENG NGUAN STREET, SINGAPORE” are more particularly delineated in the Plan set out below.

THE SCHEDULE — *continued*

PENG NGUAN 230 KV SUB-STATION
MUKIM NO. 1
SCALE 1:750

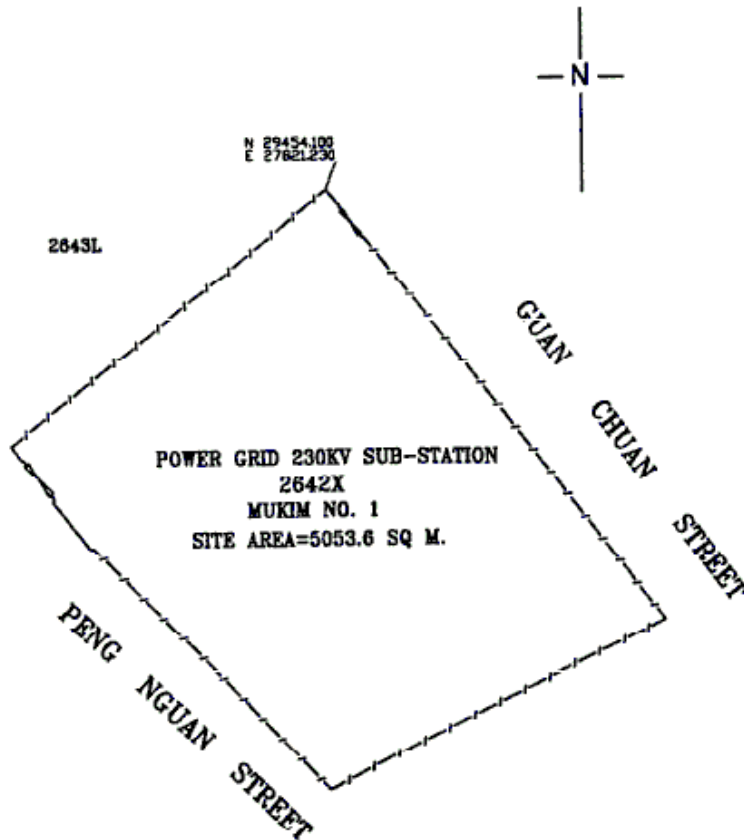

First column

Second column

The Authority

Protected Place

(10) S 242/2001
[27.4.2000]
Managing
Director of
PowerGrid Ltd

PIONEER TERMINAL BUILDING AT PIONEER
SECTOR 1, SINGAPORE.

All that area comprised in Lot 2924T MK 7, occupied
by "PIONEER TERMINAL BUILDING AT
PIONEER SECTOR 1, SINGAPORE" containing an

THE SCHEDULE — *continued*

area of about 12,163.7 square metres and bounded approximately as follows:

Commencing at the northeastern-most corner of the perimeter fence of the aforesaid “PIONEER TERMINAL BUILDING AT PIONEER SECTOR 1, SINGAPORE” which point is 31,930.4 metres North and 7,928.8 metres East of the Survey Department origin of co-ordinates, the boundaries run along successive lines of fence of bearings and distances as under:

<i>Bearing</i>	<i>Distance in metres</i>			
133° 25'	78.9	(along	chain	link
		fence)		
133° 27'	125.6	(along	chain	link
		fence)		
224° 04'	12.5	(along	chain	link
		fence)		
313° 37'	0.9	(along	chain	link
		fence)		
223° 12'	1.0	(along	chain	link
		fence)		
134° 41'	0.8	(along wall)		
223° 32'	6.0	(along wall)		
315° 34'	0.8	(along wall)		
228° 28'	0.6	(along	chain	link
		fence)		
223° 37'	6.0	(across a gate)		
225° 26'	1.2	(along	chain	link
		fence)		
136° 21'	0.9	along chain link fence)		
223° 44'	19.9	(along	chain	link
		fence)		
227° 40'	12.5	(along	chain	link
		fence)		

THE SCHEDULE — *continued*

313° 22'	99.9	(along	chain	link
		fence)		
313° 31'	101.4	(along	chain	link
		fence)		
41° 18'	25.7	(along	chain	link
		fence)		
41° 55'	26.0	(along	chain	link
		fence)		
42° 03'	2.0	(across a gate)		
41° 48'	6.1	(along	chain	link
		fence)		

to the point of commencement.

The boundaries of “PIONEER TERMINAL BUILDING AT PIONEER SECTOR 1, SINGAPORE” are more particularly delineated in the Plan set out below.

THE SCHEDULE — *continued*

PIONEER TERMINAL BUILDING
MUKIM NO. 7
SCALE 1:1200

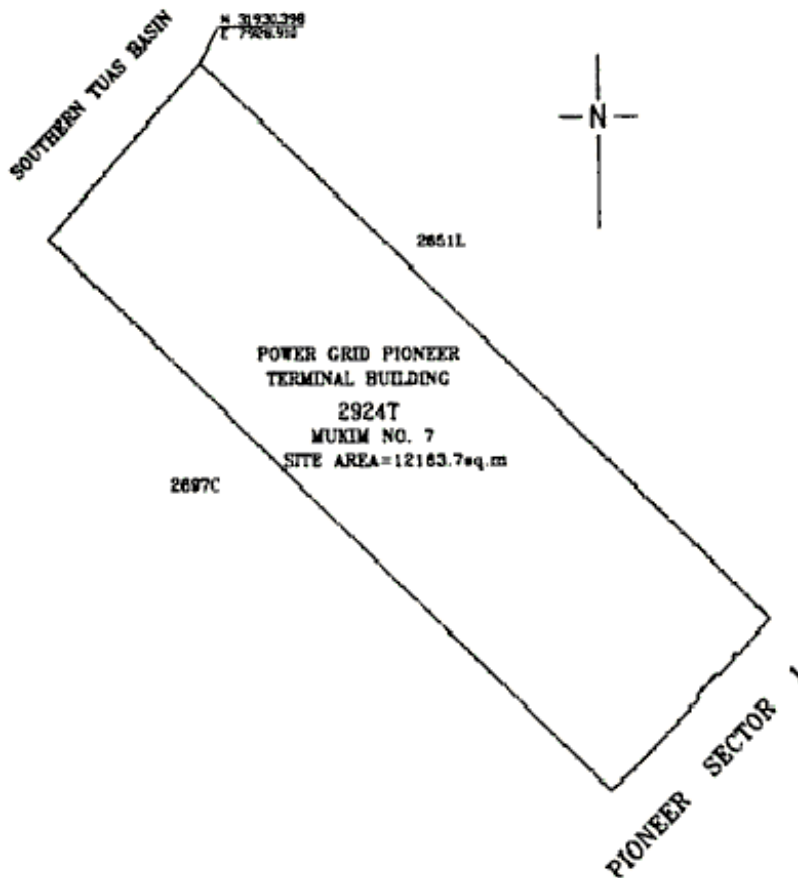

(11) [Deleted by S 999/2020 wef 09/12/2020]

(12) [Deleted by S 127/2016 wef 24/03/2016]

First column

Second column

The Authority

Protected Place

THE SCHEDULE — *continued*

- (13) S 526/2001 SATS INFLIGHT CATERING CENTRE 1
 [18.10.2001]
 Catering
 Maintenance
 And System
 Manager
 SATS
 Catering

All that area comprised in part of Lot 3369W MUKIM No. 31 (CHANGI), occupied by “CIVIL AVIATION AUTHORITY OF SINGAPORE”, containing an area of approximately 14,516 square metres and bounded approximately as follows:

Commencing at the northernmost corner of the perimeter fence of the aforesaid “SATS INFLIGHT CATERING CENTRE 1” which point is 36,096.8 metres North and 44,713.0 metres East of the Survey Department origin of co-ordinates (30,000 metres North, 30,000 metres East), the boundaries run along successive lines of fence of bearings and distances as under:

Bearing	Distance in metres	
113° 00' 42"	85.20	(along chain link fence)
203° 00' 42"	170.37	(along existing protected line)
293° 00' 42"	85.20	(along chain link fence)
23° 00' 42"	170.37	(along chain link fence and gates)

to the point of commencement.

The boundaries of “SATS INFLIGHT CATERING CENTRE 1” are more particularly delineated in the Plan set out below.

THE SCHEDULE — *continued*

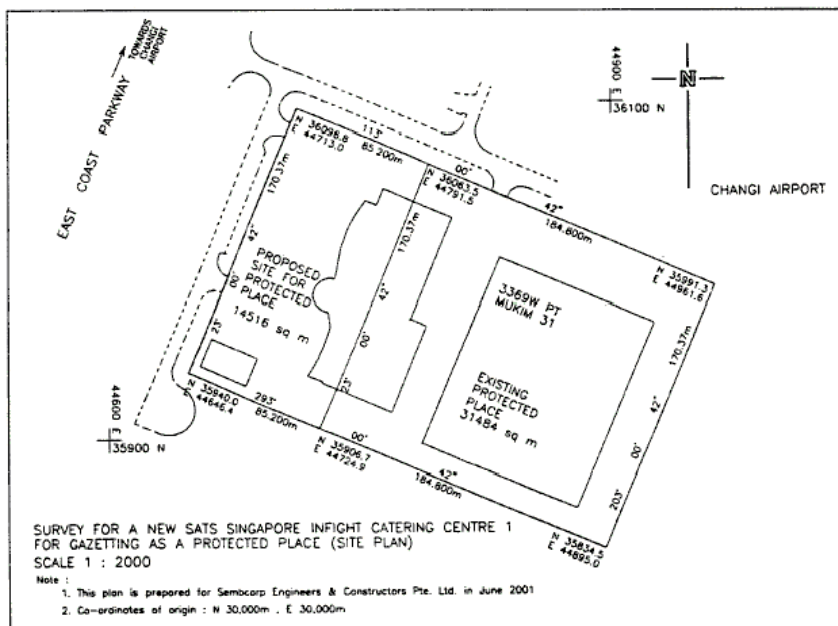

[S 416/2006 wef 12/07/2006]

First column

Second column

The Authority

Protected Place

(15) S 666/2001
[26.12.2001]
Commander of
Police Coast
Guard

POLICE COAST GUARD BRANI BASE

All that area comprised in part of State Land Lots 390PT, Police Coast Guard Brani Base, No. 10 Brani Terminal Ave, Singapore 098658, occupied by “POLICE COAST GUARD” containing an area of about 1,602.99 square metres and bounded approximately as follows:

Commencing at the north-easternmost corner of the perimeter fence of the aforesaid “POLICE COAST GUARD BRANI BASE” which point is 54.288 metres North and 26.452 metres East of the Survey Department origin of co-ordinates, (30,000 metres North, 30,000 metres East), the boundaries run along

THE SCHEDULE — *continued*

successive lines of fence of bearings and distances as under:

<i>Bearing</i>	<i>Distance in metres</i>	
17° 50' 01"	54.288	(along chain link fence)
34° 01' 20"	26.452	(along chain link fence)
108° 11' 19"	111.312	(along chain link fence)
51° 37' 43"	17.770	(along chain link fence)
19° 41' 31"	19.419	(along chain link fence)
5° 05' 53"	3.377	(along chain link fence)
107° 14' 30"	46.950	(along chain link fence)
196° 53' 56"	51.341	(along chain link fence)
195° 59' 24"	8.913	(along chain link fence)
158° 21' 50"	9.294	(along chain link fence)
196° 11' 04"	24.913	(along chain link fence)
182° 19' 14"	24.171	(along chain link fence)

to the point of commencement.

The boundaries of "POLICE COAST GUARD BRANI BASE" are more particularly delineated in the Plan set out below.

THE SCHEDULE — continued

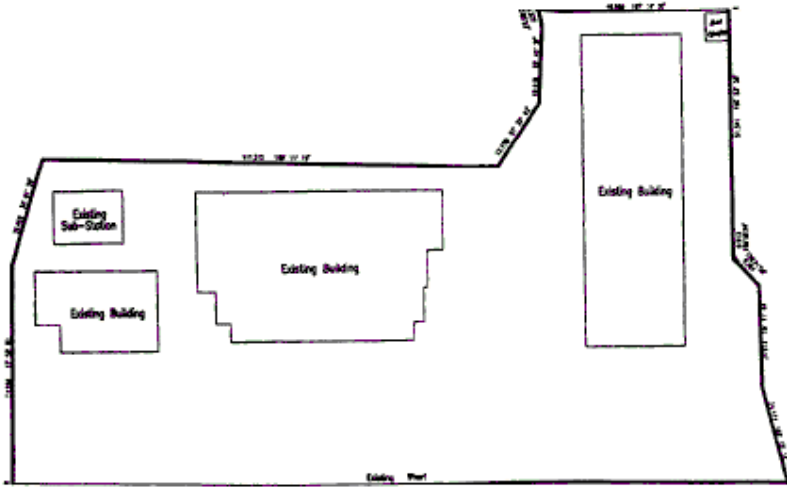

LEGISLATIVE HISTORY
PROTECTED PLACES (CONSOLIDATION) ORDER
(CHAPTER 256, O 14)

This Legislative History is provided for the convenience of users of the Protected Places (Consolidation) Order. It is not part of this Order.

- 1. G. N. No. S 9/2000 — Protected Places Order 2000**
Date of commencement : 7 January 2000
- 2. G. N. No. S 149/2000 — Protected Places (No. 2) Order 2000**
Date of commencement : 30 March 2000
- 3. G. N. No. S 13/2001 — Protected Places Order 2001**
Date of commencement : 5 January 2001
- 4. G. N. No. S 62/2001 — Protected Places (No. 2) Order 2001**
Date of commencement : 13 February 2001
- 5. G. N. No. S 82/2001 — Protected Places (No. 3) Order 2001**
Date of commencement : 14 February 2001
- 6. G. N. No. S 131/2001 — Protected Places (No. 4) Order 2001**
Date of commencement : 16 March 2001
- 7. G. N. No. S 154/2001 — Protected Places (No. 5) Order 2001**
Date of commencement : 29 March 2001
- 8. G. N. No. S 240/2001 — Protected Places (No. 6) Order 2001**
Date of commencement : 27 April 2001
- 9. G. N. No. S 241/2001 — Protected Places (No. 7) Order 2001**
Date of commencement : 27 April 2001
- 10. G. N. No. S 242/2001 — Protected Places (No. 8) Order 2001**
Date of commencement : 27 April 2001
- 11. G. N. No. S 253/2001 — Protected Places (No. 9) Order 2001**
Date of commencement : 4 May 2001
- 12. G. N. No. S 471/2001 — Protected Areas (No. 10) Order 2001**
Date of commencement : 28 September 2001

- 13. G. N. No. S 526/2001 — Protected Places (No. 11) Order 2001**
Date of commencement : 18 October 2001
- 14. 2002 Revised Edition — Protected Places (Consolidation) Order**
Date of operation : 31 January 2002
- 15. G. N. No. S 534/2002 — Protected Places (Consolidation) (Amendment) Order 2002**
Date of commencement : 1 October 2002
- 16. G. N. No. S 400/2003 — Protected Places (Consolidation) (Amendment) Order 2003**
Date of commencement : 22 August 2003
- 17. G. N. No. S 457/2005 — Protected Places (Consolidation) (Amendment) Order 2005**
Date of commencement : 13 July 2005
- 18. G. N. No. S 702/2008 — Protected Places (Consolidation) (Amendment) Order 2008**
Date of commencement : 31 December 2008
- 19. G. N. No. S 540/2010 — Protected Places (Consolidation) (Amendment) Order 2010**
Date of commencement : 22 September 2010
- 20. G.N. No. S 214/2015 — Protected Places (Consolidation) (Amendment) Order 2015**
Date of commencement : 15 April 2015
- 21. G.N. No. S 127/2016 — Protected Places (No. 2) Order 2016**
Date of commencement : 24 March 2016
- 22. G.N. No. S 999/2020 — Infrastructure Protection (Protected Places) (No. 16) Order 2020**
Date of commencement : 9 December 2020