

## PROTECTED AREAS AND PROTECTED PLACES ACT (CHAPTER 256, SECTION 5(1))

### PROTECTED PLACES (CONSOLIDATION) ORDER

#### ARRANGEMENT OF PARAGRAPHS

##### Paragraph

1. Citation
  2. Protected places, permits and authorised officers  
The Schedule
- 

#### **Citation**

**1.** This Order may be cited as the Protected Places (Consolidation) Order.

#### **Protected places, permits and authorised officers**

**2.** The premises described in the second column of the Schedule are declared to be protected places for the purposes of the Protected Areas and Protected Places Act and no person shall be in those premises unless he is in possession of a pass-card or permit issued by the authority specified in the first column of that Schedule or has received the permission of an authorised officer on duty at the premises to enter the premises.

#### THE SCHEDULE

<i>First column</i>	<i>Second column</i>
The Authority	Protected Place
(1) [ <i>Deleted by S 12/97 wef 01/03/97</i> ]	
(2) [ <i>Deleted by S 942/2020 wef 05/11/2020</i> ]	
<i>First column</i>	<i>Second column</i>
The Authority	Protected Place
(3) S 286/93 [2.7.93] General Manager,	MOBIL OIL SINGAPORE PTE LTD (JURONG REFINERY).

THE SCHEDULE — *continued*

<i>First column</i>	<i>Second column</i>																																		
The Authority	Protected Place																																		
Mobil Oil Singapore Pte Ltd, Jurong Refinery.	<p>All those areas comprised in government Survey Lots 187, 1293, 1401, 1901, 2519 and 2520 (known as Plot A) and Lot 282, 283, 289, 812 (known as Plot B) and Plot C, Mukim No. 6 containing areas of about 857,000 square metres and 188,000 square metres and 12,597 square metres, respectively, and bounded approximately as follows:</p> <p>PLOT A</p> <p>Commencing at a point which is 31,835.000 metres North and 11,466.398 metres East of Survey Department origin of co-ordinates (North 30,000 metres, East 30,000 metres) the boundaries run along successive lines of bearings and distances as under:</p> <table> <tr> <th><i>Bearing</i></th><th><i>Distance in metres</i></th></tr> <tr><td>359° 38' 10"</td><td>537.091</td></tr> <tr><td>354° 00' 43"</td><td>4.783</td></tr> <tr><td>342° 45' 50"</td><td>4.783</td></tr> <tr><td>331° 30' 56"</td><td>4.783</td></tr> <tr><td>320° 16' 02"</td><td>4.783</td></tr> <tr><td>309° 01' 08"</td><td>4.783</td></tr> <tr><td>297° 46' 14"</td><td>4.783</td></tr> <tr><td>286° 31' 20"</td><td>4.783</td></tr> <tr><td>275° 16' 26"</td><td>4.783</td></tr> <tr><td>269° 39' 00"</td><td>206.352</td></tr> <tr><td>272° 10' 22"</td><td>5.711</td></tr> <tr><td>277° 13' 06"</td><td>5.711</td></tr> <tr><td>282° 15' 50"</td><td>5.711</td></tr> <tr><td>287° 18' 34"</td><td>5.711</td></tr> <tr><td>292° 21' 19"</td><td>5.711</td></tr> <tr><td>297° 24' 03"</td><td>5.711</td></tr> </table>	<i>Bearing</i>	<i>Distance in metres</i>	359° 38' 10"	537.091	354° 00' 43"	4.783	342° 45' 50"	4.783	331° 30' 56"	4.783	320° 16' 02"	4.783	309° 01' 08"	4.783	297° 46' 14"	4.783	286° 31' 20"	4.783	275° 16' 26"	4.783	269° 39' 00"	206.352	272° 10' 22"	5.711	277° 13' 06"	5.711	282° 15' 50"	5.711	287° 18' 34"	5.711	292° 21' 19"	5.711	297° 24' 03"	5.711
<i>Bearing</i>	<i>Distance in metres</i>																																		
359° 38' 10"	537.091																																		
354° 00' 43"	4.783																																		
342° 45' 50"	4.783																																		
331° 30' 56"	4.783																																		
320° 16' 02"	4.783																																		
309° 01' 08"	4.783																																		
297° 46' 14"	4.783																																		
286° 31' 20"	4.783																																		
275° 16' 26"	4.783																																		
269° 39' 00"	206.352																																		
272° 10' 22"	5.711																																		
277° 13' 06"	5.711																																		
282° 15' 50"	5.711																																		
287° 18' 34"	5.711																																		
292° 21' 19"	5.711																																		
297° 24' 03"	5.711																																		

THE SCHEDULE — *continued*

<i>First column</i>	<i>Second column</i>
The Authority	Protected Place
302° 26' 27"	5.711
307° 29' 32"	5.711
312° 32' 16"	5.711
317° 35' 00"	5.711
322° 37' 44"	5.711
327° 40' 29"	5.711
332° 43' 13"	5.711
337° 45' 57"	5.711
340° 17' 20"	108.057
25° 17' 20"	12.728
70° 17' 20"	161.506
69° 31' 17"	41.273
60° 18' 00"	514.450
60° 17' 43"	45.221
60° 54' 13"	25.144
64° 12' 40"	28.091
66° 56' 42"	28.330
69° 39' 40"	27.715
73° 55' 43"	27.876
76° 15' 18"	28.657
78° 34' 08"	20.085
125° 09' 22"	12.571
171° 43' 19"	94.351
152° 24' 13"	16.571
227° 56' 00"	216.614
134° 41' 30"	167.624
134° 41' 10"	263.620

THE SCHEDULE — *continued*

<i>First column</i>	<i>Second column</i>
The Authority	Protected Place
213° 53' 00"	101.996
308° 21' 00"	3.048
218° 23' 00"	71.658
128° 20' 00"	247.124
214° 55' 30"	17.242
208° 07' 50"	28.122
205° 52' 00"	122.672
208° 11' 40"	30.458
212° 25' 33"	30.262
216° 55' 10"	30.172
221° 20' 40"	30.056
225° 43' 20"	30.224
230° 08' 50"	30.204
234° 35' 00"	30.240
238° 57' 30"	30.228
243° 21' 20"	30.226
247° 46' 20"	30.140
252° 13' 30"	30.278
256° 34' 00"	30.226
260° 56' 50"	30.208
265° 21' 50"	30.220
269° 47' 40"	30.234
274° 13' 20"	21.914
276° 24' 30"	459.048

to the point of commencement.

PLOT B

THE SCHEDULE — *continued*

<i>First column</i>	<i>Second column</i>
The Authority	Protected Place
	Commencing at a point which is 31,741.111 metres North and 11,919.526 metres East of the Survey Department origin of co-ordinates (North 30,000 metres, East 30,000 metres) the boundaries run along successive lines of bearings and distances as under:
<i>Bearing</i>	<i>Distance in metres</i>
94° 13' 10"	23.528
89° 47' 30"	33.536
85° 21' 40"	33.516
80° 56' 40"	33.486
76° 34' 00"	20.780
76° 33' 40"	12.696
72° 13' 20"	19.808
184° 08' 20"	176.784
94° 02' 50"	18.294
184° 08' 20"	302.162
81° 00' 00"	219.584
180° 00' 00"	124.054
261° 00' 00"	811.638
0° 00' 00"	124.054
81° 00' 00"	538.854
4° 08' 20"	61.000
274° 08' 20"	15.000
4° 08' 20"	40.000
94° 08' 20"	15.000
4° 08' 20"	79.810
269° 15' 28"	79.310
184° 44' 26"	34.729

THE SCHEDULE — *continued*

<i>First column</i>	<i>Second column</i>
The Authority	Protected Place
163° 44' 06"	1.540
94° 51' 44"	2.914
184° 55' 26"	17.347
158° 31' 33"	1.095
95° 25' 48"	8.001
185° 06' 02"	8.555
275° 04' 36"	30.504
4° 57' 12"	8.522
94° 48' 37"	7.570
11° 44' 22"	7.222
4° 45' 47"	9.836
25° 27' 00"	10.161
5° 02' 10"	28.343
292° 32' 00"	26.786
4° 19' 40"	97.842
282° 00' 02"	29.682
3° 57' 50"	34.174
4° 15' 30"	171.524
4° 35' 50"	54.334

to the point of commencement.

## PLOT C

Commencing at a point which is 31,117.863 metres North and 12,389.953 metres East of the Survey Department origin of co-ordinates (North 30,000 metres, East 30,000 metres) the boundaries run along successive lines of bearings and distances as under:

<i>Bearing</i>	<i>Distance in metres</i>
260° 59' 11"	102.815

THE SCHEDULE — continued

<i>First column</i>	<i>Second column</i>
The Authority	Protected Place
180° 00' 00"	124.054
80° 59' 03"	102.815
180° 00' 00"	124.054

to the point of commencement.

The boundaries of “MOBIL OIL SINGAPORE PTE LTD AT PIONEER ROAD/SHIPYARD ROAD/REFINERY ROAD” are more particularly delineated in the plan set out hereunder

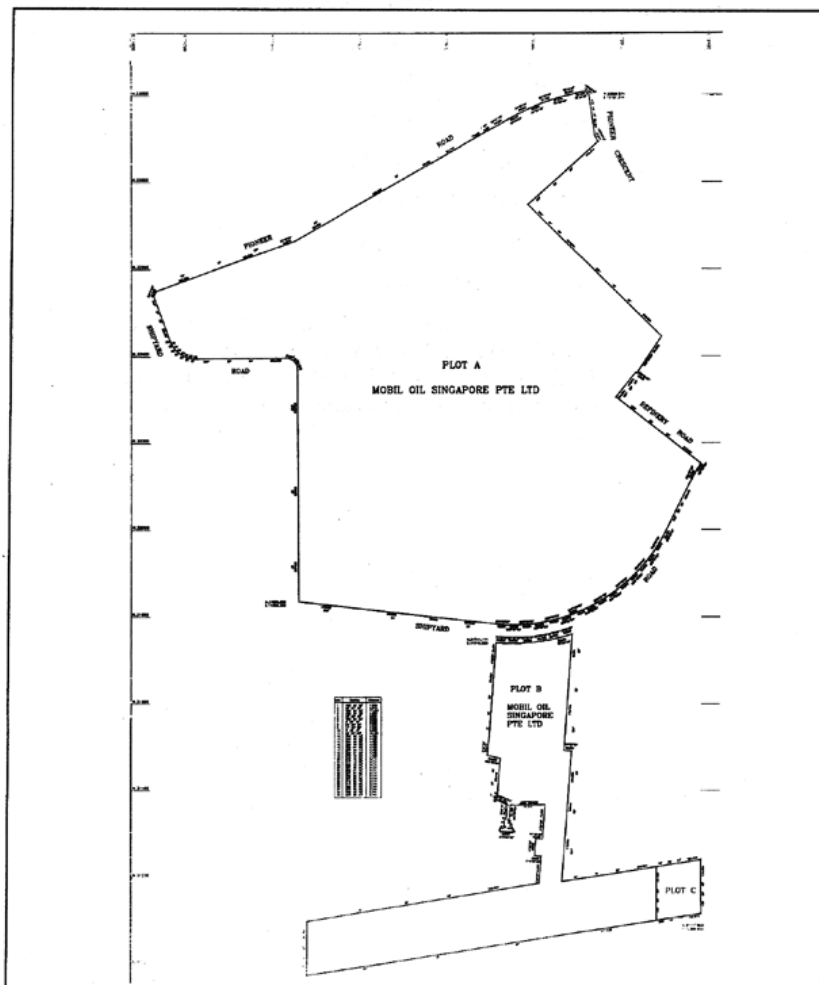
THE SCHEDULE — *continued**First column*

The Authority

(4) S 359/93

[3.9.93]

Civil Aviation  
Authority of  
Singapore.*Second column*

Protected Place

1. VOR STATION — PULAU SAKIJANG  
PELEPAH (LAZARUS ISLAND)All those areas comprised in part of State Land Lot  
58, Mukim No. 34 (OTHER ISLANDS) occupied by  
“VOR STATION — PULAU SAKIJANG  
PELEPAH (LAZARUS ISLAND)” containing an



THE SCHEDULE — *continued*

<i>First column</i>	<i>Second column</i>
The Authority	Protected Place
	area of approximately 17,200.6 square metres and bounded approximately as follows:
	Commencing at the southernmost corner of the wooden perimeter fence of the aforesaid “VOR STATION — PULAU SAKIJANG PELEPAH (LAZARUS ISLAND)” which point is 7,299.1 metres South and 360.4 metres East of the Survey Department origin of co-ordinates, the boundary runs along a line of wooden fence on a bearing of approximately 276° 02' for a distance of 6.1 metres, thence along successive lines of wooden fence of bearings and distances approximately as under:
<i>Bearing</i>	<i>Distance in metres</i>
292° 41'	12.3
304° 19'	5.4
306° 35'	0.5
312° 04'	41.6
326° 55'	15.2
324° 50'	9.0
319° 28'	5.9
312° 54'	29.9
319° 08'	9.3
326° 00'	11.9
329° 02'	18.0
341° 43'	6.1
348° 50'	6.0
356° 59'	11.8
3° 23'	6.0
19° 58'	15.1
36° 00'	2.7

THE SCHEDULE — *continued*

<i>First column</i>	<i>Second column</i>
The Authority	Protected Place
57° 26'	24.0
69° 55'	17.8
76° 54'	6.0
94° 41'	5.8
97° 54'	8.1
60° 11'	3.0
46° 09'	6.1 (partly across a gate)
122° 49'	10.5
123° 56'	4.3
127° 29'	14.9
132° 25'	17.6
138° 20'	6.0
153° 16'	9.0
157° 15'	14.7
134° 48'	4.3
166° 40'	4.7
158° 49'	34.4
163° 11'	9.0
167° 07'	21.2
163° 43'	15.1
171° 29'	11.1
179° 32'	6.7
193° 55'	9.0
205° 11'	5.1
228° 50'	13.2
242° 38'	8.4
260° 16'	11.9

THE SCHEDULE — *continued*

<i>First column</i>	<i>Second column</i>
The Authority	Protected Place

to the point of commencement.

The boundaries of “VOR STATION — PULAU SAKIJANG PELEPAH (LAZARUS ISLAND)” are more particularly delineated and edged pink on Survey Print No. 1691-76 filed in the office of the Chief Surveyor, Singapore.

2. LAZARUS ISLAND GENERATOR HUT

All that area comprised in part of State Land Lot 58 Mukim No. 34 (OTHER ISLANDS) at LAZARUS ISLAND occupied by “LAZARUS ISLAND GENERATOR HUT” containing an area of about 168 square metres and bounded approximately as follows:

Commencing at the Northernmost corner of the perimeter fence of the aforesaid “LAZARUS ISLAND GENERATOR HUT” which point is 22,948.7 metres North and 30,194.4 metres East of the Survey Department origin of co-ordinates (30,000 metres North, 30,000 metres East), the boundary runs along successive lines of fence of bearings and distances as under:

<i>Bearing</i>	<i>Distance in metres</i>
170° 44'	12.4
261° 21'	5.8
351° 33'	2.5
262° 30'	9.9
350° 52'	9.7
81° 13'	15.6

to the point of commencement.

The boundaries of “LAZARUS ISLAND GENERATOR HUT” are more particularly delineated and edged pink on Survey Plan No. S.P.

THE SCHEDULE — *continued**First column**Second column*

The Authority

Protected Place

40007 filed in the office of the Chief Surveyor,  
Singapore.

(5) [*Deleted by S 343/2005 wef 03/06/2005*]

Director of Prisons.

(2) ABINGDON WORK RELEASE CAMP

All that area comprised wholly in part Lot 341-2  
Mukim No. 31 (Abingdon Road) occupied by  
“ABINGDON WORK RELEASE CAMP”  
containing an area of about 32,277.7 square metres  
and bounded approximately as follows:

Commencing at the westernmost corner of the  
perimeter fence of the aforesaid “ABINGDON  
WORK RELEASE CAMP” which point is 38,970.4  
metres North and 44,138.2 metres East of the Survey  
Department origin of co-ordinates, the boundaries  
run along successive lines of fences of bearings and  
distances as under:

<i>Bearing</i>	<i>Distance in metres</i>
49° 53'	29.6 (along fence)
49° 49'	38.5
139° 11'	73.4
151° 04'	19.8
183° 56'	28.9
194° 09'	43.0
159° 48'	15.4
146° 03'	31.2
139° 14'	47.8
137° 27'	59.6
135° 42'	57.4
135° 45'	33.5
136° 13'	72.1

THE SCHEDULE — *continued*

<i>First column</i>	<i>Second column</i>
The Authority	Protected Place
225° 35'	71.5
267° 03'	66.4
267° 48'	30.9
2° 25'	5.2
273° 21'	9.2
181° 21'	5.5
272° 04'	30.5
12° 43'	53.1
324° 14'	45.0
50° 31'	54.7
40° 56'	12.1
357° 58'	47.7
338° 53'	17.6
338° 53'	14.9
323° 05'	30.1
323° 02'	65.4
323° 03'	26.9
321° 29'	36.2
321° 30'	33.1
321° 27'	35.9

to the point of commencement.

The boundaries of “ABINGDON WORK RELEASE CAMP” are more particularly delineated and edged pink on the survey plan filed under Reference No. D Pris 198/02/01 in the office of the Director of Prisons, Singapore.

Director of Prisons. (3) SINGAPORE PRISONS EMERGENCY ACTION RESPONSE (SPEAR) BASE

THE SCHEDULE — *continued*

<i>First column</i>	<i>Second column</i>																																
The Authority	Protected Place																																
	<p>All that area comprised in resurvey Lot 422PT, Lot 554, Lot 555PT, Lot 421PT and part of Crown Reserve Mukim No. XXX1 at the junction of Upper Changi Road/Tanah Merah Besar Road occupied by “SINGAPORE PRISONS EMERGENCY ACTION RESPONSE (SPEAR) BASE” containing an area of about 9,624.3 square metres and bounded approximately as follows:</p> <p>Commencing at a point which is 38,200.2 metres North and 43,448.7 metres East of the Survey Department origin of co-ordinates (30,000 metres North, 30,000 metres East), the boundaries run along successive lines of bearings and distances and bounded by wire fence partially imbedded in 0.18 metres concrete footing as under:</p> <table> <tr> <th><i>Bearing</i></th><th><i>Distance in metres</i></th></tr> <tr><td>54° 42'</td><td>27.1</td></tr> <tr><td>87° 14'</td><td>18.3</td></tr> <tr><td>97° 31'</td><td>18.1</td></tr> <tr><td>100° 44'</td><td>3.0</td></tr> <tr><td>104° 33'</td><td>21.0</td></tr> <tr><td>104° 46'</td><td>27.3</td></tr> <tr><td>30° 27'</td><td>15.0</td></tr> <tr><td>102° 33'</td><td>24.4</td></tr> <tr><td>102° 57'</td><td>23.9</td></tr> <tr><td>100° 29'</td><td>42.1</td></tr> <tr><td>203° 08'</td><td>24.0</td></tr> <tr><td>202° 52'</td><td>41.2</td></tr> <tr><td>280° 26'</td><td>44.4</td></tr> <tr><td>284° 19'</td><td>39.0</td></tr> <tr><td>333° 15'</td><td>4.3</td></tr> </table>	<i>Bearing</i>	<i>Distance in metres</i>	54° 42'	27.1	87° 14'	18.3	97° 31'	18.1	100° 44'	3.0	104° 33'	21.0	104° 46'	27.3	30° 27'	15.0	102° 33'	24.4	102° 57'	23.9	100° 29'	42.1	203° 08'	24.0	202° 52'	41.2	280° 26'	44.4	284° 19'	39.0	333° 15'	4.3
<i>Bearing</i>	<i>Distance in metres</i>																																
54° 42'	27.1																																
87° 14'	18.3																																
97° 31'	18.1																																
100° 44'	3.0																																
104° 33'	21.0																																
104° 46'	27.3																																
30° 27'	15.0																																
102° 33'	24.4																																
102° 57'	23.9																																
100° 29'	42.1																																
203° 08'	24.0																																
202° 52'	41.2																																
280° 26'	44.4																																
284° 19'	39.0																																
333° 15'	4.3																																

THE SCHEDULE — *continued*

<i>First column</i>	<i>Second column</i>
The Authority	Protected Place

286° 37'	21.9
286° 25'	23.9
286° 45'	24.2
308° 39'	36.2

to the point of commencement.

The boundaries of SINGAPORE PRISONS EMERGENCY ACTION RESPONSE (SPEAR) BASE are more particularly delineated and edged pink on the survey plan filed under Reference No. D Pris 198/02/01 in the office of the Director of Prisons, Singapore.

Director of Prisons.

(4) PRISON STAFF TRAINING SCHOOL

All that area comprised In Lot 1845PT Mukim No. 13 occupied by “PRISON STAFF TRAINING SCHOOL” at Admiralty Road West/Sembawang Road containing an area of about 37,868 square metres and bounded approximately as follows:

Commencing at the north-eastern corner of the perimeter fence of the “PRISON STAFF TRAINING SCHOOL” which point is 48,574.6 metres North and 27,728.9 metres East of the Survey Department origin of co-ordinates, the boundaries run along successive lines of fences of bearings and distances as under:

<i>Bearing</i>	<i>Distance in metres</i>
81° 39'	5.0
13.3344° 47'	11.7
93° 28'	41.3
83° 09'	5.6
104° 10'	8.4
185° 02'	23.6
99° 35'	37.3

THE SCHEDULE — *continued*

<i>First column</i>	<i>Second column</i>
The Authority	Protected Place
172° 41'	6.4
89° 01'	68.4
36° 47'	1.9
82° 05'	5.5
68° 15'	10.6
56° 35'	65.4
142° 35'	14.5
136° 39'	30.7
124° 30'	2.2
124° 30'	3.8 (along gate and across St. Helena Road)
124° 30'	32.8
213° 01'	11.0
123° 29'	19.3
212° 01'	11.2
209° 33'	32.2
214° 00'	35.8
226° 27'	12.6
227° 00'	10.3
226° 41'	15.2
226° 27'	11.8
227° 28'	4.5
238° 48'	6.5
241° 54'	81.5
325° 27'	33.0
284° 49'	7.8
329° 23'	33.4



THE SCHEDULE — *continued*

<i>First column</i>	<i>Second column</i>
The Authority	Protected Place
235° 42'	3.1 (across concretedrain)
329° 31'	26.9
252° 03'	3.4
240° 14'	13.8
259° 05'	2.8
and thence along successive lines of brick wall of bearings and distances as under:	
<i>Bearing.</i>	<i>Distance in metres.</i>
209° 08'	0.2
299° 08'	2.3
294° 23'	2.1 (along a gate)
329° 49'	6.5 (along a gate and across St. Helena Road)
329° 57'	13.9
329° 41'	9.7
328° 53'	16.2
327° 47'	20.7
335° 06'	12.0
9° 44'	9.6
322° 26'	8.6
297° 17'	5.9
335° 16'	11.5
327° 00'	15.1
320° 39'	21.4
50° 39'	0.3

to the point of commencement.

The boundaries of “PRISON STAFF TRAINING SCHOOL” are delineated and edged pink on the

THE SCHEDULE — *continued*

<i>First column</i>	<i>Second column</i>																				
The Authority	Protected Place																				
	survey plan filed under Reference No. D Pris 198/02/01 in the office of Director of Prisons, Singapore.																				
(6) S 538/93 [31.12.93] Director-General of Civil Aviation	<p>SINGAPORE CHANGI AIRPORT — CIVIL AVIATION AUTHORITY'S LAND AT CHANGI NORTH</p> <p>All that area of the Civil Aviation Authority's Land at Changi North comprising parts of State Land lots 29, 38, 378-35, 378-36, 378-37, 378-53, 378-56, 378-57, 1104, 2156 and State Land lots 378-54 and 378-55 in mukim No. 31 (Changi North) containing an area of approximately 22,759 square metres and bounded approximately as follows:</p> <p>Commencing at a point on the northernmost corner of the aforesaid Civil Aviation Authority's Land which point is 36,986.2 metres North and 43,733.3 metres East of the Survey Department origin of co-ordinate (N 30,000 m, E 30,000 m) the boundaries running along successive lines of bearings and distances as under:</p> <table> <tr> <th><i>Bearing</i></th><th><i>Distance in metres</i></th></tr> <tr> <td>106° 16'</td><td>92.0</td></tr> <tr> <td>202° 58'</td><td>54.9 (along fencing)</td></tr> <tr> <td>203° 00'</td><td>55.9 (along fencing)</td></tr> <tr> <td>203° 11'</td><td>31.9 (along fencing)</td></tr> <tr> <td>203° 00'</td><td>6.4 (along gate)</td></tr> <tr> <td>202° 47'</td><td>40.9 (along fencing)</td></tr> <tr> <td>186° 44'</td><td>58.2 (along fencing)</td></tr> <tr> <td>286° 16'</td><td>105.5</td></tr> <tr> <td>22° 18'</td><td>247.7</td></tr> </table> <p>to the point of commencement.</p>	<i>Bearing</i>	<i>Distance in metres</i>	106° 16'	92.0	202° 58'	54.9 (along fencing)	203° 00'	55.9 (along fencing)	203° 11'	31.9 (along fencing)	203° 00'	6.4 (along gate)	202° 47'	40.9 (along fencing)	186° 44'	58.2 (along fencing)	286° 16'	105.5	22° 18'	247.7
<i>Bearing</i>	<i>Distance in metres</i>																				
106° 16'	92.0																				
202° 58'	54.9 (along fencing)																				
203° 00'	55.9 (along fencing)																				
203° 11'	31.9 (along fencing)																				
203° 00'	6.4 (along gate)																				
202° 47'	40.9 (along fencing)																				
186° 44'	58.2 (along fencing)																				
286° 16'	105.5																				
22° 18'	247.7																				

THE SCHEDULE — *continued**First column*

The Authority

*Second column*

Protected Place

The boundaries of “CIVIL AVIATION AUTHORITY’S LAND AT CHANGI NORTH” are more particularly delineated in the Plan set out in hereunder.

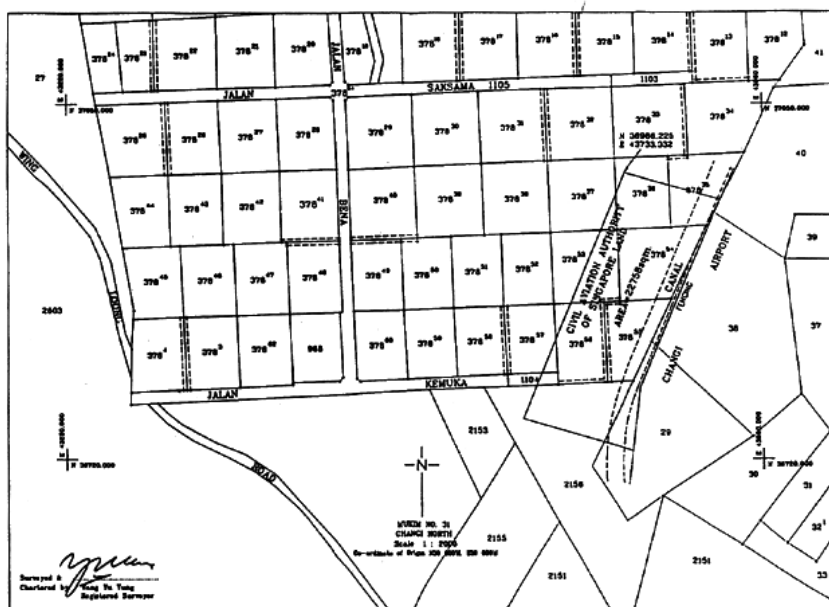
**CIVIL AVIATION AUTHORITY’S LAND AT CHANGI NORTH***First column*

The Authority

- (7) S539/93  
[31.12.93]  
General Manager,  
Singapore Aviation  
Services Co. Pte.  
Ltd.

*Second column*

Protected Place

CHANGI NORTH AVIATION INDUSTRIAL  
COMPLEX

All that area of JTC PLOT (A12002) at CHANGI NORTH AVIATION INDUSTRIAL COMPLEX comprising parts of State Land Lots 378-3, 378-4, 378-20, 378-21, 378-22, 378-25, 378-26, 378-29, 378-30, 378-31, 378-32, 378-36, 378-37, 378-44, 378-45, 378-60, 378-62, 378-64, 968, 1104, 1105, 2153, 2156, and State Land Lots 378-27, 378-28,

THE SCHEDULE — *continued*

<i>First column</i>	<i>Second column</i>
The Authority	Protected Place
	378-38, 378-39, 378-40, 378-41, 378-42, 378-43, 378-46, 378-47, 378-48, 378-49, 378-50, 378-51, 378-52, 378-53, 378-56, 378-57, 378-58, 378-59 in mukim No. 31 (Changi North) containing an area of approximately 96,976 square metres and bounded approximately as follows:
	Commencing at a point on the northernmost corner of the aforesaid CHANGI NORTH AVIATION INDUSTRIAL COMPLEX which point is 37,102.1 metres North and 43,336.1 metres East of the Survey Department origin of co-ordinate (N 30,000 m, E 30,000 m) the boundaries running along successive lines of bearings and distances as under:
<i>Bearing</i>	<i>Distance in metres</i>
106° 16'	413.8
202° 19'	247.6
286° 16'	326.8
328° 46'	82.7
16° 17'	190.3
	to the point of commencement.
	The boundaries of “CHANGI NORTH AVIATION INDUSTRIAL COMPLEX” are more particularly delineated in the Plan set out hereunder.

THE SCHEDULE — *continued*

**CHANGI NORTH AVIATION INDUSTRIAL COMPLEX**

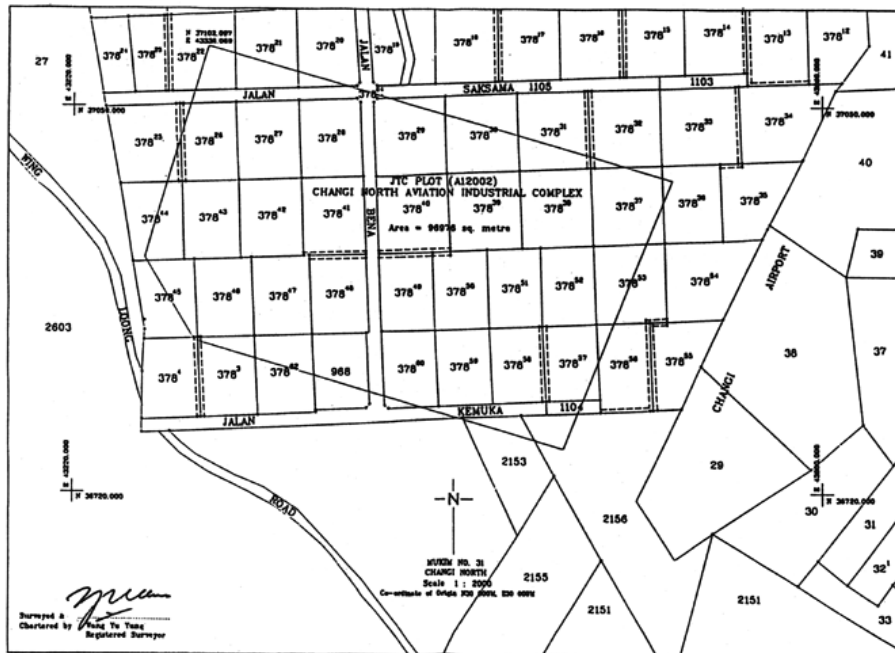

LEGISLATIVE HISTORY  
PROTECTED PLACES (CONSOLIDATION) ORDER  
(CHAPTER 256, O 5)

This Legislative History is provided for the convenience of users of the Protected Places (Consolidation) Order. It is not part of this Order.

**1. G. N. No. S 21/1993 — Protected Places (Consolidation) Order 1993**

Date of commencement : Date not available

**2. 1993 Revised Edition — Protected Places (Consolidation) Order**

Date of operation : 5 February 1993

**3. G. N. No. S 12/1997 — Protected Places (Consolidation) (Amendment) Order 1997**

Date of commencement : 1 March 1997

**4. G. N. No. S 532/2002 — Protected Places (Consolidation) (Amendment) Order 2002**

Date of commencement : 1 October 2002

**5. G. N. No. S 343/2005 — Protected Places (Consolidation) (Amendment) Order 2005**

Date of commencement : 3 June 2005

**6. G.N. No. S 942/2020 — Infrastructure Protection (Protected Places) (No. 13) Order 2020**

Date of commencement : 5 November 2020