First published in the *Government Gazette*, Electronic Edition, on 6th July 2015 at 5:00 pm.

No. S 417

PROTECTED AREAS AND PROTECTED PLACES ACT (CHAPTER 256)

PROTECTED AREAS (NO. 5) ORDER 2015

ARRANGEMENT OF PARAGRAPHS

Paragraph

1. Citation and commencement
 2. Areas declared to be protected areas
The Schedule
-

In exercise of the powers conferred by section 4(1) of the Protected Areas and Protected Places Act, the Minister for Home Affairs makes the following Order:

Citation and commencement

1. This Order may be cited as the Protected Areas (No. 5) Order 2015 and comes into operation on 6 July 2015.

Areas declared to be protected areas

2.—(1) The areas described in the second column of the Schedule are declared to be protected areas for the purposes of the Act.

(2) Every person who is in any of those areas must comply with such directions for regulating the person's movement and conduct as may be given by an authorised officer acting by or on behalf of the authority specified in the first column of the Schedule.

THE SCHEDULE

<i>First column</i>	<i>Second column</i>
The Authority	Protected Area
Chief Executive Officer,	(1) Changi Airport Passenger Terminal Building 3 (Basement 3)

THE SCHEDULE — *continued*

<i>First column</i>	<i>Second column</i>																																						
The Authority	Protected Area																																						
Changi Airport Group (Singapore) Pte. Ltd.	<p>All that area comprised in part of Land Lot 4594L in Mukim No. 31 (Changi) occupied by “Changi Airport Passenger Terminal Building 3 (Basement 3)” containing an area of about 74087.179 square metres and bounded approximately as follows:</p> <p>Commencing at Point A of the aforesaid “Changi Airport Passenger Terminal Building 3 (Basement 3)”, which point is 37958.561 metres North and 45207.117 metres East of the Singapore Land Authority SVY 21 Datum, the boundaries run along successive lines of coordinates approximately as follows:</p> <table border="0" style="margin-left: auto; margin-right: auto;"> <thead> <tr> <th style="text-align: left;"><i>Northing</i></th> <th style="text-align: left;"><i>Easting</i></th> </tr> </thead> <tbody> <tr><td>37958.561</td><td>45207.117</td></tr> <tr><td>37944.606</td><td>45240.007</td></tr> <tr><td>37928.036</td><td>45232.976</td></tr> <tr><td>37923.232</td><td>45244.299</td></tr> <tr><td>37912.001</td><td>45239.534</td></tr> <tr><td>37894.151</td><td>45281.604</td></tr> <tr><td>37888.811</td><td>45279.338</td></tr> <tr><td>37881.585</td><td>45296.369</td></tr> <tr><td>37744.813</td><td>45238.337</td></tr> <tr><td>37728.688</td><td>45276.342</td></tr> <tr><td>37693.384</td><td>45261.362</td></tr> <tr><td>37711.560</td><td>45218.525</td></tr> <tr><td>37687.096</td><td>45208.145</td></tr> <tr><td>37685.143</td><td>45212.747</td></tr> <tr><td>37672.945</td><td>45207.572</td></tr> <tr><td>37673.336</td><td>45206.651</td></tr> <tr><td>37673.612</td><td>45206.768</td></tr> <tr><td>37676.737</td><td>45199.404</td></tr> </tbody> </table>	<i>Northing</i>	<i>Easting</i>	37958.561	45207.117	37944.606	45240.007	37928.036	45232.976	37923.232	45244.299	37912.001	45239.534	37894.151	45281.604	37888.811	45279.338	37881.585	45296.369	37744.813	45238.337	37728.688	45276.342	37693.384	45261.362	37711.560	45218.525	37687.096	45208.145	37685.143	45212.747	37672.945	45207.572	37673.336	45206.651	37673.612	45206.768	37676.737	45199.404
<i>Northing</i>	<i>Easting</i>																																						
37958.561	45207.117																																						
37944.606	45240.007																																						
37928.036	45232.976																																						
37923.232	45244.299																																						
37912.001	45239.534																																						
37894.151	45281.604																																						
37888.811	45279.338																																						
37881.585	45296.369																																						
37744.813	45238.337																																						
37728.688	45276.342																																						
37693.384	45261.362																																						
37711.560	45218.525																																						
37687.096	45208.145																																						
37685.143	45212.747																																						
37672.945	45207.572																																						
37673.336	45206.651																																						
37673.612	45206.768																																						
37676.737	45199.404																																						

 THE SCHEDULE — *continued*

<i>First column</i>	<i>Second column</i>
The Authority	Protected Area
37676.461	45199.287
37676.851	45198.366
37677.127	45198.483
37679.295	45193.374
37679.019	45193.257
37679.410	45192.336
37679.686	45192.454
37683.826	45182.696
37683.550	45182.578
37684.272	45180.875
37684.549	45180.993
37686.697	45175.929
37658.804	45164.094
37664.038	45151.759
37663.946	45151.720
37664.414	45150.615
37664.507	45150.654
37670.053	45137.582
37657.173	45132.117
37657.056	45132.393
37656.127	45131.999
37656.245	45131.723
37643.357	45126.255
37643.239	45126.531
37642.319	45126.141
37642.436	45125.864
37629.548	45120.396

THE SCHEDULE — *continued*

<i>First column</i>		<i>Second column</i>
The Authority		Protected Area
	37629.431	45120.672
	37628.510	45120.282
	37628.628	45120.005
	37619.146	45115.982
	37613.560	45129.146
	37617.243	45130.709
	37611.501	45144.241
	37607.819	45142.679
	37606.022	45146.913
	37594.791	45142.148
	37596.666	45137.729
	37575.953	45128.941
	37581.187	45116.605
	37581.095	45116.566
	37581.564	45115.462
	37582.668	45115.930
	37582.629	45116.022
	37609.142	45127.272
	37609.181	45127.180
	37609.549	45127.336
	37614.978	45114.540
	37614.702	45114.423
	37614.819	45114.147
	37601.931	45108.678
	37601.814	45108.954
	37600.894	45108.564
	37601.011	45108.288

 THE SCHEDULE — *continued*

<i>First column</i>		<i>Second column</i>
The Authority		Protected Area
	37588.123	45102.819
	37588.006	45103.096
	37587.085	45102.705
	37587.202	45102.429
	37574.314	45096.960
	37574.197	45097.237
	37573.276	45096.846
	37573.394	45096.570
	37560.506	45091.102
	37560.389	45091.378
	37559.468	45090.987
	37559.585	45090.711
	37546.697	45085.243
	37546.580	45085.519
	37545.660	45085.128
	37545.777	45084.852
	37532.889	45079.384
	37532.772	45079.660
	37531.851	45079.269
	37531.968	45078.993
	37519.081	45073.525
	37518.963	45073.801
	37518.687	45073.684
	37513.258	45086.480
	37513.626	45086.636
	37513.587	45086.728
	37526.291	45092.118

THE SCHEDULE — *continued*

<i>First column</i>		<i>Second column</i>
The Authority		Protected Area
	37526.330	45092.026
	37527.435	45092.495
	37527.396	45092.587
	37540.099	45097.977
	37540.138	45097.885
	37541.243	45098.354
	37540.774	45099.458
	37540.682	45099.419
	37535.448	45111.755
	37514.736	45102.967
	37512.861	45107.385
	37501.630	45102.620
	37503.427	45098.385
	37499.744	45096.823
	37505.486	45083.291
	37509.168	45084.853
	37512.801	45076.292
	37475.702	45060.551
	37472.109	45069.020
	37472.201	45069.059
	37471.732	45070.164
	37471.640	45070.125
	37466.406	45082.460
	37424.705	45064.766
	37422.556	45069.830
	37422.833	45069.947
	37422.110	45071.650

 THE SCHEDULE — *continued*

<i>First column</i>	<i>Second column</i>
The Authority	Protected Area
37421.834	45071.533
37420.486	45074.709
37420.762	45074.826
37420.371	45075.746
37420.096	45075.629
37417.692	45081.294
37417.830	45081.352
37417.558	45081.993
37417.420	45081.935
37414.237	45089.438
37414.513	45089.555
37414.122	45090.475
37413.846	45090.358
37413.042	45092.252
37413.549	45092.467
37411.638	45096.971
37363.538	45076.562
37363.441	45076.792
37362.980	45076.597
37363.078	45076.367
37272.388	45037.887
37272.290	45038.117
37271.830	45037.922
37271.927	45037.692
37239.032	45023.735
37239.012	45023.781
37227.736	45018.996

THE SCHEDULE — *continued*

<i>First column</i>	<i>Second column</i>
The Authority	Protected Area
37229.666	45014.445
37228.516	45013.957
37229.101	45012.576
37230.252	45013.065
37230.665	45012.092
37231.125	45012.287
37237.101	44998.202
37236.917	44998.124
37237.464	44996.835
37237.648	44996.913
37276.786	44904.673
37313.148	44920.101
37313.109	44920.194
37331.060	44927.811
37330.943	44928.086
37341.069	44932.383
37341.186	44932.107
37342.107	44932.497
37341.989	44932.773
37352.116	44937.070
37352.233	44936.794
37353.154	44937.184
37353.036	44937.461
37363.162	44941.757
37363.280	44941.481
37364.200	44941.872
37364.083	44942.148

 THE SCHEDULE — *continued*

<i>First column</i>	<i>Second column</i>
The Authority	Protected Area
37374.209	44946.444
37374.327	44946.168
37375.247	44946.559
37375.130	44946.835
37385.256	44951.131
37385.373	44950.855
37386.294	44951.246
37386.176	44951.522
37396.303	44955.818
37396.420	44955.542
37397.341	44955.933
37397.223	44956.209
37407.350	44960.506
37407.467	44960.229
37408.387	44960.620
37408.270	44960.896
37425.761	44968.317
37425.878	44968.041
37426.799	44968.432
37426.682	44968.708
37436.808	44973.005
37436.925	44972.728
37437.846	44973.119
37437.728	44973.395
37447.854	44977.692
37465.119	44937.003
37464.824	44936.878

THE SCHEDULE — *continued*

<i>First column</i>		<i>Second column</i>
The Authority		Protected Area
	37471.112	44922.057
	37483.377	44927.260
	37477.518	44941.069
	37490.311	44946.497
	37490.351	44946.405
	37491.455	44946.874
	37491.416	44946.966
	37504.120	44952.356
	37504.159	44952.264
	37505.264	44952.733
	37505.225	44952.825
	37517.928	44958.215
	37517.967	44958.123
	37519.072	44958.592
	37518.799	44959.236
	37523.770	44961.345
	37521.426	44966.869
	37516.363	44964.720
	37513.180	44972.223
	37513.410	44972.321
	37512.824	44973.701
	37512.594	44973.604
	37507.223	44986.262
	37520.019	44991.691
	37520.058	44991.599
	37521.163	44992.067
	37521.123	44992.159

 THE SCHEDULE — *continued*

<i>First column</i>		<i>Second column</i>
The Authority		Protected Area
	37533.827	44997.550
	37533.866	44997.458
	37534.971	44997.926
	37534.932	44998.018
	37547.636	45003.408
	37547.675	45003.316
	37548.779	45003.785
	37548.740	45003.877
	37561.444	45009.267
	37561.484	45009.175
	37562.588	45009.644
	37562.549	45009.736
	37575.253	45015.126
	37575.292	45015.034
	37576.397	45015.503
	37576.357	45015.595
	37589.061	45020.985
	37589.100	45020.893
	37590.205	45021.362
	37590.166	45021.454
	37596.288	45024.051
	37608.005	44996.435
	37614.587	44999.227
	37614.627	44999.135
	37615.731	44999.604
	37615.692	44999.696
	37628.396	45005.086

THE SCHEDULE — *continued*

<i>First column</i>		<i>Second column</i>
The Authority		Protected Area
	37628.435	45004.994
	37629.540	45005.463
	37629.501	45005.555
	37639.074	45009.617
	37635.754	45017.442
	37626.089	45013.341
	37623.647	45019.094
	37623.877	45019.192
	37623.292	45020.573
	37623.061	45020.475
	37617.691	45033.133
	37630.487	45038.562
	37630.526	45038.470
	37631.631	45038.939
	37631.591	45039.031
	37644.295	45044.421
	37644.334	45044.329
	37645.439	45044.798
	37645.400	45044.890
	37658.103	45050.280
	37658.143	45050.188
	37659.247	45050.657
	37659.208	45050.749
	37671.912	45056.139
	37671.951	45056.047
	37673.056	45056.515
	37673.017	45056.607

 THE SCHEDULE — *continued*

<i>First column</i>		<i>Second column</i>
The Authority		Protected Area
	37685.720	45061.998
	37685.760	45061.906
	37685.851	45061.945
	37691.183	45049.379
	37690.953	45049.281
	37691.539	45047.900
	37691.769	45047.998
	37697.101	45035.432
	37697.009	45035.393
	37697.477	45034.289
	37698.582	45034.757
	37698.543	45034.849
	37711.247	45040.240
	37711.286	45040.148
	37712.390	45040.616
	37712.351	45040.708
	37725.055	45046.099
	37725.094	45046.006
	37726.199	45046.475
	37726.160	45046.567
	37738.954	45051.996
	37744.813	45038.187
	37762.305	45045.609
	37749.611	45075.528
	37795.546	45095.018
	37795.740	45094.557
	37817.652	45103.854

THE SCHEDULE — *continued*

<i>First column</i>		<i>Second column</i>
The Authority		Protected Area
	37812.965	45114.901
	37793.965	45106.839
	37789.947	45103.732
	37789.131	45104.788
	37774.753	45098.688
	37774.945	45097.367
	37770.004	45096.649
	37750.735	45088.496
	37744.485	45103.226
	37744.393	45103.187
	37744.002	45104.107
	37743.082	45103.717
	37743.277	45103.256
	37733.151	45098.960
	37732.956	45099.420
	37732.035	45099.029
	37732.230	45098.569
	37722.104	45094.273
	37721.909	45094.733
	37720.988	45094.342
	37721.184	45093.882
	37708.296	45088.414
	37708.100	45088.874
	37707.180	45088.483
	37707.375	45088.023
	37694.487	45082.555
	37694.292	45083.015

 THE SCHEDULE — *continued*

<i>First column</i>		<i>Second column</i>
The Authority		Protected Area
	37693.832	45082.820
	37688.363	45095.708
	37688.824	45095.903
	37688.433	45096.824
	37687.973	45096.628
	37682.504	45109.516
	37682.965	45109.711
	37682.574	45110.632
	37681.653	45110.241
	37681.849	45109.781
	37668.961	45104.313
	37668.766	45104.773
	37667.845	45104.382
	37668.040	45103.922
	37661.873	45101.305
	37661.834	45101.397
	37661.281	45101.163
	37661.320	45101.071
	37655.152	45098.454
	37654.957	45098.914
	37654.037	45098.524
	37654.232	45098.063
	37641.344	45092.595
	37641.149	45093.055
	37640.228	45092.665
	37640.423	45092.204
	37627.535	45086.736

THE SCHEDULE — *continued*

<i>First column</i>	<i>Second column</i>
The Authority	Protected Area
37627.340	45087.196
37626.420	45086.806
37626.810	45085.885
37627.270	45086.081
37632.700	45073.285
37632.148	45073.050
37632.616	45071.946
37633.168	45072.180
37635.610	45066.426
37628.706	45063.497
37634.623	45049.551
37503.903	44994.086
37500.974	45000.991
37500.698	45000.873
37498.139	45006.903
37498.277	45006.962
37498.004	45007.606
37497.866	45007.547
37495.268	45013.669
37495.636	45013.825
37495.168	45014.930
37494.800	45014.774
37489.370	45027.570
37489.646	45027.687
37489.256	45028.607
37488.980	45028.490
37483.511	45041.378

THE SCHEDULE — *continued*

<i>First column</i>		<i>Second column</i>
The Authority		Protected Area
	37483.788	45041.495
	37483.670	45041.771
	37496.558	45047.240
	37496.675	45046.964
	37497.596	45047.354
	37497.479	45047.630
	37510.367	45053.099
	37510.484	45052.823
	37511.404	45053.213
	37511.287	45053.489
	37524.178	45058.959
	37524.292	45058.681
	37525.213	45059.072
	37525.099	45059.350
	37537.984	45064.816
	37538.101	45064.540
	37539.021	45064.931
	37538.904	45065.207
	37551.792	45070.675
	37551.909	45070.399
	37552.830	45070.790
	37552.713	45071.066
	37565.601	45076.534
	37565.718	45076.258
	37566.638	45076.649
	37566.521	45076.925
	37579.409	45082.393

THE SCHEDULE — *continued*

<i>First column</i>		<i>Second column</i>
The Authority		Protected Area
	37579.526	45082.117
	37580.447	45082.508
	37580.330	45082.784
	37593.217	45088.252
	37593.335	45087.976
	37594.255	45088.367
	37594.138	45088.643
	37607.026	45094.111
	37607.143	45093.835
	37608.064	45094.225
	37607.946	45094.502
	37620.834	45099.970
	37620.951	45099.694
	37621.872	45100.084
	37621.755	45100.361
	37634.643	45105.829
	37634.760	45105.553
	37635.680	45105.943
	37635.563	45106.219
	37648.451	45111.688
	37648.568	45111.412
	37649.489	45111.802
	37649.372	45112.078
	37662.260	45117.547
	37662.377	45117.270
	37663.297	45117.661
	37663.180	45117.937

 THE SCHEDULE — *continued*

<i>First column</i>		<i>Second column</i>
The Authority		Protected Area
	37676.068	45123.406
	37676.185	45123.129
	37676.461	45123.247
	37679.274	45116.618
	37728.696	45137.623
	37728.903	45137.133
	37732.033	45138.461
	37731.955	45138.645
	37740.792	45142.395
	37740.675	45142.671
	37751.354	45147.202
	37756.861	45134.222
	37756.769	45134.183
	37757.316	45132.894
	37757.408	45132.933
	37760.298	45126.121
	37761.403	45126.590
	37761.044	45127.437
	37766.659	45129.819
	37767.019	45128.972
	37768.123	45129.441
	37767.733	45130.362
	37777.675	45134.580
	37778.065	45133.660
	37779.170	45134.128
	37778.779	45135.049
	37788.721	45139.267

THE SCHEDULE — *continued*

<i>First column</i>		<i>Second column</i>
The Authority		Protected Area
	37789.112	45138.347
	37789.664	45138.581
	37794.645	45126.842
	37796.405	45127.584
	37797.121	45125.885
	37801.075	45127.562
	37795.216	45141.371
	37800.095	45143.441
	37800.212	45143.165
	37801.133	45143.556
	37801.015	45143.832
	37811.141	45148.128
	37811.259	45147.852
	37812.179	45148.243
	37812.062	45148.519
	37822.188	45152.815
	37822.305	45152.539
	37823.226	45152.930
	37823.109	45153.206
	37833.235	45157.502
	37833.352	45157.226
	37834.273	45157.617
	37834.156	45157.893
	37844.282	45162.190
	37844.399	45161.913
	37845.320	45162.304
	37845.202	45162.580

THE SCHEDULE — *continued*

<i>First column</i>		<i>Second column</i>
The Authority		Protected Area
	37855.328	45166.877
	37855.446	45166.601
	37856.366	45166.991
	37856.249	45167.267
	37866.375	45171.564
	37866.497	45171.277
	37867.418	45171.666
	37867.296	45171.954
	37877.422	45176.251
	37877.548	45175.952
	37878.469	45176.342
	37878.342	45176.641
	37899.794	45185.743
	37900.501	45184.071
	37900.225	45183.954
	37900.615	45183.033
	37900.891	45183.150
	37902.487	45179.390
	37902.211	45179.273
	37902.601	45178.353
	37902.877	45178.470
	37905.377	45172.578
	37905.101	45172.461
	37907.386	45167.076
	37919.583	45172.251
	37917.787	45176.486
	37930.214	45181.759

THE SCHEDULE — *continued*

<i>First column</i>	<i>Second column</i>
The Authority	Protected Area
37925.421	45193.056

to the point of commencement (Point A).

The boundaries of “Changi Airport Passenger Terminal Building 3 (Basement 3)” are more particularly delineated in the Survey Plan Ref. No. T3PA_B3_A set out below.

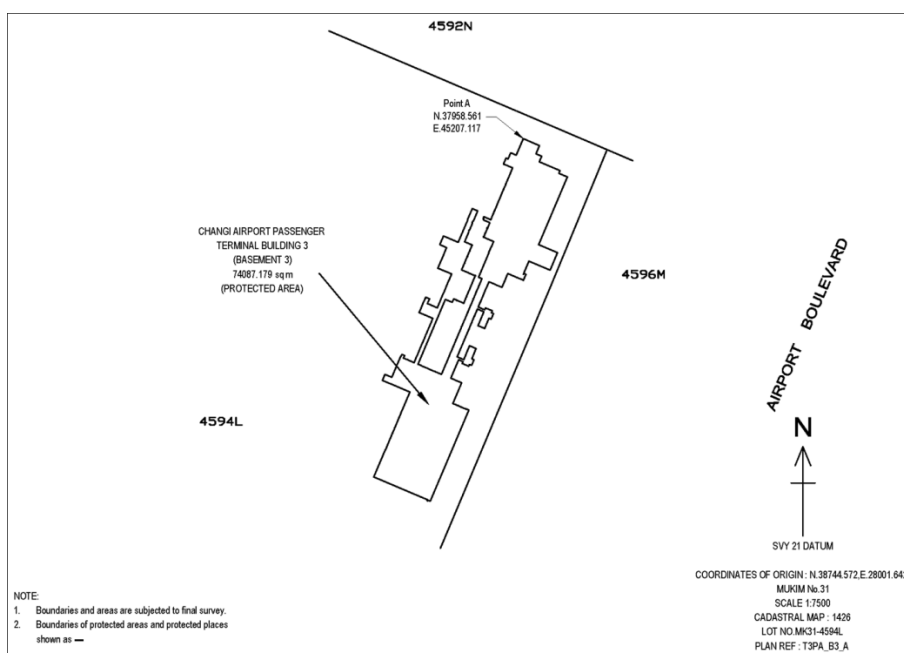

Chief Executive Officer,
Changi Airport Group
(Singapore) Pte.
Ltd.

(2) Changi Airport Passenger Terminal Building 3 (Basement 2)

All that area comprised in part of Land Lot 4594L in Mukim No. 31 (Changi) occupied by “Changi Airport Passenger Terminal Building 3 (Basement 2)” containing an area of about 106740.510 square metres and bounded approximately as follows:

Commencing at Point B of the aforesaid “Changi Airport Passenger Terminal Building 3 (Basement 2)”, which point is 37881.559 metres North and 45296.303 metres East of the Singapore Land Authority SVY 21

 THE SCHEDULE — *continued*

Datum, the boundaries run along successive lines of coordinates approximately as follows:

<i>Northing</i>	<i>Easting</i>
37881.559	45296.303
37818.316	45269.470
37818.394	45269.285
37744.911	45238.106
37727.824	45278.376
37692.520	45263.397
37711.560	45218.525
37686.890	45208.057
37684.937	45212.660
37645.328	45195.854
37654.195	45174.957
37592.057	45148.592
37596.666	45137.729
37514.736	45102.967
37510.127	45113.829
37461.797	45093.323
37452.931	45114.220
37399.998	45091.761
37228.313	45018.915
37237.060	44998.294
37236.693	44998.139
37237.316	44996.661
37237.687	44996.821
37276.551	44905.225
37242.997	44890.988
37250.320	44873.728

THE SCHEDULE — *continued*

37259.434	44877.595
37256.798	44883.808
37293.236	44899.269
37288.744	44909.856
37319.428	44922.875
37317.815	44909.698
37401.372	44945.151
37402.349	44942.850
37401.888	44942.654
37402.279	44941.734
37402.739	44941.929
37408.208	44929.041
37408.668	44929.237
37408.785	44928.960
37418.911	44933.257
37418.794	44933.533
37419.715	44933.924
37419.832	44933.648
37426.460	44936.460
37424.445	44941.207
37431.534	44944.215
37433.548	44939.467
37437.322	44941.069
37437.205	44941.345
37438.126	44941.736
37438.243	44941.459
37448.369	44945.756
37448.252	44946.032
37449.173	44946.423

THE SCHEDULE — *continued*

37449.290	44946.147
37459.416	44950.443
37459.299	44950.719
37460.219	44951.110
37460.610	44950.189
37459.874	44949.877
37465.303	44937.081
37471.310	44939.630
37471.778	44938.525
37473.553	44939.271
37476.031	44933.431
37480.035	44935.130
37477.474	44941.167
37490.272	44946.589
37489.882	44947.510
37490.986	44947.978
37491.377	44947.058
37504.081	44952.448
37503.690	44953.369
37504.795	44953.837
37505.186	44952.917
37517.889	44958.307
37517.499	44959.228
37518.603	44959.696
37518.994	44958.776
37531.698	44964.166
37531.307	44965.086
37532.412	44965.555
37532.802	44964.635

THE SCHEDULE — *continued*

37545.506	44970.025
37545.116	44970.945
37546.220	44971.414
37546.611	44970.494
37559.315	44975.884
37558.924	44976.804
37560.029	44977.273
37560.419	44976.352
37573.123	44981.743
37572.732	44982.663
37573.837	44983.132
37574.228	44982.211
37585.551	44987.016
37580.825	44998.154
37580.963	44998.213
37580.884	44998.397
37581.989	44998.866
37582.067	44998.682
37582.389	44998.818
37586.725	44988.600
37587.646	44988.991
37588.036	44988.070
37600.740	44993.460
37600.349	44994.381
37601.454	44994.850
37601.845	44993.929
37614.548	44999.319
37614.158	45000.240
37615.263	45000.709

THE SCHEDULE — *continued*

37615.653	44999.788
37628.357	45005.178
37627.966	45006.099
37629.071	45006.568
37629.462	45005.647
37642.165	45011.037
37641.775	45011.958
37642.879	45012.426
37643.270	45011.506
37655.974	45016.896
37655.583	45017.817
37656.688	45018.285
37657.078	45017.365
37669.782	45022.755
37669.392	45023.676
37670.496	45024.144
37670.887	45023.224
37683.571	45028.660
37683.200	45029.534
37684.305	45030.003
37684.676	45029.129
37697.380	45034.519
37697.009	45035.393
37698.113	45035.862
37698.504	45034.941
37711.208	45040.332
37710.817	45041.252
37711.922	45041.721
37712.312	45040.800

THE SCHEDULE — *continued*

37725.016	45046.191
37724.625	45047.111
37725.730	45047.580
37726.121	45046.659
37738.924	45052.092
37738.524	45053.008
37742.539	45054.710
37744.275	45050.612
37746.111	45051.391
37744.372	45055.489
37750.493	45058.087
37756.352	45044.278
37760.603	45046.082
37761.336	45047.895
37753.126	45067.243
37754.691	45067.906
37754.418	45068.551
37798.145	45087.104
37804.199	45072.835
37806.960	45074.007
37810.359	45065.998
37807.597	45064.826
37812.675	45052.859
37813.411	45053.172
37813.802	45052.251
37824.848	45056.938
37807.701	45097.351
37807.793	45097.390
37807.754	45097.482

 THE SCHEDULE — *continued*

37818.709	45102.130
37811.276	45119.648
37838.935	45131.384
37828.820	45139.009
37905.722	45171.638
37909.744	45162.158
37909.514	45162.061
37909.904	45161.140
37910.135	45161.238
37912.850	45154.838
37934.207	45163.900
37927.079	45180.700
37929.886	45181.891
37925.004	45193.398
37958.144	45207.460
37944.474	45239.679
37927.903	45232.649
37923.099	45243.972
37911.868	45239.206
37893.979	45281.368
37888.732	45279.142
37883.849	45290.649
37883.941	45290.688

to the point of commencement (Point B).

The boundaries of “Changi Airport Passenger Terminal Building 3 (Basement 2)” are more particularly delineated in the Survey Plan Ref. No. T3PA_B2_B set out below.

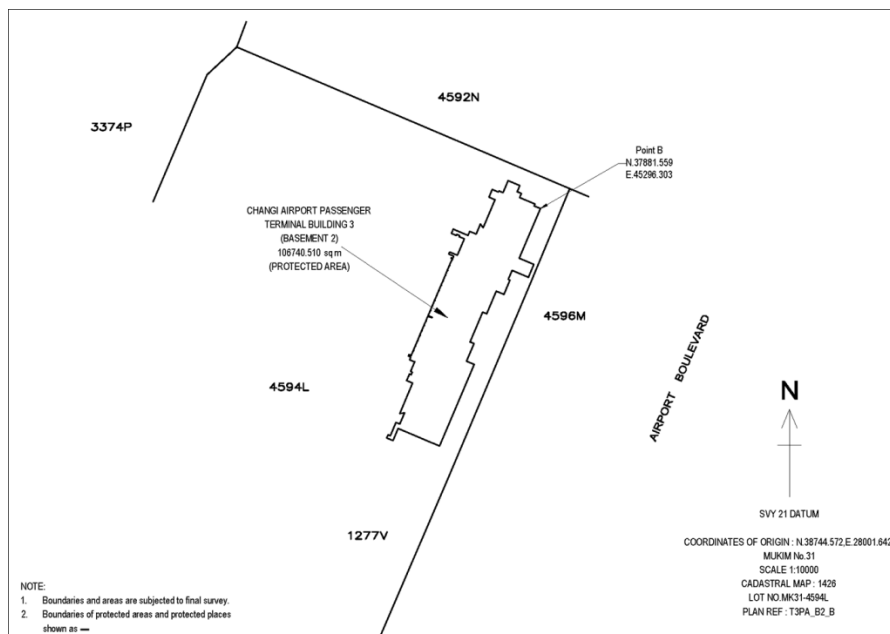
THE SCHEDULE — *continued*

Chief Executive
Officer,
Changi Airport
Group
(Singapore) Pte.
Ltd.

(3) Changi Airport Passenger Terminal
Building 3 (Basement 1)

All that area comprised in part of Land Lot 4594L in Mukim No. 31 (Changi) occupied by “Changi Airport Passenger Terminal Building 3 (Basement 1)” containing an area of about 118297.590 square metres and bounded approximately as follows:

Commencing at Point C of the aforesaid “Changi Airport Passenger Terminal Building 3 (Basement 1)”, which point is 37987.434 metres North and 45180.672 metres East of the Singapore Land Authority SVY 21 Datum, the boundaries run along successive lines of coordinates approximately as follows:

<i>Northing</i>	<i>Easting</i>
37987.434	45180.672
37981.819	45178.289
37981.936	45178.013
37981.199	45177.701
37981.082	45177.977

THE SCHEDULE — *continued*

37970.772	45173.602
37970.889	45173.326
37970.153	45173.014
37970.035	45173.290
37959.725	45168.915
37959.842	45168.639
37959.106	45168.327
37958.989	45168.603
37948.770	45164.267
37951.114	45158.744
37951.022	45158.705
37951.139	45158.429
37950.403	45158.116
37950.285	45158.392
37939.975	45154.018
37940.092	45153.741
37939.356	45153.429
37939.239	45153.705
37928.928	45149.330
37929.046	45149.054
37928.309	45148.742
37928.192	45149.018
37917.882	45144.643
37917.999	45144.367
37917.262	45144.055
37917.145	45144.331
37906.835	45139.956
37906.952	45139.680
37906.216	45139.368

THE SCHEDULE — *continued*

37906.098	45139.644
37895.788	45135.269
37895.905	45134.993
37895.169	45134.680
37895.052	45134.957
37884.741	45130.582
37884.859	45130.306
37884.122	45129.993
37884.005	45130.270
37873.695	45125.895
37873.812	45125.619
37873.075	45125.306
37872.958	45125.582
37862.648	45121.208
37862.765	45120.931
37862.029	45120.619
37861.911	45120.895
37851.601	45116.521
37851.718	45116.244
37850.982	45115.932
37850.865	45116.208
37840.646	45111.873
37840.803	45111.504
37839.882	45111.114
37839.726	45111.482
37829.600	45107.185
37829.756	45106.817
37828.835	45106.427
37828.679	45106.795

THE SCHEDULE — *continued*

37818.553	45102.498
37818.709	45102.130
37817.789	45101.740
37817.632	45102.108
37807.506	45097.811
37824.848	45056.938
37813.802	45052.251
37813.411	45053.172
37812.675	45052.859
37807.597	45064.826
37810.360	45066.001
37806.963	45074.008
37804.199	45072.835
37798.145	45087.104
37758.284	45070.191
37761.448	45062.735
37760.527	45062.344
37760.918	45061.424
37751.165	45057.285
37750.777	45058.209
37738.524	45053.008
37738.922	45052.091
37726.121	45046.659
37725.730	45047.580
37724.625	45047.111
37725.016	45046.191
37712.312	45040.800
37711.922	45041.721
37710.817	45041.252

THE SCHEDULE — *continued*

37711.208	45040.332
37698.504	45034.941
37698.113	45035.862
37697.009	45035.393
37697.399	45034.473
37684.695	45029.083
37684.305	45030.003
37683.200	45029.534
37683.591	45028.614
37670.887	45023.224
37670.496	45024.144
37669.392	45023.676
37669.782	45022.755
37657.078	45017.365
37656.688	45018.285
37655.583	45017.817
37655.974	45016.896
37643.270	45011.506
37642.879	45012.426
37641.775	45011.958
37642.165	45011.037
37629.462	45005.647
37629.071	45006.568
37627.966	45006.099
37628.357	45005.178
37615.653	44999.788
37615.263	45000.709
37614.158	45000.240
37614.548	44999.319

THE SCHEDULE — *continued*

37601.845	44993.929
37601.454	44994.850
37600.349	44994.381
37600.740	44993.460
37588.036	44988.070
37587.646	44988.991
37586.541	44988.522
37586.932	44987.602
37574.228	44982.211
37573.837	44983.132
37572.732	44982.663
37573.123	44981.743
37560.419	44976.352
37560.029	44977.273
37558.924	44976.804
37559.315	44975.884
37546.611	44970.494
37546.220	44971.414
37545.116	44970.945
37545.506	44970.025
37532.802	44964.635
37532.412	44965.555
37531.307	44965.086
37531.698	44964.166
37518.994	44958.776
37518.603	44959.696
37517.499	44959.228
37517.889	44958.307
37505.186	44952.917

THE SCHEDULE — *continued*

37504.795	44953.837
37503.690	44953.369
37504.081	44952.448
37491.377	44947.058
37490.986	44947.978
37489.882	44947.510
37490.272	44946.589
37477.485	44941.163
37477.089	44942.078
37465.302	44937.082
37459.874	44949.877
37460.610	44950.189
37460.220	44951.110
37459.299	44950.719
37459.611	44949.983
37449.485	44945.686
37449.173	44946.423
37448.252	44946.032
37448.565	44945.296
37438.438	44940.999
37438.126	44941.736
37437.205	44941.345
37437.517	44940.608
37420.027	44933.187
37419.715	44933.924
37418.794	44933.533
37419.106	44932.797
37408.980	44928.500
37408.668	44929.237

THE SCHEDULE — *continued*

37407.747	44928.846
37408.138	44927.925
37263.563	44866.583
37258.974	44877.399
37249.860	44873.532
37248.259	44877.307
37257.372	44881.174
37256.142	44884.073
37257.109	44884.484
37256.835	44885.128
37441.961	44963.676
37442.039	44963.492
37452.809	44968.062
37448.708	44977.728
37363.280	44941.481
37276.747	44904.765
37270.888	44918.574
37253.857	44911.348
37220.658	44989.594
37220.290	44989.437
37219.664	44990.912
37220.020	44991.063
37218.385	44992.919
37216.060	44993.764
37213.614	44993.393
37073.689	44934.023
37068.141	44947.141
37229.682	45015.688
37228.313	45018.915

THE SCHEDULE — *continued*

37399.998	45091.761
37709.607	45223.127
37860.424	45287.119
37861.663	45297.421
37877.938	45304.326
37888.679	45279.011
37894.018	45281.276
37911.868	45239.206
37923.099	45243.972
37927.903	45232.649
37944.474	45239.679
37958.144	45207.460
37925.004	45193.398
37929.886	45181.891
37917.689	45176.716
37917.787	45176.485
37916.406	45175.899
37916.308	45176.130
37906.642	45172.029
37906.741	45171.797
37905.360	45171.211
37905.261	45171.443
37895.595	45167.342
37895.693	45167.111
37894.313	45166.525
37894.215	45166.756
37884.549	45162.655
37884.647	45162.424
37883.266	45161.838

 THE SCHEDULE — *continued*

37883.168	45162.069
37873.502	45157.967
37873.600	45157.737
37872.220	45157.152
37872.121	45157.382
37795.024	45124.669
37777.431	45117.233
37781.531	45107.571
37943.642	45176.354
37946.349	45169.975
37956.567	45174.310
37956.450	45174.586
37956.505	45174.610
37957.186	45174.899
37957.303	45174.623
37967.614	45178.997
37967.497	45179.274
37968.233	45179.586
37968.350	45179.310
37973.436	45181.468
37971.190	45186.761
37982.766	45191.673

to the point of commencement (Point C).

The boundaries of “Changi Airport Passenger Terminal Building 3 (Basement 1)” are more particularly delineated in the Survey Plan Ref. No. T3PA_B1_C set out below.

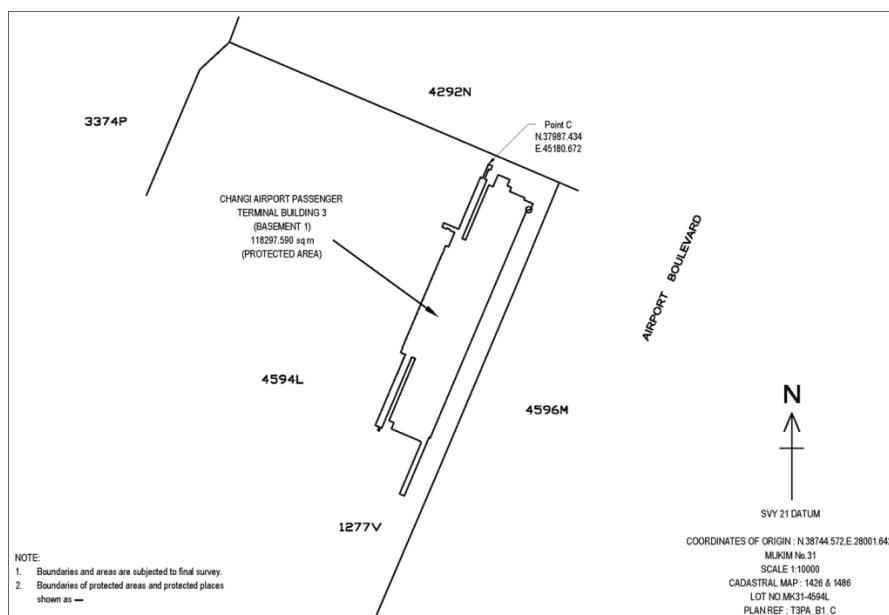
THE SCHEDULE — *continued*

Chief Executive
 Officer,
 Changi Airport
 Group
 (Singapore) Pte.
 Ltd.

(4) Changi Airport Passenger Terminal
 Building 3 (1st Storey)

All that area comprised in part of Land Lots 4594L and 1277V in Mukim No. 31 (Changi) occupied by “Changi Airport Passenger Terminal Building 3 (1st Storey)” containing an area of about 29749.849 square metres and bounded approximately as follows:

Commencing at Point D of the aforesaid “Changi Airport Passenger Terminal Building 3 (1st Storey)”, which point is 38047.984 metres North and 45185.147 metres East of the Singapore Land Authority SVY 21 Datum, the boundaries run along successive lines of coordinates approximately as follows:

<i>Northing</i>	<i>Easting</i>
38047.984	45185.147
38025.452	45175.578
38024.068	45178.838
37998.572	45168.010
37996.497	45172.894
37972.660	45162.769

THE SCHEDULE — *continued*

37974.654	45158.070
37972.168	45157.016
37970.176	45161.707
37963.129	45158.857
37965.252	45153.859
37954.207	45149.168
37945.607	45169.417
37924.253	45160.348
37926.599	45154.826
37903.772	45145.131
37901.426	45150.654
37879.244	45141.233
37877.796	45144.645
37867.013	45140.065
37870.573	45131.683
37859.357	45126.920
37855.732	45135.455
37849.657	45132.875
37849.725	45132.716
37830.046	45124.358
37824.573	45137.244
37817.329	45134.167
37818.316	45131.843
37809.434	45128.071
37808.076	45131.269
37805.678	45130.251
37803.137	45136.234
37808.020	45138.308
37804.678	45146.177

THE SCHEDULE — *continued*

37800.556	45144.427
37797.202	45152.781
37789.102	45149.340
37791.565	45143.542
37787.699	45141.900
37782.774	45153.497
37760.814	45144.063
37760.766	45144.178
37743.300	45136.760
37738.854	45147.230
37727.809	45142.539
37725.121	45148.867
37617.891	45103.326
37619.211	45100.217
37611.285	45092.910
37602.781	45086.285
37592.594	45097.205
37590.617	45096.365
37592.347	45092.292
37564.918	45080.643
37563.188	45084.716
37558.126	45082.566
37561.185	45075.363
37556.590	45073.520
37556.234	45072.566
37556.297	45072.418
37547.150	45068.533
37547.454	45062.783
37536.756	45061.264

THE SCHEDULE — *continued*

37526.020	45060.633
37524.784	45063.543
37418.590	45018.441
37420.212	45014.621
37409.167	45009.930
37415.812	44994.283
37397.193	44986.375
37396.020	44989.136
37362.405	44974.860
37365.337	44967.957
37366.028	44968.250
37374.914	44947.327
37349.019	44936.329
37350.578	44932.660
37349.000	44931.997
37350.109	44929.402
37341.852	44925.917
37344.974	44918.566
37345.052	44918.382
37335.924	44914.554
37292.220	44895.943
37294.409	44890.789
37255.221	44874.341
37254.548	44875.924
37248.842	44873.500
37248.612	44874.042
37238.395	44869.703
37238.625	44869.161
37237.981	44868.888

THE SCHEDULE — *continued*

37240.057	44864.113
37241.741	44864.825
37243.731	44860.140
37242.375	44859.564
37242.727	44858.735
37240.794	44857.914
37234.941	44871.725
37214.957	44863.238
37218.863	44854.043
37196.034	44844.347
37196.887	44842.337
37190.741	44839.739
37189.152	44843.354
37185.046	44841.623
37183.073	44846.220
37172.028	44841.528
37180.862	44820.727
37147.727	44806.654
37141.472	44821.381
37118.644	44811.689
37116.081	44817.726
37094.712	44808.691
37093.460	44811.637
37071.370	44802.255
37075.204	44793.230
37063.422	44788.227
37061.075	44793.754
37050.030	44789.063
37049.781	44789.630

THE SCHEDULE — *continued*

37017.396	44775.855
37019.976	44769.780
36981.318	44753.361
36979.617	44757.368
36975.252	44755.514
36974.608	44757.030
36972.714	44756.226
36971.227	44759.726
36949.689	44750.578
36947.032	44756.835
36941.694	44754.567
36940.345	44757.743
36945.131	44759.776
36941.359	44768.658
36936.573	44766.625
36932.937	44775.185
36938.460	44777.530
36949.796	44750.838
36978.652	44763.093
36977.870	44764.934
36981.183	44766.341
36981.281	44766.111
36983.858	44767.206
36983.905	44767.226
36984.589	44765.615
37015.423	44778.710
37049.110	44793.018
37055.967	44795.930
37055.186	44797.771

THE SCHEDULE — *continued*

37058.499	44799.178
37058.597	44798.948
37061.729	44800.279
37062.413	44798.668
37122.238	44824.076
37121.456	44825.917
37124.770	44827.324
37124.867	44827.094
37127.951	44828.404
37127.997	44828.423
37128.681	44826.813
37159.653	44839.967
37160.904	44837.021
37182.350	44846.130
37181.099	44849.075
37192.053	44853.727
37199.554	44856.913
37198.772	44858.754
37202.086	44860.161
37202.183	44859.931
37204.806	44861.045
37204.816	44861.022
37205.491	44859.434
37247.278	44877.182
37246.186	44879.761
37253.598	44882.903
37254.689	44880.330
37272.479	44887.885
37271.795	44889.496

THE SCHEDULE — *continued*

37274.713	44890.735
37274.615	44890.965
37277.929	44892.373
37278.710	44890.532
37344.790	44918.488
37338.926	44932.294
37346.014	44935.304
37351.812	44937.767
37365.849	44943.729
37355.225	44968.743
37355.205	44971.039
37359.205	44980.947
37360.814	44982.585
37374.237	44988.286
37369.458	44999.538
37374.209	45001.556
37374.884	44999.965
37377.047	45000.884
37377.000	45000.995
37382.683	45003.409
37385.629	45004.659
37387.561	45005.480
37378.628	45026.512
37380.954	45027.499
37377.748	45035.047
37405.476	45046.823
37399.172	45061.665
37419.215	45070.177
37421.240	45071.037

THE SCHEDULE — *continued*

37421.035	45071.521
37425.591	45073.456
37426.428	45071.485
37464.123	45087.494
37487.911	45097.597
37550.040	45123.984
37612.169	45150.370
37639.783	45162.099
37680.742	45179.494
37680.788	45179.514
37680.634	45179.875
37683.948	45181.282
37683.303	45182.800
37684.408	45183.270
37684.662	45182.671
37691.567	45185.604
37695.707	45187.362
37696.120	45187.538
37695.866	45188.137
37699.457	45189.662
37699.319	45189.986
37754.614	45213.468
37755.435	45211.535
37764.386	45215.337
37763.996	45216.257
37769.288	45218.504
37772.728	45210.405
37770.105	45209.291
37782.556	45179.975

THE SCHEDULE — *continued*

37774.364	45176.496
37774.599	45175.942
37763.416	45171.193
37766.719	45163.416
37800.222	45177.646
37801.737	45174.079
37825.346	45184.106
37830.281	45172.486
37805.291	45161.872
37804.979	45162.609
37783.809	45153.618
37784.122	45152.881
37783.293	45152.529
37784.486	45149.722
37793.965	45153.748
37793.555	45154.715
37806.994	45160.422
37808.111	45157.792
37808.167	45157.661
37813.873	45160.085
37816.708	45153.412
37811.001	45150.988
37812.858	45146.616
37826.388	45152.362
37825.215	45155.124
37847.121	45164.427
37847.434	45163.691
37848.355	45164.082
37849.684	45160.953

THE SCHEDULE — *continued*

37854.470	45162.985
37856.587	45163.885
37854.945	45167.750
37855.865	45168.141
37857.924	45163.294
37861.729	45154.335
37867.593	45140.528
37899.900	45154.249
37899.782	45154.526
37913.266	45160.253
37912.563	45161.909
37919.259	45164.753
37920.041	45162.912
37974.599	45186.084
37973.876	45187.787
37977.419	45189.292
37977.361	45189.430
37980.674	45190.837
37981.457	45188.996
37988.958	45192.182
37990.209	45189.237
38002.267	45194.359
38008.805	45197.135
38014.691	45199.635
38014.542	45199.986
38015.463	45200.377
38015.678	45199.871
38015.862	45199.949
38015.914	45199.826

THE SCHEDULE — *continued*

38015.021	45199.447
38023.623	45179.198
38035.036	45184.047
38030.344	45195.091
38041.388	45199.783
38042.170	45197.942
38042.491	45198.079

to the point of commencement (Point D).

The boundaries of “Changi Airport Passenger Terminal Building 3 (1st Storey)” are more particularly delineated in the Survey Plan Ref. No. T3PA_S1_D set out below.

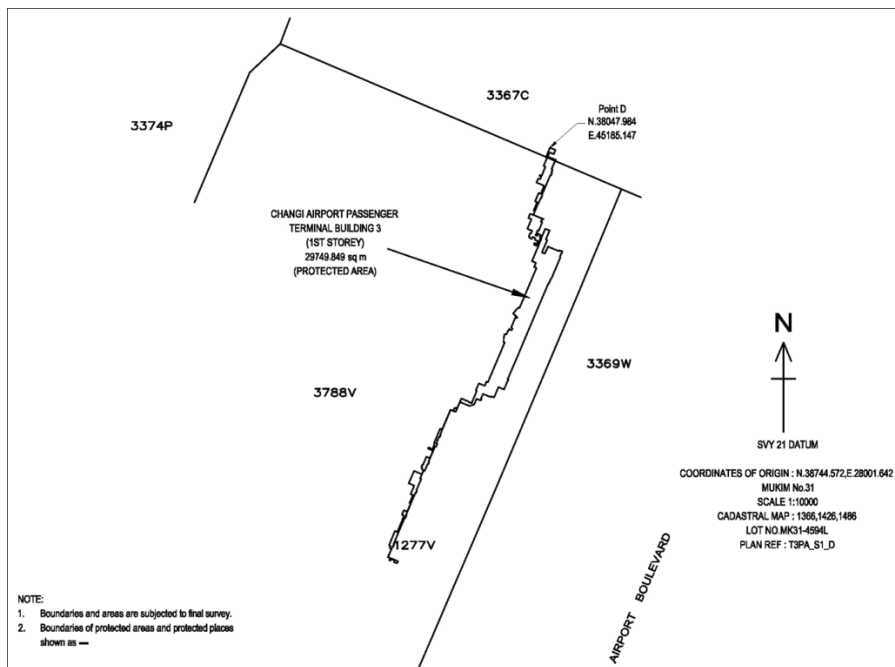

Chief Executive Officer,
Changi Airport Group

(5) Changi Airport Passenger Terminal Building 3 (2nd Storey)

All that area comprised in part of Land Lot 4594L in Mukim No. 31 (Changi) occupied by “Changi Airport Passenger Terminal Building 3 (2nd Storey)”

THE SCHEDULE — *continued*

(Singapore) Pte.
Ltd.

containing an area of about 33980.826 square metres and bounded approximately as follows:

Commencing at Point E of the aforesaid “Changi Airport Passenger Terminal Building 3 (2nd Storey)”, which point is 45135.174 metres North and 37816.630 metres East of the Singapore Land Authority SVY 21 Datum, the boundaries run along successive lines of coordinates approximately as follows:

<i>Northing</i>	<i>Easting</i>
37816.630	45135.174
37807.978	45131.500
37808.565	45130.118
37808.047	45129.897
37801.135	45130.639
37797.731	45131.135
37792.568	45130.691
37784.273	45150.223
37722.512	45123.993
37737.230	45089.339
37736.217	45088.909
37736.432	45088.402
37747.477	45093.093
37750.292	45086.466
37743.159	45083.437
37741.966	45086.244
37740.080	45085.443
37739.708	45086.317
37727.743	45081.235
37726.414	45084.365
37723.100	45082.957
37718.876	45092.905

THE SCHEDULE — *continued*

37718.645	45092.807
37718.774	45092.504
37718.153	45087.730
37713.595	45088.322
37714.149	45092.835
37715.219	45101.515
37713.171	45106.336
37614.685	45064.509
37624.477	45041.452
37621.440	45040.162
37621.674	45039.610
37621.766	45039.649
37621.845	45039.465
37622.535	45039.758
37622.467	45039.919
37645.883	45049.891
37645.823	45050.029
37656.758	45054.673
37658.105	45051.551
37657.737	45051.395
37658.128	45050.474
37660.021	45051.279
37662.992	45044.283
37650.199	45038.850
37651.176	45036.549
37645.048	45033.946
37642.038	45041.034
37622.548	45032.756
37621.122	45036.114

THE SCHEDULE — *continued*

37616.428	45034.120
37615.010	45037.458
37574.097	45020.083
37575.515	45016.744
37570.821	45014.751
37572.247	45011.393
37553.401	45003.389
37555.433	44998.603
37536.197	44990.433
37533.226	44997.428
37534.790	44998.092
37534.400	44999.013
37534.031	44998.857
37532.721	45001.994
37543.648	45006.635
37543.763	45006.365
37543.678	45006.329
37545.283	45002.549
37569.491	45012.830
37567.687	45017.333
37564.649	45016.043
37554.857	45039.100
37456.371	44997.272
37458.419	44992.451
37463.425	44988.738
37463.397	44988.700
37469.058	44984.490
37466.298	44980.770
37462.434	44983.636

THE SCHEDULE — *continued*

37462.306	44983.938
37462.076	44983.840
37466.163	44974.216
37460.365	44971.753
37461.068	44970.096
37453.705	44966.969
37453.001	44968.625
37451.897	44968.156
37436.241	45005.018
37414.072	44995.602
37413.640	44996.618
37396.232	44989.223
37396.623	44988.302
37395.703	44987.912
37395.312	44988.832
37385.187	44984.532
37385.578	44983.612
37384.658	44983.221
37384.267	44984.141
37374.142	44979.841
37374.533	44978.921
37373.612	44978.530
37373.222	44979.450
37363.097	44975.150
37363.488	44974.230
37362.567	44973.839
37367.962	44961.137
37361.151	44958.244
37358.297	44964.963

THE SCHEDULE — *continued*

37364.924	44967.778
37361.914	44974.865
37384.189	44984.325
37376.839	45001.629
37380.521	45003.193
37368.725	45030.967
37378.735	45035.218
37379.028	45034.528
37378.522	45034.313
37379.939	45030.976
37429.067	45051.841
37420.946	45070.963
37440.045	45079.074
37439.429	45080.524
37444.123	45082.518
37444.739	45081.069
37467.658	45090.802
37467.042	45092.251
37471.736	45094.245
37472.352	45092.795
37495.271	45102.529
37494.655	45103.979
37499.349	45105.972
37499.965	45104.523
37536.690	45120.120
37536.074	45121.570
37540.768	45123.563
37541.384	45122.113
37564.303	45131.847

THE SCHEDULE — *continued*

37563.687	45133.297
37568.381	45135.290
37568.997	45133.841
37605.722	45149.439
37605.106	45150.888
37609.801	45152.881
37610.416	45151.432
37633.335	45161.166
37632.719	45162.615
37637.413	45164.609
37638.029	45163.159
37674.754	45178.756
37674.139	45180.206
37678.833	45182.200
37679.449	45180.750
37684.741	45182.998
37687.800	45175.795
37698.753	45180.447
37707.773	45184.278
37711.487	45175.534
37758.429	45195.470
37765.348	45179.179
37731.430	45164.774
37733.795	45159.205
37752.066	45166.965
37755.700	45158.406
37800.066	45177.247
37811.871	45149.450
37810.766	45148.981

THE SCHEDULE — *continued*

to the point of commencement (Point E).

The boundaries of “Changi Airport Passenger Terminal Building 3 (2nd Storey)” are more particularly delineated in the Survey Plan Ref. No. T3PA_S2_E set out below.

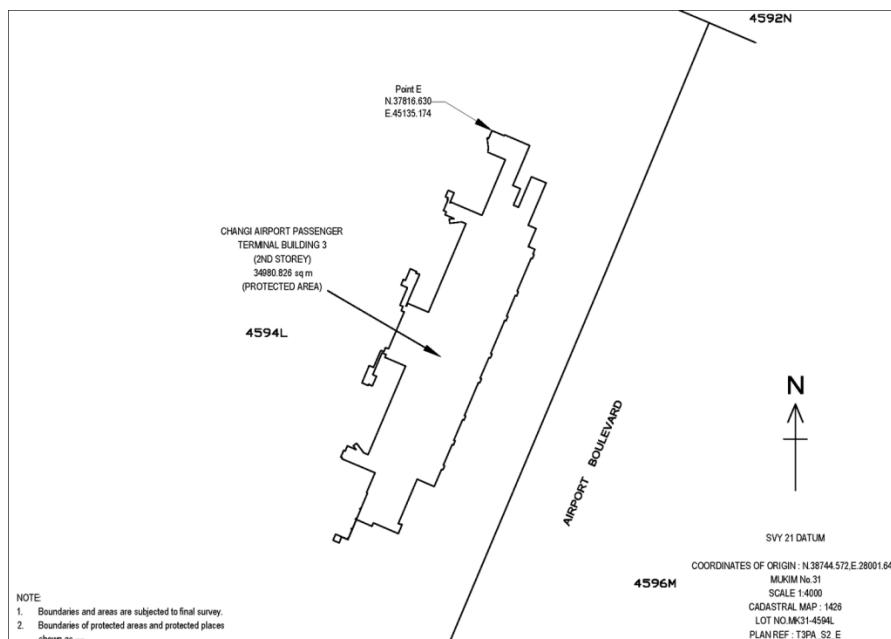

Chief Executive
Officer,
Changi Airport
Group
(Singapore) Pte.
Ltd.

(6) Changi Airport Passenger Terminal
Building 3 (3rd Storey)

All that area comprised in part of Land Lot 4594L in Mukim No. 31 (Changi) occupied by “Changi Airport Passenger Terminal Building 3 (3rd Storey)” containing an area of about 9278.578 square metres and bounded approximately as follows:

Commencing at Point F of the aforesaid “Changi Airport Passenger Terminal Building 3 (3rd Storey)”, which point is 37764.387 metres North and 45087.047 metres East of the Singapore Land Authority SVY 21 Datum, the boundaries run along successive lines of coordinates approximately as follows:

<i>Northing</i>	<i>Easting</i>
37764.387	45087.047

THE SCHEDULE — *continued*

37762.207	45092.178
37762.300	45092.218
37759.505	45098.799
37758.725	45098.468
37758.276	45099.526
37717.431	45082.179
37718.153	45087.729
37713.595	45088.322
37712.586	45080.122
37700.240	45074.878
37700.826	45073.498
37695.671	45071.308
37695.084	45072.689
37645.014	45051.424
37645.600	45050.043
37640.445	45047.853
37639.859	45049.234
37624.258	45042.608
37624.708	45041.550
37621.900	45040.358
37622.037	45040.035
37621.669	45039.879
37620.858	45041.789
37621.571	45042.092
37620.457	45044.715
37616.913	45043.210
37616.890	45043.200
37612.836	45052.746
37609.799	45051.456

THE SCHEDULE — *continued*

37615.231	45038.666
37615.139	45038.627
37615.667	45037.384
37603.451	45032.196
37600.831	45032.804
37598.324	45032.922
37595.835	45032.603
37593.272	45031.788
37590.878	45030.491
37588.924	45028.917
37587.273	45027.027
37585.911	45024.747
37573.695	45019.559
37573.167	45020.801
37573.075	45020.762
37567.643	45033.552
37564.606	45032.262
37568.660	45022.717
37568.637	45022.707
37565.093	45021.202
37566.207	45018.579
37566.921	45018.882
37567.595	45017.294
37564.502	45016.007
37564.062	45017.043
37548.369	45010.378
37548.955	45008.997
37543.800	45006.808
37543.214	45008.189

THE SCHEDULE — *continued*

37493.143	44986.923
37493.730	44985.543
37488.575	44983.353
37487.988	44984.734
37475.705	44979.517
37469.058	44984.490
37466.298	44980.770
37470.797	44977.433
37429.952	44960.086
37430.401	44959.027
37429.622	44958.696
37432.372	44952.221
37435.527	44952.442
37435.695	44952.073
37432.773	44950.832
37434.400	44947.001
37460.446	44950.329
37471.243	44952.535
37487.112	44956.693
37486.839	44958.235
37516.829	44963.435
37516.322	44967.863
37535.431	44972.224
37547.253	44976.998
37546.943	44982.881
37564.698	44986.002
37575.037	44989.389
37584.950	44993.860
37583.263	44999.666

THE SCHEDULE — *continued*

37592.638	45003.648
37594.926	45002.884
37599.025	45002.534
37601.183	45002.546
37605.214	45003.668
37607.746	45005.257
37611.363	45008.379
37613.963	45012.704
37623.342	45016.688
37626.217	45011.397
37635.257	45014.929
37652.567	45024.807
37660.617	45031.150
37664.627	45026.850
37681.094	45034.729
37692.706	45042.774
37695.561	45039.308
37709.878	45048.544
37720.076	45057.269
37721.070	45056.062
37740.652	45068.357
37750.481	45075.539

to the point of commencement (Point F).

The boundaries of “Changi Airport Passenger Terminal Building 3 (3rd Storey)” are more particularly delineated in the Survey Plan Ref. No. T3PA_S3_F set out below.

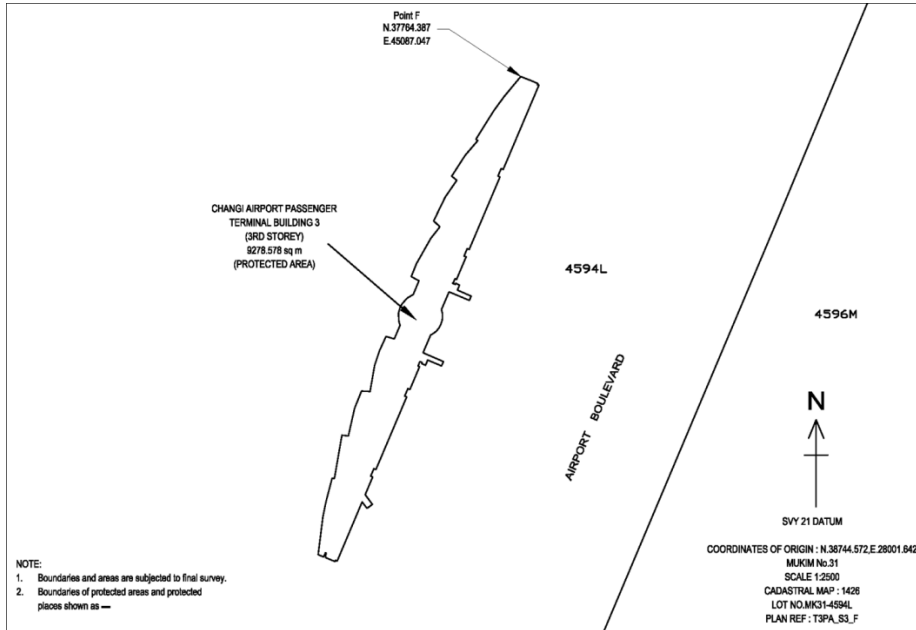
THE SCHEDULE — *continued*

Chief Executive
Officer,
Changi Airport
Group
(Singapore) Pte.
Ltd.

(7) Changi Airport Passenger Terminal
Building 3 (4th Storey)

All that area comprised in part of Land Lot 4594L in Mukim No. 31 (Changi) occupied by “Changi Airport Passenger Terminal Building 3 (4th Storey)” containing an area of about 2900.018 square metres and bounded approximately as follows:

Commencing at Point G of the aforesaid “Changi Airport Passenger Terminal Building 3 (4th Storey)”, which point is 37684.591 metres North and 44991.364 metres East of the Singapore Land Authority SVY 21 Datum, the boundaries run along successive lines of coordinates approximately as follows:

<i>Northing</i>	<i>Easting</i>
37684.591	44991.364
37676.265	45010.969
37652.333	45000.806
37633.687	45044.711
37622.354	45039.925

THE SCHEDULE — *continued*

37621.456	45042.043
37621.571	45042.092
37620.457	45044.715
37616.913	45043.210
37618.027	45040.587
37618.258	45040.685
37621.707	45032.562
37631.166	45036.578
37636.254	45024.596
37626.224	45024.945
37626.082	45020.847
37638.023	45020.432
37651.493	44988.715
37583.841	44959.984
37570.371	44991.701
37578.363	45000.581
37575.316	45003.324
37568.603	44995.864
37563.514	45007.846
37572.971	45011.863
37569.521	45019.986
37569.751	45020.084
37568.637	45022.707
37565.093	45021.202
37566.207	45018.579
37566.921	45018.882
37567.829	45016.742
37555.864	45011.661
37574.557	44967.774

