

---



---

First published in the *Government Gazette*, Electronic Edition, on 14th September 2007 at 5:00 pm.

## No. S 485

# PROTECTED AREAS AND PROTECTED PLACES ACT (CHAPTER 256)

## PROTECTED PLACES (NO. 5) ORDER 2007

### ARRANGEMENT OF PARAGRAPHS

#### Paragraph

1. Citation and commencement
  2. Premises declared to be protected place
- The Schedule
- 

In exercise of the powers conferred by section 5(1) of the Protected Areas and Protected Places Act, the Minister for Home Affairs hereby makes the following Order:

#### **Citation and commencement**

1. This Order may be cited as the Protected Places (No. 5) Order 2007 and shall come into operation on 14th September 2007.

#### **Premises declared to be protected place**

2. The premises described in the second column of the Schedule are hereby declared to be a protected place for the purposes of the Act, and no person shall be in those premises unless he is in possession of a pass-card or permit issued by the authority specified in the first column of the Schedule or has received the permission of an authorised officer on duty at the premises to enter the premises.

### THE SCHEDULE

<i>First column</i>	<i>Second column</i>
The Authority	Protected Place
(1) Commander, Ang Mo Kio Police	ANG MO KIO POLICE DIVISIONAL HEADQUARTERS.

---



---

 THE SCHEDULE — *continued*

Divisional Headquarters,  
Singapore Police Force

All that area comprised in part of State Land Lot 9442C in MK 18 occupied by “ANG MO KIO POLICE DIVISIONAL HEADQUARTERS” containing an area of about 8,229 square metres and bounded approximately as follows:

Commencing at the south-westernmost corner of the aforesaid “ANG MO KIO POLICE DIVISIONAL HEADQUARTERS” which point is 40,702.222 metres North and 29,300.674 metres East of the Singapore Land Authority SVY 21 Datum, the boundaries run along successive lines of co-ordinates approximately as follows:

<i>Northing</i>	<i>Easting</i>
40,717.986	29,294.309
40,733.286	29,288.130
40,816.998	29,254.324
40,835.171	29,325.857
40,779.680	29,339.950
40,743.805	29,349.058
40,727.813	29,353.120
40,709.396	29,357.796
40,708.828	29,352.274

to the point of commencement.

The boundaries of “ANG MO KIO POLICE DIVISIONAL HEADQUARTERS” are more particularly delineated in the Plan ASC-SPF-0611-4 set out below.

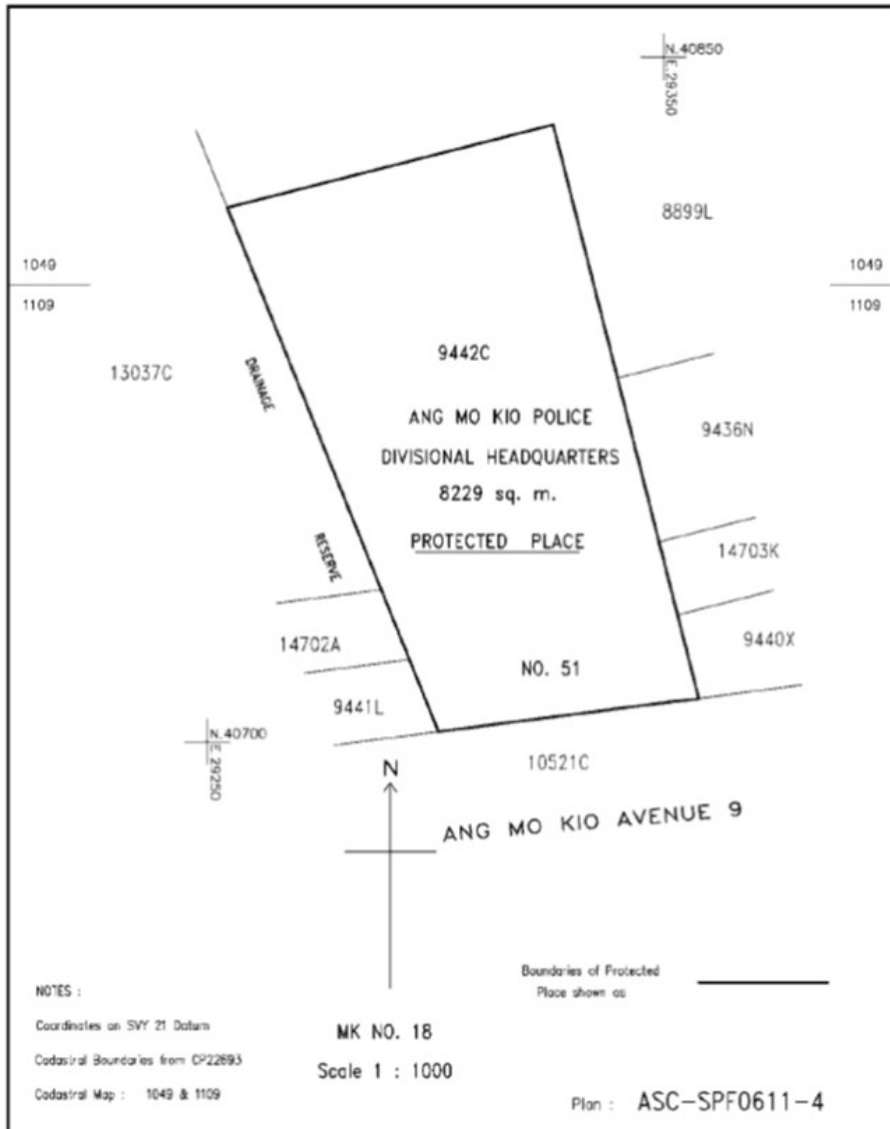
THE SCHEDULE — *continued**First column*

The Authority

- (2) Commander,  
Bedok Police Divisional  
Headquarters,  
Singapore Police Force

*Second column*

Protected Place

BEDOK POLICE DIVISIONAL  
HEADQUARTERS.

THE SCHEDULE — *continued*

All that area comprised in part of State Land Lot 3101A in MK 28 occupied by “BEDOK POLICE DIVISIONAL HEADQUARTERS” containing an area of about 8,678 square metres and bounded approximately as follows:

Commencing at the south-westernmost corner of the aforesaid “BEDOK POLICE DIVISIONAL HEADQUARTERS” which point is 34,929.802 metres North and 39,530.363 metres East of the Singapore Land Authority SVY 21 Datum, the boundaries run along successive lines of co-ordinates approximately as follows:

<i>Northing</i>	<i>Easting</i>
35,035.880	39,509.892
35,052.998	39,597.866
35,040.586	39,606.093
35,036.176	39,601.734
35,030.188	39,597.623
35,023.523	39,594.730
35,016.465	39,592.597
35,009.092	39,592.231
34,940.079	39,592.728
34,935.849	39,591.962
34,931.787	39,590.535
34,927.990	39,588.518
34,924.651	39,585.686
34,927.532	39,567.044
34,928.122	39,558.444
34,928.384	39,554.654
34,929.850	39,533.338

to the point of commencement.

THE SCHEDULE — *continued*

The boundaries of “BEDOK POLICE DIVISIONAL HEADQUARTERS” are more particularly delineated in the Plan ASC-SPF-0611-5 set out below.

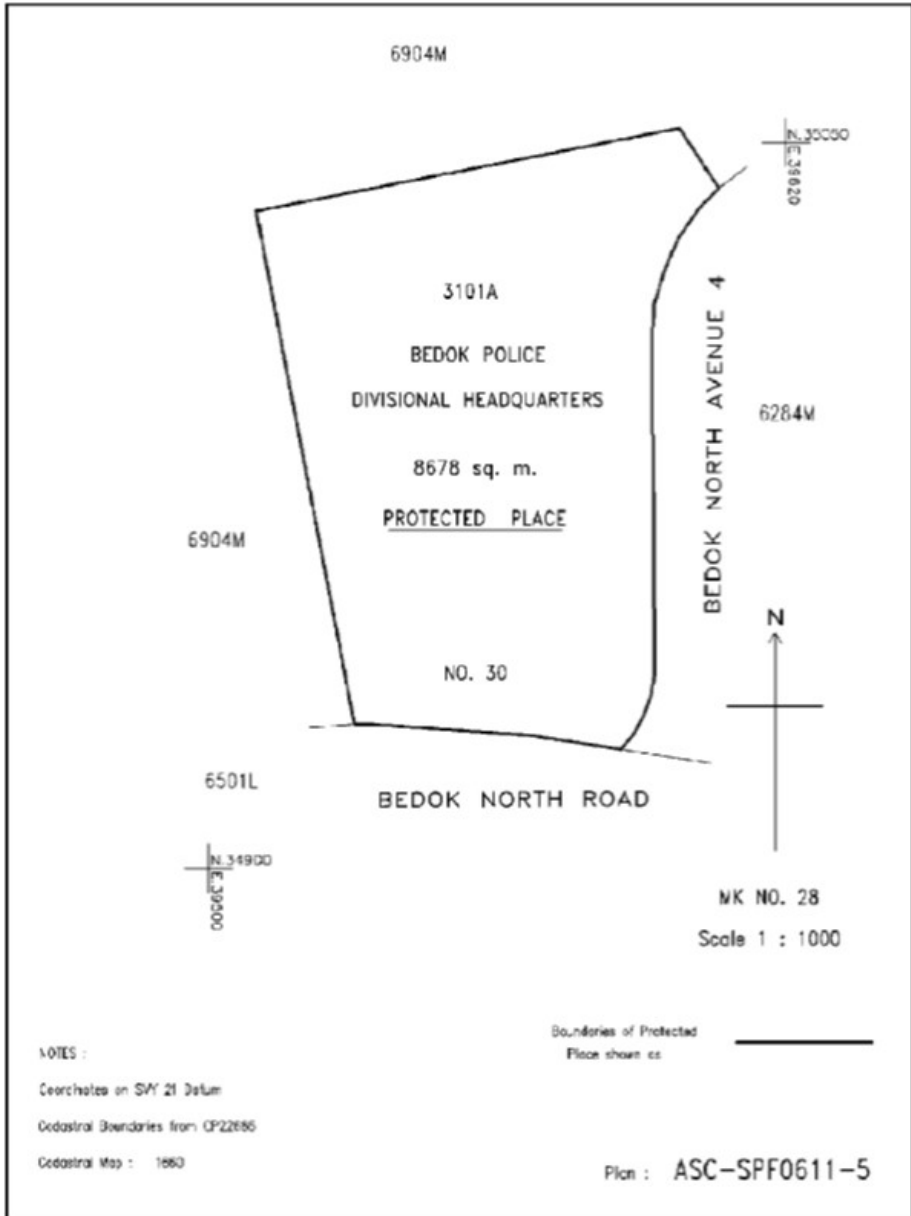

*First column*

*Second column*

THE SCHEDULE — *continued*

The Authority	Protected Place
(3) Commander, Clementi Police Divisional Headquarters, Singapore Police Force	CLEMENTI POLICE DIVISIONAL HEADQUARTERS.

All that area comprised in part of State Land Lot 4431K in MK 5 occupied by “CLEMENTI POLICE DIVISIONAL HEADQUARTERS” containing an area of about 8,648 square metres and bounded approximately as follows:

Commencing at the north-easternmost corner of the aforesaid “CLEMENTI POLICE DIVISIONAL HEADQUARTERS” which point is 33,338.154 metres North and 20,612.473 metres East of the Singapore Land Authority SVY 21 Datum, the boundaries run along successive lines of co-ordinates approximately as follows:

<i>Northing</i>	<i>Easting</i>
33,258.322	20,641.535
33,256.374	20,637.381
33,252.098	20,626.561
33,249.042	20,615.351
33,247.224	20,603.874
33,246.672	20,592.266
33,247.391	20,580.670
33,249.508	20,569.245
33,252.592	20,558.052
33,257.012	20,547.306
33,257.815	20,545.623
33,261.710	20,539.689
33,266.605	20,534.626

---

---

THE SCHEDULE — *continued*

33,272.404	20,530.736
33,278.680	20,527.831
33,285.308	20,526.117
33,292.116	20,525.775
33,311.163	20,525.791
33,338.156	20,525.765

to the point of commencement.

The boundaries of “CLEMENTI POLICE DIVISIONAL HEADQUARTERS” are more particularly delineated in the Plan ASC-SPF-0611-2 set out below.

THE SCHEDULE — *continued*

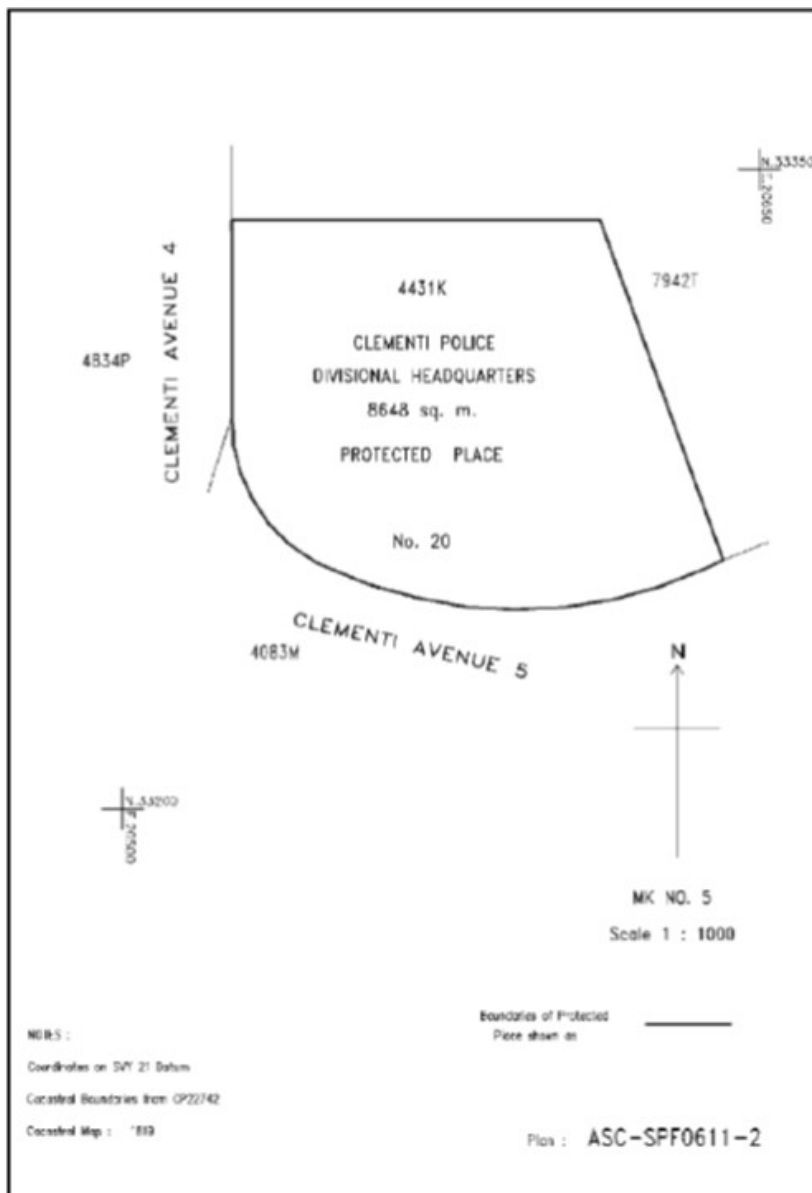

*First column*

*Second column*

The Authority

Protected Place

(4) Commander,  
Jurong Police Divisional  
Headquarters,  
Singapore Police Force

JURONG POLICE DIVISIONAL  
HEADQUARTERS.



---



---

 THE SCHEDULE — *continued*

All that area comprised in part of State Land Lot 1405C(PT) in MK 9 occupied by “JURONG POLICE DIVISIONAL HEADQUARTERS” containing an area of about 11,725 square metres and bounded approximately as follows:

Commencing at the south-westernmost corner of the aforesaid “JURONG POLICE DIVISIONAL HEADQUARTERS” which point is 36,966.924 metres North and 13,343.499 metres East of the Singapore Land Authority SVY 21 Datum, the boundaries run along successive lines of co-ordinates approximately as follows:

<i>Northing</i>	<i>Easting</i>
36,968.238	13,352.157
36,968.560	13,354.095
36,968.955	13,356.212
36,970.990	13,367.445
36,971.095	13,368.036
36,971.271	13,369.009
36,976.789	13,397.349
36,985.182	13,425.784
36,990.928	13,456.006
36,991.745	13,458.721
36,993.048	13,461.811
36,992.881	13,461.888
36,993.370	13,462.841
36,994.893	13,465.321
36,996.710	13,467.603
36,998.799	13,469.642
37,001.122	13,471.411

THE SCHEDULE — *continued*

37,003.634	13,472.886
37,006.310	13,474.039
37,009.110	13,474.856
37,011.982	13,475.326
37,014.895	13,475.434
37,017.797	13,475.191
37,018.851	13,475.011
37,018.831	13,474.863
37,020.015	13,474.526
37,036.575	13,461.367
37,043.207	13,455.770
37,047.092	13,452.477
37,064.187	13,438.194
37,071.063	13,431.833
37,090.314	13,412.402
37,096.025	13,406.581
37,128.060	13,367.984
37,121.028	13,362.873
37,117.451	13,364.801
37,113.903	13,366.178
37,109.206	13,367.452
37,097.169	13,368.236
36,995.309	13,348.924
36,993.859	13,348.626

to the point of commencement.

The boundaries of “JURONG POLICE DIVISIONAL HEADQUARTERS” are more particularly delineated in the Plan ASC-SPF-0611-6 set out below.

THE SCHEDULE — *continued*

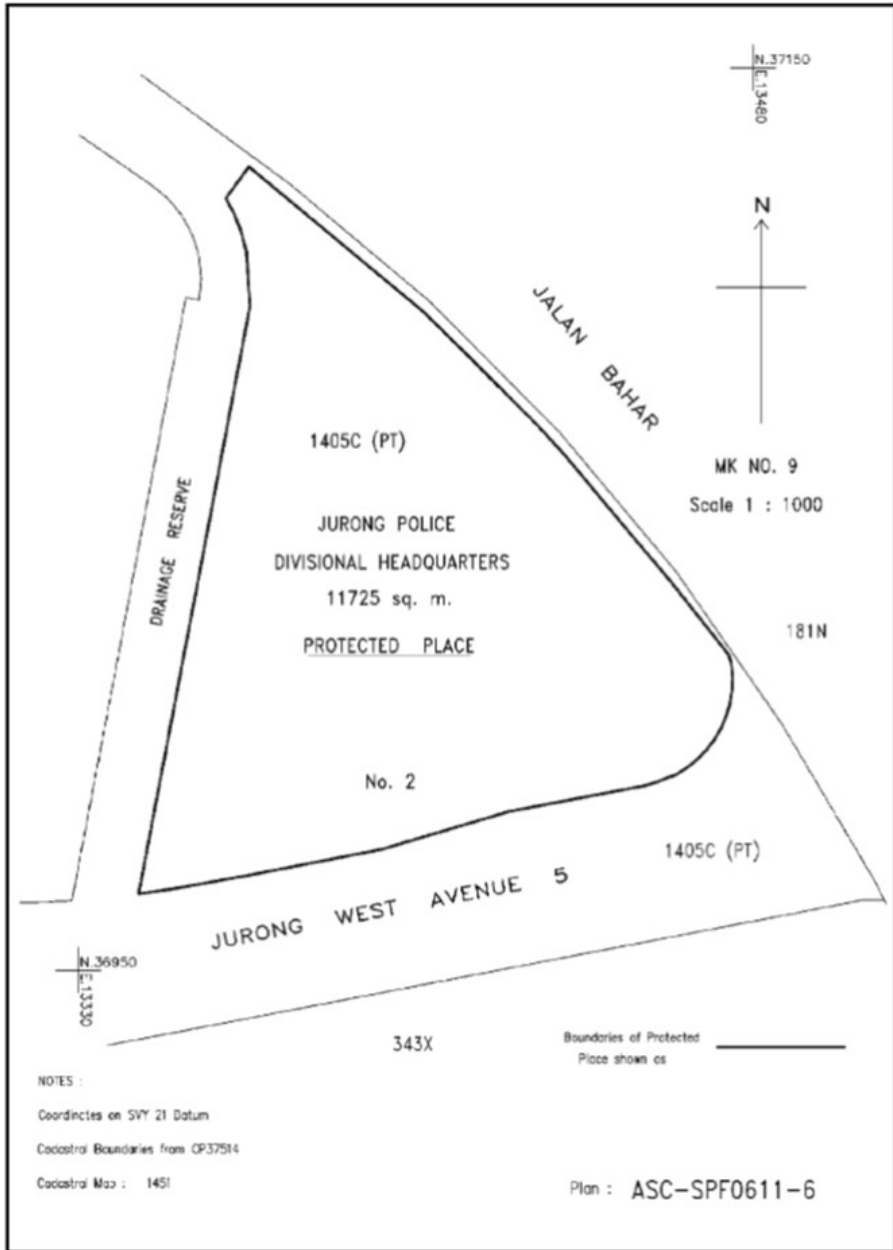

*First column*

The Authority

*Second column*

Protected Place

THE SCHEDULE — *continued*

(5) Commanding Officer,  
Police K-9 Unit,  
Singapore Police Force

POLICE K-9 UNIT.

All that area comprised in part of State Land Lot 3385A(PT) in MK 11 occupied by “POLICE K-9 UNIT” containing an area of about 27,426 square metres and bounded approximately as follows:

Commencing at the south-westernmost corner of the aforesaid “POLICE K-9 UNIT” which point is 42,086.855 metres North and 17,776.449 metres East of the Singapore Land Authority SVY 21 Datum, the boundaries run along successive lines of co-ordinates approximately as follows:

<i>Northing</i>	<i>Easting</i>
42,268.855	17,800.600
42,270.624	17,800.854
42,297.943	17,804.493
42,286.805	17,888.986
42,266.780	17,886.394
42,265.116	17,891.906
42,261.554	17,895.409
42,262.511	17,895.751
42,259.119	17,898.358
42,238.351	17,895.629
42,235.432	17,916.522
42,231.653	17,916.070
42,233.831	17,899.586
42,225.450	17,898.458
42,223.290	17,914.684
42,221.772	17,914.481
42,220.415	17,924.476

THE SCHEDULE — *continued*

42,233.132	17,926.111
42,232.550	17,930.682
42,150.376	17,919.969
42,147.890	17,919.347
42,146.375	17,917.322
42,144.689	17,915.523
42,143.107	17,914.288
42,141.090	17,913.305
42,138.745	17,912.690
42,136.288	17,912.330
42,131.331	17,911.637
42,128.954	17,910.658
42,121.748	17,910.160
42,081.077	17,904.656
42,078.566	17,904.260
42,071.231	17,902.749
42,071.428	17,901.654
42,057.588	17,898.966
42,055.236	17,898.416
42,052.924	17,897.412
42,050.937	17,895.897
42,049.461	17,893.952
42,048.338	17,891.788
42,047.777	17,889.255
42,047.871	17,886.819
42,048.163	17,885.092
42,052.117	17,871.278
42,052.920	17,868.870
42,055.218	17,862.480

---

---

THE SCHEDULE — *continued*

42,055.546	17,862.505
42,056.155	17,861.038
42,058.788	17,861.947
42,060.755	17,856.556
42,064.506	17,846.060
42,066.385	17,840.803
42,063.553	17,839.817

to the point of commencement.

The boundaries of “POLICE K-9 UNIT” are more particularly delineated in the Plan ASC-SPF-0611-9 set out below.

THE SCHEDULE — *continued*

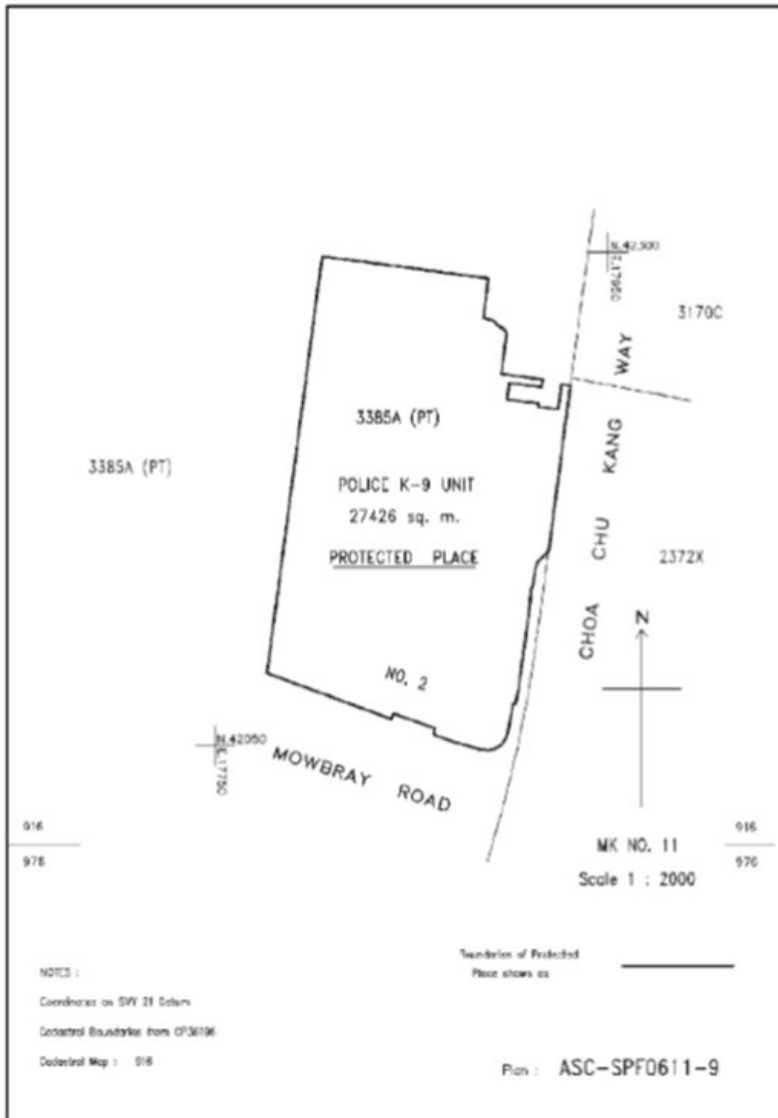

*First column*

*Second column*

The Authority

Protected Place

(6) Commander,  
Training Command,  
Singapore Police Force

OLD POLICE ACADEMY.

All that area comprised in part of State Land Lot 8616C(PT) in MK 17 occupied by “OLD POLICE ACADEMY” containing an area of

---



---

 THE SCHEDULE — *continued*

about 256292 square metres and bounded approximately as follows:

Commencing at the north- easternmost corner of the aforesaid “OLD POLICE ACADEMY” which point is 34,770.467 metres North and 28,604.531 metres East of the Singapore Land Authority SVY 21 Datum, the boundaries run along successive lines of co-ordinates approximately as follows:

<i>Northing</i>	<i>Easting</i>
34,768.002	28,605.807
34,762.418	28,608.298
34,757.054	28,610.895
34,752.001	28,613.615
34,746.907	28,616.515
34,741.950	28,619.580
34,736.883	28,622.978
34,732.166	28,626.391
34,727.231	28,630.122
34,721.188	28,634.726
34,716.611	28,638.604
34,711.815	28,642.516
34,709.487	28,644.246
34,704.472	28,647.526
34,696.284	28,652.128
34,683.753	28,659.266
34,674.022	28,664.699
34,664.068	28,670.234
34,658.996	28,673.052
34,655.469	28,668.112



THE SCHEDULE — *continued*

34,650.868	28,663.861
34,645.767	28,660.618
34,640.290	28,658.071
34,634.595	28,656.048
34,628.645	28,654.581
34,619.738	28,653.018
34,613.635	28,652.143
34,604.639	28,650.993
34,595.527	28,649.715
34,589.537	28,648.747
34,580.386	28,646.921
34,568.200	28,645.214
34,562.163	28,644.209
34,556.253	28,643.095
34,553.205	28,642.403
34,544.597	28,639.657
34,538.986	28,637.201
34,533.588	28,634.396
34,530.722	28,632.855
34,528.133	28,631.251
34,523.184	28,627.992
34,518.433	28,624.340
34,516.258	28,622.318
34,512.013	28,618.148
34,508.013	28,613.621
34,493.896	28,594.356
34,486.876	28,584.400
34,494.287	28,568.405
34,495.370	28,565.644

THE SCHEDULE — *continued*

34,493.379	28,560.880
34,494.179	28,556.770
34,492.893	28,556.412
34,487.944	28,555.069
34,485.845	28,554.485
34,484.811	28,554.222
34,485.222	28,551.130
34,482.702	28,550.003
34,479.728	28,549.280
34,479.659	28,548.728
34,476.881	28,547.767
34,468.418	28,558.044
34,452.965	28,526.794
34,440.951	28,501.466
34,435.970	28,490.357
34,431.332	28,478.957
34,428.723	28,467.160
34,426.945	28,461.166
34,426.302	28,458.535
34,420.887	28,441.874
34,416.518	28,436.773
34,415.839	28,434.175
34,411.432	28,420.161
34,406.988	28,405.814
34,388.256	28,345.743
34,371.599	28,292.174
34,362.731	28,263.676
34,353.613	28,235.770
34,350.003	28,227.518

THE SCHEDULE — *continued*

34,347.469	28,222.157
34,340.060	28,209.148
34,331.997	28,195.255
34,329.373	28,196.076
34,327.578	28,188.077
34,325.228	28,173.217
34,324.094	28,167.268
34,323.254	28,164.418
34,321.996	28,158.569
34,318.711	28,143.921
34,317.746	28,135.000
34,316.485	28,129.151
34,313.792	28,117.512
34,310.727	28,105.832
34,307.513	28,094.441
34,305.942	28,088.585
34,304.775	28,082.499
34,302.755	28,070.518
34,300.734	28,058.341
34,303.731	28,053.214
34,305.860	28,051.014
34,308.317	28,049.442
34,313.719	28,047.079
34,319.375	28,045.846
34,322.323	28,045.869
34,327.901	28,047.428
34,335.542	28,049.633
34,343.181	28,052.024
34,344.538	28,053.630

THE SCHEDULE — *continued*

34,345.076	28,055.780
34,344.138	28,058.517
34,345.197	28,058.889
34,350.265	28,060.245
34,351.327	28,059.161
34,353.082	28,057.432
34,364.939	28,055.868
34,374.144	28,054.264
34,382.745	28,051.963
34,383.809	28,051.544
34,394.233	28,048.292
34,405.454	28,045.119
34,417.090	28,041.886
34,418.068	28,041.594
34,423.685	28,039.993
34,434.576	28,036.713
34,453.859	28,030.497
34,471.151	28,024.803
34,472.126	28,024.561
34,485.927	28,020.060
34,505.384	28,013.685
34,517.160	28,010.007
34,520.185	28,008.920
34,521.133	28,008.569
34,538.888	28,003.026
34,550.509	27,999.013
34,556.101	27,996.912
34,558.552	27,995.943
34,568.786	27,992.505

THE SCHEDULE — *continued*

34,582.099	28,035.050
34,617.836	28,021.732
34,633.907	28,017.282
34,633.583	28,016.336
34,649.329	28,010.940
34,663.209	28,000.203
34,677.520	27,986.905
34,683.040	27,979.584
34,703.419	27,957.298
34,714.298	27,942.345
34,717.521	27,941.586
34,728.882	27,945.723
34,767.748	27,962.444
34,773.376	27,964.844
34,773.878	27,970.393
34,770.698	27,979.532
34,766.717	27,990.491
34,765.808	27,993.628
34,762.634	28,003.044
34,770.767	28,006.175
34,774.627	28,008.604
34,781.733	28,013.890
34,788.771	28,019.172
34,793.506	28,022.659
34,792.056	28,028.895
34,791.763	28,034.346
34,792.218	28,039.670
34,792.841	28,049.516
34,793.687	28,058.368

THE SCHEDULE — *continued*

34,794.016	28,067.503
34,794.419	28,073.023
34,796.076	28,084.981
34,798.137	28,096.570
34,799.524	28,105.439
34,801.819	28,117.131
34,804.354	28,128.723
34,807.362	28,143.350
34,808.652	28,152.219
34,809.406	28,158.200
34,809.954	28,164.401
34,806.765	28,164.702
34,804.541	28,166.987
34,793.845	28,191.771
34,787.461	28,195.920
34,784.865	28,207.276
34,782.861	28,216.384
34,781.671	28,222.364
34,787.355	28,241.878
34,787.775	28,242.808
34,806.040	28,277.464
34,827.926	28,296.904
34,840.727	28,309.149
34,847.268	28,315.284
34,853.345	28,320.815
34,852.888	28,323.757
34,850.990	28,326.054
34,833.609	28,341.424
34,826.647	28,346.253

---



---

 THE SCHEDULE — *continued*

34,820.877	28,350.753
34,810.105	28,358.982
34,805.293	28,365.172
34,801.993	28,371.779
34,799.691	28,377.352
34,796.379	28,385.246
34,794.816	28,394.067
34,794.518	28,396.787
34,793.894	28,399.799
34,791.017	28,402.193
34,790.295	28,409.503
34,792.132	28,416.369
34,791.283	28,425.370
34,788.718	28,452.358
34,787.154	28,452.194
34,786.259	28,461.256
34,783.614	28,488.086
34,779.414	28,532.093
34,777.694	28,549.704
34,772.497	28,594.631

to the point of commencement.

The boundaries of “OLD POLICE ACADEMY” are more particularly delineated in the Plan ASC-SPF-0611-10 set out below.

THE SCHEDULE — *continued*

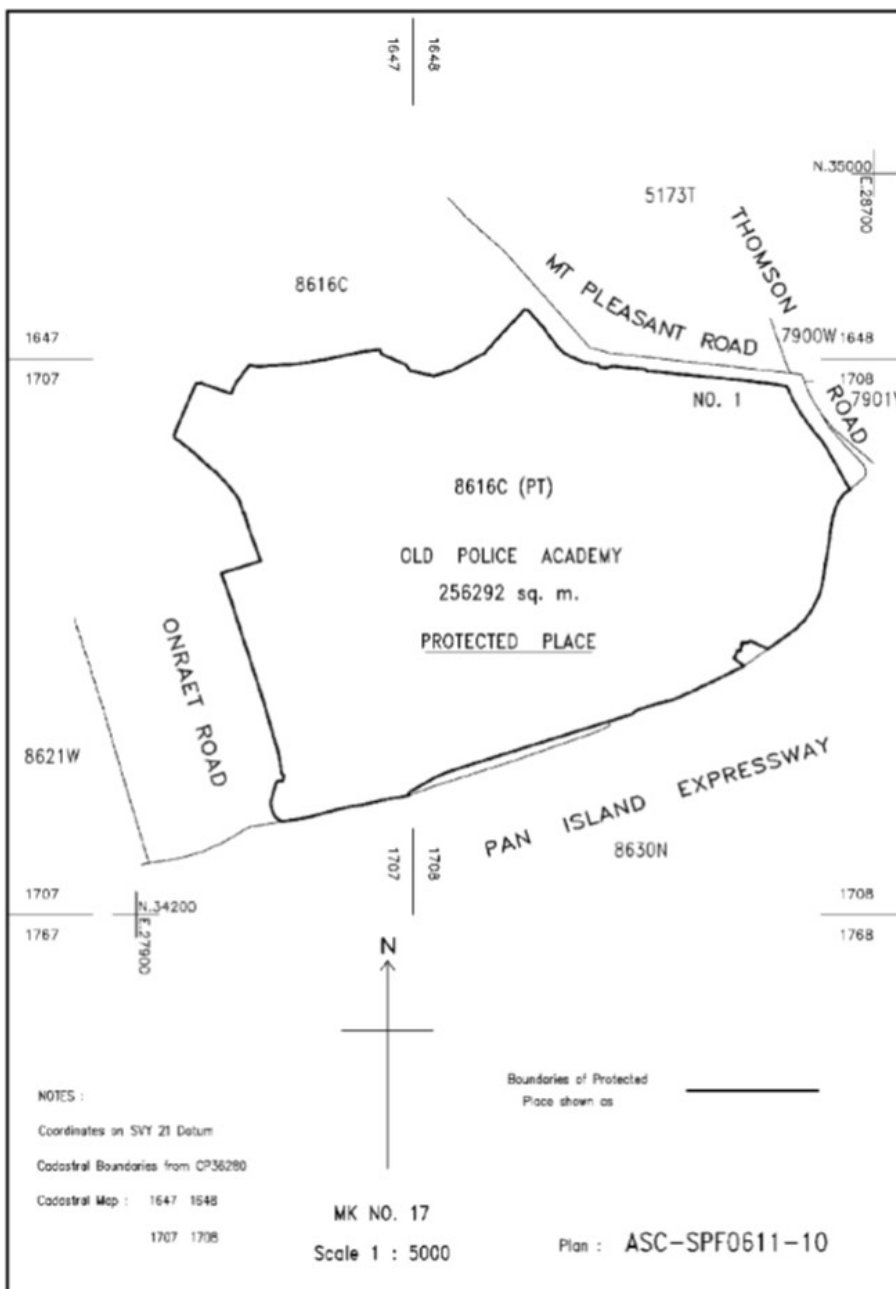

(7) [Deleted by S 251/2020 wef 07/04/2020]

[S 251/2020 wef 07/04/2020]



THE SCHEDULE — *continued*

<i>First column</i>	<i>Second column</i>																														
The Authority	Protected Place																														
(8) Director, Logistics, Singapore Police Force	<p>POLICE LOGISTIC BASE.</p> <p>All that area comprised in part of State Land Lots 99308V, 2062K and 2063N(PT) in MK 25 occupied by “POLICE LOGISTIC BASE” containing an area of about 7,521 square metres and bounded approximately as follows:</p> <p>Commencing at the south-westernmost corner of the aforesaid “POLICE LOGISTIC BASE” which point is 32,629.338 metres North and 34,405.021 metres East of the Singapore Land Authority SVY 21 Datum, the boundaries run along successive lines of co-ordinates approximately as follows:</p> <table border="0" style="margin-left: auto; margin-right: auto;"> <thead> <tr> <th style="text-align: center;"><i>Northing</i></th> <th style="text-align: center;"><i>Easting</i></th> </tr> </thead> <tbody> <tr><td style="text-align: center;">32,701.845</td><td style="text-align: center;">34,443.665</td></tr> <tr><td style="text-align: center;">32,702.174</td><td style="text-align: center;">34,443.137</td></tr> <tr><td style="text-align: center;">32,706.469</td><td style="text-align: center;">34,445.440</td></tr> <tr><td style="text-align: center;">32,706.208</td><td style="text-align: center;">34,445.991</td></tr> <tr><td style="text-align: center;">32,745.390</td><td style="text-align: center;">34,466.873</td></tr> <tr><td style="text-align: center;">32,764.176</td><td style="text-align: center;">34,477.172</td></tr> <tr><td style="text-align: center;">32,763.896</td><td style="text-align: center;">34,477.681</td></tr> <tr><td style="text-align: center;">32,763.621</td><td style="text-align: center;">34,477.530</td></tr> <tr><td style="text-align: center;">32,749.098</td><td style="text-align: center;">34,480.691</td></tr> <tr><td style="text-align: center;">32,728.630</td><td style="text-align: center;">34,481.133</td></tr> <tr><td style="text-align: center;">32,729.357</td><td style="text-align: center;">34,485.924</td></tr> <tr><td style="text-align: center;">32,673.013</td><td style="text-align: center;">34,495.584</td></tr> <tr><td style="text-align: center;">32,618.970</td><td style="text-align: center;">34,498.355</td></tr> <tr><td style="text-align: center;">32,618.194</td><td style="text-align: center;">34,451.061</td></tr> </tbody> </table>	<i>Northing</i>	<i>Easting</i>	32,701.845	34,443.665	32,702.174	34,443.137	32,706.469	34,445.440	32,706.208	34,445.991	32,745.390	34,466.873	32,764.176	34,477.172	32,763.896	34,477.681	32,763.621	34,477.530	32,749.098	34,480.691	32,728.630	34,481.133	32,729.357	34,485.924	32,673.013	34,495.584	32,618.970	34,498.355	32,618.194	34,451.061
<i>Northing</i>	<i>Easting</i>																														
32,701.845	34,443.665																														
32,702.174	34,443.137																														
32,706.469	34,445.440																														
32,706.208	34,445.991																														
32,745.390	34,466.873																														
32,764.176	34,477.172																														
32,763.896	34,477.681																														
32,763.621	34,477.530																														
32,749.098	34,480.691																														
32,728.630	34,481.133																														
32,729.357	34,485.924																														
32,673.013	34,495.584																														
32,618.970	34,498.355																														
32,618.194	34,451.061																														

---

---

THE SCHEDULE — *continued*

32,618.794

34,420.509

to the point of commencement.

The boundaries of “POLICE LOGISTIC BASE” are more particularly delineated in the Plan ASC-SPF-0611-11 set out below.

THE SCHEDULE — *continued*

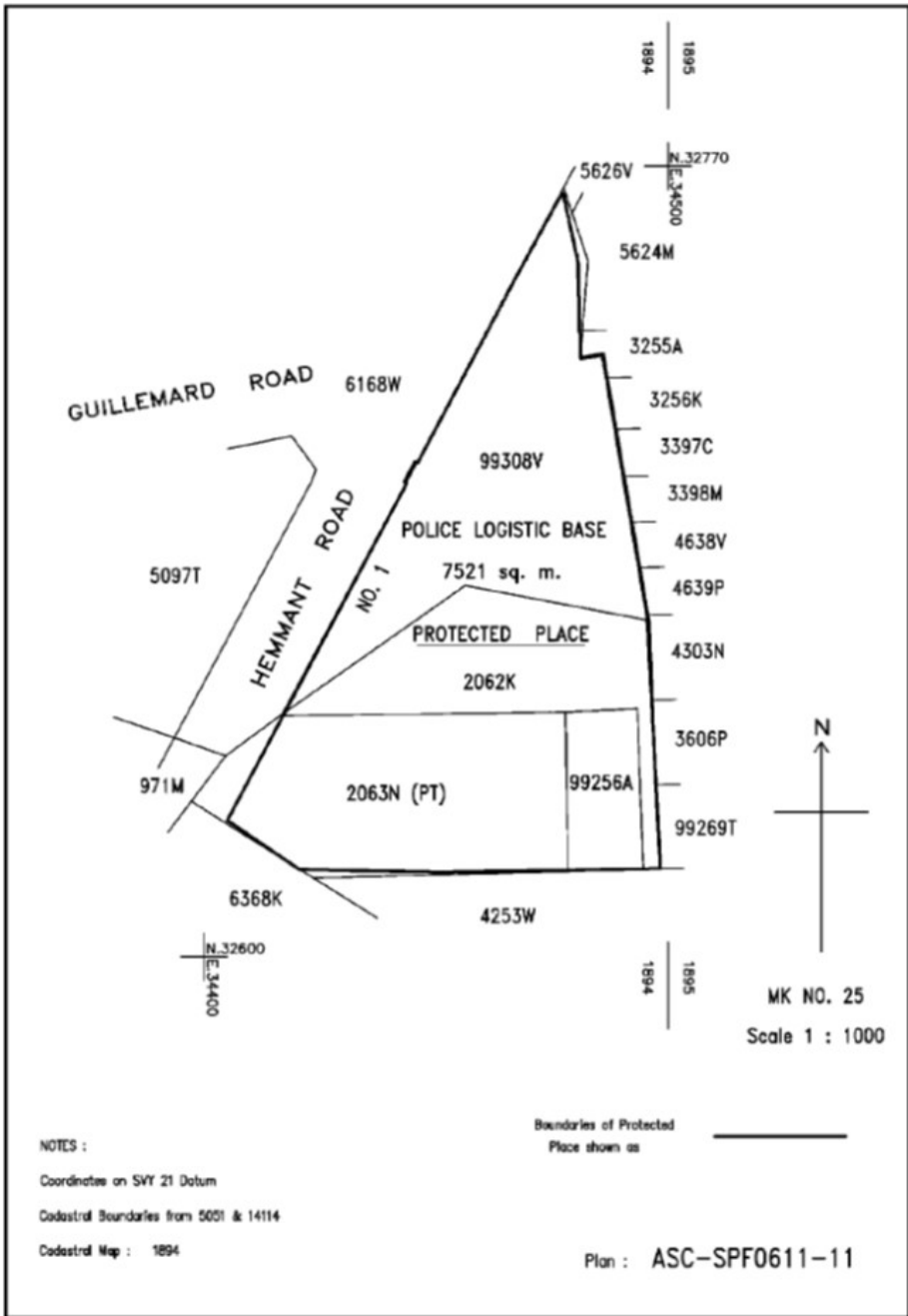

*First column*

The Authority

*Second column*

Protected Place

THE SCHEDULE — *continued*

- (9) Commander,  
Tanglin Police Divisional  
Headquarters,  
Singapore Police Force
- TANGLIN POLICE DIVISIONAL  
HEADQUARTERS.

All that area comprised in part of State Land Lot 2251L(PT) in TS 18 occupied by “TANGLIN POLICE DIVISIONAL HEADQUARTERS” containing an area of about 5,886 square metres and bounded approximately as follows:

Commencing at the north-easternmost corner of the aforesaid “TANGLIN POLICE DIVISIONAL HEADQUARTERS” which point is 32,699.479 metres North and 29,520.660 metres East of the Singapore Land Authority SVY 21 Datum, the boundaries run along successive lines of co-ordinates approximately as follows:

<i>Northing</i>	<i>Easting</i>
32,705.169	29,514.995
32,708.686	29,511.508
32,737.301	29,483.110
32,744.769	29,475.703
32,747.770	29,472.686
32,692.651	29,418.198
32,691.865	29,419.021
32,687.426	29,414.747
32,686.520	29,415.688
32,685.592	29,414.761
32,683.777	29,412.976
32,681.269	29,415.536
32,641.272	29,457.307
32,640.416	29,458.201

---

---

THE SCHEDULE — *continued*

32,639.359	29,459.304
32,638.669	29,460.546

to the point of commencement.

The boundaries of “TANGLIN POLICE DIVISIONAL HEADQUARTERS” are more particularly delineated in the Plan ASC-SPF-0611-3 set out below.

THE SCHEDULE — *continued*

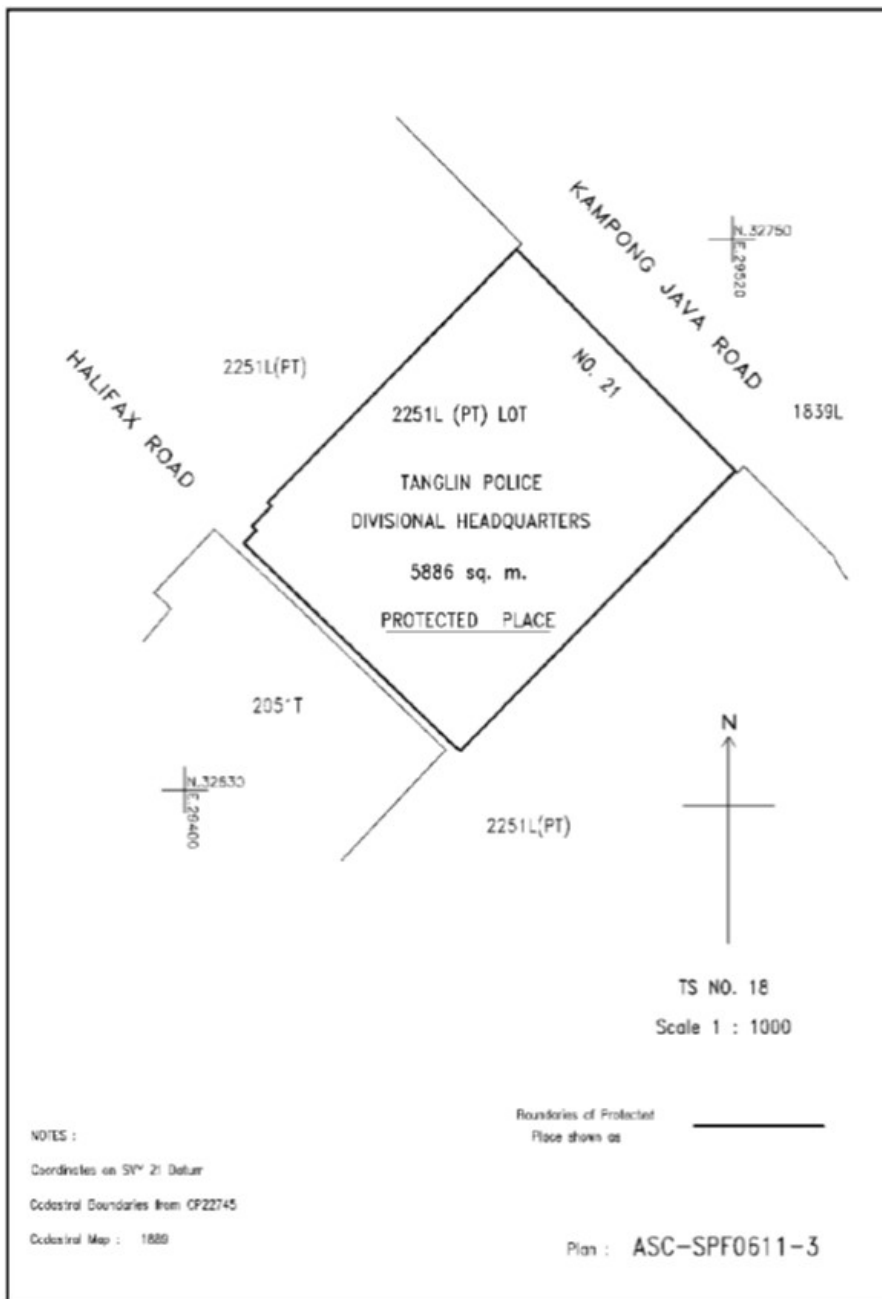

*First column*  
The Authority

*Second column*  
Protected Place

THE SCHEDULE — *continued*

- (10) Commander,  
Traffic Police Divisional  
Headquarters,  
Singapore Police Force
- TRAFFIC POLICE DIVISIONAL  
HEADQUARTERS.

All that area comprised in part of State Land Lots 4595L and 4603N (PT) in MK 23 occupied by “TRAFFIC POLICE DIVISIONAL HEADQUARTERS” containing an area of about 11,942 square metres and bounded approximately as follows:

Commencing at the south-easternmost corner of the aforesaid “TRAFFIC POLICE DIVISIONAL HEADQUARTERS” which point is 34,691.596 metres North and 34,522.323 metres East of the Singapore Land Authority SVY 21 Datum, the boundaries run along successive lines of co-ordinates approximately as follows:

<i>Northing</i>	<i>Easting</i>
34,698.089	34,520.208
34,704.921	34,517.955
34,763.232	34,498.817
34,704.921	34,517.955
34,763.232	34,498.817
34,764.026	34,497.020
34,765.222	34,494.320
34,768.210	34,487.697
34,763.420	34,475.653
34,758.147	34,461.875
34,756.629	34,457.938
34,749.182	34,435.835
34,737.151	34,393.057

THE SCHEDULE — *continued*

34,735.447	34,385.757
34,735.206	34,384.764
34,733.639	34,378.309
34,732.132	34,371.942
34,731.172	34,367.797
34,730.398	34,364.485
34,729.870	34,362.235
34,729.373	34,360.078
34,728.371	34,355.871
34,720.699	34,358.934
34,699.813	34,367.234
34,658.079	34,383.955
34,658.016	34,383.797
34,647.512	34,388.231
34,660.720	34,428.396

to the point of commencement.

The boundaries of “TRAFFIC POLICE DIVISIONAL HEADQUARTERS” are more particularly delineated in the Plan ASC-SPF-0611-7 set out below.



THE SCHEDULE — *continued*

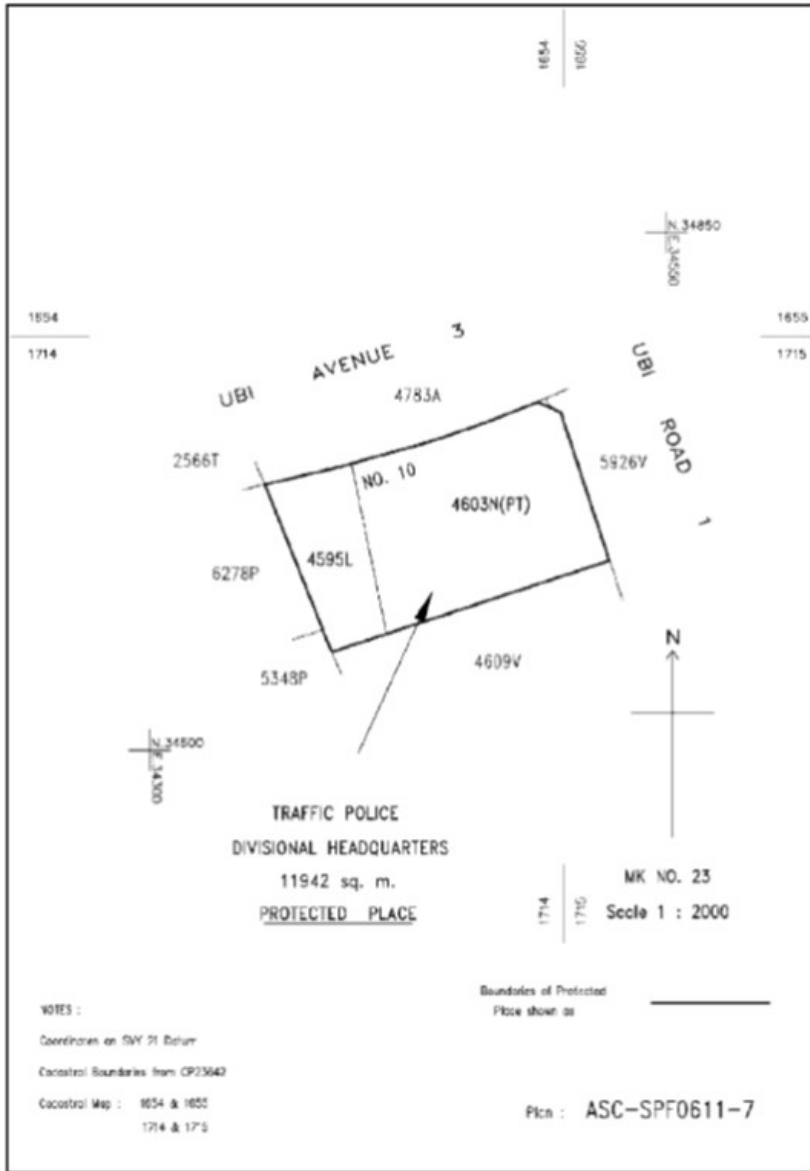

[S 251/2020 wef 07/04/2020]

Made this 5th day of September 2007.

BENNY LIM  
*Permanent Secretary,  
Ministry of Home Affairs,  
Singapore.*

[MHA (PS) 12/2/07 TF 4; AG/LEG/SL/256/2002/1 Vol. 11]