First published in the *Government Gazette*, Electronic Edition, on 14th September 2007 at 5:00 pm.

No. S 485

PROTECTED AREAS AND PROTECTED PLACES ACT (CHAPTER 256)

PROTECTED PLACES (NO. 5) ORDER 2007

ARRANGEMENT OF PARAGRAPHS

Paragraph

1. Citation and commencement
 2. Premises declared to be protected place
- The Schedule
-

In exercise of the powers conferred by section 5(1) of the Protected Areas and Protected Places Act, the Minister for Home Affairs hereby makes the following Order:

Citation and commencement

1. This Order may be cited as the Protected Places (No. 5) Order 2007 and shall come into operation on 14th September 2007.

Premises declared to be protected place

2. The premises described in the second column of the Schedule are hereby declared to be a protected place for the purposes of the Act, and no person shall be in those premises unless he is in possession of a pass-card or permit issued by the authority specified in the first column of the Schedule or has received the permission of an authorised officer on duty at the premises to enter the premises.

THE SCHEDULE

<i>First column</i>	<i>Second column</i>
The Authority	Protected Place
(1) Commander, Ang Mo Kio Police	ANG MO KIO POLICE DIVISIONAL HEADQUARTERS.

 THE SCHEDULE — *continued*

Divisional Headquarters,
Singapore Police Force

All that area comprised in part of State Land Lot 9442C in MK 18 occupied by “ANG MO KIO POLICE DIVISIONAL HEADQUARTERS” containing an area of about 8,229 square metres and bounded approximately as follows:

Commencing at the south-westernmost corner of the aforesaid “ANG MO KIO POLICE DIVISIONAL HEADQUARTERS” which point is 40,702.222 metres North and 29,300.674 metres East of the Singapore Land Authority SVY 21 Datum, the boundaries run along successive lines of co-ordinates approximately as follows:

<i>Northing</i>	<i>Easting</i>
40,717.986	29,294.309
40,733.286	29,288.130
40,816.998	29,254.324
40,835.171	29,325.857
40,779.680	29,339.950
40,743.805	29,349.058
40,727.813	29,353.120
40,709.396	29,357.796
40,708.828	29,352.274

to the point of commencement.

The boundaries of “ANG MO KIO POLICE DIVISIONAL HEADQUARTERS” are more particularly delineated in the Plan ASC-SPF-0611-4 set out below.

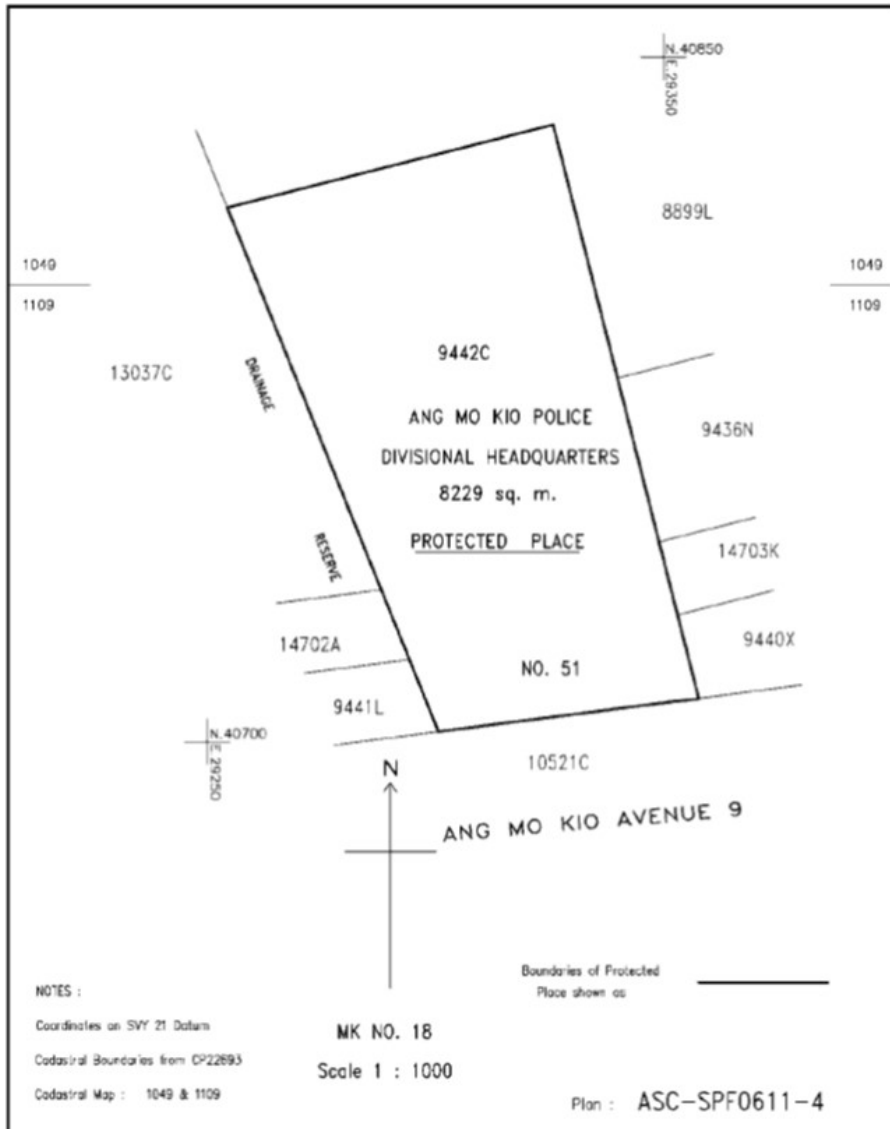
THE SCHEDULE — *continued**First column*

The Authority

- (2) Commander,
Bedok Police Divisional
Headquarters,
Singapore Police Force

Second column

Protected Place

BEDOK POLICE DIVISIONAL
HEADQUARTERS.

THE SCHEDULE — *continued*

All that area comprised in part of State Land Lot 3101A in MK 28 occupied by “BEDOK POLICE DIVISIONAL HEADQUARTERS” containing an area of about 8,678 square metres and bounded approximately as follows:

Commencing at the south-westernmost corner of the aforesaid “BEDOK POLICE DIVISIONAL HEADQUARTERS” which point is 34,929.802 metres North and 39,530.363 metres East of the Singapore Land Authority SVY 21 Datum, the boundaries run along successive lines of co-ordinates approximately as follows:

<i>Northing</i>	<i>Easting</i>
35,035.880	39,509.892
35,052.998	39,597.866
35,040.586	39,606.093
35,036.176	39,601.734
35,030.188	39,597.623
35,023.523	39,594.730
35,016.465	39,592.597
35,009.092	39,592.231
34,940.079	39,592.728
34,935.849	39,591.962
34,931.787	39,590.535
34,927.990	39,588.518
34,924.651	39,585.686
34,927.532	39,567.044
34,928.122	39,558.444
34,928.384	39,554.654
34,929.850	39,533.338

to the point of commencement.

THE SCHEDULE — *continued*

The boundaries of “BEDOK POLICE DIVISIONAL HEADQUARTERS” are more particularly delineated in the Plan ASC-SPF-0611-5 set out below.

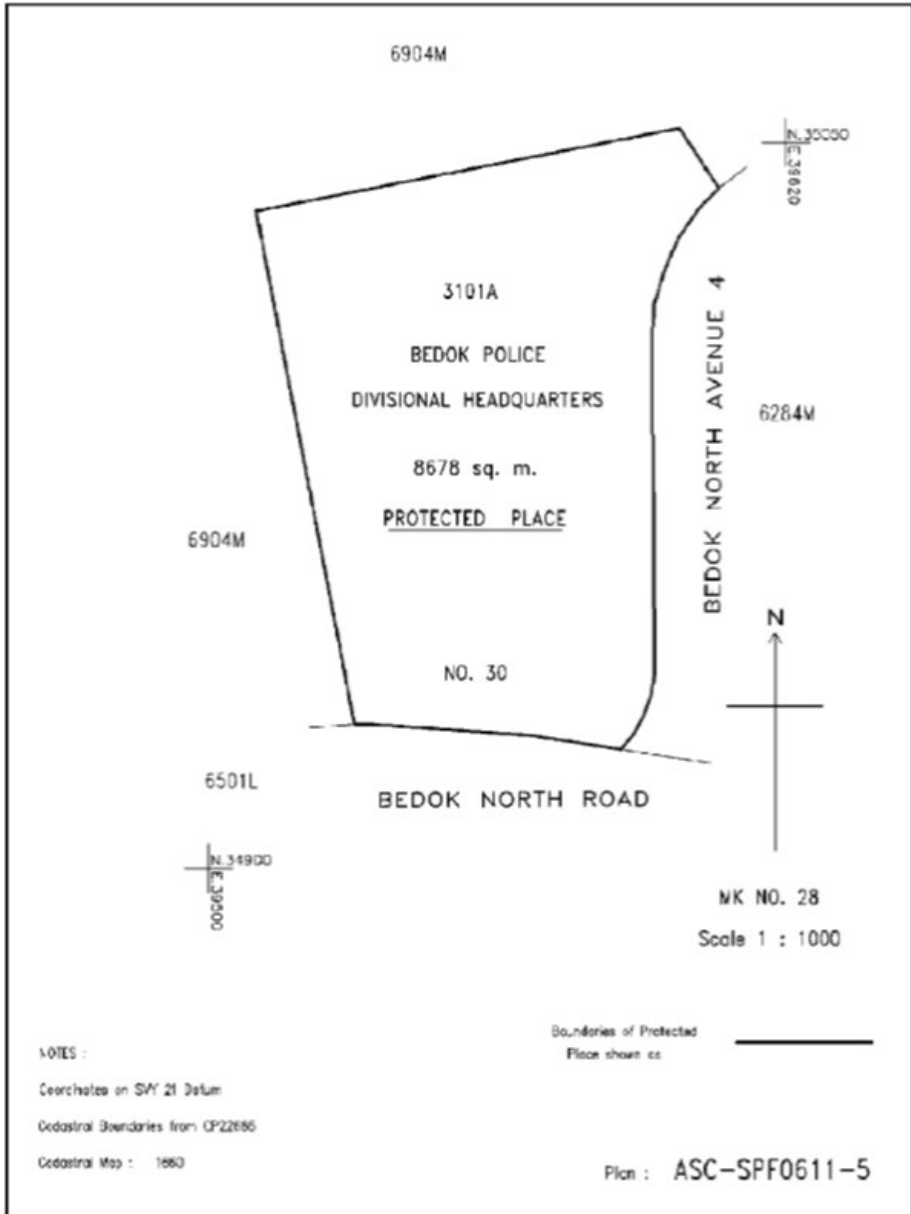

First column

Second column

THE SCHEDULE — *continued*

The Authority	Protected Place
(3) Commander, Clementi Police Divisional Headquarters, Singapore Police Force	CLEMENTI POLICE DIVISIONAL HEADQUARTERS.

All that area comprised in part of State Land Lot 4431K in MK 5 occupied by “CLEMENTI POLICE DIVISIONAL HEADQUARTERS” containing an area of about 8,648 square metres and bounded approximately as follows:

Commencing at the north-easternmost corner of the aforesaid “CLEMENTI POLICE DIVISIONAL HEADQUARTERS” which point is 33,338.154 metres North and 20,612.473 metres East of the Singapore Land Authority SVY 21 Datum, the boundaries run along successive lines of co-ordinates approximately as follows:

<i>Northing</i>	<i>Easting</i>
33,258.322	20,641.535
33,256.374	20,637.381
33,252.098	20,626.561
33,249.042	20,615.351
33,247.224	20,603.874
33,246.672	20,592.266
33,247.391	20,580.670
33,249.508	20,569.245
33,252.592	20,558.052
33,257.012	20,547.306
33,257.815	20,545.623
33,261.710	20,539.689
33,266.605	20,534.626

THE SCHEDULE — *continued*

33,272.404	20,530.736
33,278.680	20,527.831
33,285.308	20,526.117
33,292.116	20,525.775
33,311.163	20,525.791
33,338.156	20,525.765

to the point of commencement.

The boundaries of “CLEMENTI POLICE DIVISIONAL HEADQUARTERS” are more particularly delineated in the Plan ASC-SPF-0611-2 set out below.

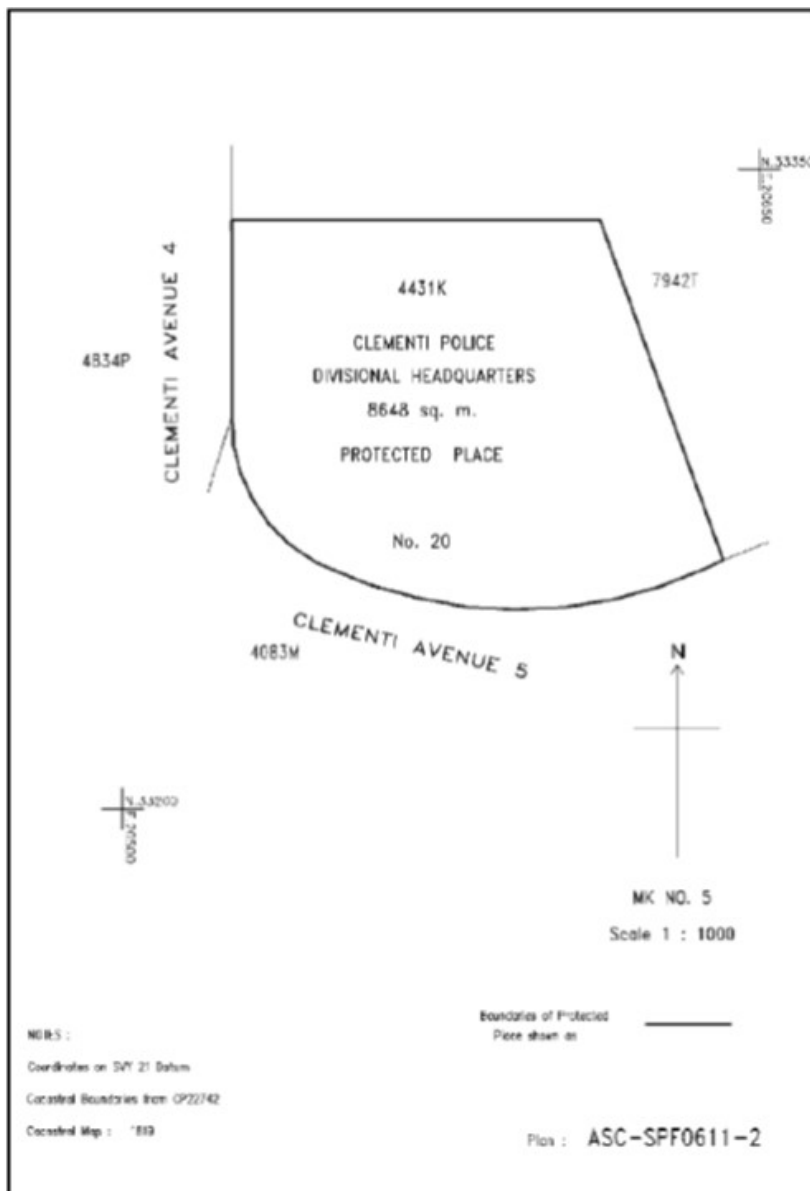
THE SCHEDULE — *continued**First column*

The Authority

- (4) Commander,
Jurong Police Divisional
Headquarters,
Singapore Police Force

Second column

Protected Place

JURONG POLICE DIVISIONAL
HEADQUARTERS.

 THE SCHEDULE — *continued*

All that area comprised in part of State Land Lot 1405C(PT) in MK 9 occupied by “JURONG POLICE DIVISIONAL HEADQUARTERS” containing an area of about 11,725 square metres and bounded approximately as follows:

Commencing at the south-westernmost corner of the aforesaid “JURONG POLICE DIVISIONAL HEADQUARTERS” which point is 36,966.924 metres North and 13,343.499 metres East of the Singapore Land Authority SVY 21 Datum, the boundaries run along successive lines of co-ordinates approximately as follows:

<i>Northing</i>	<i>Easting</i>
36,968.238	13,352.157
36,968.560	13,354.095
36,968.955	13,356.212
36,970.990	13,367.445
36,971.095	13,368.036
36,971.271	13,369.009
36,976.789	13,397.349
36,985.182	13,425.784
36,990.928	13,456.006
36,991.745	13,458.721
36,993.048	13,461.811
36,992.881	13,461.888
36,993.370	13,462.841
36,994.893	13,465.321
36,996.710	13,467.603
36,998.799	13,469.642
37,001.122	13,471.411

THE SCHEDULE — *continued*

37,003.634	13,472.886
37,006.310	13,474.039
37,009.110	13,474.856
37,011.982	13,475.326
37,014.895	13,475.434
37,017.797	13,475.191
37,018.851	13,475.011
37,018.831	13,474.863
37,020.015	13,474.526
37,036.575	13,461.367
37,043.207	13,455.770
37,047.092	13,452.477
37,064.187	13,438.194
37,071.063	13,431.833
37,090.314	13,412.402
37,096.025	13,406.581
37,128.060	13,367.984
37,121.028	13,362.873
37,117.451	13,364.801
37,113.903	13,366.178
37,109.206	13,367.452
37,097.169	13,368.236
36,995.309	13,348.924
36,993.859	13,348.626

to the point of commencement.

The boundaries of “JURONG POLICE DIVISIONAL HEADQUARTERS” are more particularly delineated in the Plan ASC-SPF-0611-6 set out below.

THE SCHEDULE — *continued*

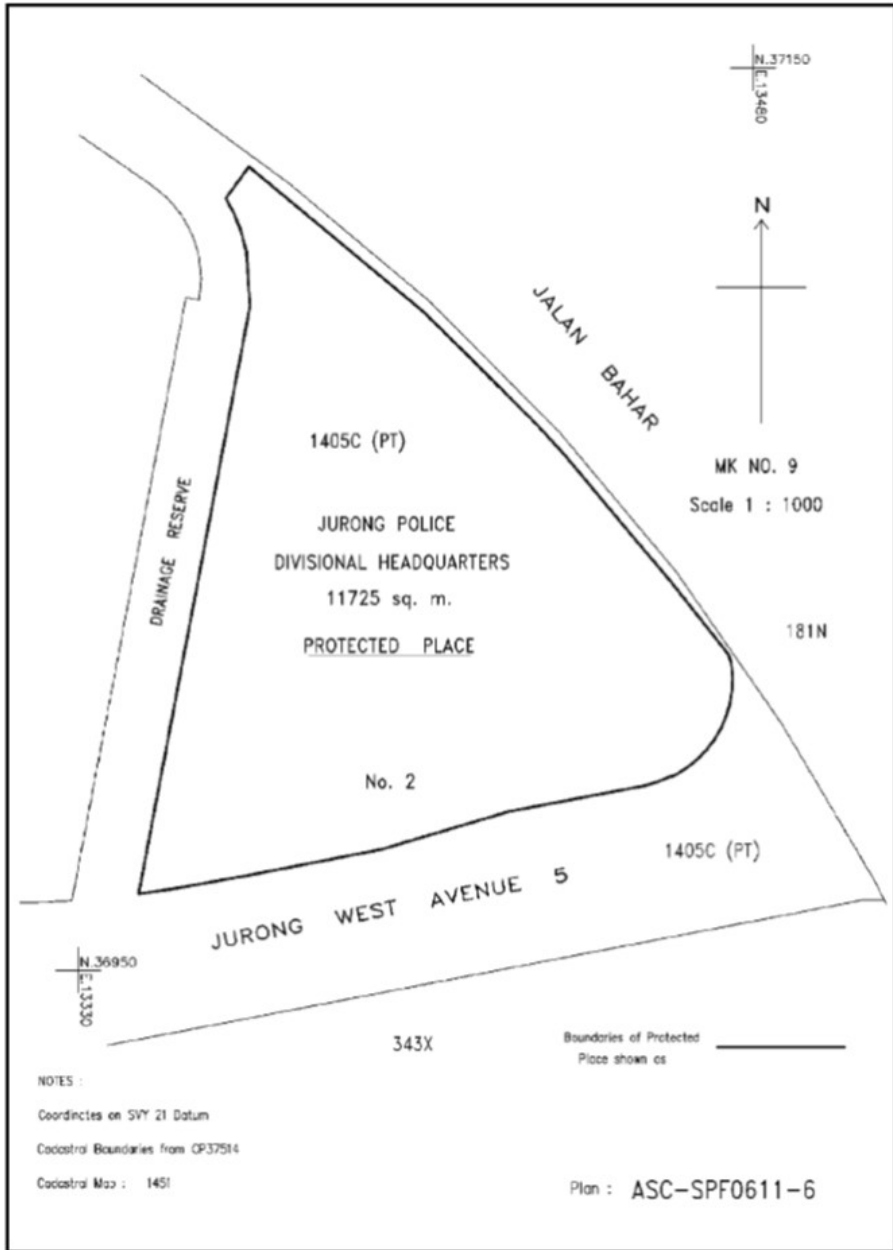

First column
The Authority

Second column
Protected Place

THE SCHEDULE — *continued*

(5) Commanding Officer,
Police K-9 Unit,
Singapore Police Force

POLICE K-9 UNIT.

All that area comprised in part of State Land Lot 3385A(PT) in MK 11 occupied by “POLICE K-9 UNIT” containing an area of about 27,426 square metres and bounded approximately as follows:

Commencing at the south-westernmost corner of the aforesaid “POLICE K-9 UNIT” which point is 42,086.855 metres North and 17,776.449 metres East of the Singapore Land Authority SVY 21 Datum, the boundaries run along successive lines of co-ordinates approximately as follows:

<i>Northing</i>	<i>Easting</i>
42,268.855	17,800.600
42,270.624	17,800.854
42,297.943	17,804.493
42,286.805	17,888.986
42,266.780	17,886.394
42,265.116	17,891.906
42,261.554	17,895.409
42,262.511	17,895.751
42,259.119	17,898.358
42,238.351	17,895.629
42,235.432	17,916.522
42,231.653	17,916.070
42,233.831	17,899.586
42,225.450	17,898.458
42,223.290	17,914.684
42,221.772	17,914.481
42,220.415	17,924.476

THE SCHEDULE — *continued*

42,233.132	17,926.111
42,232.550	17,930.682
42,150.376	17,919.969
42,147.890	17,919.347
42,146.375	17,917.322
42,144.689	17,915.523
42,143.107	17,914.288
42,141.090	17,913.305
42,138.745	17,912.690
42,136.288	17,912.330
42,131.331	17,911.637
42,128.954	17,910.658
42,121.748	17,910.160
42,081.077	17,904.656
42,078.566	17,904.260
42,071.231	17,902.749
42,071.428	17,901.654
42,057.588	17,898.966
42,055.236	17,898.416
42,052.924	17,897.412
42,050.937	17,895.897
42,049.461	17,893.952
42,048.338	17,891.788
42,047.777	17,889.255
42,047.871	17,886.819
42,048.163	17,885.092
42,052.117	17,871.278
42,052.920	17,868.870
42,055.218	17,862.480

THE SCHEDULE — *continued*

42,055.546	17,862.505
42,056.155	17,861.038
42,058.788	17,861.947
42,060.755	17,856.556
42,064.506	17,846.060
42,066.385	17,840.803
42,063.553	17,839.817

to the point of commencement.

The boundaries of “POLICE K-9 UNIT” are more particularly delineated in the Plan ASC-SPF-0611-9 set out below.

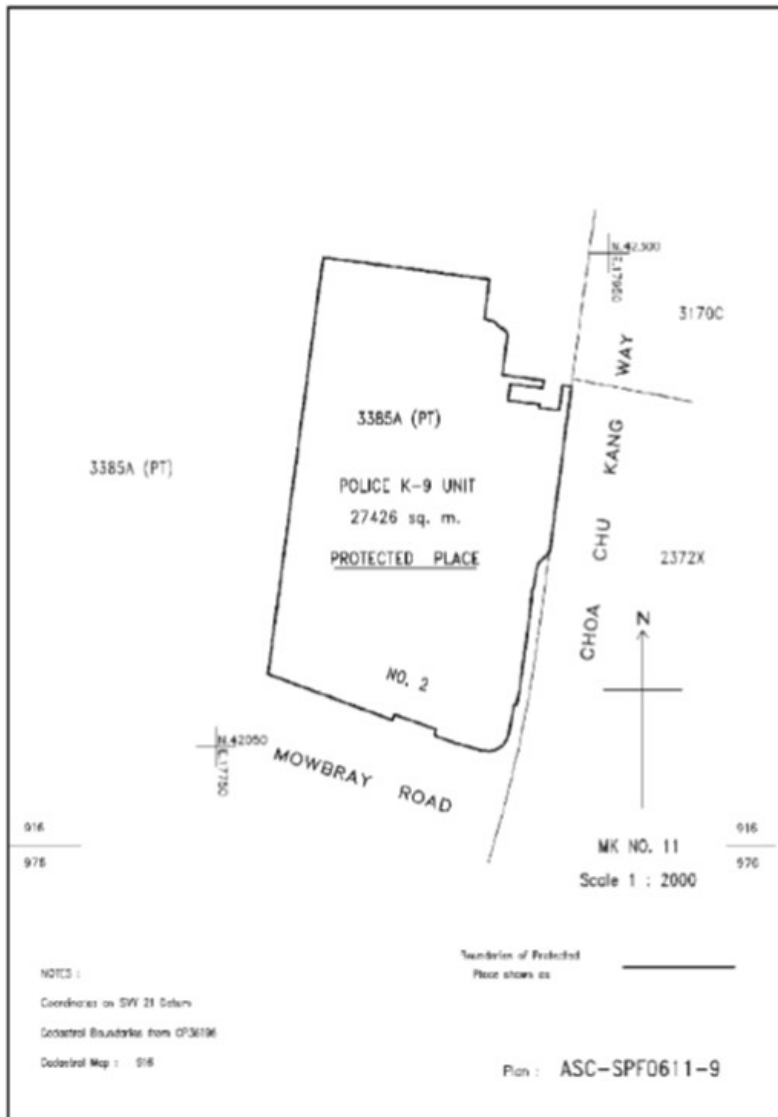
THE SCHEDULE — *continued*

(6) [*Deleted by S 93/2023 wef 24/02/2023*]

(7) [*Deleted by S 251/2020 wef 07/04/2020*]

First column
The Authority

Second column
Protected Place

THE SCHEDULE — *continued*

(8) Director, Logistics,
Singapore Police Force

POLICE LOGISTIC BASE.

All that area comprised in part of State Land Lots 99308V, 2062K and 2063N(PT) in MK 25 occupied by “POLICE LOGISTIC BASE” containing an area of about 7,521 square metres and bounded approximately as follows:

Commencing at the south-westernmost corner of the aforesaid “POLICE LOGISTIC BASE” which point is 32,629.338 metres North and 34,405.021 metres East of the Singapore Land Authority SVY 21 Datum, the boundaries run along successive lines of co-ordinates approximately as follows:

<i>Northing</i>	<i>Easting</i>
32,701.845	34,443.665
32,702.174	34,443.137
32,706.469	34,445.440
32,706.208	34,445.991
32,745.390	34,466.873
32,764.176	34,477.172
32,763.896	34,477.681
32,763.621	34,477.530
32,749.098	34,480.691
32,728.630	34,481.133
32,729.357	34,485.924
32,673.013	34,495.584
32,618.970	34,498.355
32,618.194	34,451.061
32,618.794	34,420.509

to the point of commencement.

THE SCHEDULE — *continued*

The boundaries of “POLICE LOGISTIC BASE” are more particularly delineated in the Plan ASC-SPF-0611-11 set out below.

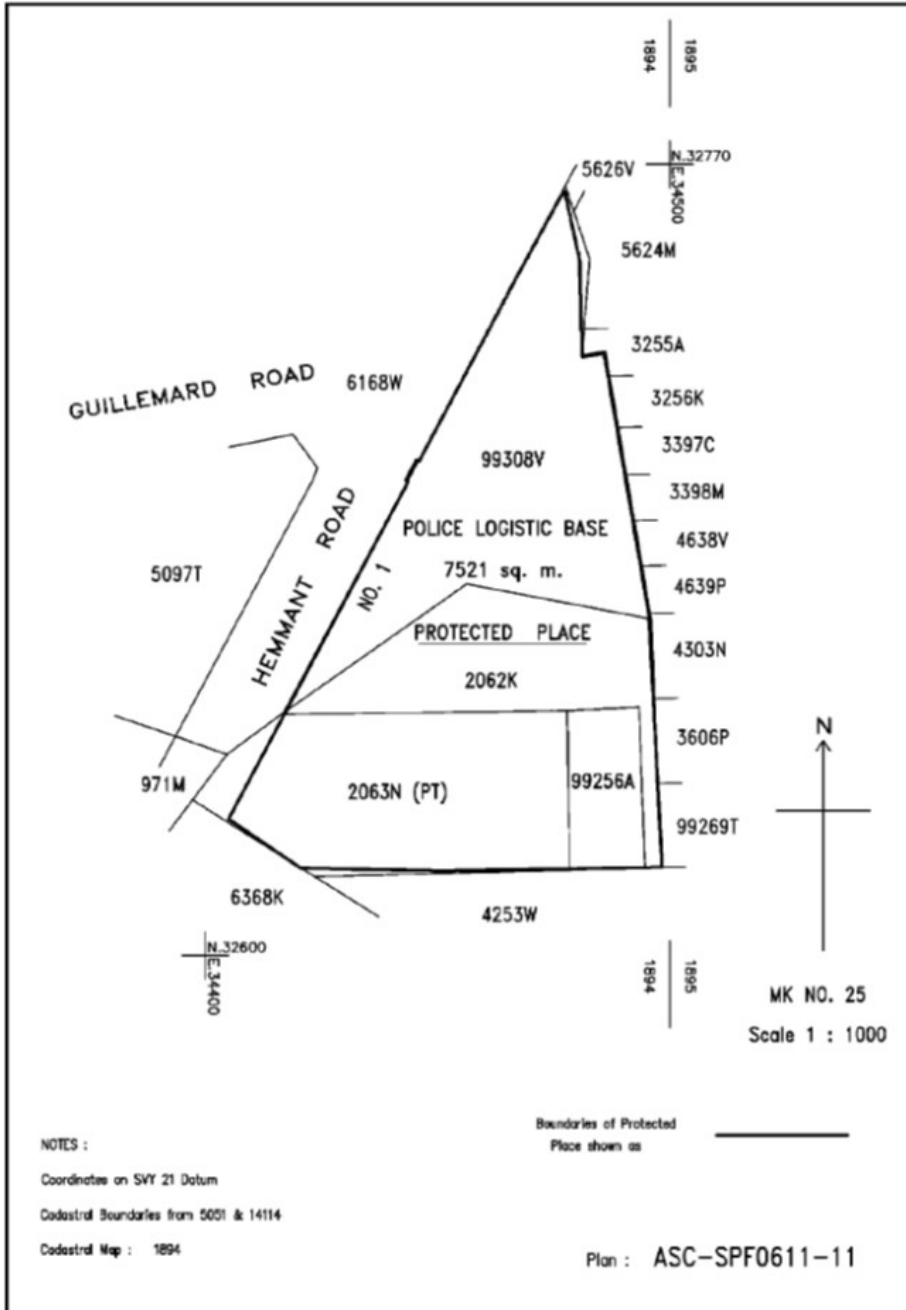

THE SCHEDULE — *continued*

<i>First column</i>	<i>Second column</i>
The Authority	Protected Place
(9) Commander, Tanglin Police Divisional Headquarters, Singapore Police Force	TANGLIN POLICE DIVISIONAL HEADQUARTERS.

All that area comprised in part of State Land Lot 2251L(PT) in TS 18 occupied by “TANGLIN POLICE DIVISIONAL HEADQUARTERS” containing an area of about 5,886 square metres and bounded approximately as follows:

Commencing at the north-easternmost corner of the aforesaid “TANGLIN POLICE DIVISIONAL HEADQUARTERS” which point is 32,699.479 metres North and 29,520.660 metres East of the Singapore Land Authority SVY 21 Datum, the boundaries run along successive lines of co-ordinates approximately as follows:

<i>Northing</i>	<i>Easting</i>
32,705.169	29,514.995
32,708.686	29,511.508
32,737.301	29,483.110
32,744.769	29,475.703
32,747.770	29,472.686
32,692.651	29,418.198
32,691.865	29,419.021
32,687.426	29,414.747
32,686.520	29,415.688
32,685.592	29,414.761
32,683.777	29,412.976
32,681.269	29,415.536

THE SCHEDULE — *continued*

32,641.272	29,457.307
32,640.416	29,458.201
32,639.359	29,459.304
32,638.669	29,460.546

to the point of commencement.

The boundaries of “TANGLIN POLICE DIVISIONAL HEADQUARTERS” are more particularly delineated in the Plan ASC-SPF-0611-3 set out below.

THE SCHEDULE — *continued*

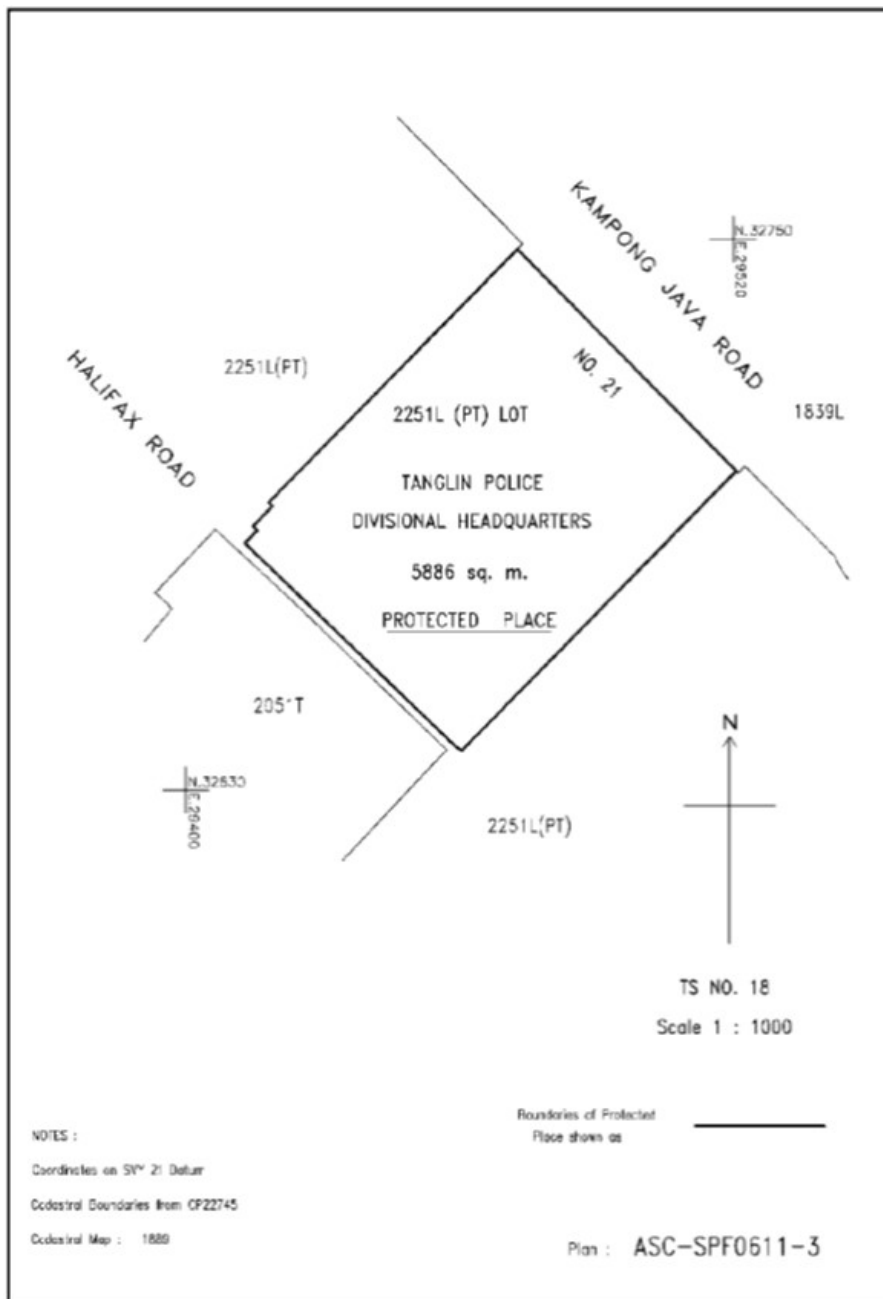

First column
The Authority

Second column
Protected Place

THE SCHEDULE — *continued*

- (10) Commander,
Traffic Police Divisional
Headquarters,
Singapore Police Force
- TRAFFIC POLICE DIVISIONAL
HEADQUARTERS.

All that area comprised in part of State Land Lots 4595L and 4603N (PT) in MK 23 occupied by “TRAFFIC POLICE DIVISIONAL HEADQUARTERS” containing an area of about 11,942 square metres and bounded approximately as follows:

Commencing at the south-easternmost corner of the aforesaid “TRAFFIC POLICE DIVISIONAL HEADQUARTERS” which point is 34,691.596 metres North and 34,522.323 metres East of the Singapore Land Authority SVY 21 Datum, the boundaries run along successive lines of co-ordinates approximately as follows:

<i>Northing</i>	<i>Easting</i>
34,698.089	34,520.208
34,704.921	34,517.955
34,763.232	34,498.817
34,704.921	34,517.955
34,763.232	34,498.817
34,764.026	34,497.020
34,765.222	34,494.320
34,768.210	34,487.697
34,763.420	34,475.653
34,758.147	34,461.875
34,756.629	34,457.938
34,749.182	34,435.835
34,737.151	34,393.057

THE SCHEDULE — *continued*

34,735.447	34,385.757
34,735.206	34,384.764
34,733.639	34,378.309
34,732.132	34,371.942
34,731.172	34,367.797
34,730.398	34,364.485
34,729.870	34,362.235
34,729.373	34,360.078
34,728.371	34,355.871
34,720.699	34,358.934
34,699.813	34,367.234
34,658.079	34,383.955
34,658.016	34,383.797
34,647.512	34,388.231
34,660.720	34,428.396

to the point of commencement.

The boundaries of “TRAFFIC POLICE DIVISIONAL HEADQUARTERS” are more particularly delineated in the Plan ASC-SPF-0611-7 set out below.

THE SCHEDULE — *continued*

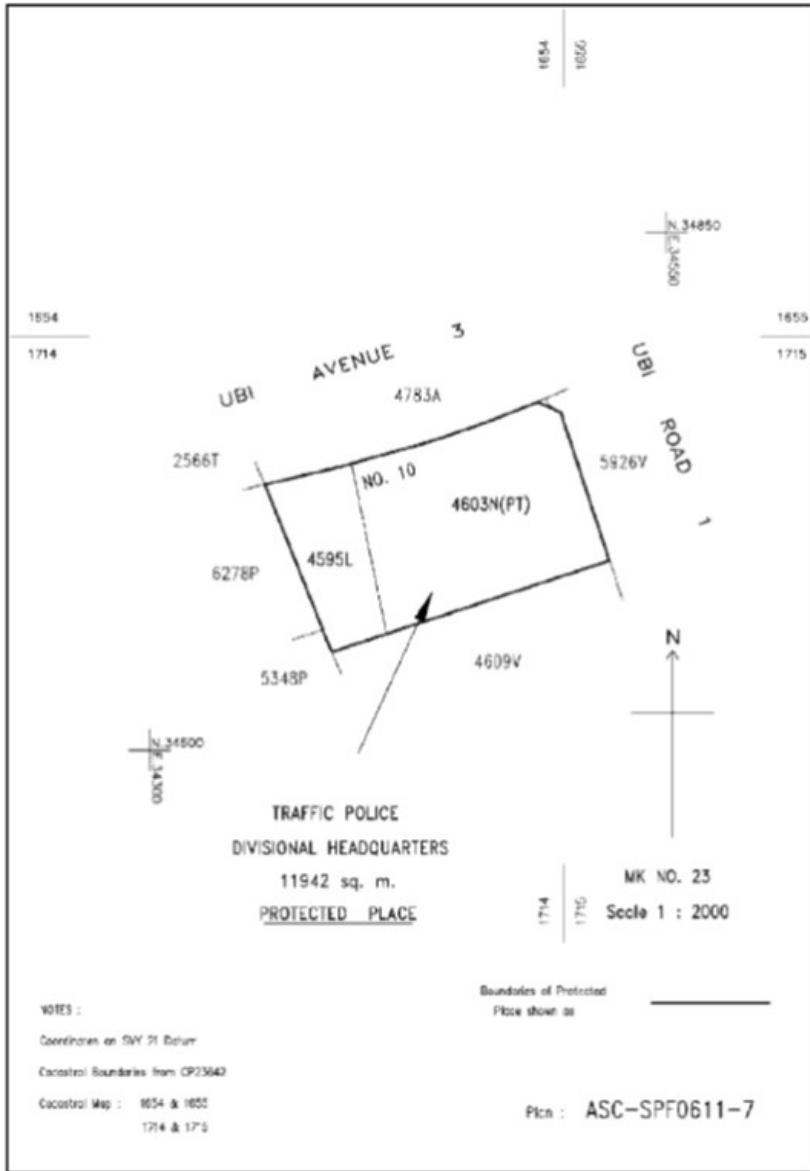

Made this 5th day of September 2007.

BENNY LIM
*Permanent Secretary,
Ministry of Home Affairs,
Singapore.*

[MHA (PS) 12/2/07 TF 4; AG/LEG/SL/256/2002/1 Vol. 11]