

---

---

First published in the *Government Gazette*, Electronic Edition, on 30 January 2024 at 5 pm.

## No. S 49

### INFRASTRUCTURE PROTECTION ACT 2017

#### INFRASTRUCTURE PROTECTION (PROTECTED PLACES) (NO. 6) ORDER 2024

##### ARRANGEMENT OF PARAGRAPHS

###### Paragraph

1. Citation and commencement
  2. Premises declared to be protected places
  3. Revocations
- The Schedule
- 

In exercise of the powers conferred by sections 14(1) and 19(1) of the Infrastructure Protection Act 2017, the Minister for Home Affairs makes the following Order:

#### **Citation and commencement**

1. This Order is the Infrastructure Protection (Protected Places) (No. 6) Order 2024 and comes into operation on 31 January 2024.

#### **Premises declared to be protected places**

2. The premises described in the second column of the Schedule are declared to be protected places for the purposes of the Act, and the person specified in the first column of that Schedule is designated as the authority of the corresponding protected place.

#### **Revocations**

3.—(1) In the Protected Places (No. 8) Order 2012 (G.N. No. S 453/2012), in the Schedule, delete items (2), (4), (5), (18), (19) and (26).

(2) In the Protected Places (No. 5) Order 2013 (G.N. No. S 306/2013), in the Schedule, delete items (3), (4) and (5).

(3) In the Protected Places (No. 6) Order 2013 (G.N. No. S 307/2013), in the Schedule, delete items (10) and (12).

(4) In the Protected Places (No. 7) Order 2013 (G.N. No. S 308/2013), in the Schedule, delete item (3).

(5) In the Protected Places (No. 9) Order 2013 (G.N. No. S 310/2013), in the Schedule, delete items (2) and (3).

## THE SCHEDULE

Paragraph 2

<i>First column</i>	<i>Second column</i>																				
The Authority	Protected Place																				
1. Chief Executive Officer, SP PowerGrid Ltd	<p>GRANGE ROAD SUBSTATION</p> <p>All that area comprised in part of Lot 00854A in Town Subdivision No. 21 occupied by “GRANGE ROAD SUBSTATION” containing an area of about 1762.3 square metres and bounded approximately as follows:</p> <p>Commencing at a point 31373.814 metres North and 27725.753 metres East of the Singapore Land Authority SVY 21 Datum, the boundaries run along successive lines of coordinates approximately as follows:</p> <table border="0" style="margin-left: auto; margin-right: auto;"> <thead> <tr> <th style="text-align: center;"><i>Northing</i></th> <th style="text-align: center;"><i>Easting</i></th> </tr> </thead> <tbody> <tr> <td style="text-align: center;">31373.814</td> <td style="text-align: center;">27725.753</td> </tr> <tr> <td style="text-align: center;">31373.076</td> <td style="text-align: center;">27762.505</td> </tr> <tr> <td style="text-align: center;">31373.390</td> <td style="text-align: center;">27798.012</td> </tr> <tr> <td style="text-align: center;">31374.492</td> <td style="text-align: center;">27799.321</td> </tr> <tr> <td style="text-align: center;">31379.263</td> <td style="text-align: center;">27800.289</td> </tr> <tr> <td style="text-align: center;">31384.604</td> <td style="text-align: center;">27794.051</td> </tr> <tr> <td style="text-align: center;">31369.453</td> <td style="text-align: center;">27794.151</td> </tr> <tr> <td style="text-align: center;">31358.775</td> <td style="text-align: center;">27793.552</td> </tr> <tr> <td style="text-align: center;">31358.355</td> <td style="text-align: center;">27793.449</td> </tr> </tbody> </table>	<i>Northing</i>	<i>Easting</i>	31373.814	27725.753	31373.076	27762.505	31373.390	27798.012	31374.492	27799.321	31379.263	27800.289	31384.604	27794.051	31369.453	27794.151	31358.775	27793.552	31358.355	27793.449
<i>Northing</i>	<i>Easting</i>																				
31373.814	27725.753																				
31373.076	27762.505																				
31373.390	27798.012																				
31374.492	27799.321																				
31379.263	27800.289																				
31384.604	27794.051																				
31369.453	27794.151																				
31358.775	27793.552																				
31358.355	27793.449																				

---



---

 THE SCHEDULE — *continued*

<i>First column</i>		<i>Second column</i>
The Authority		Protected Place
	31357.759	27785.622
	31357.700	27785.683
	31358.314	27785.065
	31357.552	27765.653
	31356.911	27744.088
	31356.852	27743.470
	31354.817	27743.403
	31352.603	27735.401
	31352.545	27735.533
	31353.190	27734.851
	31352.439	27729.200
	31351.770	27727.003
	31351.685	27730.298
	31351.169	27762.505
	31365.579	27798.012

to the point of commencement.

The boundaries of “GRANGE ROAD SUBSTATION” are more particularly delineated in the Survey Plan set out below.

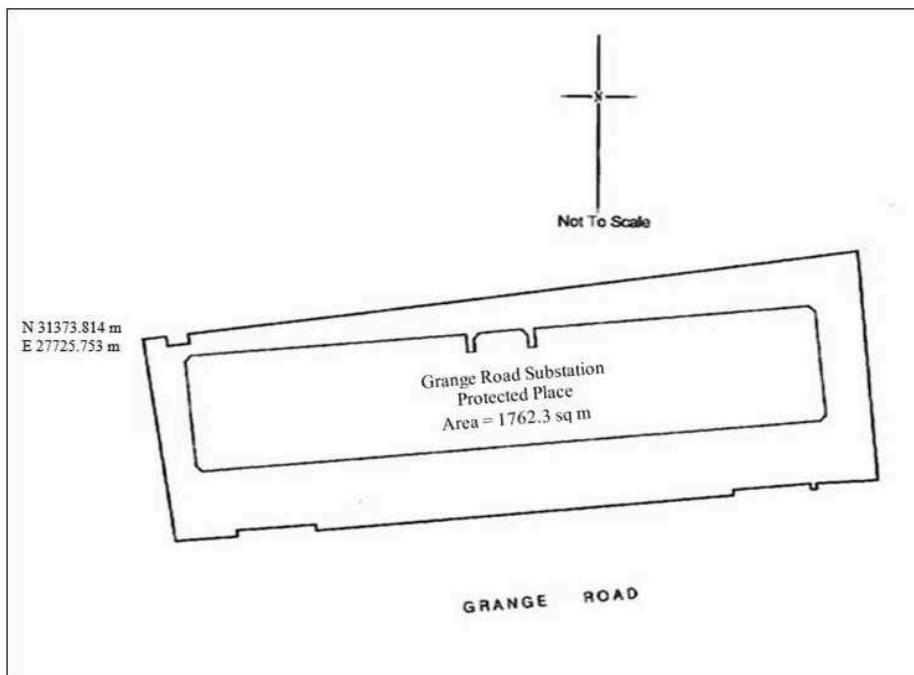
THE SCHEDULE — *continued**First column**Second column*

The Authority

Protected Place

2. Chief Executive Officer,  
SP PowerGrid Ltd

GUL CHANNEL SUBSTATION

All that area comprised in part of Lot 00778L in Mukim No. 7 occupied by “GUL CHANNEL SUBSTATION” containing an area of about 5001.3 square metres and bounded approximately as follows:

Commencing at a point 32154.761 metres North and 9326.705 metres East of the Singapore Land Authority SVY 21 Datum, the boundaries run along successive lines of coordinates approximately as follows:

<i>Northing</i>	<i>Easting</i>
32154.761	9326.705
32154.781	9326.912
32161.468	9380.918
32141.572	9383.463

---



---

 THE SCHEDULE — *continued*

<i>First column</i>	<i>Second column</i>
The Authority	Protected Place
32129.464	9385.070
32110.654	9387.503
32092.589	9389.900
32082.922	9391.124
32073.485	9392.311
32071.085	9392.371
32070.968	9392.372
32064.147	9337.980
32078.026	9336.330
32084.132	9335.573
32110.790	9332.227
32133.633	9329.402
32147.047	9327.739
32153.150	9326.964
32154.583	9326.734

to the point of commencement.

The boundaries of “GUL CHANNEL SUBSTATION” are more particularly delineated in the Survey Plan set out below.

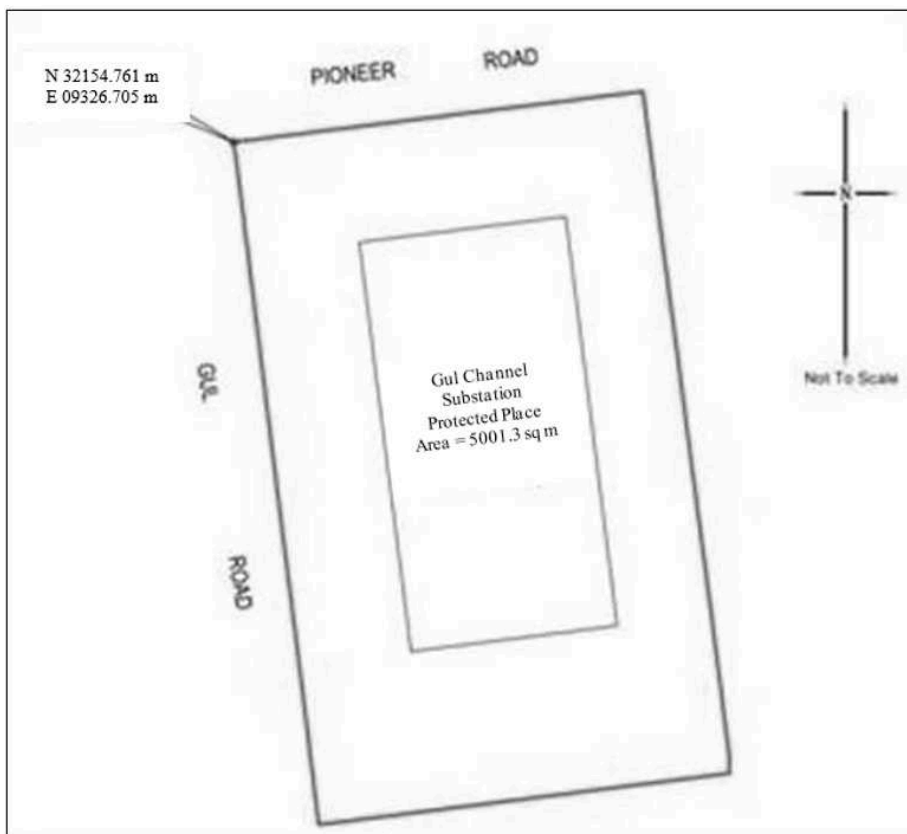
THE SCHEDULE — *continued**First column**Second column*

The Authority

Protected Place

3. Chief Executive Officer,  
SP PowerGrid Ltd

HARBOUR DRIVE BUILDING

All that area comprised in part of Lot 03920A in Mukim No. 3 occupied by “HARBOUR DRIVE BUILDING” containing an area of about 1894.9 square metres and bounded approximately as follows:

Commencing at a point 29465.393 metres North and 22053.568 metres East of the Singapore Land Authority SVY 21 Datum, the boundaries run along successive lines of coordinates approximately as follows:

<i>Northing</i>	<i>Easting</i>
29465.393	22053.568

---



---

 THE SCHEDULE — *continued*

<i>First column</i>		<i>Second column</i>
The Authority		Protected Place
	29452.393	22045.820
	29435.678	22035.866
	29425.889	22052.312
	29415.810	22069.266
	29415.718	22069.216
	29413.129	22073.563
	29413.359	22073.706
	29410.410	22078.691
	29410.203	22078.571
	29409.943	22079.010
	29409.932	22079.055
	29407.674	22082.845
	29409.573	22083.950
	29421.242	22090.900
	29437.551	22100.564
	29445.669	22086.913
	29453.116	22074.429

to the point of commencement.

The boundaries of “HARBOUR DRIVE BUILDING” are more particularly delineated in the Survey Plan set out below.

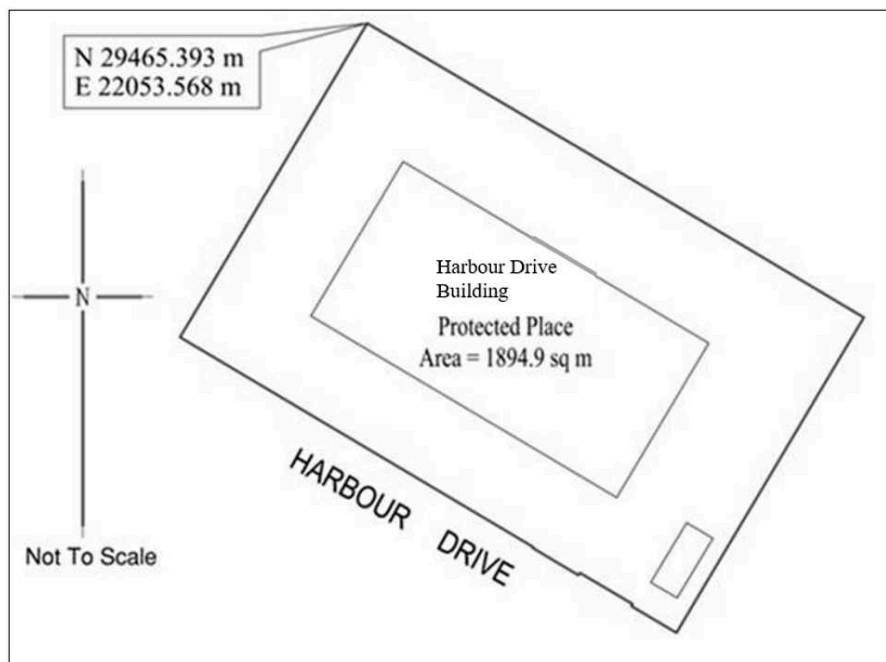
THE SCHEDULE — *continued**First column**Second column*

The Authority

Protected Place

4. Chief Executive Officer,  
SP PowerGrid Ltd

HENDERSON SUBSTATION

All that area comprised in part of Lot 02362L in Mukim No. 1 occupied by “HENDERSON SUBSTATION” containing an area of about 1037.9 square metres and bounded approximately as follows:

Commencing at a point 29323.658 metres North and 26601.847 metres East of the Singapore Land Authority SVY 21 Datum, the boundaries run along successive lines of coordinates approximately as follows:

<i>Northing</i>	<i>Easting</i>
29323.658	26601.847
29317.732	26608.323
29316.200	26608.626
29315.879	26608.882



---



---

 THE SCHEDULE — *continued*

<i>First column</i>		<i>Second column</i>
The Authority		Protected Place
	29310.619	26609.811
	29310.522	26609.825
	29304.622	26610.874
	29304.540	26610.887
	29281.792	26614.718
	29279.767	26614.145
	29272.452	26607.319
	29271.531	26606.511
	29271.366	26606.338
	29297.273	26577.816

to the point of commencement.

The boundaries of “HENDERSON SUBSTATION” are more particularly delineated in the Survey Plan set out below.

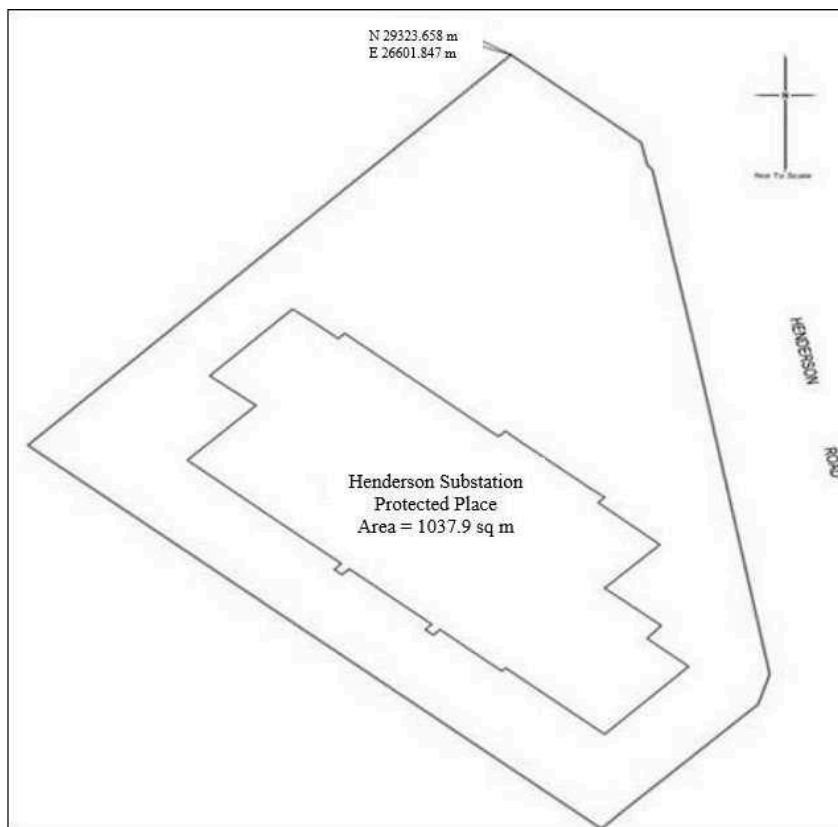
THE SCHEDULE — *continued**First column**Second column*

The Authority

Protected Place

5. Chief Executive Officer,  
SP PowerGrid Ltd

INTERNATIONAL ROAD SUBSTATION

All that area comprised in part of Lot 00824C in Mukim No. 6 occupied by “INTERNATIONAL ROAD SUBSTATION” containing an area of about 2875.2 square metres and bounded approximately as follows:

Commencing at a point 34520.019 metres North and 12448.725 metres East of the Singapore Land Authority SVY 21 Datum, the boundaries run along successive lines of coordinates approximately as follows:

<i>Northing</i>	<i>Easting</i>
34520.019	12448.725

---



---

 THE SCHEDULE — *continued*

<i>First column</i>	<i>Second column</i>
The Authority	Protected Place
34507.812	12448.378
34506.942	12448.080
34501.980	12448.048
34501.112	12449.282
34481.987	12449.020
34481.120	12447.861
34476.196	12447.823
34472.704	12448.070
34472.842	12509.352
34519.963	12509.473
34520.170	12452.378

to the point of commencement.

The boundaries of “INTERNATIONAL ROAD SUBSTATION” are more particularly delineated in the Survey Plan set out below.

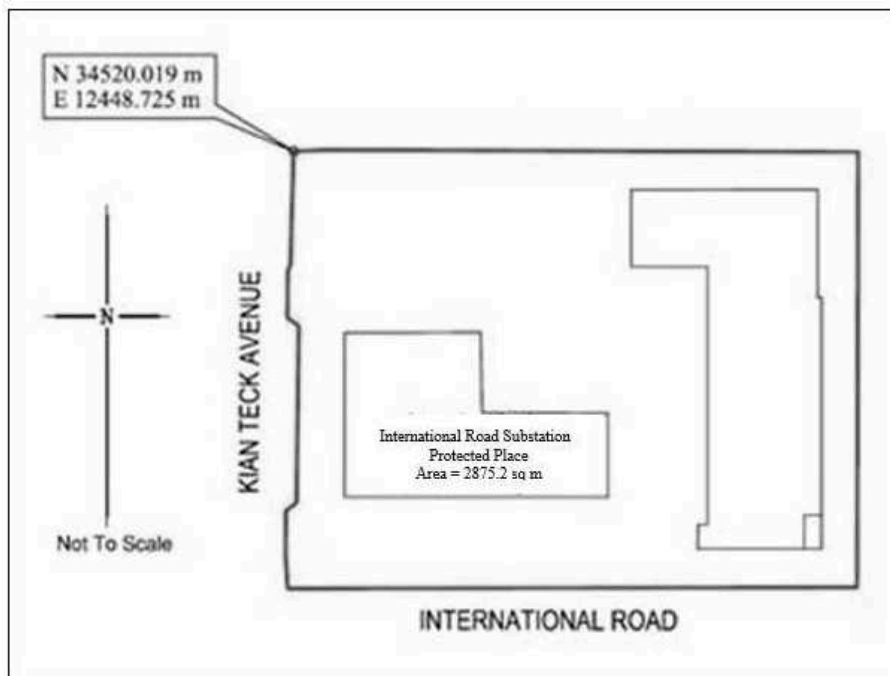
THE SCHEDULE — *continued**First column**Second column*

The Authority

Protected Place

6. Chief Executive Officer,  
SP PowerGrid Ltd

## JALAN BAHAR SUBSTATION

All that area comprised in part of Lot 00351V in Mukim No. 9 occupied by “JALAN BAHAR SUBSTATION” containing an area of about 2953.3 square metres and bounded approximately as follows:

Commencing at a point 38255.167 metres North and 12329.810 metres East of the Singapore Land Authority SVY 21 Datum, the boundaries run along successive lines of coordinates approximately as follows:

<i>Northing</i>	<i>Easting</i>
38255.167	12329.810
38211.891	12393.097
38206.851	12394.763

THE SCHEDULE — *continued*

<i>First column</i>	<i>Second column</i>	
The Authority	Protected Place	
	38204.718	12395.514
	38189.670	12352.718

to the point of commencement.

The boundaries of “JALAN BAHAR SUBSTATION” are more particularly delineated in the Survey Plan set out below.

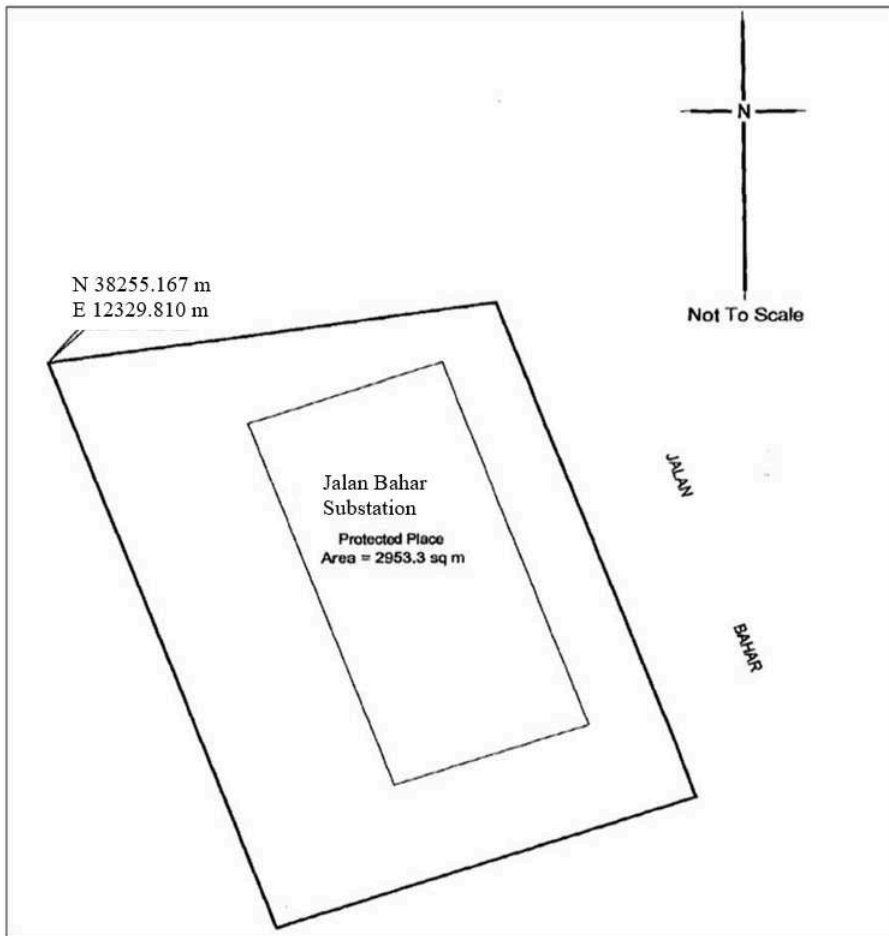

THE SCHEDULE — *continued*

<i>First column</i>	<i>Second column</i>																						
The Authority	Protected Place																						
7. Chief Executive Officer, SP PowerGrid Ltd	<p style="text-align: center;">JURONG HARBOUR SUBSTATION</p> <p>All that area comprised in part of Lot 00482N in Mukim No. 6 occupied by “JURONG HARBOUR SUBSTATION” containing an area of about 3033.1 square metres and bounded approximately as follows:</p> <p>Commencing at a point 32149.397 metres North and 9561.610 metres East of the Singapore Land Authority SVY 21 Datum, the boundaries run along successive lines of coordinates approximately as follows:</p> <table border="0" style="margin-left: auto; margin-right: auto;"> <thead> <tr> <th style="text-align: center;"><i>Northing</i></th> <th style="text-align: center;"><i>Easting</i></th> </tr> </thead> <tbody> <tr><td style="text-align: center;">32149.397</td><td style="text-align: center;">9561.610</td></tr> <tr><td style="text-align: center;">32147.313</td><td style="text-align: center;">9561.133</td></tr> <tr><td style="text-align: center;">32132.063</td><td style="text-align: center;">9558.066</td></tr> <tr><td style="text-align: center;">32104.825</td><td style="text-align: center;">9552.491</td></tr> <tr><td style="text-align: center;">32091.847</td><td style="text-align: center;">9617.963</td></tr> <tr><td style="text-align: center;">32136.321</td><td style="text-align: center;">9627.045</td></tr> <tr><td style="text-align: center;">32144.370</td><td style="text-align: center;">9586.643</td></tr> <tr><td style="text-align: center;">32144.528</td><td style="text-align: center;">9586.368</td></tr> <tr><td style="text-align: center;">32145.739</td><td style="text-align: center;">9580.289</td></tr> <tr><td style="text-align: center;">32145.692</td><td style="text-align: center;">9580.166</td></tr> </tbody> </table> <p>to the point of commencement.</p>	<i>Northing</i>	<i>Easting</i>	32149.397	9561.610	32147.313	9561.133	32132.063	9558.066	32104.825	9552.491	32091.847	9617.963	32136.321	9627.045	32144.370	9586.643	32144.528	9586.368	32145.739	9580.289	32145.692	9580.166
<i>Northing</i>	<i>Easting</i>																						
32149.397	9561.610																						
32147.313	9561.133																						
32132.063	9558.066																						
32104.825	9552.491																						
32091.847	9617.963																						
32136.321	9627.045																						
32144.370	9586.643																						
32144.528	9586.368																						
32145.739	9580.289																						
32145.692	9580.166																						

The boundaries of “JURONG HARBOUR SUBSTATION” are more particularly delineated in the Survey Plan set out below.

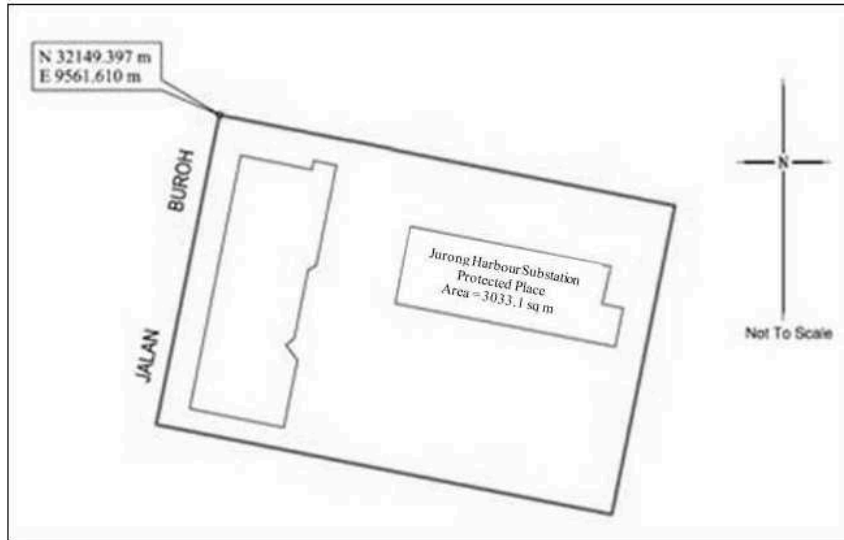
THE SCHEDULE — *continued**First column**Second column*

The Authority

Protected Place

8. Chief Executive Officer, SP PowerGrid Ltd      JURONG ISLAND SUBSTATION

All that area comprised in part of Lot 01255M in Mukim No. 34 occupied by “JURONG ISLAND SUBSTATION” containing an area of about 7323.9 square metres and bounded approximately as follows:

Commencing at a point 28239.842 metres North and 14000.062 metres East of the Singapore Land Authority SVY 21 Datum, the boundaries run along successive lines of coordinates approximately as follows:

<i>Northing</i>	<i>Easting</i>
28239.842	14000.062
28230.196	14053.173
28226.063	14077.220
28219.186	14074.122
28221.610	14069.473
28220.946	14069.110

---



---

 THE SCHEDULE — *continued*

<i>First column</i>		<i>Second column</i>
The Authority		Protected Place
	28213.454	14064.974
	28212.806	14064.614
	28210.804	14068.382
	28210.437	14069.118
	28210.543	14069.295
	28210.263	14069.852
	28204.368	14066.800
	28204.422	14066.700
	28202.977	14065.670
	28189.058	14057.846
	28183.409	14054.347
	28180.281	14052.284
	28176.755	14046.814
	28162.353	14036.756
	28148.337	14025.887
	28141.637	14020.238
	28131.498	14011.127
	28171.973	13953.077
	28212.472	13980.852

to the point of commencement.

The boundaries of “JURONG ISLAND SUBSTATION” are more particularly delineated in the Survey Plan set out below.

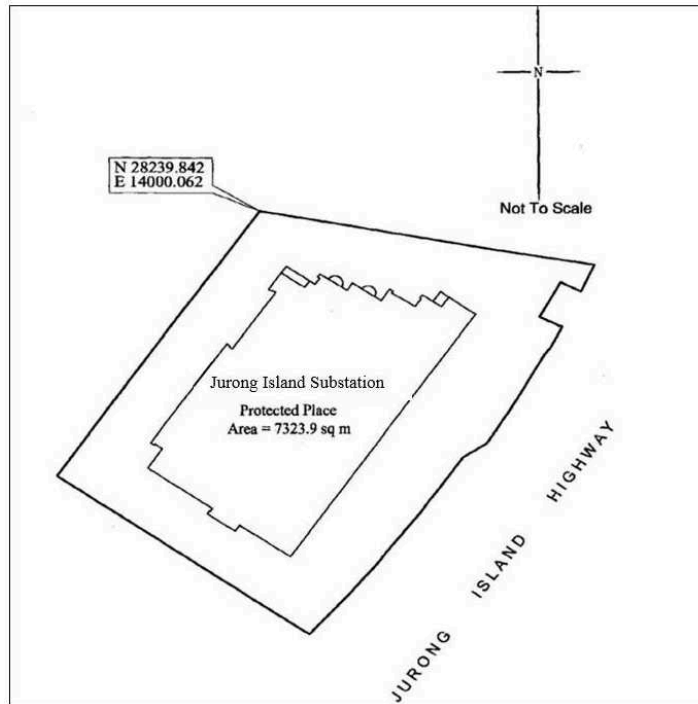

THE SCHEDULE — *continued**First column**Second column*

The Authority

Protected Place

9. Chief Executive Officer,  
SP PowerGrid Ltd

## JURONG LAKE CANAL LINK BRIDGE

All that area comprised in part of Lot 03949L pt in Mukim No. 6 occupied by “JURONG LAKE CANAL LINK BRIDGE” containing an area of about 466.8 square metres and bounded approximately as follows:

Commencing at a point 36307.704 metres North and 16272.970 metres East of the Singapore Land Authority SVY 21 Datum, the boundaries run along successive lines of coordinates approximately as follows:

<i>Northing</i>	<i>Easting</i>
36307.704	16272.970
36305.814	16316.563
36305.814	16316.699

---



---

 THE SCHEDULE — *continued*

<i>First column</i>		<i>Second column</i>
The Authority		Protected Place
	36303.931	16316.702
	36303.931	16316.573
	36297.253	16316.565
	36297.002	16273.008
	36303.842	16272.974
	36303.839	16272.843
	36305.707	16272.834
	36305.715	16272.969

to the point of commencement.

The boundaries of “JURONG LAKE CANAL LINK BRIDGE” are more particularly delineated in the Survey Plan set out below.

THE SCHEDULE — *continued*

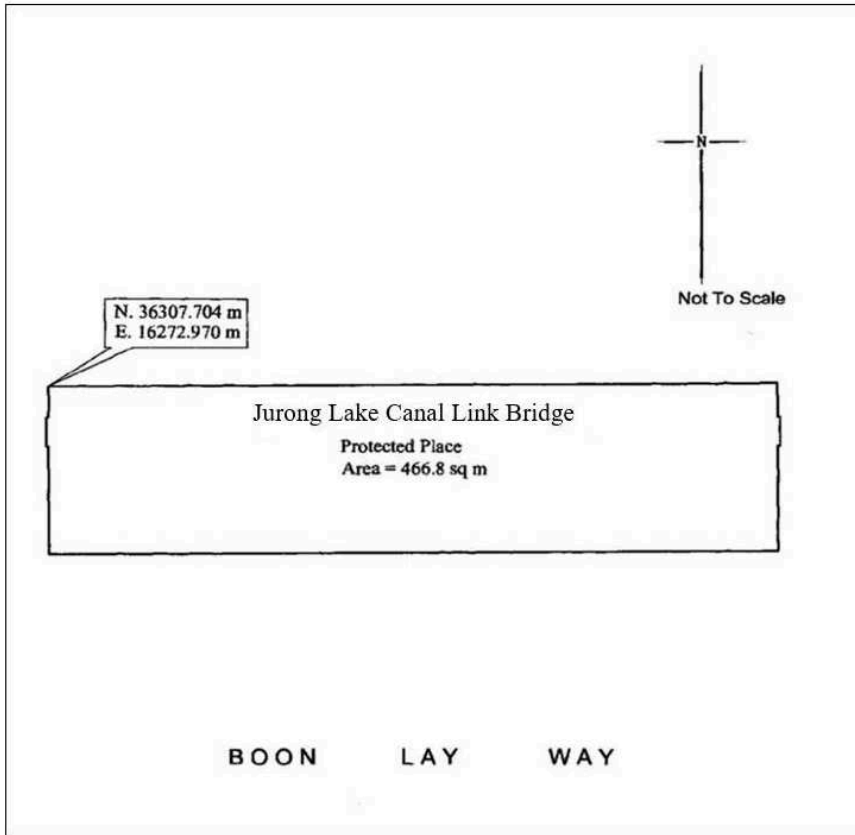

*First column*

*Second column*

The Authority

Protected Place

10. Chief Executive Officer, JURONG WEST SUBSTATION  
SP PowerGrid Ltd

All that area comprised in part of Lot 00734W in Mukim No. 9 occupied by “JURONG WEST SUBSTATION” containing an area of about 3140.8 square metres and bounded approximately as follows:

Commencing at a point 36523.936 metres North and 13451.341 metres East of the Singapore Land Authority SVY 21 Datum, the boundaries run along successive lines of coordinates approximately as follows:

*Northing*

*Easting*

---



---

 THE SCHEDULE — *continued*

<i>First column</i>		<i>Second column</i>
The Authority		Protected Place
	36523.936	13451.341
	36552.444	13509.706
	36507.126	13532.029
	36506.247	13532.434
	36504.948	13529.624
	36505.555	13529.345
	36501.712	13521.417
	36501.195	13520.116
	36493.304	13498.026
	36493.799	13494.342
	36491.483	13490.556
	36482.362	13471.638
	36486.189	13469.780

to the point of commencement.

The boundaries of “JURONG WEST SUBSTATION” are more particularly delineated in the Survey Plan set out below.

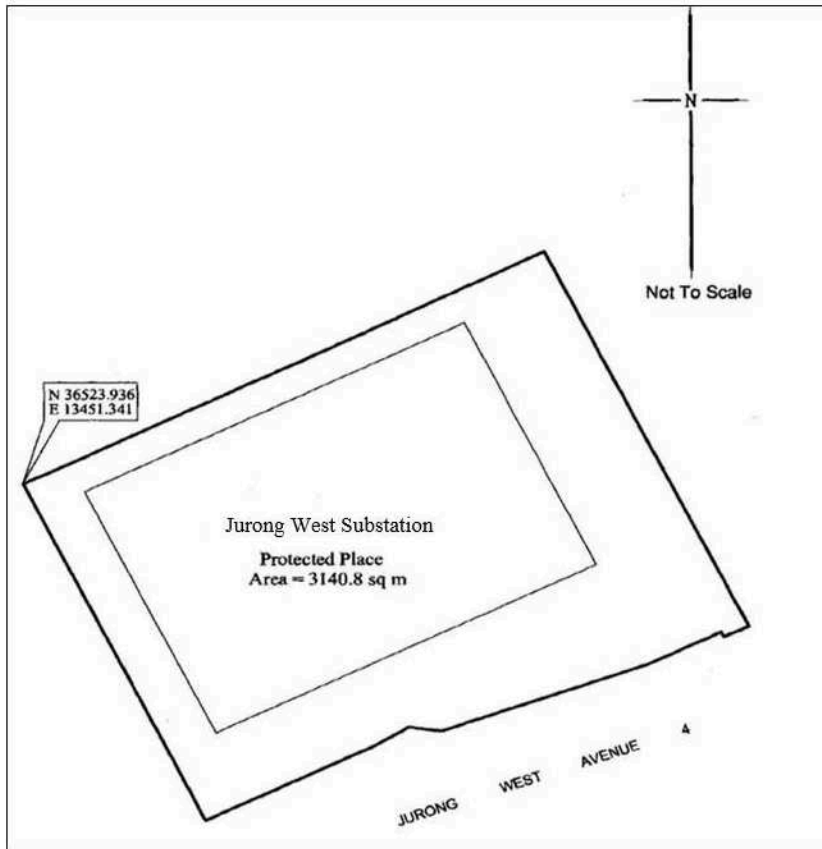
THE SCHEDULE — *continued**First column*

The Authority

*Second column*

Protected Place

11. Chief Executive Officer, KAKI BUKIT AVENUE 4 SUBSTATION  
SP PowerGrid Ltd

All that area comprised in part of Lot 06191V in Mukim No. 23 occupied by “KAKI BUKIT AVENUE 4 SUBSTATION” containing an area of about 3915.4 square metres and bounded approximately as follows:

Commencing at a point 35684.895 metres North and 36297.127 metres East of the Singapore Land Authority SVY 21 Datum, the boundaries run along successive lines of coordinates approximately as follows:

*Northing**Eastings*

---



---

 THE SCHEDULE — *continued*

<i>First column</i>		<i>Second column</i>
The Authority		Protected Place
	35684.895	36297.127
	35665.818	36330.462
	35663.912	36329.307
	35659.508	36327.121
	35630.757	36310.382
	35630.932	36283.553
	35631.380	36250.688
	35634.252	36250.098
	35634.221	36249.999
	35634.744	36249.881
	35634.756	36249.920
	35642.332	36248.194
	35642.323	36248.159
	35648.028	36246.850
	35648.055	36246.952
	35671.569	36241.626
	35674.022	36241.507
	35676.433	36241.967
	35678.755	36242.798
	35680.825	36244.141
	35682.459	36245.936
	35684.052	36248.696
	35684.744	36251.033
	35684.991	36252.719

to the point of commencement.

THE SCHEDULE — *continued**First column**Second column*

The Authority

Protected Place

The boundaries of “KAKI BUKIT AVENUE 4 SUBSTATION” are more particularly delineated in the Survey Plan set out below.

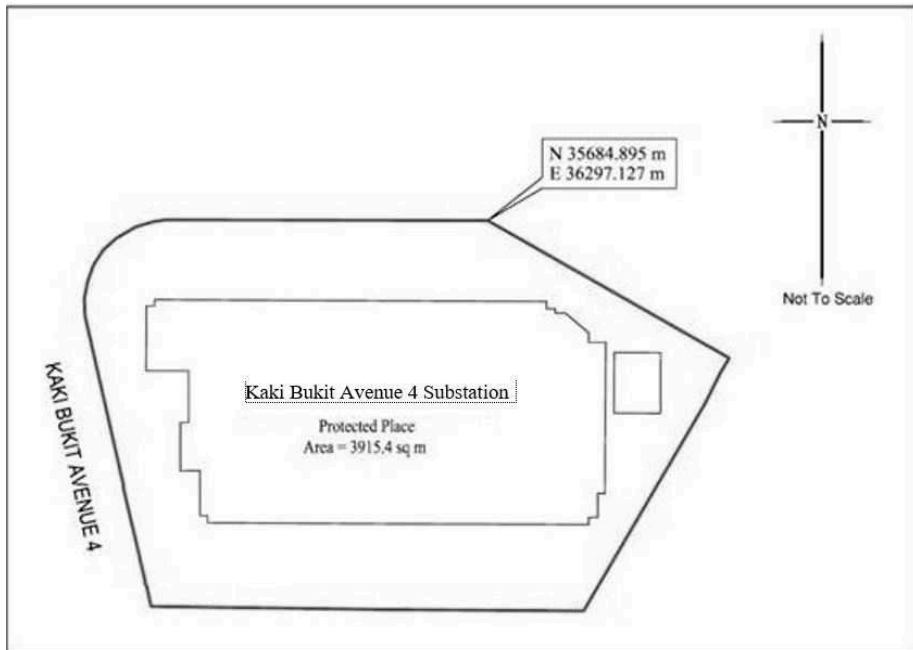
*First column**Second column*

The Authority

Protected Place

12. Chief Executive Officer, KAMPONG BAHRU SUBSTATION  
SP PowerGrid Ltd

All that area comprised in part of Lot 02422M in Mukim No. 1 occupied by “KAMPONG BAHRU SUBSTATION” containing an area of about 2972.6 square metres and bounded approximately as follows:

Commencing at a point 28811.048 metres North and 27897.252 metres East of the Singapore Land Authority SVY 21 Datum, the boundaries run along successive lines of coordinates approximately as follows:

THE SCHEDULE — *continued*

<i>First column</i>	<i>Second column</i>	
The Authority	Protected Place	
	<i>Northing</i>	<i>Easting</i>
	28811.048	27897.252
	28820.688	27956.197
	28826.418	27958.697
	28826.058	27959.264
	28821.674	27966.149
	28819.206	27969.828
	28812.780	27978.837
	28811.219	27980.386
	28809.400	27981.636
	28807.352	27982.496
	28805.174	27982.893
	28803.028	27982.849
	28800.766	27982.636
	28799.715	27982.387
	28798.607	27982.126
	28786.069	27977.799
	28784.341	27976.418
	28782.912	27974.718
	28782.418	27972.622
	28779.319	27928.132
	28779.846	27928.087
	28779.244	27919.352
	28779.385	27919.339
	28778.862	27911.219
	28778.722	27911.228
	28778.052	27902.468



THE SCHEDULE — *continued*

<i>First column</i>	<i>Second column</i>
The Authority	Protected Place

to the point of commencement.

The boundaries of “KAMPONG BAHRU SUBSTATION” are more particularly delineated in the Survey Plan set out below.

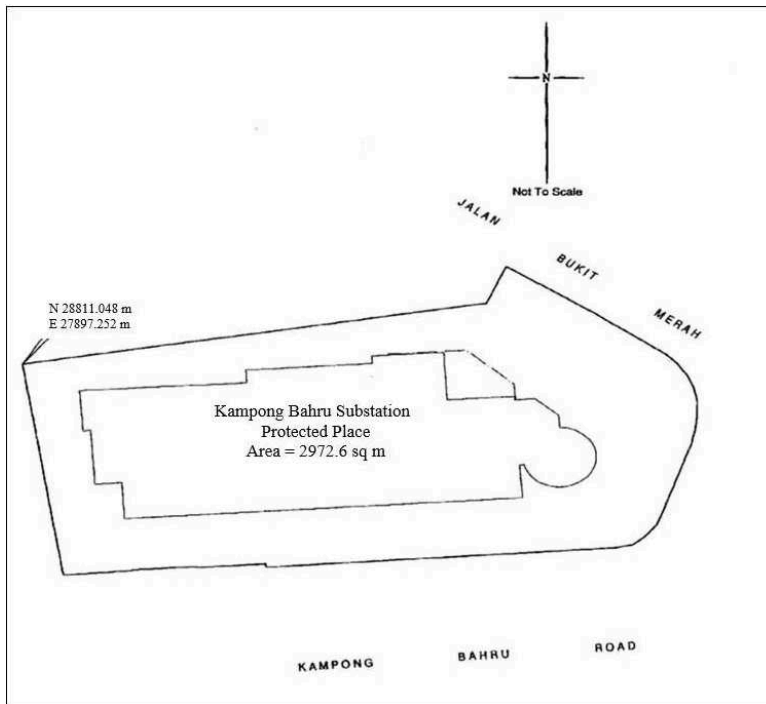

<i>First column</i>	<i>Second column</i>
The Authority	Protected Place

13. Chief Executive Officer, LOYANG SUBSTATION  
SP PowerGrid Ltd

All that area comprised in part of Lot 02563V in Mukim No. 31 occupied by “LOYANG SUBSTATION” containing an area of about 3949.5 square metres and bounded approximately as follows:

Commencing at a point 39725.356 metres North and 43267.386 metres East of the Singapore Land Authority SVY 21 Datum, the

THE SCHEDULE — *continued*

<i>First column</i>	<i>Second column</i>																																																
The Authority	Protected Place																																																
	boundaries run along successive lines of coordinates approximately as follows:																																																
	<table border="0" style="margin-left: auto; margin-right: auto;"> <thead> <tr> <th style="text-align: left;"><i>Northing</i></th> <th style="text-align: left;"><i>Easting</i></th> </tr> </thead> <tbody> <tr><td>39725.356</td><td>43267.386</td></tr> <tr><td>39714.849</td><td>43277.864</td></tr> <tr><td>39704.365</td><td>43288.308</td></tr> <tr><td>39693.887</td><td>43298.826</td></tr> <tr><td>39691.665</td><td>43296.578</td></tr> <tr><td>39691.138</td><td>43296.120</td></tr> <tr><td>39685.282</td><td>43290.288</td></tr> <tr><td>39681.091</td><td>43285.940</td></tr> <tr><td>39670.897</td><td>43275.712</td></tr> <tr><td>39659.022</td><td>43263.796</td></tr> <tr><td>39650.101</td><td>43254.834</td></tr> <tr><td>39649.456</td><td>43254.299</td></tr> <tr><td>39644.302</td><td>43249.071</td></tr> <tr><td>39643.809</td><td>43248.503</td></tr> <tr><td>39634.938</td><td>43239.577</td></tr> <tr><td>39635.028</td><td>43231.506</td></tr> <tr><td>39643.544</td><td>43222.983</td></tr> <tr><td>39652.086</td><td>43214.486</td></tr> <tr><td>39662.352</td><td>43204.222</td></tr> <tr><td>39674.612</td><td>43216.487</td></tr> <tr><td>39688.150</td><td>43230.059</td></tr> <tr><td>39708.494</td><td>43250.449</td></tr> <tr><td>39725.356</td><td>43267.386</td></tr> </tbody> </table>	<i>Northing</i>	<i>Easting</i>	39725.356	43267.386	39714.849	43277.864	39704.365	43288.308	39693.887	43298.826	39691.665	43296.578	39691.138	43296.120	39685.282	43290.288	39681.091	43285.940	39670.897	43275.712	39659.022	43263.796	39650.101	43254.834	39649.456	43254.299	39644.302	43249.071	39643.809	43248.503	39634.938	43239.577	39635.028	43231.506	39643.544	43222.983	39652.086	43214.486	39662.352	43204.222	39674.612	43216.487	39688.150	43230.059	39708.494	43250.449	39725.356	43267.386
<i>Northing</i>	<i>Easting</i>																																																
39725.356	43267.386																																																
39714.849	43277.864																																																
39704.365	43288.308																																																
39693.887	43298.826																																																
39691.665	43296.578																																																
39691.138	43296.120																																																
39685.282	43290.288																																																
39681.091	43285.940																																																
39670.897	43275.712																																																
39659.022	43263.796																																																
39650.101	43254.834																																																
39649.456	43254.299																																																
39644.302	43249.071																																																
39643.809	43248.503																																																
39634.938	43239.577																																																
39635.028	43231.506																																																
39643.544	43222.983																																																
39652.086	43214.486																																																
39662.352	43204.222																																																
39674.612	43216.487																																																
39688.150	43230.059																																																
39708.494	43250.449																																																
39725.356	43267.386																																																

to the point of commencement.

THE SCHEDULE — *continued*

*First column*

*Second column*

The Authority

Protected Place

The boundaries of “LOYANG SUBSTATION” are more particularly delineated in the Survey Plan set out below.

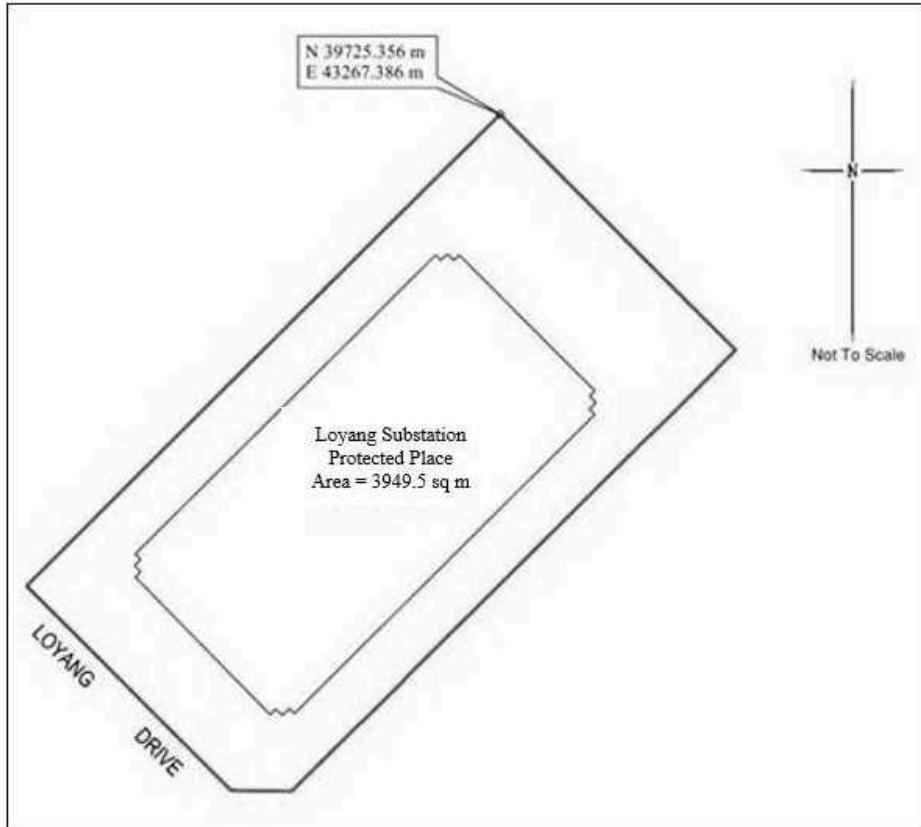

*First column*

*Second column*

The Authority

Protected Place

14. Chief Executive Officer, MAGAZINE SUBSTATION  
SP PowerGrid Ltd

All that area comprised in part of Lot 00490L pt in Town Subdivision No. 8 occupied by “MAGAZINE SUBSTATION” containing an area of about 1903.3 square metres and bounded approximately as follows:

THE SCHEDULE — *continued**First column**Second column*

The Authority

Protected Place

Commencing at a point 30249.398 metres North and 28987.484 metres East of the Singapore Land Authority SVY 21 Datum, the boundaries run along successive lines of coordinates approximately as follows:

<i>Northing</i>	<i>Easting</i>
30249.398	28987.484
30248.305	28989.284
30247.706	28992.292
30247.213	28994.354
30246.566	28997.053
30245.959	28999.012
30245.099	29001.673
30244.385	29003.625
30243.295	29006.181
30242.397	29008.120
30241.222	29010.478
30240.192	29012.348
30238.752	29014.763
30237.624	29016.479
30235.608	29018.464
30234.275	29020.026
30232.750	29022.084
30229.482	29025.759
30225.911	29029.081
30222.170	29032.125
30218.335	29035.506
30217.145	29037.321

THE SCHEDULE — *continued*

<i>First column</i>		<i>Second column</i>
The Authority		Protected Place
	30215.412	29036.181
	30212.466	29034.276
	30208.406	29031.641
	30202.091	29027.576
	30200.382	29026.470
	30198.057	29024.964
	30196.239	29023.782
	30194.885	29022.911
	30193.127	29021.764
	30195.530	29018.049
	30199.279	29012.250
	30203.429	29005.857
	30208.673	28997.746
	30213.926	28989.591
	30219.182	28981.476
	30224.214	28973.693
	30225.340	28971.937
	30227.115	28973.086
	30228.444	28973.952
	30230.194	28975.084
	30232.508	28976.577
	30234.250	28977.694
	30236.568	28979.198
	30238.309	28980.329
	30240.640	28981.832
	30242.391	28982.959
	30244.704	28984.455

THE SCHEDULE — *continued*

<i>First column</i>	<i>Second column</i>
The Authority	Protected Place
30246.448	28985.586
30247.619	28986.351

to the point of commencement.

The boundaries of “MAGAZINE SUBSTATION” are more particularly delineated in the Survey Plan set out below.

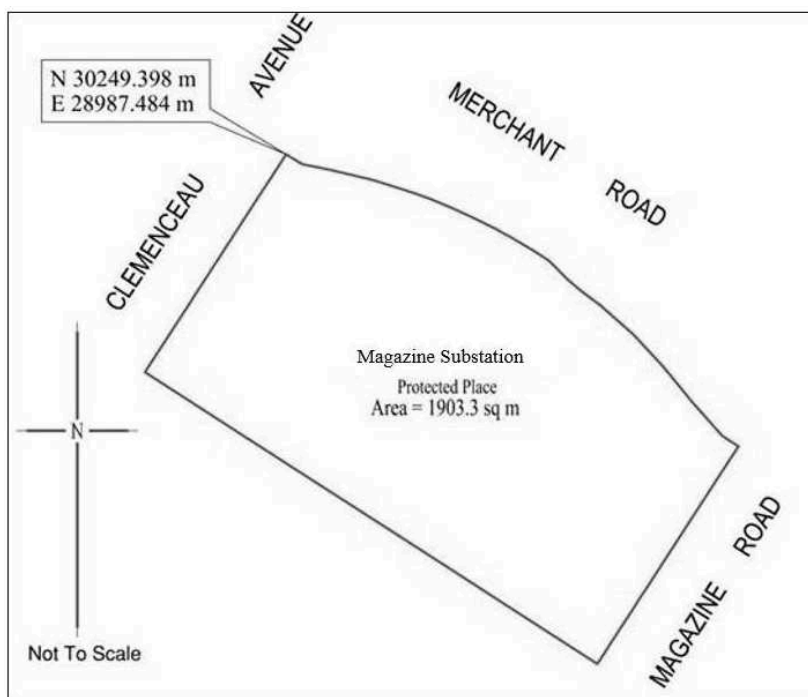

Made on 22 January 2024.

PANG KIN KEONG  
*Permanent Secretary,  
Ministry of Home Affairs,  
Singapore.*

[SPF/CPS/C/09/02/03; AG/LEGIS/SL/137B/2020/2 Vol. 15]