First published in the *Government Gazette*, Electronic Edition, on 30 January 2024 at 5 pm.

No. S 50

INFRASTRUCTURE PROTECTION ACT 2017

INFRASTRUCTURE PROTECTION (PROTECTED PLACES) (NO. 7) ORDER 2024

ARRANGEMENT OF PARAGRAPHS

Paragraph

1. Citation and commencement
 2. Premises declared to be protected places
 3. Revocations
- The Schedule
-

In exercise of the powers conferred by sections 14(1) and 19(1) of the Infrastructure Protection Act 2017, the Minister for Home Affairs makes the following Order:

Citation and commencement

1. This Order is the Infrastructure Protection (Protected Places) (No. 7) Order 2024 and comes into operation on 31 January 2024.

Premises declared to be protected places

2. The premises described in the second column of the Schedule are declared to be protected places for the purposes of the Act, and the person specified in the first column of that Schedule is designated as the authority of the corresponding protected place.

Revocations

3.—(1) In the Protected Places (No. 8) Order 2012 (G.N. No. S 453/2012), in the Schedule, delete items (7) and (20).

(2) In the Protected Places (No. 5) Order 2013 (G.N. No. S 306/2013), in the Schedule, delete items (1) and (2).

(3) In the Protected Places (No. 6) Order 2013 (G.N. No. S 307/2013), in the Schedule, delete items (1), (2) and (3).

(4) In the Protected Places (No. 8) Order 2013 (G.N. No. S 309/2013), in the Schedule, delete item (1).

(5) In the Protected Places (No. 6) Order 2014 (G.N. No. S 532/2014), in the Schedule, delete item (5).

(6) In the Protected Places (No. 4) Order 2018 (G.N. No. S 407/2018), in the Schedule, delete item (1).

THE SCHEDULE

Paragraph 2

<i>First column</i>	<i>Second column</i>																				
The Authority	Protected Place																				
1. Chief Executive Officer, SP PowerGrid Ltd	<p>AIDA STREET SUBSTATION</p> <p>All that area comprised in part of Lot 04053L in Mukim No. 27 occupied by “AIDA STREET SUBSTATION” containing an area of about 3535.3 square metres and bounded approximately as follows:</p> <p>Commencing at a point 33796.583 metres North and 38475.301 metres East of the Singapore Land Authority SVY 21 Datum, the boundaries run along successive lines of coordinates approximately as follows:</p> <table border="0" style="margin-left: auto; margin-right: auto;"> <thead> <tr> <th style="text-align: center;"><i>Northing</i></th> <th style="text-align: center;"><i>Easting</i></th> </tr> </thead> <tbody> <tr><td style="text-align: center;">33796.583</td><td style="text-align: center;">38475.301</td></tr> <tr><td style="text-align: center;">33772.642</td><td style="text-align: center;">38479.854</td></tr> <tr><td style="text-align: center;">33771.260</td><td style="text-align: center;">38478.812</td></tr> <tr><td style="text-align: center;">33764.499</td><td style="text-align: center;">38480.144</td></tr> <tr><td style="text-align: center;">33764.569</td><td style="text-align: center;">38480.467</td></tr> <tr><td style="text-align: center;">33764.079</td><td style="text-align: center;">38480.563</td></tr> <tr><td style="text-align: center;">33763.974</td><td style="text-align: center;">38480.073</td></tr> <tr><td style="text-align: center;">33758.073</td><td style="text-align: center;">38481.212</td></tr> <tr><td style="text-align: center;">33758.188</td><td style="text-align: center;">38481.706</td></tr> </tbody> </table>	<i>Northing</i>	<i>Easting</i>	33796.583	38475.301	33772.642	38479.854	33771.260	38478.812	33764.499	38480.144	33764.569	38480.467	33764.079	38480.563	33763.974	38480.073	33758.073	38481.212	33758.188	38481.706
<i>Northing</i>	<i>Easting</i>																				
33796.583	38475.301																				
33772.642	38479.854																				
33771.260	38478.812																				
33764.499	38480.144																				
33764.569	38480.467																				
33764.079	38480.563																				
33763.974	38480.073																				
33758.073	38481.212																				
33758.188	38481.706																				

THE SCHEDULE — *continued*

<i>First column</i>	<i>Second column</i>	
The Authority	Protected Place	
	33757.683	38481.813
	33757.603	38481.473
	33754.710	38482.016
	33754.138	38483.641
	33752.350	38484.034
	33737.217	38406.569
	33763.704	38401.434
	33781.485	38397.922
	33783.491	38407.648
	33787.217	38426.477
	33793.045	38456.615

to the point of commencement.

The boundaries of “AIDA STREET SUBSTATION” are more particularly delineated in the Survey Plan set out below.

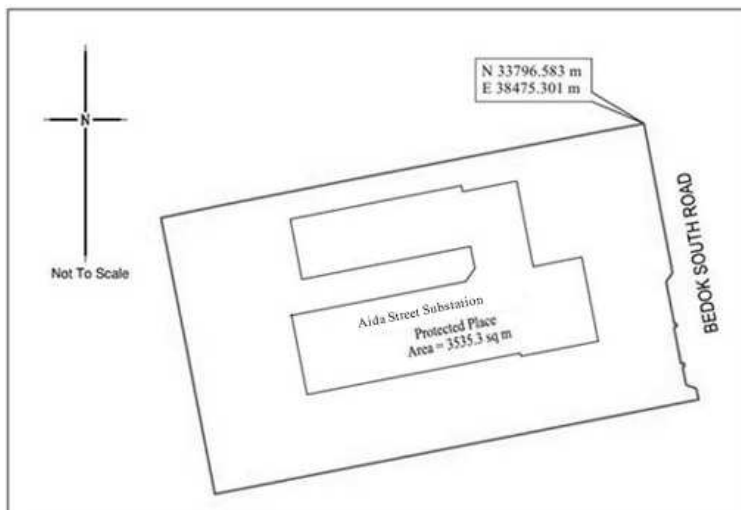

THE SCHEDULE — *continued*

<i>First column</i>	<i>Second column</i>																										
The Authority	Protected Place																										
2. Chief Executive Officer, SP PowerGrid Ltd	<p>ALJUNIED SUBSTATION</p> <p>All that area comprised in part of Lots 08130M and 06195N in Mukim No. 24 occupied by “ALJUNIED SUBSTATION” containing an area of about 2466.4 square metres and bounded approximately as follows:</p> <p>Commencing at a point 34712.675 metres North and 33097.491 metres East of the Singapore Land Authority SVY 21 Datum, the boundaries run along successive lines of coordinates approximately as follows:</p> <table border="0" style="margin-left: auto; margin-right: auto;"> <thead> <tr> <th style="text-align: center;"><i>Northing</i></th> <th style="text-align: center;"><i>Easting</i></th> </tr> </thead> <tbody> <tr><td style="text-align: center;">34712.675</td><td style="text-align: center;">33097.491</td></tr> <tr><td style="text-align: center;">34700.304</td><td style="text-align: center;">33100.946</td></tr> <tr><td style="text-align: center;">34694.938</td><td style="text-align: center;">33102.476</td></tr> <tr><td style="text-align: center;">34672.986</td><td style="text-align: center;">33108.657</td></tr> <tr><td style="text-align: center;">34667.513</td><td style="text-align: center;">33110.283</td></tr> <tr><td style="text-align: center;">34631.630</td><td style="text-align: center;">33122.888</td></tr> <tr><td style="text-align: center;">34622.611</td><td style="text-align: center;">33116.874</td></tr> <tr><td style="text-align: center;">34640.382</td><td style="text-align: center;">33092.119</td></tr> <tr><td style="text-align: center;">34640.329</td><td style="text-align: center;">33092.081</td></tr> <tr><td style="text-align: center;">34648.383</td><td style="text-align: center;">33081.259</td></tr> <tr><td style="text-align: center;">34664.319</td><td style="text-align: center;">33060.167</td></tr> <tr><td style="text-align: center;">34684.174</td><td style="text-align: center;">33075.453</td></tr> </tbody> </table> <p>to the point of commencement.</p> <p>The boundaries of “ALJUNIED SUBSTATION” are more particularly delineated in the Survey Plan set out below.</p>	<i>Northing</i>	<i>Easting</i>	34712.675	33097.491	34700.304	33100.946	34694.938	33102.476	34672.986	33108.657	34667.513	33110.283	34631.630	33122.888	34622.611	33116.874	34640.382	33092.119	34640.329	33092.081	34648.383	33081.259	34664.319	33060.167	34684.174	33075.453
<i>Northing</i>	<i>Easting</i>																										
34712.675	33097.491																										
34700.304	33100.946																										
34694.938	33102.476																										
34672.986	33108.657																										
34667.513	33110.283																										
34631.630	33122.888																										
34622.611	33116.874																										
34640.382	33092.119																										
34640.329	33092.081																										
34648.383	33081.259																										
34664.319	33060.167																										
34684.174	33075.453																										

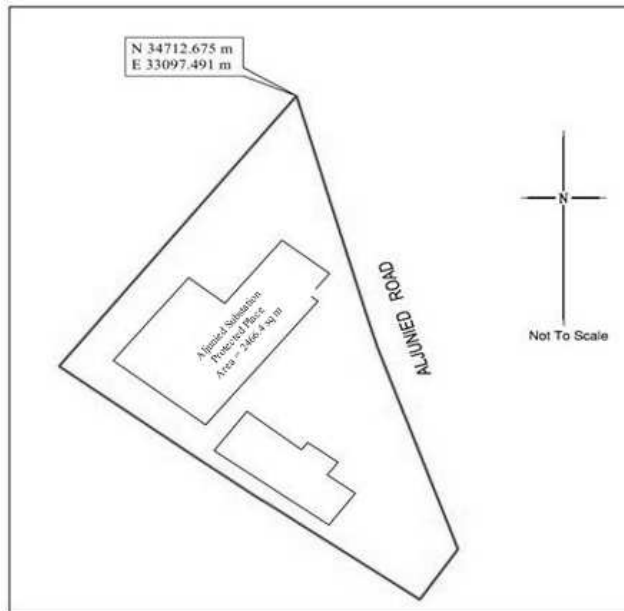
THE SCHEDULE — *continued**First column*

The Authority

Second column

Protected Place

3. Chief Executive Officer, SP PowerGrid Ltd ANG MO KIO SUBSTATION

All that area comprised in part of Lot 16904X in Mukim No. 18 occupied by “ANG MO KIO SUBSTATION” containing an area of about 5333.6 square metres and bounded approximately as follows:

Commencing at a point 39105.269 metres North and 30629.967 metres East of the Singapore Land Authority SVY 21 Datum, the boundaries run along successive lines of coordinates approximately as follows:

<i>Northing</i>	<i>Easting</i>
39105.269	30629.967
39105.343	30642.710
39105.422	30667.773
39105.397	30680.469
39105.501	30693.152

THE SCHEDULE — *continued*

<i>First column</i>		<i>Second column</i>
The Authority		Protected Place
	39105.416	30700.700
	39092.735	30700.933
	39080.027	30700.810
	39052.323	30700.774
	39039.743	30700.773
	39027.859	30700.710
	39030.131	30645.325
	39030.577	30638.370
	39032.783	30634.355
	39036.387	30631.598
	39038.530	30631.030
	39053.460	30630.581
	39078.726	30630.286
	39098.862	30629.954

to the point of commencement.

The boundaries of “ANG MO KIO SUBSTATION” are more particularly delineated in the Survey Plan set out below.

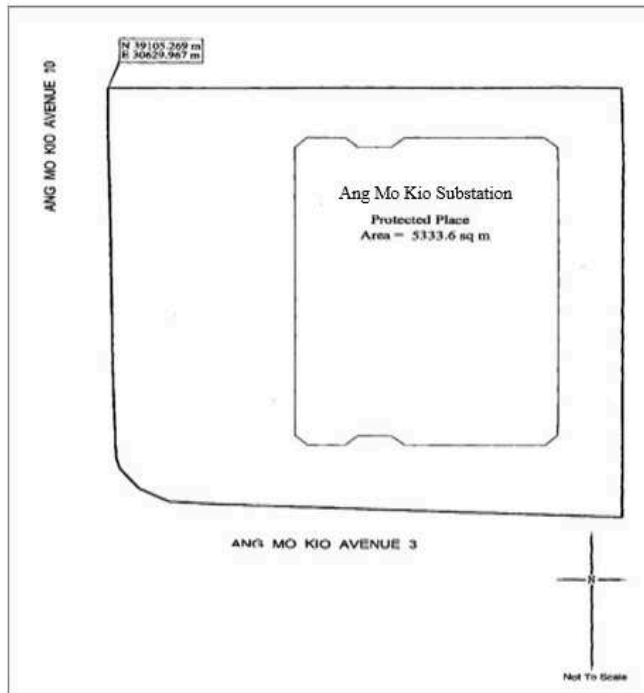
THE SCHEDULE — *continued**First column**Second column*

The Authority

Protected Place

4. Chief Executive Officer, NEW ARMENIAN STREET SUBSTATION
SP PowerGrid Ltd

All that area comprised in part of Lot 00156V in Town Subdivision No. 10 occupied by “NEW ARMENIAN STREET SUBSTATION” containing an area of about 722.8 square metres and bounded approximately as follows:

Commencing at a point 30747.772 metres North and 29843.604 metres East of the Singapore Land Authority SVY 21 Datum, the boundaries run along successive lines of coordinates approximately as follows:

<i>Northing</i>	<i>Easting</i>
30747.772	29843.604
30735.876	29865.316
30710.388	29850.770

THE SCHEDULE — *continued*

<i>First column</i>		<i>Second column</i>
The Authority		Protected Place
	30722.326	29829.113
	30722.607	29829.258
	30722.561	29829.347
	30739.137	29838.820
	30739.192	29838.732
	30742.428	29840.580
	30742.401	29840.636
	30747.439	29843.503
	30747.477	29843.438

to the point of commencement.

The boundaries of “NEW ARMENIAN STREET SUBSTATION” are more particularly delineated in the Survey Plan set out below.

THE SCHEDULE — *continued*

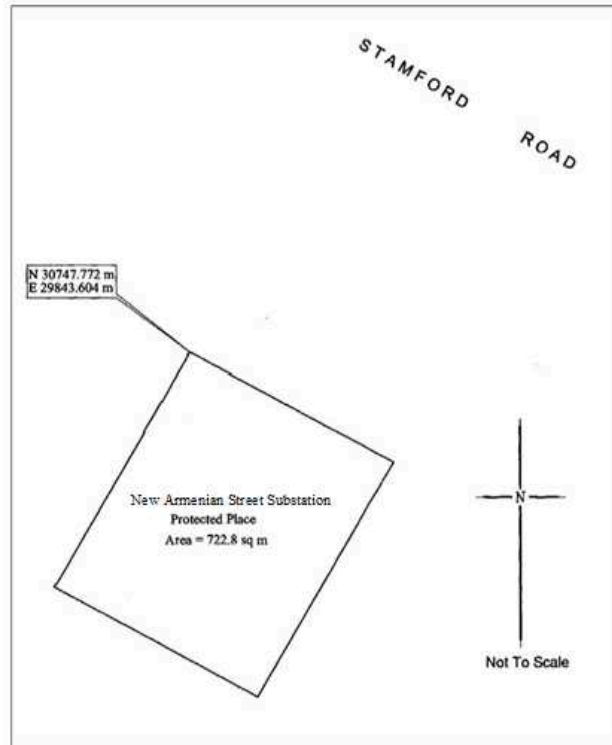

First column

Second column

The Authority

Protected Place

- | | |
|---|----------------------|
| 5. Chief Executive Officer,
SP PowerGrid Ltd | ATTAP VALLEY STATION |
|---|----------------------|

All that area comprised in part of Lot 05407W in Mukim No. 13 occupied by “ATTAP VALLEY STATION” containing an area of about 5991.8 square metres and bounded approximately as follows:

Commencing at a point 49256.281 metres North and 23336.585 metres East of the Singapore Land Authority SVY 21 Datum, the boundaries run along successive lines of coordinates approximately as follows:

<i>Northing</i>	<i>Easting</i>
49256.281	23336.585
49254.440	23337.797

 THE SCHEDULE — *continued*

<i>First column</i>		<i>Second column</i>
The Authority		Protected Place
	49240.210	23347.169
	49171.663	23392.254
	49195.515	23429.248
	49108.200	23486.641
	49108.097	23533.123
	49114.090	23532.589
	49114.183	23492.535
	49114.296	23491.504
	49114.614	23490.502
	49115.124	23489.594
	49115.809	23488.809
	49255.622	23396.922
	49281.922	23379.650
	49288.879	23374.767
	49277.086	23368.847

to the point of commencement.

The boundaries of “ATTAP VALLEY STATION” are more particularly delineated in the Survey Plan set out below.

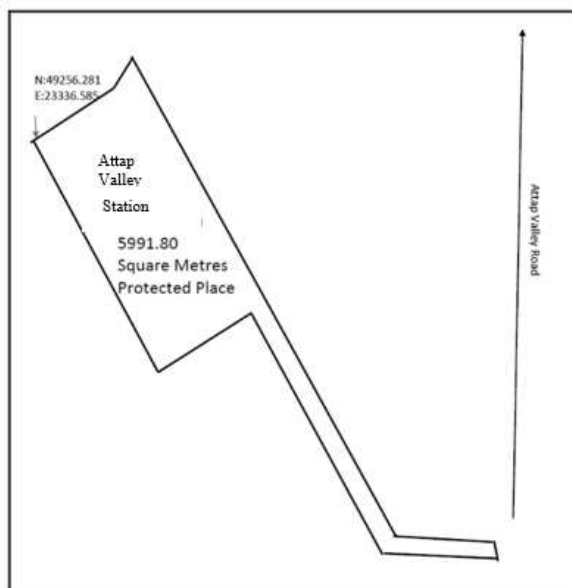
THE SCHEDULE — *continued**First column**Second column*

The Authority

Protected Place

6. Chief Executive Officer, SP PowerGrid Ltd BANYAN DRIVE SUBSTATION

All that area comprised in part of Lot 01124P in Mukim No. 34 occupied by “BANYAN DRIVE SUBSTATION” containing an area of about 2603.4 square metres and bounded approximately as follows:

Commencing at a point 27082.813 metres North and 10353.505 metres East of the Singapore Land Authority SVY 21 Datum, the boundaries run along successive lines of coordinates approximately as follows:

<i>Northing</i>	<i>Easting</i>
27082.813	10353.505
27116.706	10400.618
27080.357	10426.767
27046.338	10379.660

to the point of commencement.

THE SCHEDULE — *continued**First column**Second column*

The Authority

Protected Place

The boundaries of “BANYAN DRIVE SUBSTATION” are more particularly delineated in the Survey Plan set out below.

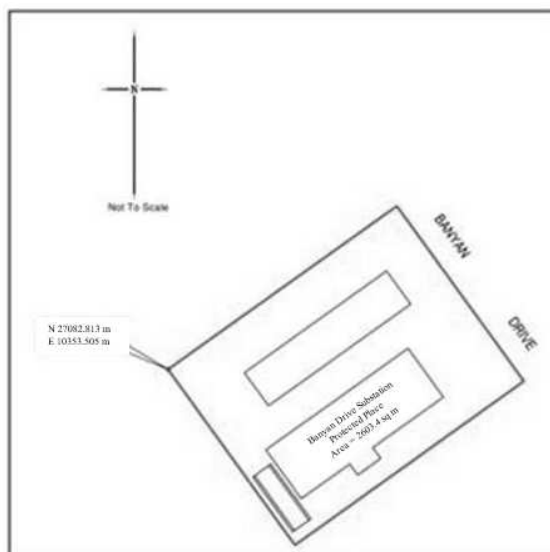
*First column**Second column*

The Authority

Protected Place

7. Chief Executive Officer,
SP PowerGrid Ltd

BEDOK SUBSTATION

All that area comprised in part of Lots 06911T and 02524W in Mukim No. 28 occupied by “BEDOK SUBSTATION” containing an area of about 5130.6 square metres and bounded approximately as follows:

Commencing at a point 35106.263 metres North and 39103.645 metres East of the Singapore Land Authority SVY 21 Datum, the boundaries run along successive lines of coordinates approximately as follows:

<i>Northing</i>	<i>Easting</i>
35106.263	39103.645

 THE SCHEDULE — *continued*

<i>First column</i>	<i>Second column</i>
The Authority	Protected Place
35109.713	39120.510
35112.119	39132.782
35118.199	39164.790
35108.403	39166.625
35088.850	39169.978
35066.885	39173.630
35050.357	39176.278
35050.280	39176.290
35043.173	39177.527
35042.971	39177.562
35036.000	39178.775
35028.663	39141.642
35024.428	39119.570
35042.638	39115.987
35085.029	39107.711

to the point of commencement.

The boundaries of “BEDOK SUBSTATION” are more particularly delineated in the Survey Plan set out below.

THE SCHEDULE — *continued*

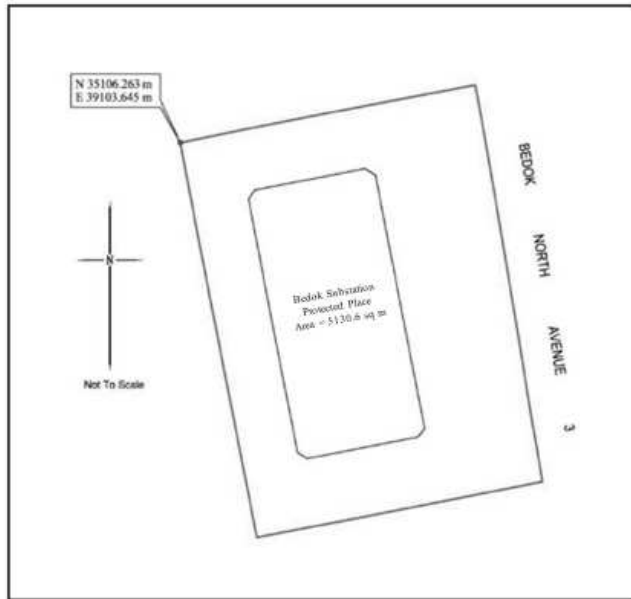

First column

Second column

The Authority

Protected Place

8. Chief Executive Officer, SP PowerGrid Ltd BOON LAY WAY SUBSTATION

All that area comprised in part of Lot 06691A in Mukim No. 5 occupied by “BOON LAY WAY SUBSTATION” containing an area of about 5289.6 square metres and bounded approximately as follows:

Commencing at a point 34767.191 metres North and 18620.918 metres East of the Singapore Land Authority SVY 21 Datum, the boundaries run along successive lines of coordinates approximately as follows:

<i>Northing</i>	<i>Easting</i>
34767.191	18620.918
34768.464	18632.032
34769.450	18642.553
34770.145	18647.765
34729.154	18652.102

 THE SCHEDULE — *continued*

<i>First column</i>		<i>Second column</i>
The Authority		Protected Place
	34709.615	18654.231
	34690.944	18656.771
	34684.829	18657.652
	34681.770	18658.063
	34672.131	18659.380
	34654.286	18661.871
	34644.080	18663.190
	34655.057	18650.747
	34663.117	18641.729
	34663.314	18641.560
	34664.293	18640.434
	34664.478	18640.234
	34667.638	18636.487
	34672.550	18631.169
	34673.037	18630.607
	34676.931	18626.181
	34677.377	18625.613
	34680.838	18621.702
	34712.461	18585.597
	34720.175	18579.096
	34738.083	18595.420
	34740.426	18597.250
	34742.780	18599.251
	34760.438	18614.810

to the point of commencement.

THE SCHEDULE — *continued**First column**Second column*

The Authority

Protected Place

The boundaries of “BOON LAY WAY SUBSTATION” are more particularly delineated in the Survey Plan set out below.

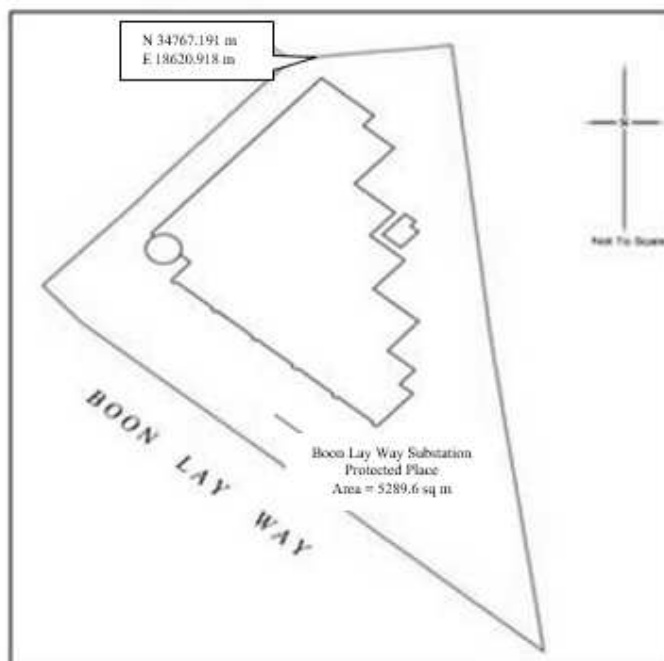
*First column**Second column*

The Authority

Protected Place

9. Chief Executive
Officer,
SP PowerGrid Ltd

BUKIT BATOK CRESCENT SUBSTATION

All that area comprised in Lot 07741L in Mukim No. 5 occupied by “BUKIT BATOK CRESCENT SUBSTATION” containing an area of about 1428.2 square metres and bounded approximately as follows:

Commencing at a point 35647.144 metres North and 19382.779 metres East of the Singapore Land Authority SVY 21 Datum, the boundaries run along successive lines of coordinates approximately as follows:

THE SCHEDULE — *continued*

<i>First column</i>	<i>Second column</i>	
The Authority	Protected Place	
	<i>Northing</i>	<i>Easting</i>
	35647.144	19382.779
	35601.039	19356.853
	35614.281	19333.322
	35660.377	19359.246

to the point of commencement.

The boundaries of “BUKIT BATOK CRESCENT SUBSTATION” are more particularly delineated in the Survey Plan set out below.

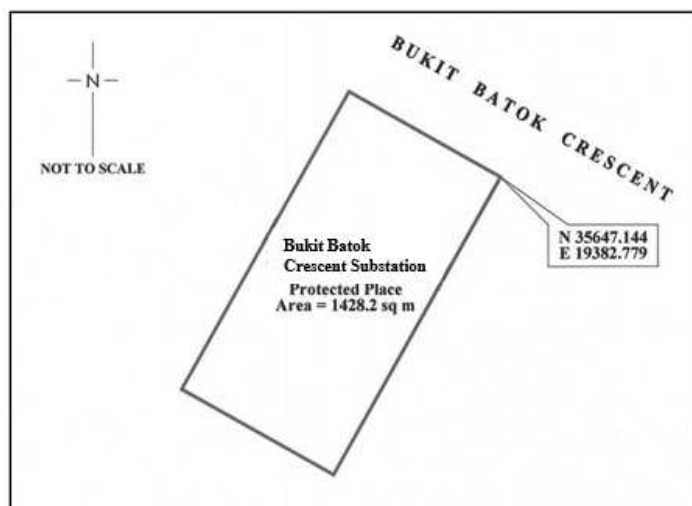

<i>First column</i>	<i>Second column</i>
The Authority	Protected Place

10. Chief Executive Officer, BUKIT BATOK SUBSTATION
SP PowerGrid Ltd

All that area comprised in part of Lot 06661K in Mukim No. 5 occupied by “BUKIT BATOK SUBSTATION” containing an area of about 3928.8 square metres and bounded approximately as follows:

THE SCHEDULE — *continued**First column**Second column*

The Authority

Protected Place

Commencing at a point 35984.016 metres North and 19283.250 metres East of the Singapore Land Authority SVY 21 Datum, the boundaries run along successive lines of coordinates approximately as follows:

<i>Northing</i>	<i>Easting</i>
35984.016	19283.250
35983.923	19283.416
35975.331	19298.700
35964.246	19318.373
35953.274	19337.916
35953.160	19338.120
35952.976	19338.016
35934.008	19327.300
35910.228	19314.012
35906.266	19311.784
35906.141	19311.713
35906.200	19311.608
35909.758	19305.314
35909.825	19305.200
35912.889	19299.680
35912.969	19299.542
35920.501	19286.144
35929.258	19270.578
35929.316	19270.460
35932.419	19264.922
35932.465	19264.818
35938.402	19254.319

THE SCHEDULE — *continued*

<i>First column</i>	<i>Second column</i>	
The Authority	Protected Place	
	35946.645	19239.609
	35946.877	19239.789
	35959.708	19254.766
	35974.266	19271.844
	35983.869	19283.078

to the point of commencement.

The boundaries of “BUKIT BATOK SUBSTATION” are more particularly delineated in the Survey Plan set out below.

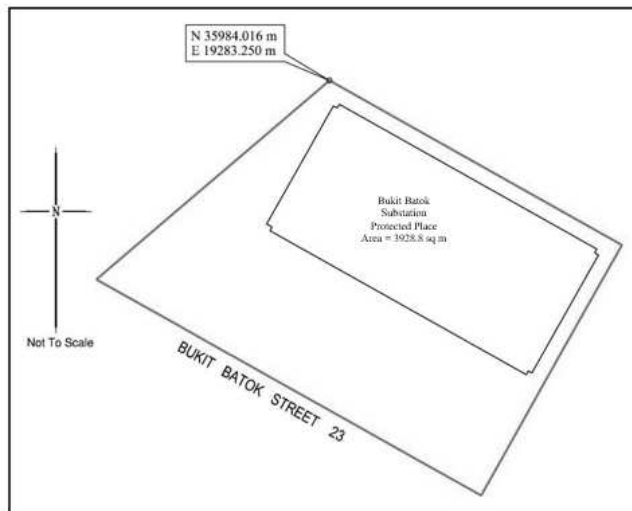

Made on 22 January 2024.

PANG KIN KEONG
*Permanent Secretary,
Ministry of Home Affairs,
Singapore.*

[SPF/CPS/C/09/02/03; AG/LEGIS/SL/137B/2020/2 Vol. 15]