First published in the *Government Gazette*, Electronic Edition, on 1st September 2014 at 5:00 pm.

No. S 577

**PROTECTED AREAS AND PROTECTED PLACES ACT
(CHAPTER 256)**

PROTECTED PLACES (NO. 7) ORDER 2014

ARRANGEMENT OF PARAGRAPHS

Paragraph

1. Citation and commencement
 2. Premises declared to be protected place
 3. Revocation
The Schedule
-

In exercise of the powers conferred by section 5(1) of the Protected Areas and Protected Places Act, the Minister for Home Affairs hereby makes the following Order:

Citation and commencement

1. This Order may be cited as the Protected Places (No. 7) Order 2014 and shall come into operation on 1 September 2014.

Premises declared to be protected place

2. The premises described in the second column of the Schedule are hereby declared to be a protected place for the purposes of the Act, and no person shall be in those premises unless he is in possession of a pass-card or permit issued by the authority specified in the first column of the Schedule or has received permission of an authorised officer on duty at the premises to enter the premises.

Revocation

3. The Protected Places (No. 5) Order 2012 (G.N. No. S 353/2012) is revoked.

 THE SCHEDULE

<i>First column</i>	<i>Second column</i>
The Authority	Protected Place
VP/GM ST Aerospace Engineering Pte Ltd	ST AEROSPACE ENGINEERING PTE LTD (SELETAR)

All that area comprised in Land Lots 04376C and 04566X in Mukim No. 20 occupied by “ST AEROSPACE ENGINEERING PTE LTD (SELETAR)” containing an area of about 61746.770 square metres and bounded approximately as follows:

Commencing at a point of the aforesaid “ST AEROSPACE ENGINEERING PTE LTD (SELETAR)” which point is 44257.588 metres North and 31191.982 metres East of the Singapore Land Authority SVY 21 Datum, the boundaries run along successive lines of co-ordinates approximately as follows:

<i>Northing</i>	<i>Easting</i>
44257.588	31191.982
44263.199	31192.510
44286.528	31195.815
44273.840	31214.820
44370.899	31279.618
44373.675	31275.460
44392.980	31288.348
44402.073	31274.729
44412.875	31281.940
44411.382	31284.176
44420.947	31290.561
44411.713	31304.292
44464.109	31339.373
44455.377	31352.261

 THE SCHEDULE — *continued*

<i>First column</i>		<i>Second column</i>
The Authority		Protected Place
	44450.485	31349.022
	44442.035	31361.566
	44457.348	31371.782
	44456.283	31373.844
	44462.340	31378.211
	44466.009	31380.857
	44471.527	31383.411
	44474.709	31382.518
	44482.123	31387.046
	44484.018	31391.418
	44473.834	31416.800
	44492.636	31423.228
	44481.428	31454.183
	44479.282	31462.839
	44476.985	31463.344
	44476.558	31465.768
	44475.768	31468.085
	44465.244	31484.501
	44464.601	31486.807
	44463.706	31489.109
	44450.493	31509.333
	44429.117	31542.012
	44409.685	31529.272
	44355.864	31494.058
	44333.587	31479.431
	44306.803	31462.116
	44304.485	31461.538

 THE SCHEDULE — *continued*

<i>First column</i>	<i>Second column</i>
The Authority	Protected Place
44278.549	31444.637
44277.089	31442.660
44250.575	31425.352
44248.098	31425.286
44217.766	31405.610
44216.132	31407.879
44213.966	31409.081
44206.595	31404.269
44191.360	31394.936
44182.334	31389.001
44138.753	31360.719
44168.871	31314.236
44174.019	31307.416
44185.559	31291.258
44190.300	31289.637
44190.492	31289.708
44198.858	31276.756
44200.824	31276.233
44223.730	31242.235

to the point of commencement.

The boundaries of “ST AEROSPACE ENGINEERING PTE LTD (SELETAR)” are more particularly delineated in the Survey Plan set out below.

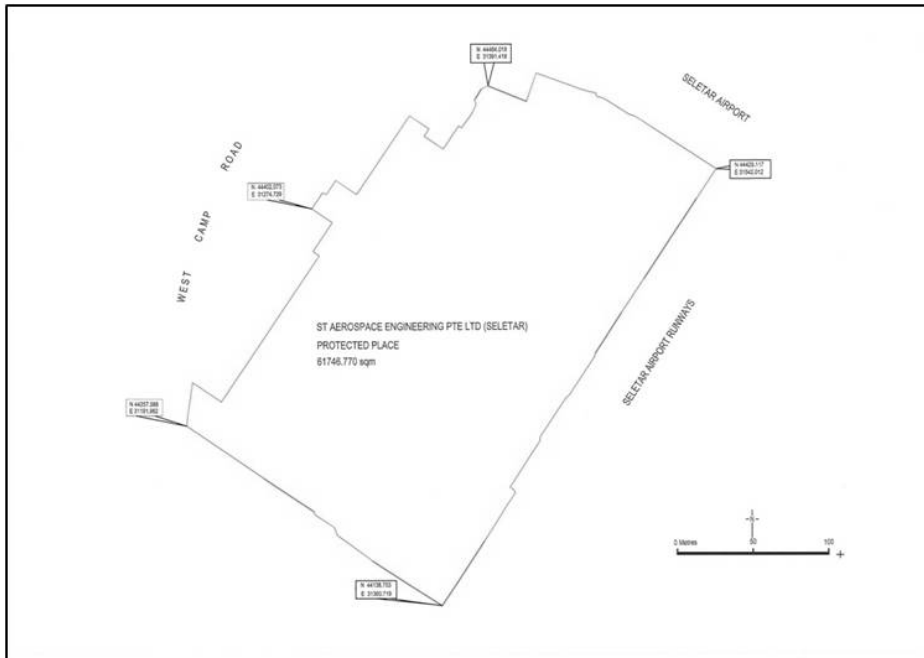
THE SCHEDULE — *continued*

Made on 28 August 2014.

TAN TEE HOW
*Permanent Secretary,
Ministry of Home Affairs,
Singapore.*

[MHA (PS) 12/2/010 TF 4; CP/C/198/39/1 V29; AG/LLRD/SL/256/2010/1 Vol. 8]