

---

---

First published in the *Government Gazette*, Electronic Edition, on 23 February 2023 at 5 pm.

## No. S 99

### INFRASTRUCTURE PROTECTION ACT 2017

#### INFRASTRUCTURE PROTECTION (PROTECTED PLACES) (NO. 6) ORDER 2023

##### ARRANGEMENT OF PARAGRAPHS

##### Paragraph

1. Citation and commencement
  2. Premises declared to be protected places
  3. Revocations
- The Schedule
- 

In exercise of the powers conferred by sections 14(1) and 19(1) of the Infrastructure Protection Act 2017, the Minister for Home Affairs makes the following Order:

#### **Citation and commencement**

1. This Order is the Infrastructure Protection (Protected Places) (No. 6) Order 2023 and comes into operation on 24 February 2023.

#### **Premises declared to be protected places**

2. The premises described in the second column of the Schedule are declared to be protected places for the purposes of the Act, and the person specified in the first column of that Schedule is designated as the authority of the corresponding protected place.

#### **Revocations**

3. In the Protected Places (No. 10) Order 2013 (G.N. No. S 311/2013), in the Schedule, delete items (1), (2), (3) and (7) to (13).

---



---

THE SCHEDULE

Paragraph 2

<i>First column</i>	<i>Second column</i>
The Authority	Protected Place
1. Chief Executive Officer, SP PowerGrid Ltd	PART OF 1 <sup>st</sup> STOREY BIOPOLIS BUONA VISTA SUBSTATION

All that area comprised in part of Lot 04931M in Mukim No. 3 occupied by “PART OF 1<sup>st</sup> STOREY BIOPOLIS BUONA VISTA SUBSTATION” containing an area of about 1112.1 square metres and bounded approximately as follows:

Commencing at a point 31762.778 metres North and 23515.939 metres East of the Singapore Land Authority SVY 21 Datum, the boundaries run along successive lines of coordinates approximately as follows:

<i>Northing</i>	<i>Easting</i>
31762.778	23515.939
31759.930	23526.565
31753.419	23526.565
31751.776	23527.374
31756.282	23535.777
31725.473	23552.174
31723.525	23548.585
31719.012	23551.007
31714.023	23541.520
31713.425	23541.845
31709.420	23534.251
31724.942	23525.922
31724.942	23523.043
31730.418	23523.045
31730.439	23515.952

to the point of commencement.

THE SCHEDULE — *continued**First column**Second column*

The Authority

Protected Place

The boundaries of “PART OF 1<sup>ST</sup> STOREY BIOPOLIS BUONA VISTA SUBSTATION” are more particularly delineated in the Survey Plan set out below.

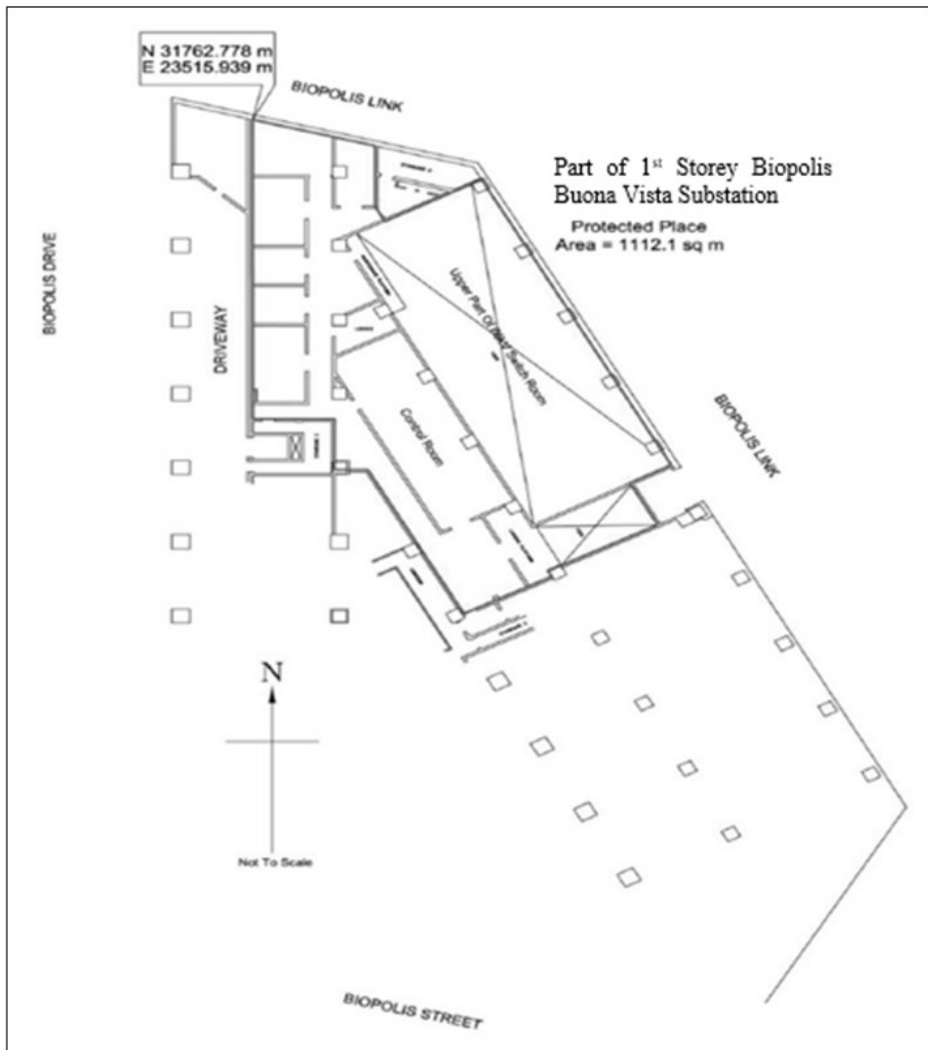

THE SCHEDULE — *continued*

<i>First column</i>	<i>Second column</i>																												
The Authority	Protected Place																												
2. Chief Executive Officer, SP PowerGrid Ltd	<p>PART OF 1<sup>st</sup> BASEMENT BIOPOLIS BUONA VISTA SUBSTATION</p> <p>All that area comprised in part of Lot 04931M in Mukim No. 3 occupied by “PART OF 1<sup>st</sup> BASEMENT BIOPOLIS BUONA VISTA SUBSTATION” containing an area of about 916.6 square metres and bounded approximately as follows:</p> <p>Commencing at a point 31761.090 metres North and 23522.975 metres East of the Singapore Land Authority SVY 21 Datum, the boundaries run along successive lines of coordinates approximately as follows:</p> <table border="0" style="margin-left: auto; margin-right: auto;"> <thead> <tr> <th style="text-align: left;"><i>Northing</i></th> <th style="text-align: left;"><i>Easting</i></th> </tr> </thead> <tbody> <tr><td>31761.090</td><td>23522.975</td></tr> <tr><td>31760.130</td><td>23526.565</td></tr> <tr><td>31751.349</td><td>23526.563</td></tr> <tr><td>31756.305</td><td>23535.926</td></tr> <tr><td>31729.925</td><td>23550.005</td></tr> <tr><td>31727.969</td><td>23546.412</td></tr> <tr><td>31719.085</td><td>23551.142</td></tr> <tr><td>31713.957</td><td>23541.396</td></tr> <tr><td>31713.488</td><td>23541.651</td></tr> <tr><td>31709.295</td><td>23533.949</td></tr> <tr><td>31724.686</td><td>23525.727</td></tr> <tr><td>31724.658</td><td>23520.325</td></tr> <tr><td>31730.446</td><td>23520.315</td></tr> </tbody> </table>	<i>Northing</i>	<i>Easting</i>	31761.090	23522.975	31760.130	23526.565	31751.349	23526.563	31756.305	23535.926	31729.925	23550.005	31727.969	23546.412	31719.085	23551.142	31713.957	23541.396	31713.488	23541.651	31709.295	23533.949	31724.686	23525.727	31724.658	23520.325	31730.446	23520.315
<i>Northing</i>	<i>Easting</i>																												
31761.090	23522.975																												
31760.130	23526.565																												
31751.349	23526.563																												
31756.305	23535.926																												
31729.925	23550.005																												
31727.969	23546.412																												
31719.085	23551.142																												
31713.957	23541.396																												
31713.488	23541.651																												
31709.295	23533.949																												
31724.686	23525.727																												
31724.658	23520.325																												
31730.446	23520.315																												

THE SCHEDULE — *continued*

*First column*

*Second column*

The Authority

Protected Place

31730.437

23514.804

31732.690

23514.808

31732.677

23522.973

to the point of commencement.

The boundaries of “PART OF 1<sup>ST</sup> BASEMENT BIOPOLIS BUONA VISTA SUBSTATION” are more particularly delineated in the Survey Plan set out below.

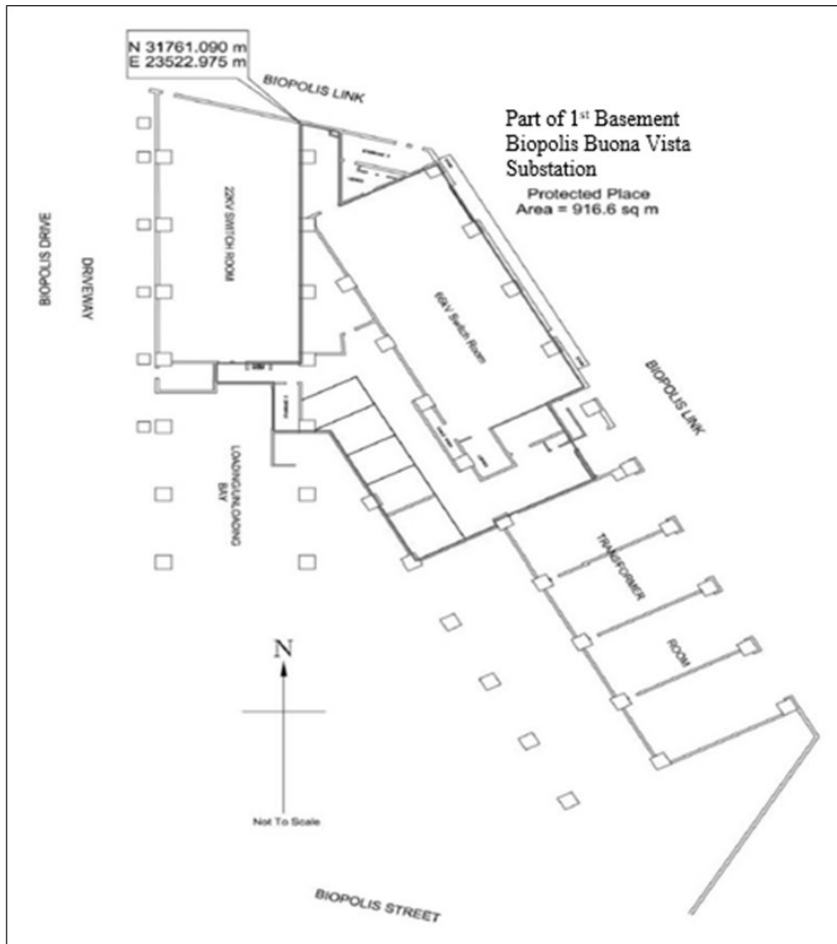

THE SCHEDULE — *continued*

<i>First column</i>	<i>Second column</i>																																		
The Authority	Protected Place																																		
3. Chief Executive Officer, SP PowerGrid Ltd	<p>PART OF 2<sup>nd</sup> BASEMENT BIOPOLIS BUONA VISTA SUBSTATION</p> <p>All that area comprised in part of Lot 04931M in Mukim No. 3 occupied by “PART OF 2<sup>nd</sup> BASEMENT BIOPOLIS BUONA VISTA SUBSTATION” containing an area of about 1330.3 square metres and bounded approximately as follows:</p> <p>Commencing at a point 31764.563 metres North and 23509.280 metres East of the Singapore Land Authority SVY 21 Datum, the boundaries run along successive lines of coordinates approximately as follows:</p> <table border="0" style="margin-left: auto; margin-right: auto;"> <thead> <tr> <th style="text-align: left;"><i>Northing</i></th> <th style="text-align: left;"><i>Easting</i></th> </tr> </thead> <tbody> <tr><td>31764.563</td><td>23509.280</td></tr> <tr><td>31759.930</td><td>23526.565</td></tr> <tr><td>31753.210</td><td>23526.565</td></tr> <tr><td>31751.762</td><td>23527.347</td></tr> <tr><td>31756.223</td><td>23535.808</td></tr> <tr><td>31730.068</td><td>23549.732</td></tr> <tr><td>31728.854</td><td>23547.503</td></tr> <tr><td>31720.034</td><td>23552.304</td></tr> <tr><td>31714.202</td><td>23541.263</td></tr> <tr><td>31713.148</td><td>23541.836</td></tr> <tr><td>31711.655</td><td>23539.026</td></tr> <tr><td>31711.567</td><td>23539.073</td></tr> <tr><td>31709.092</td><td>23534.413</td></tr> <tr><td>31724.711</td><td>23526.078</td></tr> <tr><td>31724.658</td><td>23520.325</td></tr> <tr><td>31730.446</td><td>23520.325</td></tr> </tbody> </table>	<i>Northing</i>	<i>Easting</i>	31764.563	23509.280	31759.930	23526.565	31753.210	23526.565	31751.762	23527.347	31756.223	23535.808	31730.068	23549.732	31728.854	23547.503	31720.034	23552.304	31714.202	23541.263	31713.148	23541.836	31711.655	23539.026	31711.567	23539.073	31709.092	23534.413	31724.711	23526.078	31724.658	23520.325	31730.446	23520.325
<i>Northing</i>	<i>Easting</i>																																		
31764.563	23509.280																																		
31759.930	23526.565																																		
31753.210	23526.565																																		
31751.762	23527.347																																		
31756.223	23535.808																																		
31730.068	23549.732																																		
31728.854	23547.503																																		
31720.034	23552.304																																		
31714.202	23541.263																																		
31713.148	23541.836																																		
31711.655	23539.026																																		
31711.567	23539.073																																		
31709.092	23534.413																																		
31724.711	23526.078																																		
31724.658	23520.325																																		
31730.446	23520.325																																		

THE SCHEDULE — *continued**First column**Second column*

The Authority

Protected Place

31730.437

23514.804

31732.737

23514.808

31732.733

23509.314

to the point of commencement.

The boundaries of “PART OF 2<sup>nd</sup> BASEMENT BIOPOLIS BUONA VISTA SUBSTATION” are more particularly delineated in the Survey Plan set out below.

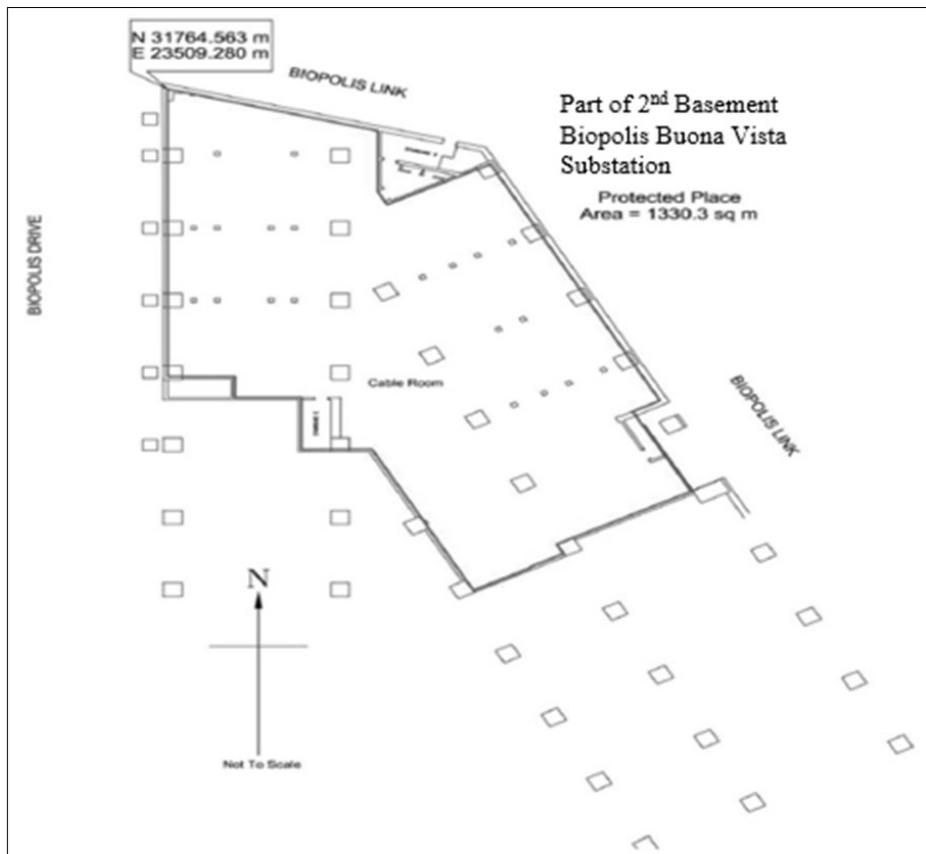

THE SCHEDULE — *continued*

<i>First column</i>	<i>Second column</i>																														
The Authority	Protected Place																														
4. Chief Executive Officer, SP PowerGrid Ltd	<p>PART OF 1<sup>st</sup> STOREY PANDAN LOOP SUBSTATION</p> <p>All that area comprised in part of Lot 06855X in Mukim No. 5 occupied by “PART OF 1<sup>st</sup> STOREY PANDAN LOOP SUBSTATION” containing an area of about 512.9 square metres and bounded approximately as follows:</p> <p>Commencing at a point 32483.672 metres North and 18902.838 metres East of the Singapore Land Authority SVY 21 Datum, the boundaries run along successive lines of coordinates approximately as follows:</p> <table border="0" style="margin-left: auto; margin-right: auto;"> <thead> <tr> <th style="text-align: left;"><i>Northing</i></th> <th style="text-align: left;"><i>Easting</i></th> </tr> </thead> <tbody> <tr><td>32483.672</td><td>18902.838</td></tr> <tr><td>32488.684</td><td>18907.714</td></tr> <tr><td>32491.506</td><td>18904.814</td></tr> <tr><td>32493.117</td><td>18906.382</td></tr> <tr><td>32494.837</td><td>18904.613</td></tr> <tr><td>32495.332</td><td>18905.095</td></tr> <tr><td>32495.703</td><td>18904.713</td></tr> <tr><td>32496.415</td><td>18905.406</td></tr> <tr><td>32496.450</td><td>18907.156</td></tr> <tr><td>32489.470</td><td>18914.331</td></tr> <tr><td>32494.243</td><td>18918.975</td></tr> <tr><td>32479.276</td><td>18934.359</td></tr> <tr><td>32470.802</td><td>18926.115</td></tr> <tr><td>32468.006</td><td>18928.989</td></tr> </tbody> </table>	<i>Northing</i>	<i>Easting</i>	32483.672	18902.838	32488.684	18907.714	32491.506	18904.814	32493.117	18906.382	32494.837	18904.613	32495.332	18905.095	32495.703	18904.713	32496.415	18905.406	32496.450	18907.156	32489.470	18914.331	32494.243	18918.975	32479.276	18934.359	32470.802	18926.115	32468.006	18928.989
<i>Northing</i>	<i>Easting</i>																														
32483.672	18902.838																														
32488.684	18907.714																														
32491.506	18904.814																														
32493.117	18906.382																														
32494.837	18904.613																														
32495.332	18905.095																														
32495.703	18904.713																														
32496.415	18905.406																														
32496.450	18907.156																														
32489.470	18914.331																														
32494.243	18918.975																														
32479.276	18934.359																														
32470.802	18926.115																														
32468.006	18928.989																														



THE SCHEDULE — *continued*

<i>First column</i>	<i>Second column</i>
The Authority	Protected Place
	32464.725                      18925.797
	32464.522                      18926.006
	32462.780                      18924.312

to the point of commencement.

The boundaries of “PART OF 1<sup>ST</sup> STOREY PANDAN LOOP SUBSTATION” are more particularly delineated in the Survey Plan set out below.

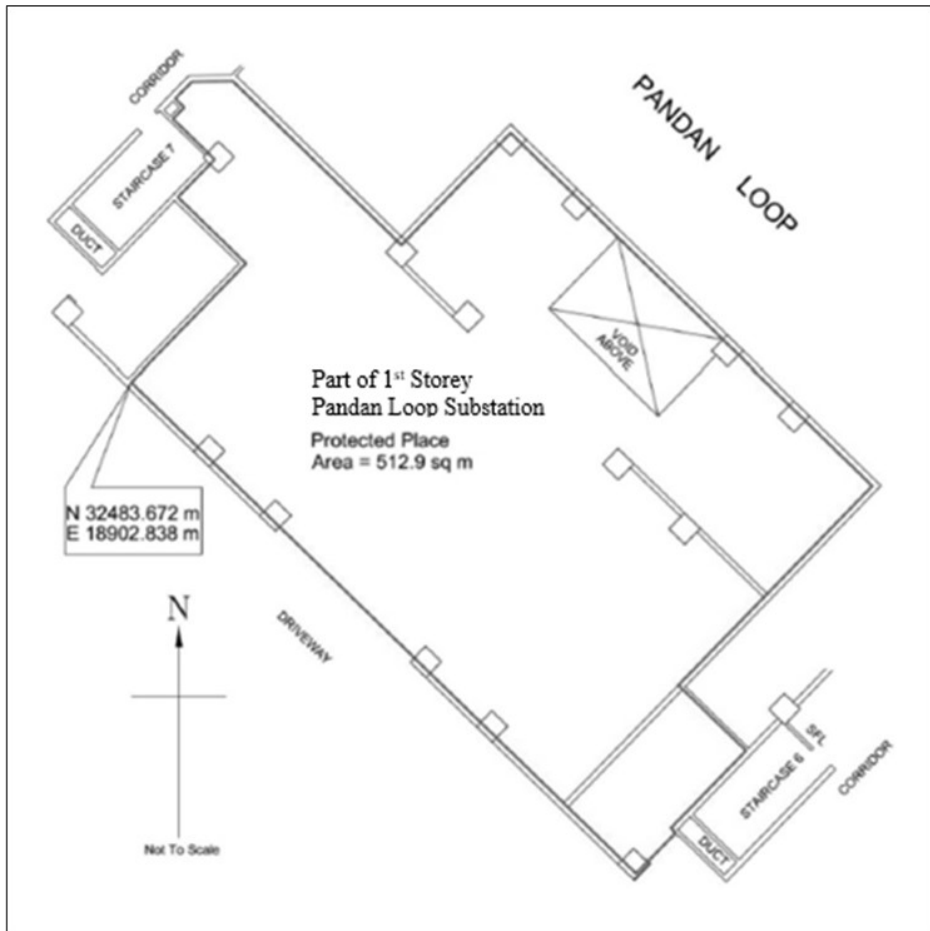

THE SCHEDULE — *continued*

<i>First column</i>	<i>Second column</i>																										
The Authority	Protected Place																										
5. Chief Executive Officer, SP PowerGrid Ltd	<p>PART OF 1<sup>st</sup> MEZZANINE PANDAN LOOP SUBSTATION</p> <p>All that area comprised in part of Lot 06855X in Mukim No. 5 occupied by “PART OF 1<sup>st</sup> MEZZANINE PANDAN LOOP SUBSTATION” containing an area of about 47.2 square metres and bounded approximately as follows:</p> <p>Commencing at a point 32486.611 metres North and 18899.816 metres East of the Singapore Land Authority SVY 21 Datum, the boundaries run along successive lines of coordinates approximately as follows:</p> <table border="0" style="margin-left: auto; margin-right: auto;"> <thead> <tr> <th style="text-align: left;"><i>Northing</i></th> <th style="text-align: left;"><i>Easting</i></th> </tr> </thead> <tbody> <tr><td>32486.611</td><td>18899.816</td></tr> <tr><td>32488.374</td><td>18901.532</td></tr> <tr><td>32488.270</td><td>18901.639</td></tr> <tr><td>32493.603</td><td>18906.827</td></tr> <tr><td>32495.778</td><td>18904.591</td></tr> <tr><td>32497.484</td><td>18906.251</td></tr> <tr><td>32495.594</td><td>18908.193</td></tr> <tr><td>32494.698</td><td>18907.321</td></tr> <tr><td>32493.095</td><td>18908.970</td></tr> <tr><td>32492.098</td><td>18908.001</td></tr> <tr><td>32490.721</td><td>18909.417</td></tr> <tr><td>32483.811</td><td>18902.695</td></tr> </tbody> </table> <p>to the point of commencement.</p>	<i>Northing</i>	<i>Easting</i>	32486.611	18899.816	32488.374	18901.532	32488.270	18901.639	32493.603	18906.827	32495.778	18904.591	32497.484	18906.251	32495.594	18908.193	32494.698	18907.321	32493.095	18908.970	32492.098	18908.001	32490.721	18909.417	32483.811	18902.695
<i>Northing</i>	<i>Easting</i>																										
32486.611	18899.816																										
32488.374	18901.532																										
32488.270	18901.639																										
32493.603	18906.827																										
32495.778	18904.591																										
32497.484	18906.251																										
32495.594	18908.193																										
32494.698	18907.321																										
32493.095	18908.970																										
32492.098	18908.001																										
32490.721	18909.417																										
32483.811	18902.695																										

THE SCHEDULE — *continued**First column**Second column*

The Authority

Protected Place

The boundaries of “PART OF 1<sup>ST</sup> MEZZANINE PANDAN LOOP SUBSTATION” are more particularly delineated in the Survey Plan set out below.

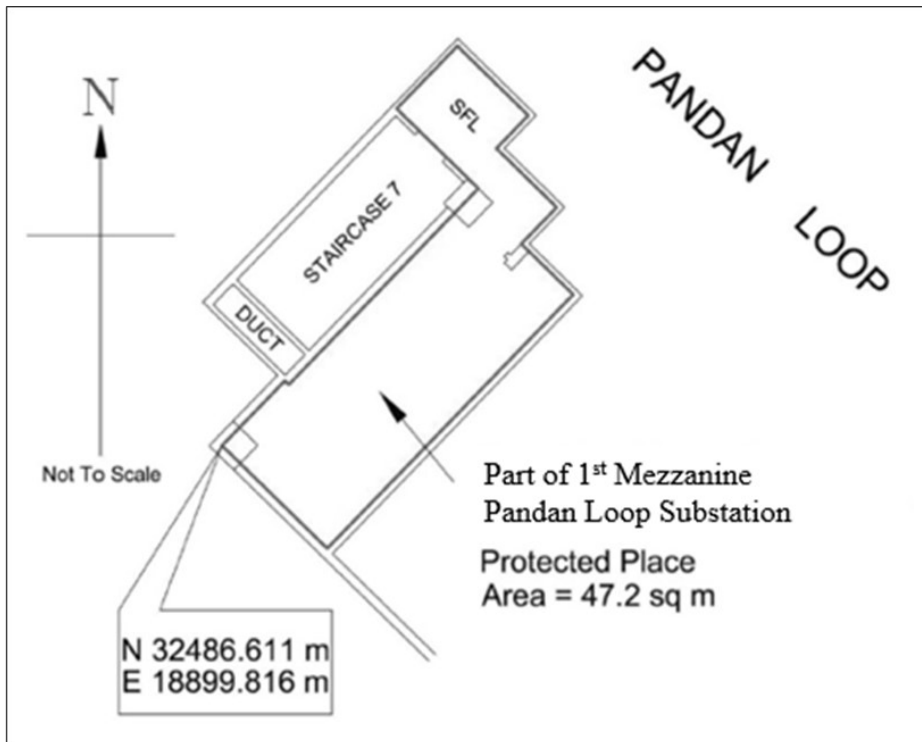

THE SCHEDULE — *continued*

<i>First column</i>	<i>Second column</i>																																				
The Authority	Protected Place																																				
6. Chief Executive Officer, SP PowerGrid Ltd	<p>PART OF 2<sup>nd</sup> STOREY PANDAN LOOP SUBSTATION</p> <p>All that area comprised in part of Lot 06855X in Mukim No. 5 occupied by “PART OF 2<sup>nd</sup> STOREY PANDAN LOOP SUBSTATION” containing an area of about 585.4 square metres and bounded approximately as follows:</p> <p>Commencing at a point 32486.604 metres North and 18899.823 metres East of the Singapore Land Authority SVY 21 Datum, the boundaries run along successive lines of coordinates approximately as follows:</p> <table border="0" style="margin-left: auto; margin-right: auto;"> <thead> <tr> <th style="text-align: left;"><i>Northing</i></th> <th style="text-align: left;"><i>Easting</i></th> </tr> </thead> <tbody> <tr><td>32486.604</td><td>18899.823</td></tr> <tr><td>32488.346</td><td>18901.518</td></tr> <tr><td>32488.234</td><td>18901.633</td></tr> <tr><td>32493.467</td><td>18906.723</td></tr> <tr><td>32495.175</td><td>18904.967</td></tr> <tr><td>32495.691</td><td>18905.469</td></tr> <tr><td>32496.082</td><td>18905.068</td></tr> <tr><td>32497.322</td><td>18906.274</td></tr> <tr><td>32495.035</td><td>18908.625</td></tr> <tr><td>32494.225</td><td>18907.837</td></tr> <tr><td>32493.095</td><td>18908.998</td></tr> <tr><td>32492.077</td><td>18908.008</td></tr> <tr><td>32487.649</td><td>18912.559</td></tr> <tr><td>32494.244</td><td>18918.975</td></tr> <tr><td>32475.354</td><td>18938.392</td></tr> <tr><td>32470.587</td><td>18933.755</td></tr> <tr><td>32469.614</td><td>18934.755</td></tr> </tbody> </table>	<i>Northing</i>	<i>Easting</i>	32486.604	18899.823	32488.346	18901.518	32488.234	18901.633	32493.467	18906.723	32495.175	18904.967	32495.691	18905.469	32496.082	18905.068	32497.322	18906.274	32495.035	18908.625	32494.225	18907.837	32493.095	18908.998	32492.077	18908.008	32487.649	18912.559	32494.244	18918.975	32475.354	18938.392	32470.587	18933.755	32469.614	18934.755
<i>Northing</i>	<i>Easting</i>																																				
32486.604	18899.823																																				
32488.346	18901.518																																				
32488.234	18901.633																																				
32493.467	18906.723																																				
32495.175	18904.967																																				
32495.691	18905.469																																				
32496.082	18905.068																																				
32497.322	18906.274																																				
32495.035	18908.625																																				
32494.225	18907.837																																				
32493.095	18908.998																																				
32492.077	18908.008																																				
32487.649	18912.559																																				
32494.244	18918.975																																				
32475.354	18938.392																																				
32470.587	18933.755																																				
32469.614	18934.755																																				

THE SCHEDULE — *continued*

<i>First column</i>	<i>Second column</i>	
The Authority	Protected Place	
	32468.410	18933.583
	32470.317	18931.623
	32469.206	18930.542
	32469.771	18929.962
	32468.768	18928.985
	32468.370	18929.394
	32464.700	18925.824
	32464.617	18925.910
	32462.875	18924.215

to the point of commencement.

The boundaries of “PART OF 2<sup>nd</sup> STOREY PANDAN LOOP SUBSTATION” are more particularly delineated in the Survey Plan set out below.

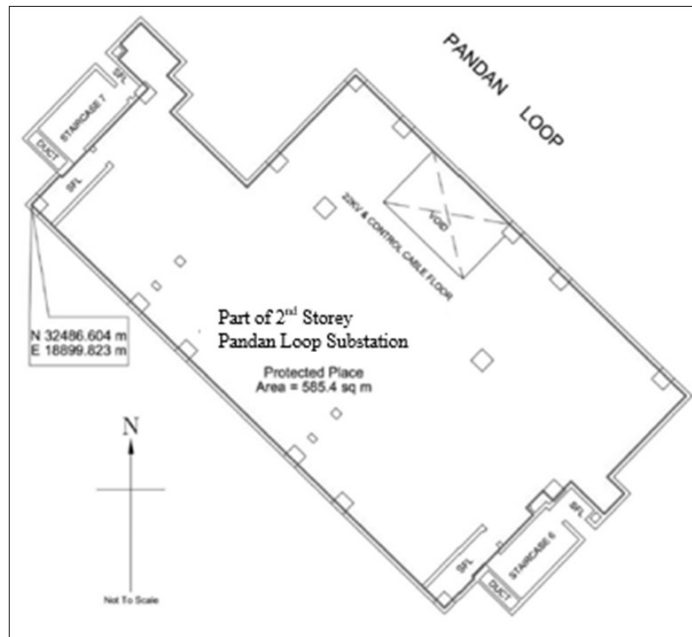

THE SCHEDULE — *continued*

<i>First column</i>	<i>Second column</i>
The Authority	Protected Place
7. Chief Executive Officer, SP PowerGrid Ltd	PART OF 3 <sup>rd</sup> STOREY PANDAN LOOP SUBSTATION

All that area comprised in part of Lot 06855X in Mukim No. 5 occupied by “PART OF 3<sup>rd</sup> STOREY PANDAN LOOP SUBSTATION” containing an area of about 619.2 square metres and bounded approximately as follows:

Commencing at a point 32486.562 metres North and 18898.792 metres East of the Singapore Land Authority SVY 21 Datum, the boundaries run along successive lines of coordinates approximately as follows:

<i>Northing</i>	<i>Easting</i>
32486.562	18898.792
32488.841	18901.009
32488.269	18901.597
32493.624	18906.806
32495.186	18905.200
32495.580	18905.584
32496.173	18904.974
32497.484	18906.250
32495.588	18908.200
32495.509	18908.123
32489.470	18914.331
32494.244	18918.975
32476.379	18937.338
32469.297	18930.449
32469.771	18929.962
32468.839	18929.055
32468.410	18929.496

THE SCHEDULE — *continued*

<i>First column</i>	<i>Second column</i>	
The Authority	Protected Place	
	32464.669	18925.856
	32464.128	18926.411
	32461.849	18924.194

to the point of commencement.

The boundaries of “PART OF 3<sup>rd</sup> STOREY PANDAN LOOP SUBSTATION” are more particularly delineated in the Survey Plan set out below.

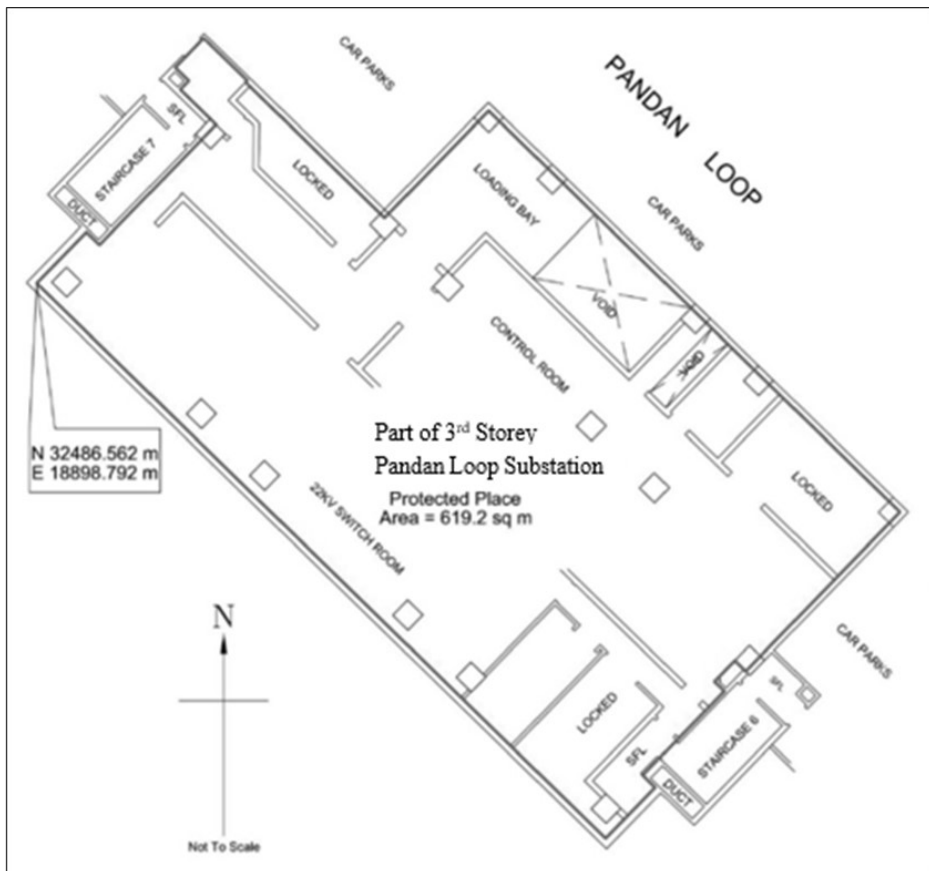

THE SCHEDULE — *continued*

<i>First column</i>	<i>Second column</i>																																				
The Authority	Protected Place																																				
8. Chief Executive Officer, SP PowerGrid Ltd	<p>PART OF 4<sup>th</sup> STOREY PANDAN LOOP SUBSTATION</p> <p>All that area comprised in part of Lot 06855X in Mukim No. 5 occupied by “PART OF 4<sup>th</sup> STOREY PANDAN LOOP SUBSTATION” containing an area of about 618.1 square metres and bounded approximately as follows:</p> <p>Commencing at a point 32486.597 metres North and 18898.756 metres East of the Singapore Land Authority SVY 21 Datum, the boundaries run along successive lines of coordinates approximately as follows:</p> <table border="0" style="margin-left: auto; margin-right: auto;"> <thead> <tr> <th style="text-align: left;"><i>Northing</i></th> <th style="text-align: left;"><i>Easting</i></th> </tr> </thead> <tbody> <tr><td>32486.597</td><td>18898.756</td></tr> <tr><td>32488.847</td><td>18900.945</td></tr> <tr><td>32488.192</td><td>18901.619</td></tr> <tr><td>32493.539</td><td>18906.821</td></tr> <tr><td>32495.150</td><td>18905.165</td></tr> <tr><td>32495.573</td><td>18905.577</td></tr> <tr><td>32496.082</td><td>18905.053</td></tr> <tr><td>32497.401</td><td>18906.336</td></tr> <tr><td>32495.574</td><td>18908.214</td></tr> <tr><td>32495.495</td><td>18908.138</td></tr> <tr><td>32489.470</td><td>18914.331</td></tr> <tr><td>32494.186</td><td>18918.919</td></tr> <tr><td>32479.299</td><td>18934.222</td></tr> <tr><td>32477.277</td><td>18932.256</td></tr> <tr><td>32472.717</td><td>18936.943</td></tr> <tr><td>32469.986</td><td>18934.286</td></tr> <tr><td>32469.561</td><td>18934.724</td></tr> </tbody> </table>	<i>Northing</i>	<i>Easting</i>	32486.597	18898.756	32488.847	18900.945	32488.192	18901.619	32493.539	18906.821	32495.150	18905.165	32495.573	18905.577	32496.082	18905.053	32497.401	18906.336	32495.574	18908.214	32495.495	18908.138	32489.470	18914.331	32494.186	18918.919	32479.299	18934.222	32477.277	18932.256	32472.717	18936.943	32469.986	18934.286	32469.561	18934.724
<i>Northing</i>	<i>Easting</i>																																				
32486.597	18898.756																																				
32488.847	18900.945																																				
32488.192	18901.619																																				
32493.539	18906.821																																				
32495.150	18905.165																																				
32495.573	18905.577																																				
32496.082	18905.053																																				
32497.401	18906.336																																				
32495.574	18908.214																																				
32495.495	18908.138																																				
32489.470	18914.331																																				
32494.186	18918.919																																				
32479.299	18934.222																																				
32477.277	18932.256																																				
32472.717	18936.943																																				
32469.986	18934.286																																				
32469.561	18934.724																																				



THE SCHEDULE — *continued*

<i>First column</i>	<i>Second column</i>
The Authority	Protected Place
32468.378	18933.573
32470.317	18931.580
32469.227	18930.521
32469.771	18929.962
32468.839	18929.055
32468.435	18929.471
32464.693	18925.831
32464.094	18926.447
32461.814	18924.230

to the point of commencement.

The boundaries of “PART OF 4<sup>th</sup> STOREY PANDAN LOOP SUBSTATION” are more particularly delineated in the Survey Plan set out below.

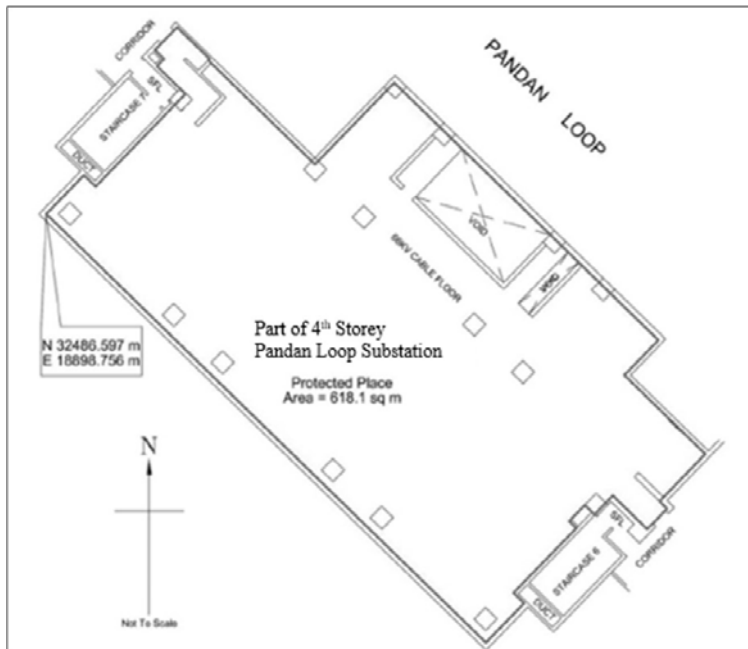

THE SCHEDULE — *continued*

<i>First column</i>	<i>Second column</i>																																		
The Authority	Protected Place																																		
9. Chief Executive Officer, SP PowerGrid Ltd	<p>PART OF 4<sup>th</sup> MEZZANINE PANDAN LOOP SUBSTATION</p> <p>All that area comprised in part of Lot 06855X in Mukim No. 5 occupied by “PART OF 4<sup>th</sup> MEZZANINE PANDAN LOOP SUBSTATION” containing an area of about 627.5 square metres and bounded approximately as follows:</p> <p>Commencing at a point 32486.597 metres North and 18898.756 metres East of the Singapore Land Authority SVY 21 Datum, the boundaries run along successive lines of coordinates approximately as follows:</p> <table border="0" style="margin-left: auto; margin-right: auto;"> <thead> <tr> <th style="text-align: left;"><i>Northing</i></th> <th style="text-align: left;"><i>Easting</i></th> </tr> </thead> <tbody> <tr><td>32486.597</td><td>18898.756</td></tr> <tr><td>32488.847</td><td>18900.945</td></tr> <tr><td>32488.192</td><td>18901.619</td></tr> <tr><td>32492.492</td><td>18905.803</td></tr> <tr><td>32494.609</td><td>18903.627</td></tr> <tr><td>32495.505</td><td>18904.499</td></tr> <tr><td>32494.999</td><td>18905.019</td></tr> <tr><td>32495.573</td><td>18905.577</td></tr> <tr><td>32496.082</td><td>18905.053</td></tr> <tr><td>32497.329</td><td>18906.267</td></tr> <tr><td>32489.477</td><td>18914.338</td></tr> <tr><td>32494.215</td><td>18918.947</td></tr> <tr><td>32479.279</td><td>18934.300</td></tr> <tr><td>32477.186</td><td>18932.264</td></tr> <tr><td>32472.716</td><td>18936.858</td></tr> <tr><td>32470.071</td><td>18934.285</td></tr> </tbody> </table>	<i>Northing</i>	<i>Easting</i>	32486.597	18898.756	32488.847	18900.945	32488.192	18901.619	32492.492	18905.803	32494.609	18903.627	32495.505	18904.499	32494.999	18905.019	32495.573	18905.577	32496.082	18905.053	32497.329	18906.267	32489.477	18914.338	32494.215	18918.947	32479.279	18934.300	32477.186	18932.264	32472.716	18936.858	32470.071	18934.285
<i>Northing</i>	<i>Easting</i>																																		
32486.597	18898.756																																		
32488.847	18900.945																																		
32488.192	18901.619																																		
32492.492	18905.803																																		
32494.609	18903.627																																		
32495.505	18904.499																																		
32494.999	18905.019																																		
32495.573	18905.577																																		
32496.082	18905.053																																		
32497.329	18906.267																																		
32489.477	18914.338																																		
32494.215	18918.947																																		
32479.279	18934.300																																		
32477.186	18932.264																																		
32472.716	18936.858																																		
32470.071	18934.285																																		

---



---

 THE SCHEDULE — *continued*

<i>First column</i>	<i>Second column</i>
The Authority	Protected Place
32469.590	18934.780
32468.343	18933.567
32468.880	18933.015
32468.270	18932.422
32467.733	18932.974
32466.981	18932.242
32468.912	18930.256
32469.206	18930.542
32469.771	18929.962
32468.839	18929.055
32468.435	18929.471
32464.693	18925.831
32464.094	18926.447
32461.814	18924.230

to the point of commencement.

The boundaries of “PART OF 4<sup>th</sup> MEZZANINE PANDAN LOOP SUBSTATION” are more particularly delineated on the Survey Plan set out below.

THE SCHEDULE — *continued*

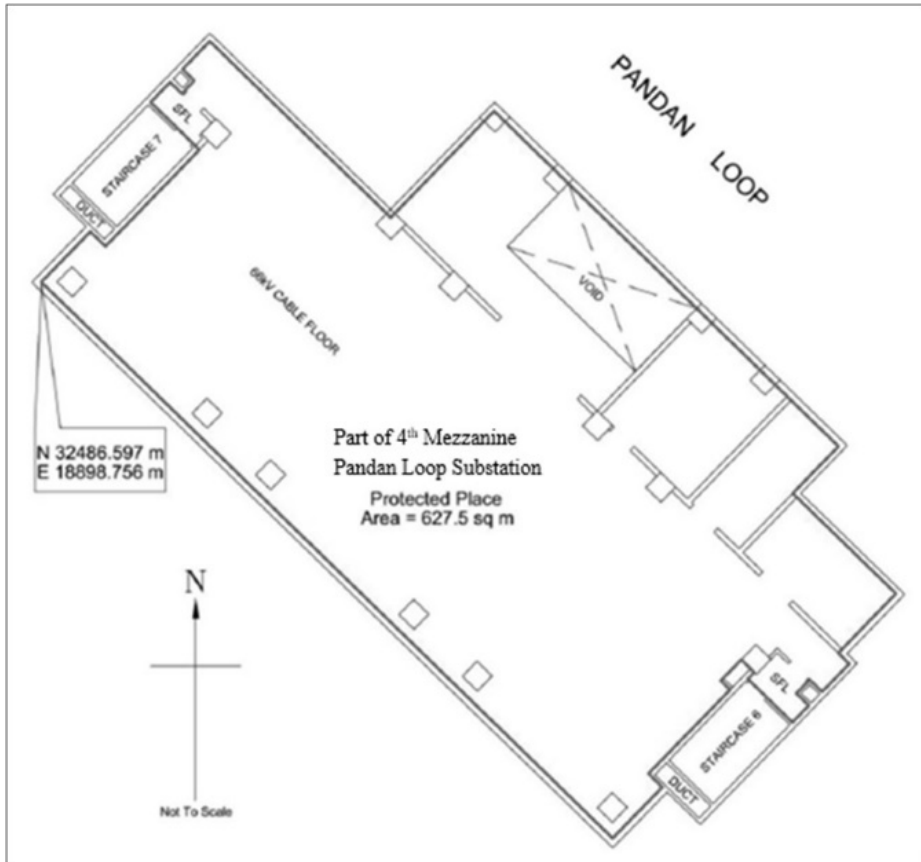

*First column*

*Second column*

The Authority

Protected Place

10. Chief Executive Officer,  
SP PowerGrid Ltd

PART OF 4<sup>th</sup> MEZZANINE MAINTENANCE PLATFORM PANDAN LOOP SUBSTATION

All that area comprised in part of Lot 06855X in Mukim No. 5 occupied by “PART OF 4<sup>th</sup> MEZZANINE MAINTENANCE PLATFORM PANDAN LOOP SUBSTATION” containing an area of about 16.5 square metres and bounded approximately as follows:

Commencing at a point 32464.192 metres North and 18921.785 metres East of the Singapore Land Authority SVY 21 Datum, the boundaries run along successive lines of coordinates approximately as follows:

---



---

 THE SCHEDULE — *continued*

<i>First column</i>	<i>Second column</i>	
The Authority	Protected Place	
	<i>Northing</i>	<i>Easting</i>
	32464.192	18921.785
	32468.105	18925.593
	32467.213	18926.510
	32467.105	18926.405
	32466.164	18927.373
	32465.397	18926.627
	32465.502	18926.519
	32464.742	18925.780
	32464.093	18926.447
	32461.814	18924.229

to the point of commencement.

The boundaries of “PART OF 4<sup>th</sup> MEZZANINE MAINTENANCE PLATFORM PANDAN LOOP SUBSTATION” are more particularly delineated in the Survey Plan set out below.

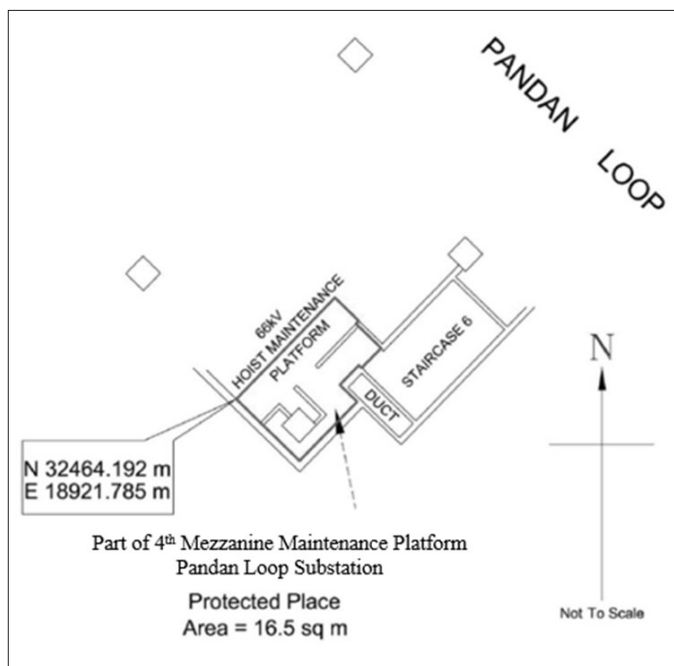
THE SCHEDULE — *continued*

Made on 13 February 2023.

PANG KIN KEONG  
*Permanent Secretary,  
Ministry of Home Affairs,  
Singapore.*

[SPF/CPS/C/09/02/03; AG/LEGIS/SL/137B/2020/2 Vol. 1]