

---

---

First published in the *Government Gazette*, Electronic Edition, on 17 April 2018 at 5 pm.

## No. S 213

# PROTECTED AREAS AND PROTECTED PLACES ACT (CHAPTER 256)

## PROTECTED PLACES (NO. 2) ORDER 2018

### ARRANGEMENT OF PARAGRAPHS

#### Paragraph

1. Citation and commencement
  2. Premises declared to be protected place  
The Schedule
- 

In exercise of the powers conferred by section 5(1) of the Protected Areas and Protected Places Act, the Minister for Home Affairs makes the following Order:

#### **Citation and commencement**

1. This Order is the Protected Places (No. 2) Order 2018 and comes into operation on 18 April 2018.

#### **Premises declared to be protected place**

2.—(1) The premises described in the second column of the Schedule are declared to be a protected place for the purposes of the Act.

(2) No person may enter or remain in those premises unless the person —

- (a) is in possession of a pass-card or permit issued by the authority specified in the first column of the Schedule; or
- (b) has the permission of an authorised officer on duty at those premises to enter those premises.

---



---

THE SCHEDULE

*First column**Second column*

The Authority

Protected Place

Director,  
Water Supply (Plants)  
Department,  
Public Utilities Board

Tuas Desalination Plant.

All that area comprised in part of State Land Lot 4882C in Mukim No. 7, occupied by “Tuas Desalination Plant” containing an area of about 35000.0 square metres and bounded approximately as follows:

Commencing at a point 31778.539 metres North and 4771.833 metres East of the Singapore Land Authority SVY 21 Datum, the boundaries run along successive lines of coordinates approximately as follows:

<i>Northing</i>	<i>Easting</i>
31778.539	4771.833
31687.235	4738.112
31724.914	4636.239
31811.583	4401.905
31849.409	4414.948
31853.722	4416.463
31863.537	4420.430
31865.867	4421.290
31897.861	4433.100
31903.277	4435.445

to the point of commencement.

The boundaries of “Tuas Desalination Plant” are more particularly delineated in the Survey Plan No. (35A) in SLA/LPB/47.1.250 set out below.

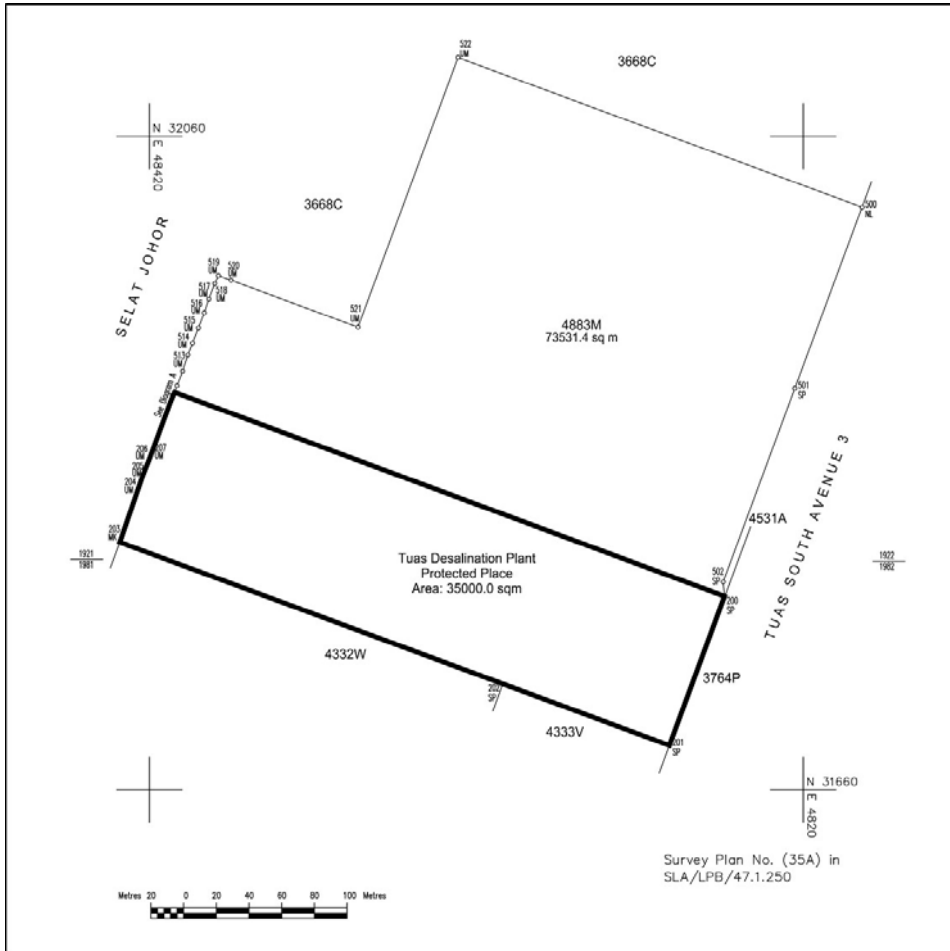
THE SCHEDULE — *continued*

Made on 26 March 2018.

PANG KIN KEONG  
*Permanent Secretary,  
 Ministry of Home Affairs,  
 Singapore.*

[MHA (PS) 12/2/02; AG/LEGIS/SL/256/2015/1 Vol. 8]